



# CASCADE HORSE SHOWS

# 2022

## Official Prize List

July

JULY 13-17 **PACIFIC CREST OPEN**

*USEF Regional I (B) Hunter, Jumper Rating 2*

**USHJA Sanctioned Outreach Event**

WASHINGTON STATE HORSE PARK, CLE ELUM WASHINGTON

[CASCADEHORSESHOWS.COM](http://CASCADEHORSESHOWS.COM)

*Photos, L-R: Closing Time and Kelsey King; Dreamliner and Gillian Baird; Jevaro and Hannah Evans.*



## Flying over obstacles: This is what trust is all about.

Building a family legacy takes a lifetime. Maintaining it over generations takes our kind of expertise.

Experience tells us that perpetuating wealth is often as much about family dynamics as it is economics. For this reason we focus on your vision and values as tenaciously as we pursue solid returns. Our goal is to empower you, your family, your traditions and culture for generations to come. With Whittier Trust your lasting legacy begins today.

There is a tangible difference that the oldest and largest multi-family office headquartered in the West can mean for your legacy. Experience it. Talk to Lori Houston and Paul Cantor at (206) 332.0836.



# Whittier Trust

Investment Management & Consulting | Trust Services | Family Office  
Philanthropy & Family Continuity | Real Estate & Energy

---

#### SEATTLE OFFICE

520 PIKE STREET, SUITE 1415, SEATTLE, WA 98101  
(206) 332.0836

#### PORTLAND OFFICE

111 S.W. FIFTH AVENUE, SUITE 3150, PORTLAND, OR 97294  
(503) 444.3428

---

SOUTH PASADENA | WEST LOS ANGELES | NEWPORT BEACH | SAN FRANCISCO | RENO | SEATTLE | PORTLAND

# TABLE OF CONTENTS

How to Enter	5
Horse Show Approvals	5
Directions to the Washington State Horse Park	5
US Equestrian Sections and Ratings	7
Horse Show Officials	9
Horse Show Fees	12
Facilities & Grounds	14
Important Policies of the Show	16
Rules & Regulations	20
Cascade Circuit Cup Awards	25
Spotlight Classes	27
Hunter Division	29
Equitation Division	37
Jumper Division	40
Championships Offered	44
Specifications	46
Schedules: Pacific Crest Open	51
Entry Forms	56
USHJA Zone 9 Specifications (MT, WY, ID, OR, WA)	61
USEF Safe Sport / MAAP	64

# CASCADE SPONSORS

Cascade Horse Shows gratefully thanks its proud sponsors



# HOW TO ENTER

[Stall reservations](#) are required for entry into the horse show (see page 16).  
After reserving stalls, you may enter online at [Horseshowing.com](http://Horseshowing.com) or [EquestrianConnect.com](http://EquestrianConnect.com)



### Enter by email:

Send scanned entries to  
[office@cascadehorseshows.com](mailto:office@cascadehorseshows.com)

### Mail entries to:

Show Secretary  
Cascade Horse Shows  
311 Avenue C, Snohomish, WA 98290

Entries postmarked or received online after the close of entries are considered post entries and will incur a \$50 late entry fee.

## HORSE SHOW APPROVALS

**United States Equestrian Federation (USEF)** *Lexington, KY*

**United States Hunter Jumper Association (USHJA)** *Lexington, KY*

**Washington State Hunter Jumper Association (WSHJA)** *Sammamish, WA*

**Oregon Hunter Jumper Association (OHJA)** *Wilsonville, OR*

## DIRECTIONS TO THE WASHINGTON STATE HORSE PARK

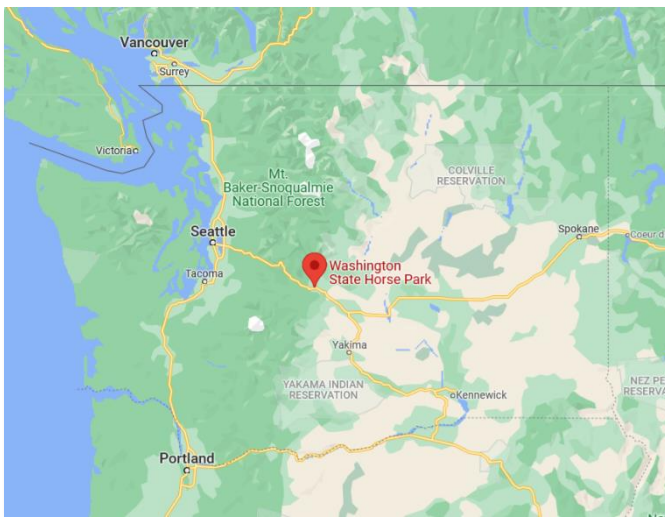

Map courtesy Google.

### Washington State Horse Park

1202 Douglas Munro Blvd.  
Cle Elum, WA 98922

*The Horse Park is conveniently located off Interstate 90 in Cle Elum, Washington, approximately 80 miles from Seattle.*

### From I90 Westbound:

Take exit 84 from I-90 W toward Cle Elum  
Right onto Oakes Ave 0.5 mi  
Left onto W 2nd St 0.6 mi  
Left onto Forest Service Rd 4517/Douglas Munro Blvd  
Right onto Douglas Munro Blvd

### From I90 Eastbound:

Take exit 84 from I-90 E toward Cle Elum/S Cle Elum  
Continue onto W 1st St 361 ft  
Turn left onto Douglas Munro Blvd 0.9 mi  
Continue on Douglas Munro Blvd



HORSEWARE®  
IRELAND

# Horse Therapy From Horseware

## SPORTZ-VIBE MASSAGE THERAPY RUG



- Reduces pain and inflammation
- Improves blood supply to tissue
- Relaxes muscles
- Improves quality of life

[www.sportzvibe.com](http://www.sportzvibe.com)



Massage Areas

## ICE-VIBE CIRCULATION THERAPY



- Reduces soreness and swelling
- Helps boost circulation
- Stimulates healing
- Strengthens muscle tissue

[www.icevibe.com](http://www.icevibe.com)

*"We use the ICE-VIBE boots daily as part of our treatment plan on our grand prix horses."*

-Richie Maloney *International Show Jumper*



[www.horseware.com](http://www.horseware.com)

# US EQUESTRIAN SECTIONS AND RATINGS

## **PACIFIC CREST OPEN | USEF #332619 | JUMPER 2**

*USEF Rated Regional I (B):* Performance Hunter 3'3" & 3'6", Green Hunter 3', 3'3", 3'6", Young Hunter 2'9", 3', 3'3", Amateur Owner Hunter 3'3" & 3'6", Junior Hunter 3'3" & 3'6", Pony Hunters

*USEF Rated Regional II (C):* Adult Amateur Hunter, Children's Hunter, Children's Hunter Pony, Small Hunter, Thoroughbred Hunter, USHJA Hunter 2', 2'3", 2'6", 2'9", 3'



*Four-time World Champion Hunter Rider John French competing in the Cascade USHJA National Hunter Derby sponsored by Brick Road Farms. Photo: Gary Voth*



Express your potential

VOLTAIRE  
DESIGN



[voltairedesignusa\\_can](https://www.instagram.com/voltairedesignusa_can)



[Voltaire Design USA & Canada](https://www.facebook.com/VoltaireDesignUSA)



[@VoltaireDesign](https://www.tiktok.com/@VoltaireDesign)

[VoltaireDesign.com](https://www.VoltaireDesign.com)

# HORSE SHOW OFFICIALS

*Show Manager*

**JENNIFER HANSEN**

*Show Secretary*

**LAUREN WASSERMAN**

*Marketing, Sponsorships & Community Relations*

**JESSICA VANIA**

*Grounds Manager*

**ADAM CHAMBERLIN**

*Finance and Operations*

**NANCY LEWIS**

*Web Site, Technology & Communications*

**GARY VOTH**

*Veterinarian*

**WASHINGTON STATE UNIVERSITY**

*Farrier*

**BRANDON HERMANN**

*Official Photographer*

**VIOLA MITCHELL**

*Horse Park Director*

**LESLIE THURSTON**

*Horse Show Advisors*

**ABBIE BLOCK**

**ANDREA SCHROEDER**

**DENISE YUELL**

---

## PACIFIC CREST OPEN

July 13-17, 2022

*Judges, Hunter & Equitation*

**CINDY ROSS**, Camas, WA

**KENDRA BEST**, Delta, BC

*Judge, Jumper*

**MAX VON ZIMMERMANN**, Selah, WA

*Course Designers*

**LINDSEY UYESUGI-LACEY**, Snohomish, WA

**LIZ HAMBLETON**, Sammamish, WA

*Steward*

**JILL EDWARDS**, Paso Robles CA

# New and Improved!

## USHJA Outreach Rewards and Awards

Earn points towards year-end rewards and awards with a free USHJA Outreach Membership!

USHJA Outreach Competitions and Classes provide opportunity to earn national recognition in classes from walk/trot to 3'0" in hunter, equitation, and .60m-1.20m in jumper sections at rated and unrated local shows.

### Rewards

Riders and owners of USHJA Outreach registered horses can earn level status and points to redeem at the end of the year for items such as USHJA logo wear, Outreach ribbons or Outreach medallions.

**Bronze Level:** Riders or horses must earn at least 50-74 points during the competition year

**Silver Level:** Riders or horses must earn at least 75-99 points during the competition year

**Gold Level:** Riders or horses must earn at least 100 points during the competition year

### Awards

*New! Exciting year-end awards will be given to trainers, riders and horses.*

**Trainers**—Earn the USHJA Outreach High Point Trainer Award by being the leading trainer in your zone whose riders have earned 100 or more points cumulatively in USHJA Outreach Classes.

**Riders**— In addition to awards and rewards, one high point rider from each Zone will earn a Golden Backstage Pass to participate in the USHJA National Championship Affiliate sections and get exclusive access to free educational sessions and National Championship Grand Prix and Hunter Derby course walks!

**Horses**—While horse recording and microchipping is not required to participate in Outreach classes, owners wishing for their horses to earn points must have them recorded with USHJA (\$20/annual or \$75/lifetime). Horses will have their Outreach points tracked and ranked within their USHJA Zone and displayed on ushja.org.

### For more information

and to find a USHJA Outreach Competition near you, visit [ushja.org/Outreach](http://ushja.org/Outreach).

**Questions?** Contact Melanie Mader at [mmader@ushja.org](mailto:mmader@ushja.org).



USHJA Outreach Champion



USHJA Outreach Champion



USHJA Outreach Champion



USHJA Outreach Champion





# Selling homes for horses and their people



**Heidi Davalos**

[heidid@pacesetterproptiesteam.com](mailto:heidid@pacesetterproptiesteam.com)

425.870.3334

**Raquel Davalos**

[raquel@pacesetterproptiesteam.com](mailto:raquel@pacesetterproptiesteam.com)

425.760.8600

**Reilly Ochs**

[reilly@pacesetterproptiesteam.com](mailto:reilly@pacesetterproptiesteam.com)

206.914.5254

# HORSE SHOW FEES

**USEF Horse Fee:** \$8\*

**USEF Equine Drug & Medication Fee:** \$15\*

**USEF Show Pass Fee:** \$45\*

**USEF Membership Fee:** \$80\*

**USHJA Fee:** \$2\*

**USHJA Show Pass Fee:** \$30\*

**Stall Fee:** \$290

**Non-Showing Horse Fee:** \$150/show

**Haul-In Fee:** \$50/horse/day or \$150/horse/show

**RV Space:** \$385 (Full hookup), \$300 (Partial hookup), \$150/week or \$25/night (no hookup/dry camp)

**Tent / Dry Camp Space:** \$150/week or \$25/night

**Warm-Up / Schooling Fee:** \$35

**Office Fee:** \$50

**Per Stall Manure Disposal / Garbage Fee:** \$50

**Hunter / Jumper Nomination Fee:** \$50

*\*Applies to rated competition only*

## CLOSING DATES FOR ENTRIES

Entries received after the closing dates will be charged a \$50 late entry fee.

*Swiftwater Invitational:* **MAY 20, 2022**

*Alpine Preview:* **MAY 20, 2022**

*Pacific Crest Open:* **JUNE 28, 2022**

*Cascade Finals:* **AUGUST 12, 2022**

## HORSE SHOW SERVICES

### *Show Office Hours*

**DAY PRECEDING SHOW:** 10am – 5pm

**DAYS OF SHOW:** 7am<sup>1</sup> – 5pm<sup>2</sup>

<sup>1</sup> or 30 minutes prior to start of the first class

<sup>2</sup> or 30 minutes after the last regularly scheduled class ends

### *Concessions Provided By*

#### **ONSITE VENDORS**

### *Golf carts*

#### **AVAILABLE FOR RENT FROM CHS**

A limited number of golf carts are available for rent on a weekly basis during the show from Cascade Horse Shows. Requests can be made from our web site using [our online form](#). Availability is first come, first served until the limited supply is gone.

## ONSITE RV POLICY

RV sites are available for request on a first come, first served basis, with consideration given for sponsors, two-week stays and size of RV. Please use our online form at [cascadehorsheshows.com](http://cascadehorsheshows.com) to make requests. Choices are not guaranteed, and no requests are final until you receive emailed confirmation from the Show Office and render payment, if required. For cancellations, please see [Cancellations & Refunds](#), page 16.

All sites are assigned by Cascade Horse Shows and will be shared with you upon confirmation. Upon arrival, please find your site at the welcome center or Show Office should you need assistance. An RV Pass must be procured at the Show Office and prominently displayed. Hookups with utilities include 15-amp, 30-amp, or 50-amp power and potable water (availability of 50-amp hookups is limited). Charges apply whether hooked up to utilities or not. Pump out services can be requested in the office on the dates they indicate are available.



TRAINING  
PROGRAM

TRAINING AND SHOWING PROGRAM

RIDING  
ACADEMY

RIDING LESSON PROGRAM

SUMMER  
CAMPS

SUMMER - AGES 7+

# LEGACY

Hunters & Jumpers

Shelly Kerron, Owner / Trainer

425.869.1527 | [LEAGACYHUNTERSJUMPERS.COM](http://LEAGACYHUNTERSJUMPERS.COM) | WOODINVILLE, WA

# FACILITIES & GROUNDS

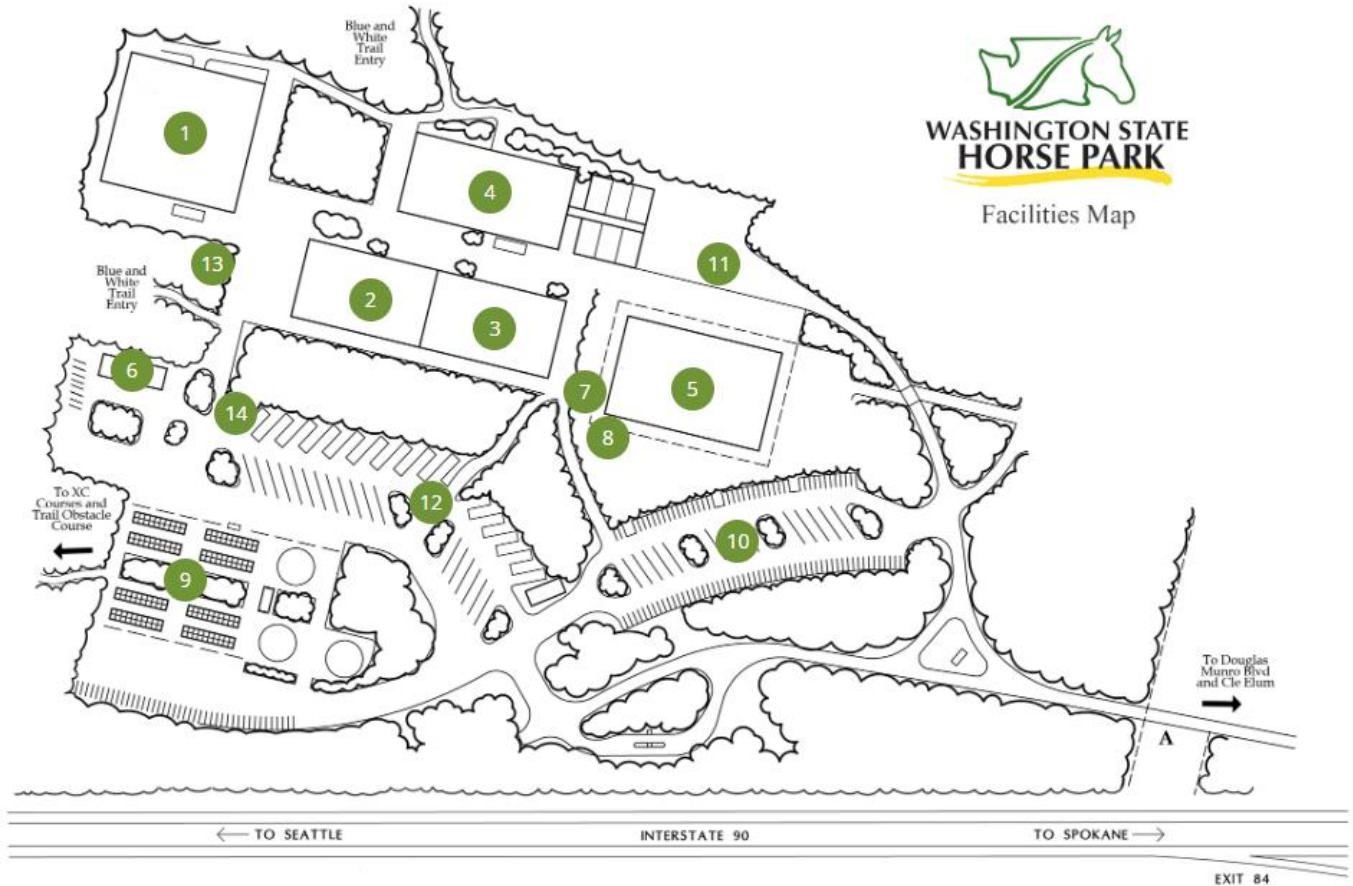

- 1 Ariat Grand Hunter (250' x 250')
- 2 Hunter warm-up (140' x 230')
- 3 Legacy Hunter (130' x 230')
- 4 Jumper warm-up (150' x 300')
- 5 Kona Coast Grand Jumper (covered arena, 150' x 300') with ample spectator seating
- 6 Show Office
- 7 Prize Store
- 8 Vendor Row
- 9 10 11 Stabling West, East and Northeast
- 12 RV sites: 14 premium full hookup (water, electric, sewer) sites nestled in the trees. 14 standard hookup (water & electric) situated around the tree islands. 24 basic no-hookup spaces
- 13 Windbreaker Lounge: Hospitality tent with lounge seating, plus covered and open picnic areas
- 14 Geneva Financial Lounge: Covered lounge with seating for work or relaxation

**Additional Amenities:**

- Shower facility with 3 private shower rooms
- Miles of adjacent horse trails with easy access from stabling areas
- Ample trailer parking

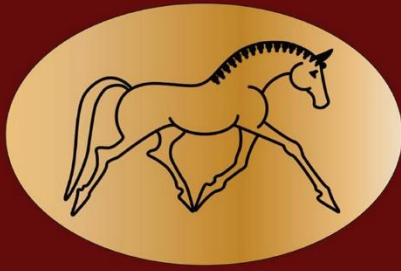

# Brick Road Farms

Quality Hunters and Jumpers

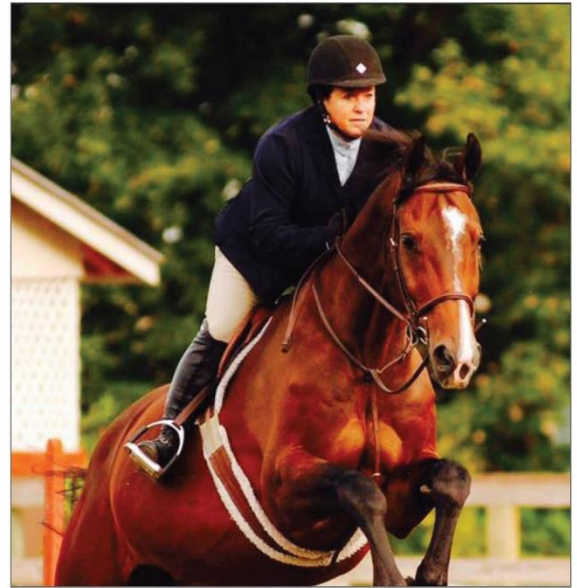

## Brick Road Farms is the Proud Sponsor of the Cascade Hunter Derby Series

Our farm is located on 25 beautiful acres, with trails on site, riding access to the beach on the Snohomish river.

Along with:

Experienced trainers always on site.

Top quality lesson horses with "A" circuit experience.

30 Matted stalls 12 x 12 and 10 x 13.

12 Acres of pasture turn outs plus winter turn outs.

80 x 250 covered arena with state of the art footing.

200 x 300 outdoor derby field with custom derby jumps.

1,200 square foot viewing room with special amenities, including a wine bar.

LESSONS

TRAINING

SALES

# IMPORTANT POLICIES OF THE SHOW

## STALL RESERVATIONS

Trainers or their authorized agents, or individual exhibitors not affiliated with a trainer, must use our online [Stall Reservation form](#) to reserve stalls in advance of our shows. Entries cannot be accepted without stall reservations. We will confirm your reservation within 7 business days of receiving your form. In the case that stalls sell out prior to the close of entries, we will add your reservations to our waitlist.

You can change your counts by notifying us via email at [office@cascadehorseshows.com](mailto:office@cascadehorseshows.com) or text at 360.573.4360, *however*, your counts will be locked-in after the show scratch / cancellation deadline (see below).

**Confirming your counts:** When the scratch deadline is approaching, we will contact you at least 72 hours in advance to confirm your final stall count. Stalls you confirm past the scratch deadline will be *final* regardless of whether you have submitted entries, so please only reserve stalls you are confident you will use. If we do not hear back from you at this stage, your stalls will be released to others on the waitlist.

**Changes past this deadline:** If your needs change past this deadline, you can work with other trainers to take your confirmed stalls—provided you notify us via email. All parties—i.e., you and the other trainer(s)—must be included on this communication to us. You must give us notice of any stall exchanges at least 10 days prior to the start of the show to have this reflected on the stabling chart. In the unlikely case of a misunderstanding between trainers as to who is paying for exchanged stalls, we must hold the trainer who made the original reservation responsible for the stalls.

If something does change, please reach out to us as soon as possible. While the above is our formal policy, with enough notice we will always try to work with you while maintaining a fair approach for all competitors.

## CANCELLATIONS & REFUNDS

If circumstances change and you will no longer be able to attend the show, please communicate any desired changes promptly. This helps us accommodate as many competitors as possible.

**Show Scratches and Cancellations:** The deadline for show cancellations and scratches without penalty will be the *earliest* of these two dates:

- The published close of entry date for the show
- A date we publicly announce that is approximately 6 weeks prior to the show (in the event the show sells out early)

Up until this deadline, you may make changes to or cancel your entries or their associated stall reservations and RV site requests without penalty. Any deposits paid with entries made prior to the scratch deadline will be fully refunded.

After this deadline, you are fully responsible for any stall fees due for your reserved stalls (see above) in addition to office fees due, if any. Refunds for RV sites with hookups are offered prior to the entry close date provided we can resell the space. RV sites are non-refundable past close of entries.

**Changes Past the Close of Entries:** A \$50 office fee per horse will apply to all entries, scratches and substitutions made after the close of entries. Please note that after a horse has been checked in, there are no refunds of stalls, nomination fees, feed and hay, bedding, RV reservations, schooling fees, office fees, non-showing horse fees, manure and garbage disposal fees or any completed classes.

**Refunds:** Any refunds due will be credited to your card or mailed to you within 3 weeks following the show.

**How to Request Changes:** Please communicate your requests to the Show Office promptly at [office@cascadehorseshows.com](mailto:office@cascadehorseshows.com).

**Illness or Injury During the Competition:** After the competition starts, if you are unable to compete due to an illness or injury, your remaining class fees will be refunded upon presentation of a doctor's certificate. Stall and other fees will not be refunded. A \$50 office charge will apply.

## ADDITIONAL POLICIES

### Adds & Scratches Due By 4:00 pm Daily

All changes for the next day, including adds and scratches, must be made by 4:00 pm each day in the office or on [horseshowing.com](http://horseshowing.com). This allows the next day's schedule to be created with class counts and times and made available to everyone in a timely manner.

### Day-of Adds

If wanting to add a class on the same day, approval will be based on schedule availability and management discretion. We cannot guarantee acceptance, and you may be put on the ring wait list. If accepted, day-of adds will be assessed a \$10 per class fee. Enter your classes by 4:00 pm the day prior to avoid the \$10 add fee. See our [full policy](#) on page 21.

### Canceling And Combining of Classes

Classes with fewer entries than the minimums may be either canceled or combined with other classes, at management's discretion.

### Posted Ring Schedule

The most accurate estimation of the daily ring schedules will be completed after adds and scratches have been entered. We strive to post this schedule by 7:00 pm the day prior. The schedule can be found at our [Competitor Resources page](#).

## US EQUESTRIAN MEMBERSHIP STATEMENT

Life, senior active and junior active members shall be eligible to participate in all classes at Regular Competitions, Eventing Competitions at the Modified Level or above and Combined Driving Competitions at the Advanced Level, Dressage, Reining and Vaulting Competitions and Endurance Rides. A nonmember may participate as a handler, rider, driver, owner, lessee, agent, coach or trainer at Regular Competitions, Eventing Competitions, Dressage Competitions, Reining Competitions and Combined Driving Competitions upon payment of a \$45 Show Pass fee. Participants in the following classes are exempted from the Requirements of this rule: 1) leadline; 2) exhibitions; 3) games and races; 4) classes for 4-H members; 5) walk trot (exception: Friesian performance FR222) and academy classes (academy classes are classes limited to horses used regularly in a lesson program); 6) USDF introductory level tests, pas de deux and quadrille classes; 7) NRHA Endorsed Reining Competitions. 8) Opportunity classes, 9) citizens of other nations who have proof, in English, of current membership in good standing of their own National Federation, 10) USEA beginner novice division; and 11) assistant handlers in Dressage Sport Horse Breeding classes.



# FARPOINT FARM TRAINING CENTER

CALGARY | KENTUCKY | CALIFORNIA | THE GREAT NORTHWEST

*“The secret of joy in work is contained in one word - excellence. To know how to do something well is to enjoy it.”*

*~ Pearl S. Buck*

Farpoint offers individualized instruction and training in the American Hunter-Jumper Riding System. From ponies to grand prix show jumpers, Farpoint offers an excellent program for Northwest riders to go far beyond where they've gone before.



**Denise Youell**, Owner & Head Trainer  
Snohomish, Washington | 360.668.7128  
[info@farpointfarm.com](mailto:info@farpointfarm.com)

## SPOTLIGHT CLASSES

# Pacesetter Mini Prix

Presented by **Pacesetter Properties Team**

July 16, 2022

**\$2,000 Pacesetter Mini Prix**

The signature Cascade Grand Prix event for July

*To be run as Table II, Sec 2(a/b) — Time first with a jump off; ties to jump off for first place*

*Prize money: 1<sup>st</sup> 30%, 2<sup>nd</sup> 20%, 3<sup>rd</sup> 14%, 4<sup>th</sup> 10%, 5<sup>th</sup> 8%, 6<sup>th</sup> 7%, 7<sup>th</sup> 6%, 8<sup>th</sup> 5%*

*Pacesetter Properties*  
**MINI PRIX**   
**CHAMPION**

**HORSEWARE**  
IRELAND

2021 Champion Jevaro & Hannah Evans  
Owner Whitney P Walker  
Trainer: Denise Youell

# RULES & REGULATIONS

Cascade Horse Shows competitions are conducted under current U.S. Equestrian and USHJA rules and are U.S. Equestrian, USHJA, USHJA Zone 9, WSHJA, and OHJA approved.

## ENTRIES

Enter online via [HorseShowing.com](http://HorseShowing.com) or [EquestrianConnect.com](http://EquestrianConnect.com). All sites are credit or debit card payment only. Or email scanned entries to:

Show Secretary  
Cascade Horse Shows  
311 Avenue C, Snohomish, WA 98290  
Email: [office@cascadehorseshows.com](mailto:office@cascadehorseshows.com)  
Text: 360.573.4360

Each show has a published close of entries date. You may enter the shows at any time assuming space availability.

All entries require a Competition Deposit equivalent to the cost of a stall plus a \$50 fee. This deposit will be fully credited to your final show bill upon checkout if entries are received prior to the close of entries date. If your entries are received after the close of entries date, the \$50 per entry fee is forfeit.

## SCRATCH DEADLINE

The deadline for refunds in the event of show cancellations or scratches will be the *earliest* of these two dates:

- The published close of entry date for the show
- A date that we publicly announce that is approximately 6 weeks prior to the show if the show sells out early

Refunds for show entries or reserved stalls are not possible for any reason after this deadline. Please contact the Show Office to request refunds.

## STALL RESERVATIONS

Trainers or their authorized agents, or individual exhibitors not affiliated with a trainer, may use our online [Stall Reservation form](#) to reserve stalls in advance of our shows. Please see our full [Stall Reservation policy](#) on page 15.

## PAYMENT

Pay by check, cash, money order, VISA, MasterCard, Discover, American Express credit or debit card. A valid form of payment must be presented upon check-in at the show. All credit and debit card payments subject to a 3.5% convenience fee.

Canadian Exhibitor entries must be paid by draft payable in US funds or check on Canadian US dollar account or credit card. Canadian checks with US FUNDS written on the face of the check cannot be accepted.

All checks returned by the bank incur a fee of \$50. To retain entries, the fees and penalty must be paid by before 4pm the day before the Show starts. In the event a check is returned after the completion of the show, it will be handled in accordance with US EQUESTRIAN GR913.

Competitors who do not come into the office to close out at the end of the show forfeit the right to adjustments on any show charges. Final balances will be automatically charged to the payment method on file.

## TRAINER SPLITS

Trainers having accounts with Cascade Horse Shows may choose to add their show fees and charges to their "trainer splits" to have these charges distributed amongst their clients. Trainers have until 5:00pm Friday of the show to inform the Show Office which charges will be distributed to which clients. It is fully and solely the trainer's responsibility to indicate which items are applicable to the split and to which clients they should be applied. *Exhibitors:* By submitting an entry form, you acknowledge that you fully accept responsibility for the costs assigned to you by your trainer for the show that you are entering.

## SUBSTITUTIONS

A new horse may be substituted for a scratched horse. There will be a \$50 office charge for substitutions made after the close of entries.

## SHOW SCRATCH and REFUNDS

Refer to [Cancellations & Refunds](#) on page 16.

## EVERY CLASS OFFERED HEREIN WHICH IS COVERED BY THE RULES AND SPECIFICATIONS OF THE CURRENT USEF RULE BOOK WILL BE CONDUCTED AND JUDGED IN ACCORDANCE THEREWITH

## REQUIRED CREDENTIALS

Exhibitors entering rated competition must present copies of the following current credentials to the horse show: US EQUESTRIAN/USHJA/EC membership card; US EQUESTRIAN/USHJA Amateur certification; US EQUESTRIAN/USHJA Large, Small, Junior Hunter and Pony measurement card; USHJA/EC horse recording card or ID number.

## USHJA HORSE REGISTRATIONS

All horses competing in licensed competitions with Hunter, Hunter Breeding, Jumper and/or Hunt Seat Equitation classes (except those activities enumerated in GR901.9, items 1-9) must obtain a Registration Number from USHJA. Not required for Opportunity and Outreach classes.

## HORSE MICROCHIP

Note: An ISO 11784/11785 compliant chip is required for entry into ALL USHJA rated hunter/jumper competitions starting with the 2019 season.

## MEASUREMENT & AMATEUR CERTIFICATION

All Small, Large, Junior and Pony Hunters must possess and present a current Measurement card to the Show Secretary before numbers may be picked up. If the cards are not available, MEASUREMENT WILL BE REQUIRED. Photocopies of current Amateur Certification or Junior Memberships may be included with entries or made available when picking up numbers. Check in the Show Office for measurements times and dates.

## SAFE SPORT

All USEF Life and Senior Active members, as well as participants who have regular contact with minor athletes, are required to comply with the U.S. Center for SafeSport training requirement to be eligible to participate in the competition. All participants must adhere to the U.S. Center for SafeSport Code, USEF Safe Sport Policy, and the Minor Athlete Abuse Prevention Policies. More information about this can be found at [www.usef.org](http://www.usef.org).

## COMPETITION OFFICE HOURS

Day preceding show: 10:00am-5:00pm. Days of show: 7am-5pm or 30 minutes after the last regular class completes whichever is later. Special classes are excluded. Regardless of closing time all next day class adds are due by 4:00pm.

## ARRIVALS AND DEPARTURES

*Arrivals:* Plan to arrive and move in as early as 2 days prior to the start of the competition. For example, a Tuesday warm-up day with a Wednesday competition start means you move in on Monday starting at 8am. You may arrive later if you like. For approval to arrive earlier than the 2 days before competition start, contact the Show Office at [office@cascadehorsheshows.com](mailto:office@cascadehorsheshows.com). Early arrivals incur a per-night fee per-stall and per-RV as applies.

*Departures:* Plan to depart Stabling and RV locations by 7pm Sunday or pre-pay with the Show Office to stay over Sunday night. The fee is \$35 per horse stall, and you must vacate by 8am on Monday morning. On Sunday night there will be a 10pm stabling 'lights out'. Sunday night RV stays incur a 'per night' RV fee.

## 4- & 5-YEAR-OLDS and OFF-THE-TRACK THOROUGHBREDS (OTTB) SHOW FREE

Free entry limited to ONE open Hunter or open Jumper section, excluding Spotlight classes and Classics. Each rider (professional, junior, or amateur) is limited to one horse at each Cascade show. Horses that utilize this program are allowed one use per Cascade Horse Show season. Participation in the program is limited to 2 consecutive years. Management reserves the right to cap participation. Horses entered after the entry close date are not eligible.

All participants wishing to utilize this program must email [office@cascadehorsheshows.com](mailto:office@cascadehorsheshows.com) prior to close date of entries, include horse and rider's name, and trainer's name. Must provide proof of age at time of check-in. Thoroughbreds must have Jockey Club papers and/or proof of breeding including tattoos. All other fees, including stalls, nomination, office, federation, etc. apply. Substitutions are allowed and will follow the regular substitution policy.

## STABLING

Stalls with doors are provided; dimensions are 10'x10'. 160 have mats; the remaining have dirt/gravel floors. Requests for specific stalls or stall locations will be considered on an individual basis. Preference given to horses showing both weeks and to sponsors. Portable stalls, with doors, are provided. Bales of shavings will be available by pre-order on entry form and/or during the show by request at the Competition Office. One bale of shavings is included with each stall. Straw is not permitted.

In cases of high demand, management reserves the right to cap how many non-horse stalls are sold, and a ratio of horse stalls to non-horse stalls may be put into effect.

Stalls must be cleaned daily. Dirty bedding must be placed in areas provided. Exhibitors are responsible for cleaning their own stalls and must provide their own feed and buckets. A \$50 manure disposal and garbage fee will be assessed for all stalls. No staples, nails, cutting stalls or removal of top doors permitted. Stabling damage fees will be assessed by the WSHP as follows: Panels – \$100 portable stall, \$200 permanent stall; Stall metal framework - \$200; light cords \$150; Roof Tarps – actual repair/replacement costs. Trash cans and bags will be provided on move out days.

## SHARPS CONTAINERS

Sharps containers will be available at the end of each barn aisle way. Please be aware, Competition Management may fine any individual up to \$100 for improper disposal of needles or other sharp disposable instruments. GR1210.4 If needles are dropped in manure, it cannot be composted.

## JUMPER / HUNTER / EQ NOMINATING FEE

Horses or ponies entered in any jumper, hunter or equitation classes pay a Nomination Fee (varies per show). This fee allows entries to add classes before 4:00 pm prior to the day of the class.

## CLASS ADD / SCRATCH POLICY

*Adds* — Classes may be added up to a day ahead of time at no charge if the Show Office is notified by 4:00pm. Unless otherwise posted, it should be assumed that there are no day-of adds. If wanting to add a class on the same day, approval will be based on schedule availability and management discretion. We cannot guarantee acceptance, and you may be put on the ring wait list. If accepted, day-of adds will be assessed a \$10 per class fee.

*Scratches* — With the exception of special classes, if your horse has a written scratch form at the Show Office prior to the start of the class, full class entry fees are refunded minus a \$10 scratch fee. You must scratch your classes BEFORE they start. If you don't scratch them at all or try to scratch them after the class has started, you will be charged the full class entry fee.

## SPECIAL / SPOTLIGHT CLASS SCRATCH POLICY

Special / Spotlight classes will be assessed a \$25 scratch fee if scratched on the day of the class.

## RIDER DID NOT ENTER (RDNE) FEE

It is the responsibility of the competitor and trainer to ensure they have properly entered all classes they intend to compete in. A "ride-did-not-enter" (RDNE) fee of \$25 will be added to the cost of the class for any rounds competed that cannot be supported by office-approved paperwork.

## CLASS WAIT LIST POLICY

Be sure to get all entries planned for the next day in by 4pm. If full ring capacity is reached, any entries received for that ring after 4pm, may be put on a wait list. You are encouraged to enter all classes/divisions for the entire show before 4pm on schooling day to ensure entry in those classes/divisions.

## US EQUESTRIAN and USHJA FEES

All horses participating in any competition recognized by the US Equestrian Federation incur the following fees: USEF \$23 fee (\$15 of this fee is a Drugs and Medication fee to provide research, inspection, and enforcement of rules regarding use of medications and drugs: see GR407.1, .2, and .3); USHJA Fee \$7 (National shows) or \$2 (Regional I shows). If you are not a current USEF and USHJA member, a Show Pass fee is assessed by USEF/USHJA (\$45 USEF, \$30 for USHJA). These fees will be added to your show account.

## MANAGEMENT CLASS CHANGES

Management reserves the right to cancel or combine any classes as appropriate. Notice will be given to exhibitors affected. Management reserves the right to start the first class of any section 30 minutes earlier than the scheduled time. Management reserves the right to change arenas, judges, or class orders to facilitate time, schedule, and conditions.

Vegetarian, Glycerin-free, Petroleum-free, pH Matched Premium Leather Care

# You've certainly invested **A LOT** in your tack, haven't you?

So you can see how it is well worth it to give it the premium care that will help extend its life, can you not?

When you choose Sterling Essentials, you choose life-extending tack care made with pH formulated, all natural vegetarian ingredients, and mold-fighting pure essential oils.

You'll **NEVER** have to use harsh chemicals that damage your tack and harm you and your horse ever again.

Liberate yourself and your horse with Sterling Essentials.

Photo Credit  
Genevieve Munson



**STERLING  
ESSENTIALS**  
— LLC —  
EMPOWERED EQUESTRIAN

Purchase your favorite fragrance at retailers nationwide or  
learn more at:

[WWW.STERLING-ESSENTIALS.COM](http://WWW.STERLING-ESSENTIALS.COM)

## PRIZE MONEY PAYMENTS

Exhibitors receive prize money within 3 weeks after the horse show. A valid Social Security or Federal tax ID number must be provided. Prize money won by foreign exhibitors is subject to the US Internal Revenue Service regulation requiring sporting events to withhold 30% of prize money unless they have a US Social Security #.

## TROPHIES, RIBBONS, PRIZE MONEY SPLITS

Trophy and ribbons will be awarded to eight places in all Hunter and Equitation classes. Unless stated otherwise, Hunter and Hunter Classic prize money will be divided 30%, 25%, 20%, 15%, 10%. The USHJA National Hunter Derby prize money will be divided 30%, 22%, 13%, 8%, 6%, 5%, 4%, 3%, 2%, 2%, 2%. Trophy and ribbons will be awarded to six places in all Jumper classes. Unless stated otherwise, Jumper prize money will be divided 25%, 23%, 20%, 17%, 15%. The Cascade Welcome and the Cascade DerbyCross™ prize money will be divided 30%, 23%, 15%, 12%, 10%, 10%. The Need for Speed™ Open Jumper will be divided 30%, 20%, 14%, 10%, 8%, 7%, 6%, 5%. The Grand Prix and Mini Prix will be divided 30%, 20%, 15%, 10%, 8%, 6%, 4%, 3%, 2%, 2%.

## HUNTER TIES

As stated in [USEF HU154](#), in case of a tie the Championship and/or Reserve is awarded to the horse with the most points over fences. If horses have equal points over fences and no points under saddle, the tied horses will be asked to compete in a hack off (Exception: Green and Young Hunters.) Any competitor may concede and not hack off, or if both competitors agree, break the tie with a coin toss. If horses have an equal number of points over fences, under saddle, and model (i.e., Green Conformation Hunter 3'6" or High-Performance Conformation Hunter) the tie will stand as is and double ribbons will be awarded.

## JUMPER TIES

As stated in [USEF JP143](#), Competitors who are tied for first place after the initial round(s) will jump off. Any competitors that compete in the jump off and are still tied for first place shall remain tied. Competitors who are tied for other than first place in all Jumper sections will be placed according to the time taken to complete the first course. Prize money and Championship points shall be combined and divided equally among the tied competitors. Double ribbons will be awarded for division championships. For special classes, the competitors will toss a coin for the ribbon and toss a coin for the special award if any.

## JUMPER CLASS SCHEDULE TABLES

Jumper classes not otherwise designated in the class schedules will run as Table II.1, Table II.2.b or Table II.2.c, or Table II.d. Please refer to the daily schedules available in the Competition Office.

## STAKE/HANDY HUNTER CLASSES

If a per class entry is offered in a division, horse and rider must have shown in at least one other class in the division to be eligible for the Stake or Handy Hunter Class.

## HORSE ILLNESS

In the event of an acute and serious injury or illness of a horse on competition grounds when the owner or trainer of the horse is not present, after reasonable effort to contact that individual has been made, Competition Management, in consultation with a licensed veterinarian, may authorize the provision of emergency veterinary treatment of the horse. If Competition Management authorizes treatment under provisions of this rule, Competition Management and veterinarian are not responsible for any resulting costs, damages, losses, claims, or actions arising directly from the treatment of the horse.

## SCHOOLING AND EXERCISE

Schooling areas are available for use before and during the show. A mandatory schooling fee of \$35 is charged for all horses. Helmets meeting the US Equestrian requirements as well as riding boots must be worn during schooling.

No lungeing is permitted in any of the arenas including the warm-up rings. Please lunge horses on the designated lungeing pads located on the Horse Park near the west and northeast stalls.

## WARM-UP RINGS

During competition days, please cede use of the warm-up rings to riders preparing for upcoming classes. When jumping, standards are cleared with the flags on the right, no reversing of directions. Horses approaching a jump must always be given priority. For your safety and the safety of others, always pass "left shoulder to left shoulder" when traveling opposite directions in the arena. More warm-up ring rules and best practices can be found at <https://practicalhorsemanmag.com/training/warm-up-ring-etiquette>

## ARENAS & FOOTING

Grand Hunter: 250' X 255'; Hunter 2: 150' X 220'; Grand Jumper (covered): 150' X 300'. All have sand footing.

## DOGS

We welcome your dogs at the shows! Keep your dogs and horses safe by always keeping your dogs on leash while on the Horse Park property. We kindly request you pick up after your dog. For their safety, do not let dogs run loose on trails. All dogs are eligible for our Cascade Canine Derby in July!

## RVs, MOTORHOMES, TRAILERS, AND CAMPERS

Submit the [RV Site Request form](#) to request your site. RV sites are available by the week only (the night before schooling day through Sunday day only). Additional nights on either end of the reservation may be available for an additional fee with pre-approval. As hookup sites are limited, preference is given for length of stay, sponsors, reservation date, and size of RV. In the event all the hookup sites are reserved, additional requests will be accepted for non-hookup dry-camping sites.

Full payment is required for confirmed sites. Designated trainers having an account with Cascade Horse Shows may choose to add their personal RV site to their show bill to have us do trainer splits. [All other sites](#) must be pre-paid in advance at the time of confirmation. Charges apply to RV site whether hooked to utilities or not.

Upon arrival, an RV Pass must be obtained from Show Office and displayed. Hookup locations are assigned by us—if assigned a site with a hookup, park only in your designated site.

Tent campers must submit a [Tent Camping Request form](#) to request camping on the Horse Park grounds. Upon arrival, camping passes must be obtained from the Show Office and displayed. Campers must camp in designated areas only. See the Tent Camping Request form for fees.

### MOTORIZED VEHICLES

Minors who do not have a valid driver's license which allows them to operate a motorized vehicle in the state in which they reside will not be permitted to operate a motorized vehicle of any kind, including, but not limited to, golf carts, motorcycles, scooters, or farm utility vehicles, on the competition grounds of licensed competitions. Minors who have a valid temporary license may operate the above-described motorized vehicles as long as they are accompanied by an adult with a valid driver's license. The parent/legal guardian or individual who signs the entry blank as a parent or guardian of a minor operating a motorized vehicle in violation of this rule are solely responsible for any damages, claims, losses, or actions resulting from that operation. Violations of this rule will be cause for penalties against those responsible for the child committing the offense. Wheelchairs and other mobility assistance devices for individuals with disabilities are exempt from this rule. The unsafe use of personal electronic transport devices, as determined by the competition officials and management in their sole discretion, that do not require a driver's license to operate, including but not limited to Segways, hover boards, and single wheeled scooters is prohibited on competition grounds. Operating such devices in areas where people gather may be deemed "unsafe use" if there is a risk of harm to others. If the operator of the device is a minor, the parent/legal guardian or

individual who signs the entry blank as a parent or guardian of a minor operating the device in violation of this rule is accountable and may be subject to penalties. Wheelchairs and other mobility assistance devices for individuals with disabilities are exempt from this rule.

### HELMETS

It is compulsory for all persons at US Equestrian licensed hunter, jumper or hunter/jumper competitions when mounted anywhere on the competition grounds, to wear properly fastened protective headgear which meets or exceeds ASTM (American Society for Testing and Materials)/SEI (Safety Equipment Institute) standards for equestrian use and carries the SEI tag. It must be properly fitted with harness secure

### SAFETY AND WELFARE

The nearest hospital is [Kittitas Valley Healthcare](#) which is 24 miles from the Washinton State Horse Park. The nearest level 1 trauma center is [Harborview Medical Center](#) in Seattle, WA which is 83 miles from the Washington State Horse Park.

### DISCRETIONARY POLICY

**All questions not covered in these rules and regulations shall be decided by Show Management whose decision shall be final.**



OLSON'S IS YOUR PACIFIC NORTHWEST

*Butet Saddle Dealer*



*The Portrait of Performance*



VISIT OUR WEBSITE:

**OLSONSTACK.COM**

CALL OR TEXT:

**425-454-9453**



# CIRCUIT CUP AWARDS

The *Cascade Circuit Cup Awards* are season championships bestowed upon the horses accumulating the most points in one of 5 categories over our rated show season. We recognize that performing well in the arena takes similar courage and commitment, whether competing in the 2' 3" hunters or the 1.30m jumpers (or any height in between).

## HONORING OUR 2021 WINNERS!

*Congratulations to the following horses, riders, and trainers for their outstanding performances in 2021.*

### **JUMPER 1.10M AND UP**

#### *Pimlico*

16.3 Bay Warmblood Gelding

Owner & Rider: Elizabeth Champagne

Trainer: Allison Heidmann,  
Big Sky Equestrian

### **JUMPER UP TO 1.05M**

#### *Newtorius*

16.3 Bay Holsteiner Mare

Owner & Rider: Kelli Webber

Trainer: Shannon Hendrickson,  
Signature West Farms

### **USHJA HUNTER DERBY**

#### *Closing Time*

16.3 Buckskin Dutch Warmblood Gelding

Owner & Rider: Kelsey King

Trainer: Denise Youell, Farpoint Farm

### **HUNTER 3' AND UP**

#### *MTM Check Me Out*

16.1 Bay Warmblood Gelding

Owner & Rider: Mary-Lou Misrahy

Trainer: Shelly Kerron,  
Legacy Hunters & Jumpers

### **HUNTER UP TO 2'9"**

#### *Filibuster*

16.2 Chestnut Thoroughbred Cross  
Gelding

Owner & Rider: Jodi Gearon  
Trainer: Sarah Olmstead, Brass Ring Farm

The Circuit Cup Awards are announced and presented at the conclusion of the Cascade Finals show in September. All horses are eligible. Each winner receives valuable prizes honoring their achievement. We are excited to see who this season's big winners will be. See you in September!

Full Cascade Circuit Cup specifications can be found at [Cascade-Circuit-Cup-Specs.pdf \(cascadehorseshows.com\)](https://www.cascadehorseshows.com/Cascade-Circuit-Cup-Specs.pdf)



*Closing Time and Kelsey King*

SPOTLIGHT CLASSES

# Hunter Derbies

Presented by **Brick Road Farms**

July 15, 2022

**\$1,500 USHJA National Hunter Derby**

*To be run at 3' with 3'5" options*

July 16, 2022

**USHJA Outreach Hunter Derby**

*To be run at 2'6" with 2'9" options*



*Luigi with professional Amanda Gelderman*

## SPOTLIGHT CLASSES

Class #	Class	Height	Entry Fee	Prize Money
3	<b>USHJA National Hunter Derby</b> Presented by BRICK ROAD FARMS	3' with 3'5" options	\$140/class	\$1,500
4	<b>Pacesetter Mini Prix</b> Presented by PACESETTER PROPERTIES TEAM	1.15m	\$150/class	\$2,000
7	<b>Luxury DerbyCross™ 3'-3'3"   1.00m-1.05m</b> Presented by BELUXARI EQ	Hunter course: 3' with 3'3" options, Jumper course: 1.00m-1.05m	\$100/class	\$1,000
10	<b>Junior/Amateur Hunt &amp; Handy</b> Presented by HELITE Equestrian	2'6" with 2'9" options	\$50/class	\$500
16	<b>Rising Stars™ Leadline</b> Presented by KERRITS EQUESTRIAN	N/A	Free	
11	<b>Rosé All Day Amateur Classic</b> Presented by ABSOLUTE HUNTERS & JUMPERS Offered exclusively at the Swiftwater Invitational (week 1)	N/A	\$50/class	
17	<b>Cascade Canine Derby</b> Presented by TBA	Varied	Free	
20	<b>Need for Speed™ Open Jumper 1.10 or 1.20m</b> Presented by VOLTAIRE DESIGN	1.10 or 1.20m	\$75/class	\$750
165	<b>Cascade Welcome 1.20m</b> This class is included in the Jumper 1.20m section	1.20m	\$100/class	\$1,000

**Formal Attire Required** — Salute to Sponsors Requested

See full class specifications here: [Specifications](#) on page 45.



## Vacation Homes & Cabins

Providing Premier Vacation Homes and Cabins for  
Cle Elum, Roslyn, Suncadia Resort, & the Surrounding Areas



**Book Direct and Save**  
**The Longer You Stay**  
**The More You Save**  
CALL 509-649-3099



**[www.GoASVR.com](http://www.GoASVR.com)**

[Info@AllSeasonsVacationRents.com](mailto:Info@AllSeasonsVacationRents.com)

SPOTLIGHT CLASSES

# Rosé All Day Amateur Classic

Presented by **Absolute Hunters & Jumpers**

July 15, 2022

Run in the spirit of a traditional Hunter Hack for all 21 and older amateur riders...  
How much will be left in *your* glass?

*The winner takes home a case of rosé wine, bottles to 8<sup>th</sup> place*  
*Traditional attire encouraged; salute to sponsor requested*



# HUNTER DIVISION

## HUNTER CLASSICS

Class #	Class	Height	Entry Fee	Prize Money
30	<b>Pony Hunter Classic 2'3", 2'6", 2'9"-3'</b> Presented by KAIDYN GRIGGS	2'3", 2'6", 2'9"-3'	\$50/class	\$500
31	<b>Pre-Children's/Adult Hunter Classic 2'9"</b> Presented by NOVELLA FARMS	2'9"	\$50/class	\$250
32	<b>Low Children's/Adult Hunter Classic 2'6"</b> Presented by KERRITS EQUESTRIAN / EQL	2'6"	\$50/class	\$500
33	<b>Children's/Adult Hunter Classic 3'</b> Presented by MAGNOLIA RIDGE FARM	3'	\$50/class	\$500
34	<b>Children's Hunter Pony Classic 2', 2'3", 2'6"</b> Presented by KERRITS EQUESTRIAN / EQL	2', 2'3", 2'6"	\$50/class	\$250
35	<b>Short/Long Stirrup Hunter Classic 2'3"</b> Presented by TIFFANY & EQUESTRIANS	2'3"	\$50/class	\$300
36	<b>Short Stirrup Hunter Pony Classic 18"</b> Presented by KERRITS EQUESTRIAN / EQL	18"	\$50/class	\$300
37	<b>Cascade Classic 2'</b> Presented by KERRITS EQUESTRIAN / EQL	2'	\$50/class	\$250
38	<b>Cascade Classic 2'3"</b> Presented by KERRITS EQUESTRIAN / EQL	2'3"	\$50/class	\$250
39	<b>Cascade Classic 2'6"</b> Presented by KERRITS EQUESTRIAN / EQL	2'6"	\$50/class	\$250
40	<b>Cascade Classic 2'9"</b> Presented by KERRITS EQUESTRIAN / EQL	2'9"	\$50/class	\$250

**Formal Attire Required** — Salute to Sponsors Requested

**Prize Money** — 30%, 25%, 20%, 15%, 10%

All Classics are 2 rounds. The last class of the corresponding division to be the first round of the class. Round 2 to be shown over a course of at least 10 obstacles with at least one combination. Hunter Classic riders must have ridden in at least 2 hunter classes in their division to compete.

## USEF “B”-RATED HUNTER SECTIONS

Class #	Class (Section Code)	Height	Entry Fee	Prize Money
310, 311, 312, 313 <sup>1</sup> , 314 <sup>3</sup>	<b>Performance Hunter 3’6” (C)</b>	3’6”	\$250/section or \$55/class	\$90
315, 316, 317, 318 <sup>1</sup> , 319 <sup>3</sup>	<b>Performance Hunter 3’3” (D)</b>	3’3”	\$250/section or \$55/class	\$75
325, 326, 327, 328 <sup>1</sup> , 329 <sup>3</sup>	<b>Green Hunter 3’6” (F)</b>	3’6”	\$250/section or \$55/class	\$75
330, 331, 332, 333 <sup>1</sup> , 334 <sup>3</sup>	<b>Green Hunter 3’3” (G)</b>	3’3”	\$250/section or \$55/class	\$75
335, 336, 337, 338 <sup>1</sup> , 339 <sup>3</sup>	<b>Green Hunter 3’ (H)</b>	3’	\$250/section or \$55/class	\$75
345, 346, 347, 348, 349 <sup>3</sup>	<b>Young Hunter 3’3” - Horses 7 &amp; Under (J)</b>	3’3”	\$250/section or \$55/class	
350, 351, 352, 353, 354 <sup>3</sup>	<b>Young Hunter 3’ - Horses 6 &amp; Under (K)</b>	3’	\$250/section or \$55/class	
355, 356, 357, 358, 359 <sup>3</sup>	<b>Young Hunter 2’9” - Horses 5 &amp; Under (L)</b>	2’9”	\$250/section or \$55/class	
360, 361, 362, 363 <sup>1</sup> , 364 <sup>3</sup>	<b>Amateur Owner Hunter 18-35 3’6” (P)</b>	3’6”	\$250/section or \$55/class	\$75
365, 366, 367, 368 <sup>1</sup> , 369 <sup>3</sup>	<b>Amateur Owner Hunter 36 &amp; Over 3’6” (M)</b>	3’6”	\$250/section or \$55/class	\$75
370, 371, 372, 373 <sup>1</sup> , 374 <sup>3</sup>	<b>Amateur Owner Hunter 18-35 3’3” (O)</b>	3’3”	\$250/section or \$55/class	\$75
375, 376, 377, 378 <sup>1</sup> , 379 <sup>3</sup>	<b>Amateur Owner Hunter 36 &amp; Over 3’3” (N)</b>	3’3”	\$250/section or \$55/class	\$75
380, 381, 382, 383 <sup>1</sup> , 384 <sup>3</sup>	<b>Junior Hunter 15-17 3’6” (Q)</b>	3’6”	\$250/section or \$55/class	\$75
385, 386, 387, 388 <sup>1</sup> , 389 <sup>3</sup>	<b>Junior Hunter 14 &amp; Under 3’6” (R)</b>	3’6”	\$250/section or \$55/class	\$75
400, 401, 402, 403 <sup>1</sup> , 404 <sup>3</sup>	<b>Junior Hunter 15-17 3’3” (U)</b>	3’3”	\$250/section or \$55/class	\$75
405, 406, 407, 408 <sup>1</sup> , 409 <sup>3</sup>	<b>Junior Hunter 14 &amp; Under 3’3” (V)</b>	3’3”	\$250/section or \$55/class	\$75
410, 411, 412 <sup>3</sup> , 413, 414 <sup>1</sup>	<b>Small Pony Hunter 2’3” (W)</b>	2’3”	\$225/section or \$50/class	\$50
415, 416, 417 <sup>3</sup> , 418, 419 <sup>1</sup>	<b>Medium Pony Hunter 2’6” (X)</b>	2’6”	\$225/section or \$50/class	\$50
420, 421, 422 <sup>3</sup> , 423, 424 <sup>1</sup>	<b>Large Pony Hunter 2’9”-3’ (Y)</b>	2’9”-3’	\$225/section or \$50/class	\$50

Class # footnotes: 1 = Handy; 2 = Stake; 3 = Under Saddle; italics = Conformation

**Green Hunter:** Reference [US Equestrian Rule Book HU](#) for Green Hunter Eligibility and Status. Jog for soundness. Horse may compete in only one green hunter fence height section at any one competition

**Young Hunter:** Reference [US Equestrian Rule Book HU](#) for Young Hunter Eligibility and Status. Not to Jog.

**AO Hunters:** Horses competing in 3’6” AO Hunters may not cross-enter 3’3” AO Hunters

**Junior Hunter:** A large Junior Hunter is over 16.0 hands, and a small Junior Hunter is 16.0 Hands and under. Junior Hunter 3’3” is open to junior riders. Riders may not cross-enter any class at 3’6” or higher in the Hunter division, higher than 3’9” in the Equitation division or higher than 1.20m in the Jumper division at the same competition. Horses entered in the Junior Hunter 3’3” section may not cross-enter the Junior Hunter 3’6” section at the same competition.

**SML Pony Hunter:** Classes 410, 415, and 420 are to be judged 25% Conformation.

**Sections may be combined if fewer than 4 entries in section.**

ALL HUNTER CLASSES WILL BE JUDGED ON PERFORMANCE AND SOUNDNESS UNLESS OTHERWISE NOTED



Ansara Patterson, wife Tracy and daughters Naya and Cayenne.

PHOTO COURTESY PAUL DUDLEY

# Family » Home » Heart

**Ansara Patterson, A Mortgage Professional You Can Trust.**

*Serving all of Washington and Our Veterans*

## **Providing Residential Mortgages:**

- VA • USDA • FHA
- Conventional
- Refinances
- Manufactured

### **Ansara Patterson**

Loan Officer

NMLS ID 90076

Mobile: **206-714-5733**

Email: [ansara@genevafi.com](mailto:ansara@genevafi.com)

Web: [genevafi.com/ansarapatterson](http://genevafi.com/ansarapatterson)

 **GENEVA**  
FINANCIAL  
Home Loans Powered By Humans™



Copyright© 2020 Geneva Financial, LLC, NMLS #42056 • All loans subject to qualifying factors. Not all applicants will qualify. Equal Opportunity Lender and Equal Housing Lender, 3155 S Price Rd Chandler, AZ 85248, 1-888-889-0009, NMLS #42056 BK #0910215



## USEF “C” AND NON-RATED HUNTER SECTIONS

Class #	Class (Section Code)	Height	Entry Fee	Prize Money
425, 426, 427, 428, 429 <sup>3</sup>	<b>Adult Amateur Hunter 18-39 3' (Z)</b>	3'	\$225/section or \$50/class	
430, 431, 432, 433, 434 <sup>3</sup>	<b>Adult Amateur Hunter 40 &amp; Over 3' (AA)</b>	3'	\$225/section or \$50/class	
435, 436, 437, 438, 439 <sup>3</sup>	<b>Children's Hunter 13 &amp; Under 3' (AB)</b>	3'	\$225/section or \$50/class	
440, 441, 442, 443, 444 <sup>3</sup>	<b>Children's Hunter 14-17 3' (AC)</b>	3'	\$225/section or \$50/class	
445, 446, 447, 448, 449 <sup>3</sup>	<b>Children's Hunter Pony 2', 2'3", 2'6" (AD)</b>	2', 2'3", 2'6"	\$225/section or \$50/class	
450, 451, 452, 453, 454 <sup>3</sup>	<b>Small Hunter 3' (AN)</b>	3'	\$225/section or \$50/class	
455, 456, 457, 458, 459 <sup>3</sup>	<b>Thoroughbred Hunter 3' (AE)</b>	3'	\$225/section or \$50/class	
460, 461, 462 <sup>3</sup> , 463, 464	<b>USHJA 2' Hunter (AF)</b>	2'	\$225/section or \$50/class	
465, 466, 467 <sup>3</sup> , 468, 469	<b>USHJA 2'3" Hunter (AG)</b>	2'3"	\$225/section or \$50/class	
470 <sup>3</sup> , 471, 472, 473, 474	<b>USHJA 2'6" Hunter (AH)</b>	2'6"	\$225/section or \$50/class	
475, 476, 477 <sup>3</sup> , 478, 479	<b>USHJA 2'9" Hunter (AI)</b>	2'9"	\$225/section or \$50/class	
480, 481, 482, 483, 484 <sup>3</sup>	<b>USHJA 3' Hunter (AJ)</b>	3'	\$225/section or \$50/class	
500, 501, 502, 503, 504 <sup>3</sup>	<b>Short Stirrup Hunter Horse 17 &amp; Under 2'3" (AK) *</b>	2'3"	\$225/section or \$50/class	
505, 506, 507 <sup>3</sup> , 508, 509	<b>Short Stirrup Hunter Pony 17 &amp; Under 18" (AL) *</b>	18"	\$225/section or \$50/class	
510, 511, 512, 513, 514 <sup>3</sup>	<b>Long Stirrup Hunter 18 &amp; Over 2'3" (AM) *</b>	2'3"	\$225/section or \$50/class	
515, 516, 517, 518, 519 <sup>3</sup>	<b>Large Hunter 3' (AO) *</b>	3'	\$225/section or \$50/class	
520, 521, 522, 523, 524 <sup>3</sup>	<b>Pre-Children's/Adult Hunter 2'9" (AP) *</b>	2'9"	\$225/section or \$50/class	
525, 526, 527 <sup>3</sup> , 528, 529	<b>Low Children's Hunter 2'6" (AQ) *</b>	2'6"	\$225/section or \$50/class	
530, 531, 532 <sup>3</sup> , 533, 534	<b>Low Adult Hunter 2'6" (AS) *</b>	2'6"	\$225/section or \$50/class	
535, 536, 537 <sup>3</sup> , 538, 539	<b>Baby Green Hunter 2'6" (AR) *</b>	2'6"	\$225/section or \$50/class	

Class # footnotes: 1 = Handy; 2 = Stake; 3 = Under Saddle \* Indicates a non-rated class.

**AA Hunter:** To be ridden by amateurs no longer eligible to compete as a Junior. See current [USHJA Zone 9 specifications](#) in this prize list or at [Zone-9 Specifications on USHJA.org](#).

**Ponies** may not cross into any other rated section at the same show. Riders may compete on a maximum of 1 Children's Hunter horse section at the same show and in any class not to exceed 3' (Exception: Pony Jumpers). Green & Regular Hunter Pony riders may compete on a maximum of 1 additional pony in the Children's Hunter Pony section at the same show.

**Small Hunters:** Open to horses over 14.2 hands and not to exceed 16 hands

**Thoroughbred Hunters:** Thoroughbred registration verification required, see [USEF HU 106.8](#)

**USHJA Hunter:** Open to all horses and ponies.

**Short Stirrup:** Rider no cross entry into any other classes except Low Under 3' Short Stirrup Equitation and Short Stirrup Pony or Short Stirrup Horse (as applicable to the class)

**Long Stirrup:** Riders no cross entry into rated classes 3' & up.

**Large Hunter:** Open to Horses Over 16 hands

**Pre-Children's/Adult Hunter:** Rider no cross entry into rated sections or classes with fences 3'6" or higher. May be split by age group if entries warrant.

**Low Children's / Low Adult Hunter:** Please see full [Zone 9 specifications](#) for cross-entry restrictions.

**Baby Green:** Open to horses and ponies in 1st year of showing.

**Sections may be combined if fewer than 4 entries in section.**

ALL HUNTER CLASSES WILL BE JUDGED ON PERFORMANCE AND SOUNDNESS UNLESS OTHERWISE NOTED.

## HUNTER WARM-UP CLASSES (NON-RATED)

Class #	Class	Height	Entry Fee	Prize Money
600	<b>Warm-Up Hunter 18"</b>	18"	\$50/class	
610, 611	<b>Warm-Up Hunter 2'</b>	2'	\$50/class	
615, 616	<b>Warm-Up Hunter 2'3"</b>	2'3"	\$50/class	
620, 621, 622	<b>Warm-Up Hunter 2'6"</b>	2'6"	\$50/class	
630, 631	<b>Warm-Up Hunter 2'9"</b>	2'9"	\$50/class	
635, 636	<b>Warm-Up Hunter 3'</b>	3'	\$50/class	
640, 641	<b>Warm-Up Hunter 3'3"</b>	3'3"	\$50/class	
645, 646	<b>Warm-Up Hunter 3'6"</b>	3'6"	\$50/class	
655	<b>Warm-Up Pony Hunter</b>	Respective heights	\$50/class	

Braiding is optional. Not to jog.

*Owner/rider Kylie Mulligan with Ipswich Van Shuttershof performing in the 2021 Pacific Crest Preview. Photo: Gary Voth*



## USHJA OUTREACH HUNTER CLASSES (NON-RATED)

USEF / USHJA memberships and horse recording are not required.

Class #	Class	Height	Entry Fee	Prize Money
1200	<b>USHJA Outreach Hunter Derby</b>	2'6" with 2'9" options	\$40/class	
1215, 1216, 1217 <sup>3</sup> , 1218	<b>USHJA Outreach Hunters 18"</b>	18"	\$120/section or \$35/class	
1220 <sup>3</sup> , 1221, 1222, 1223	<b>USHJA Outreach Hunters 2'</b>	2'	\$120/section or \$35/class	
1225, 1226, 1227 <sup>3</sup> , 1228	<b>USHJA Outreach Hunters 2'3"</b>	2'3"	\$120/section or \$35/class	
1230 <sup>3</sup> , 1231, 1232, 1233	<b>USHJA Outreach Hunters 2'6"</b>	2'6"	\$120/section or \$35/class	
1235, 1236, 1237 <sup>3</sup> , 1238	<b>USHJA Outreach Hunters 2'9"</b>	2'9"	\$120/section or \$35/class	



For the Farmer in All of Us!™



**THE GRANGE**  
FOR ALL YOUR HORSE NEEDS

Blankets,  
Fly Sheets,  
Feed & Treats,  
Supplements,  
Grooming Supplies,  
and more!

145 NE GILMAN BLVD ISSAQUAH, WA 98027

(425) 392-6469 [www.grangesupply.com](http://www.grangesupply.com) [shop.grangesupply.com](http://shop.grangesupply.com)



SPOTLIGHT CLASSES

# Luxury DerbyCross

Presented by **Beluxari EQ**

Sunday, July 17, 2022

The Cascade DerbyCross™ is a unique combined class challenging the skills of both rider and horse with back-to-back Handy Hunter and Jumper Speed rounds

*Lowest combined score wins*

*\$1,000 distributed 1st through 6th*

*Formal attire required, salute to sponsor requested*



*Kayla Long and Khall Me Luna*

# EQUITATION DIVISION

## EQUITATION SECTIONS

Class #	Class (Section Code)	Height	Entry Fee
700, 701, 702 <sup>3</sup>	<b>Pony Equitation 2'3", 2'6", 2'9"-3' (AT)</b>	2'3", 2'6", 2'9"-3'	\$135/section or \$50/class
703 <sup>3</sup> , 704, 705	<b>Long Stirrup Equitation 2'3" (AU)</b>	2'3"	\$135/section or \$50/class
706 <sup>3</sup> , 707, 708	<b>Short Stirrup Equitation Horse 2'3" (AV)</b>	2'3"	\$135/section or \$50/class
709, 710, 711 <sup>3</sup>	<b>Short Stirrup Equitation Pony 18" (AW)</b>	18"	\$135/section or \$50/class
712, 713, 714 <sup>3</sup>	<b>Children's Pony Equitation 2', 2'3", 2'6" (AX)</b>	2', 2'3", 2'6"	\$135/section or \$50/class
715, 716, 717 <sup>3</sup>	<b>Low Children's Equitation 2'6" (AY)</b>	2'6"	\$135/section or \$50/class
718, 719, 720 <sup>3</sup>	<b>Low Adult Equitation 2'6" (AZ)</b>	2'6"	\$135/section or \$50/class
721, 722, 723 <sup>3</sup>	<b>Pre-Children's/Adult Equitation 2'9" (BA)</b>	2'9"	\$135/section or \$50/class
724, 725, 726 <sup>3</sup>	<b>Adult Equitation 18-39 3' (BB)</b>	3'	\$135/section or \$50/class
727, 728, 729 <sup>3</sup>	<b>Adult Equitation 40 &amp; Over 3' (BC)</b>	3'	\$135/section or \$50/class
730, 731, 732 <sup>3</sup>	<b>Equitation 14 &amp; Under 3' (BD)</b>	3'	\$135/section or \$50/class
733, 734, 735 <sup>3</sup>	<b>Equitation 15-17 3' (BE)</b>	3'	\$135/section or \$50/class

Class # footnotes: 3 = Not to jump

\* Ponies ride respective heights

## USHJA OUTREACH EQUITATION (NON-RATED)

USEF / USHJA memberships and horse recording are not required.

Class #	Class	Height	Entry Fee
1300 <sup>3</sup> , 1301 <sup>3</sup> , 1302 <sup>3</sup> , 1303 <sup>3</sup>	<b>USHJA Outreach Walk, Trot Equitation</b>		\$150/section or \$35/class
1310, 1311, 1312 <sup>3</sup> , 1313, 1314	<b>USHJA Outreach Equitation Crossrail</b>		\$150/section or \$35/class
1315, 1316 <sup>3</sup> , 1317, 1318	<b>USHJA Outreach Equitation 18"</b>	18"	\$120/section or \$35/class
1320, 1321 <sup>3</sup> , 1322, 1323	<b>USHJA Outreach Equitation 2'</b>	2'	\$120/section or \$35/class
1325, 1326 <sup>3</sup> , 1327, 1328	<b>USHJA Outreach Equitation 2'3"</b>	2'3"	\$120/section or \$35/class
1330, 1331 <sup>3</sup> , 1332, 1333	<b>USHJA Outreach Equitation 2'6"</b>	2'6"	\$120/section or \$35/class
1335, 1336 <sup>3</sup> , 1337, 1338	<b>USHJA Outreach Equitation 2'9"</b>	2'6"	\$120/section or \$35/class

Class # footnotes: 3 = Not to jump

Braiding is optional. Not to jog.

## MEDAL CLASSES

Class #	Class	Height	Entry Fee
800	<b>WSHJA Good Hands &amp; Seat 2'6"</b>	2'6"	\$50/class
801	<b>WSHJA Good Hands &amp; Seat 3'</b>	3'	\$50/class
802	<b>WSHJA Good Hands &amp; Seat 3'6"</b>	3'6"	\$50/class
803	<b>ASPCA Maclay Horsemanship Medal 3'6"</b>	3'6"	\$50/class
804	<b>Dover Saddlery/USEF Hunter Seat Medal 3'6"</b>	3'6"	\$50/class
805	<b>Hamel Foundation NHS Medal 3'3"</b>	3'3"	\$50/class
807	<b>USEF/NCEA Junior Hunter Seat Medal 3'3"</b>	3'3"	\$50/class
808	<b>Taylor Harris Insurance National Children's Medal 3'</b>	3'	\$50/class
809	<b>Ariat National Adult Medal 3'</b>	3'	\$50/class
810	<b>Marshall &amp; Sterling U.S. Pony Medal 2'3", 2'6", 2'9"-3'</b>	Respective heights	\$50/class
811	<b>OHJA Mini Medal 2'6"</b>	2'6"	\$50/class
812	<b>OHJA Children's Medal 3'</b>	3'	\$50/class
813	<b>OHJA Adult Medal 3'</b>	3'	\$50/class

**WSHJA Medals:** Open to juniors and amateurs. Riders must be WSHJA members prior to the start of the class.

**ASPCA Maclay:** Open to junior members of USEF or Equine Canada who have not reached their 18th birthday in accordance with GR127. Riders and their trainers or coaches must be current members of the National Horse Show Association ("NHS").

**Dover Saddlery/USEF Hunter Seat:** Open to Individual Junior USEF Members in good standing who have not reached their 18th birthday in accordance with GR127.

**USEF/NCEA:** NCEA membership is not required to ride the class but only NCEA members receive points and will be included in rankings for the finals

**Taylor Harris National Children's Medal:** Riders not to compete in any hunter or equitation class 3'9" or higher, or jumper class set above 1.20m at same show

**Ariat National Adult Medal:** Riders not to compete over jumps that exceed 3'6" or 1.20m or higher at same show.

**Marshall & Sterling U.S. Pony Medal:** tests young riders, judging their ability to compete over a technical and demanding course of fences.

**OHJA Mini Medal:** No cross entry with 3' medals. Riders must be OHJA members prior to the start of the class.

**OHJA Children's Medal:** Riders may not cross-enter into junior hunters, junior jumpers, or any 3'6" medal class at the same show. Riders must be OHJA members prior to the start of the class.

**OHJA Adult Medal:** Riders must be OHJA members prior to the start of the class.



#1

# SHINE SPRAY ON THE MARKET

“ THE QUALITY OF EQUIFUSE SHINE IS SIMPLY

*perfection in a bottle.*

IT'S THE ONLY COAT SHINE SPRAY I TRUST ON MY SENSITIVE MARE. ”



LINDSEY DENOBREGA, EQUIFUSE USER

# JUMPER DIVISION

## JUMPER CLASSICS

Class #	Class	Height	Entry Fee	Prize Money
60	<b>Open Jumper Classic .70m</b>	.70m	\$60/class	\$500
61	<b>Open Jumper Classic .80m</b>	.80m	\$60/class	\$500
62	<b>Open Jumper Classic .90m</b>	.90m	\$60/class	\$500
64	<b>Open Jumper Classic 1.00m</b>	1.00m	\$60/class	\$500
68	<b>High Children's/Adult Amateur Jumper Classic 1.10m</b>	1.10m	\$60/class	\$500

**Formal Attire Required** — Salute to Sponsors Requested

Prize Money — 25%, 23%, 20%, 17%, 15%

Jumper Classic riders must have ridden in at least 1 other class to compete.

*Junior Cayenne Patterson and Caliente competing in the Open Jumper Classic 1.0m during the 2019 Cascade Finals.  
Photo: Gary Voth*



## JUMPER SECTIONS

Class #	Class	Height	Entry Fee	Prize Money
100, 101, 102, 103, 104, 105	<b>Jumper .70m</b>	.70m	\$225/section or \$50/class	
110, 111, 112, 113, 114, 115	<b>Jumper .80m</b>	.80m	\$225/section or \$50/class	
120, 121, 122, 123	<b>Jumper .90m</b>	.90m	\$180/section or \$50/class	
140, 141, 142, 143	<b>Jumper 1.00m</b>	1.00m	\$180/section or \$50/class	
150, 151, 152, 153	<b>Jumper 1.10m</b>	1.10m	\$200/section or \$55/class	\$100
160, 161, 162, 163	<b>Jumper 1.15m</b>	1.15m	\$200/section or \$55/class	\$100
165, 166, 167	<b>Jumper 1.20m</b>	1.20m	\$100/class   \$55/class	\$1,000   \$100
180, 181, 182	<b>PNW 5 Y/O Young Jumper 1.00m</b>	1.00m	\$165/section or \$60/class	
185, 186, 187	<b>PNW 6 Y/O Young Jumper 1.10m</b>	1.10m	\$165/section or \$60/class	
190, 191, 192	<b>PNW 7 Y/O Young Jumper 1.15m</b>	1.15m	\$165/section or \$60/class	
210, 211, 212	<b>Thoroughbred Jumper 1.00m</b>	1.00m	\$135/section or \$50/class	
215, 216, 217	<b>Pony Jumper 1.05m</b>	1.05m	\$135/section or \$50/class	
220, 221, 222, 223 <sup>2</sup>	<b>Mod. Jr/Amateur Jumper 1.15m</b>	1.15m	\$180/section or \$50/class	Stake \$500
225, 226, 227 <sup>2</sup>	<b>Junior/Amateur Jumper 1.20m</b>	1.20m	\$150/section or \$55/class	Stake \$500
230, 231, 232, 233 <sup>2</sup>	<b>Low Adult Amateur Jumper .90m</b>	.90m	\$180/section or \$50/class	Stake \$150
235, 236, 237, 238 <sup>2</sup>	<b>Low Children's Jumper .90m</b>	.90m	\$180/section or \$50/class	Stake \$150
240, 241, 242, 243 <sup>2</sup>	<b>Low Adult Amateur Jumper 1.00m</b>	1.00m	\$180/section or \$50/class	Stake \$150
245, 246, 247, 248 <sup>2</sup>	<b>Low Children's Jumper 1.00m</b>	1.00m	\$180/section or \$50/class	Stake \$150
250, 251, 252, 253	<b>High Adult Amateur Jumper 1.10m</b>	1.10m	\$180/section or \$50/class	
255, 256, 257, 258	<b>High Children's Jumper 1.10m</b>	1.10m	\$180/section or \$50/class	

Class # footnotes: 2 = Stake

**Stake Classes:** Must have ridden in at least one other class in the same section at the same show to ride in any Stake Class

**Class #165** is the Cascade Welcome 1.20m Spotlight class

**PNW Young Jumpers:** Open to jumpers with papers indicating a foaling date the number of years as indicated prior to the current calendar year. WSHJA membership required to qualify for PNW championship. ^ = Clear rounds

**Thoroughbred Jumper:** Thoroughbred registration verification required according to USEF JP 120. Affiliated with the TAKE2 Thoroughbred League. Points count for USEF and TAKE2

**Children's & Adult Amateur** jumper riders may not cross-enter classes with fences over 1.15m

**Low Children's & Low Adult Amateur** horse and rider combinations may not cross-enter the High Children's & High Adult Amateur Jumpers

**High Children's & High Adult Amateur** horse and rider combinations may not cross-enter the Low Children's & Low Adult Amateur Jumpers

Sections may be split by age group if there are more than 5 horses in each section

Vanessa Gardner  
and Windsor  
Royal 1916  
enroute to a  
second-place  
finish in the Need  
for Speed at the  
2021 Alpine  
Preview.



## JUMPER WARM-UP CLASSES (NON-RATED)

Class #	Class	Height	Entry Fee	Prize Money
660	<b>Warm-Up Jumper .70m</b>	.70m	\$50/class	
670	<b>Warm-Up Jumper .80m</b>	.80m	\$50/class	
680	<b>Warm-Up Jumper .90m</b>	.90m	\$50/class	

## USHJA OUTREACH JUMPER CLASSES (NON-RATED)

*USEF / USHJA memberships and horse recording are not required.*

Class #	Class	Height	Entry Fee	Prize Money
1400, 1401, 1402, 1403, 1404, 1405	<b>USHJA Outreach Jumper .60m</b>	.60m	\$180/section or \$35/class	
1410, 1411, 1412, 1413, 1414, 1415	<b>USHJA Outreach Jumper .70m</b>	.70m	\$180/section or \$35/class	
1420, 1421, 1422, 1423, 1424, 1425	<b>USHJA Outreach Jumper .80m</b>	.80m	\$180/section or \$35/class	
1430, 1431, 1432, 1433, 1434, 1435	<b>USHJA Outreach Jumper .90m</b>	.90m	\$180/section or \$35/class	

## SPOTLIGHT CLASSES

# Need for Speed™ Open Jumper Classic

Presented by **Voltaire Design**

July 17, 2022

*\$750.00 prize money to be distributed 1<sup>st</sup> through 8<sup>th</sup>  
The winner receives \$500 in Voltaire Design accessories  
Formal attire required; salute to sponsor requested*

*Danielle Bogardus and Naturelle.*



# CHAMPIONSHIPS OFFERED

## Hunter Section Championships

Performance Hunter 3'6" (C)	Junior Hunter 15-17 3'3" (U)	USHJA 2'6" Hunter (AH)
Performance Hunter 3'3" (D)	Junior Hunter 14 & Under 3'3" (V)Small Pony	USHJA 2'9" Hunter (AI)
Green Hunter 3'6" (F)	Hunter 2'3" (W)	USHJA 3' Hunter (AJ)
Green Hunter 3'3" (G)	Medium Pony Hunter 2'6" (X)	Short Stirrup Hunter Horse 17 & Under 2'3" (AK)
Green Hunter 3' (H)	Large Pony Hunter 2'9"-3' (Y)	Short Stirrup Hunter Pony 17 & Under 18" (AL)
Young Hunter 3'3" - Horses 7 & Under (J)	Adult Amateur Hunter 18-39 3' (Z)	Long Stirrup Hunter 18 & Over 2'3" (AM)
Young Hunter 3' - Horses 6 & Under (K)	Adult Amateur Hunter 40 & Over 3' (AA)Children's	Small Hunter 3' (AN)
Young Hunter 2'9" - Horses 5 & Under (L)	Hunter 13 & Under 3' (AB)	Large Hunter 3' (AO)
Amateur Owner Hunter 36 & Over 3'6" (M)	Children's Hunter 14-17 3' (AC)	Pre-Children's/Adult Hunter 2'9" (AP)
Amateur Owner Hunter 36 & Over 3'3" (N)	Children's Hunter Pony 2', 2'3", 2'6" (AD)	Low Children's Hunter 2'6" (AQ)
Amateur Owner Hunter 18-35 3'3" (O)	Thoroughbred Hunter 3' (AE)	Baby Green Hunter 2'6" (AR)
Amateur Owner Hunter 18-35 3'6" (P)	USHJA 2' Hunter (AF)	Low Adult Hunter 2'6" (AS)
Junior Hunter 15-17 3'6" (Q)	USHJA 2'3" Hunter (AG)	
Junior Hunter 14 & Under 3'6" (R)		

**Hunter Championships:** Hunter champion and reserve will be awarded to two of the four horses scoring the most points over fences. In addition, only these top four horses will receive full points for ribbons won under saddle and half points for ribbons won in model. Points will be awarded 10, 6, 4, 2, 1, ½.

## Equitation Section Championships

Pony Equitation 2'3", 2'6", 2'9"-3' (AT)	Children's Pony Equitation 2', 2'3", 2'6" (AX)	Adult Equitation 18-39 3' (BB)
Long Stirrup Equitation 2'3" (AU)	Low Children's Equitation 2'6" (AY)	Adult Equitation 40 & Over 3' (BC)
Short Stirrup Equitation Horse 2'3" (AV)	Low Adult Equitation 2'6" (AZ)	Equitation 14 & Under 3' (BD)
Short Stirrup Equitation Pony 18" (AW)	Pre-Children's/Adult Equitation 2'9" (BA)	Equitation 15-17 3' (BE)

**Equitation Championships:** points for all classes shall be calculated 10, 6, 4, 2, 1, ½. In the case of a tie for champion or reserve, the winner shall be the entry with the most points over fences. If still tied, the entry with the most points in the equitation flat class will win the tie.

## Jumper Section Championships

Jumper .70m	High Adult Amateur Jumper 1.10m	Low Children's Jumper .90m
Jumper .80m	High Children's Jumper 1.10m	Low Children's Jumper 1.00m
Jumper .90m	Junior/Amateur Jumper 1.20m	Mod. Jr./Amateur Jumper 1.15m
Jumper 1.00m	Low Adult Amateur Jumper .90m	Pony Jumper 1.05m
Jumper 1.10m	Low Adult Amateur Jumper 1.00m	Thoroughbred Jumper 1.00m
Jumper 1.15m		
Jumper 1.20m		

**Jumper Championships:** in jumper championships, points for all classes shall be calculated 10, 6, 4, 2, 1, 1/2. In case of a tie for champion or reserve the tied entries shall remain tied and each receive a ribbon and trophy / prize.

**All:** At least three competitors must compete in the first class of a section for it to run.

**Sections codes** (in parentheses) allow convenient entry into all classes in section.

## SPOTLIGHT CLASSES

# Cascade Welcome 1.20m

July 14, 2022

The \$1,000 Cascade Welcome is a thrilling 1.20m Table II, Sec 2(a/b) jumper class—  
Time first with a jump off; ties to jump off for first place

*\$1,000 prize money distributed 1<sup>st</sup> through 6<sup>th</sup> 30%, 23%, 15%, 12%, 10%, 10%*

*This class counts toward the Jumper 1.30m section championship*

*Traditional attire encouraged; salute to sponsor requested*



*Michelle Bion and Madges Lane Gem*

# SPECIFICATIONS

---

## **Pacesetter Mini Prix, #4**

The Grand Prix held at each Cascade show will be run as a Table II, Sec 2(a/b) — Time first with a jump off; ties to jump off for first place. Order of go will be drawn by Show Management under supervision of the USEF Steward and posted by 2pm the day of the class. Prize money will be distributed as 1<sup>st</sup> 30%, 2<sup>nd</sup> 20%, 3<sup>rd</sup> 14%, 4<sup>th</sup> 10%, 5<sup>th</sup> 8%, 6<sup>th</sup> 7%, 7<sup>th</sup> 6%, 8<sup>th</sup> 5% unless otherwise stated. Horses and riders must have competed in at least one other class in the competition. Formal attire required; salute to sponsors requested. *The Pacesetter Mini Prix is generously presented by Pacesetter Properties Team.*

---

## **USHJA National Hunter Derby, #3**

The USHJA National Hunter Derby features a two-round format with a minimum of two judges utilizing a numerical system to score competitors in the Classic Hunter Round (first round) on performance, hunter pace, jumping style, quality and substance, and movement. A second round will feature a Handy Hunter course designed to reflect brilliance of pace and handiness. In each round, following the judges' base score, one point will be added for each high-option fence jumped; up to a maximum of four high options may be included. Fences are set at 3' with four high-option fences set at 3'5" (June) or 3'3" (July/September). Prize money will be distributed as: 1<sup>st</sup> 30%, 2<sup>nd</sup> 22%, 3<sup>rd</sup> 13%, 4<sup>th</sup> 8%, 5<sup>th</sup> 6%, 6<sup>th</sup> 5%, 7<sup>th</sup> 4%, 8<sup>th</sup>-9<sup>th</sup> 3%, 10<sup>th</sup>-12<sup>th</sup> 2% unless otherwise stated. The top 3 Amateurs/Juniors will also be recognized. Formal attire required; salute to sponsor requested. Full specs can be found in this document and with the United States Hunter Jumper Association. *The Cascade USHJA National Hunter Derby is generously presented by Brick Road Farms.*

---

## **Luxury DerbyCross™, #7**

The Cascade DerbyCross is a unique combined class that challenges the skills of a rider and horse pair to perform in both the Hunter and Jumper disciplines. This class features both a Handy Hunter Derby round and a Jumper Speed round which are ridden back-to-back with no break. The Handy Hunter Derby round will include some natural fences, at least one trot fence and bending line and will be judged on performance, hunter pace, style, quality, and handiness. The Jumper speed round will consist of a minimum of 8 jumps 1.00m with a minimum of one combination and will be judged as Table II.1 (a speed class). The Hunter course will have fences at 3' with 2 high options of 3'3". Riders will ride the Hunter course first, then immediately walk on a designated path to the Jumper course to begin their speed round. Riders MUST stay mounted and MUST walk from one ring to the other having NO interaction with trainers, spectators, or family. Upon entering the Jumper ring, the horse and rider will have 5 seconds before the starting whistle. Once the whistle is blown, the horse and rider must cross the start line within the time allowed or face time penalties. A total of two refusals will constitute elimination. Scoring: points will be assigned to both Hunter and Jumper rounds and added together to determine the winner. Horse and rider must be present to ride for ribbons. Prize money will be distributed as: 1<sup>st</sup> 30%, 2<sup>nd</sup> 23%, 3<sup>rd</sup> 15%, 4<sup>th</sup> 12%, 5<sup>th</sup> 10%, 6<sup>th</sup> 10%. Formal attire required; salute to sponsor requested. Either Hunter or Jumper tack and attire are acceptable. Boots are optional. *The Cascade DerbyCross is generously presented by BELUXARI EQ*

---

## **Cascade Welcome, #165**

The Cascade Welcome held at each Cascade show will be run as a Table II, Sec 2(a/b) — Time first with a jump off; ties to jump off for first place. Order of go will be drawn by Show Management under supervision of the USEF Steward and posted by 2pm the day of the class. Prize money will be distributed as: 1<sup>st</sup> 30%, 2<sup>nd</sup> 23%, 3<sup>rd</sup> 15%, 4<sup>th</sup> 12%, 5<sup>th</sup> 10%, 6<sup>th</sup> 10% unless otherwise stated. This class counts towards the Jumper 1.20m section championship.

---

# SPECIFICATIONS (CONT.)

---

## **Junior/Amateur Hunt & Handy, #10**

In a single round, this class combines a classic Hunter course of 6-8 jumps immediately followed by a Handy course of 4-6 jumps for a total of 12 obstacles. The course will be set at 2'6" with 2'9" options unless otherwise posted. Competitors will be judged on performance, hunter pace, jumping style, quality and substance, movement, and handiness. One point is added to the final score for each high option taken. Prize money to be distributed as 1<sup>st</sup> 30%, 2<sup>nd</sup> 25%, 3<sup>rd</sup> 20%, 4<sup>th</sup> 15%, 5<sup>th</sup> 10%, with ribbons to 8<sup>th</sup>. Formal attire required; salute to sponsor requested. *The Junior/Amateur Hunt & Handy is generously presented by HELITE Equestrian.*

---

## **Rosé All Day Amateur Classic, #11**

Run in the spirit of a traditional Hunter Hack for all 21 & older amateur riders. A Hunter Hack is a type of English pleasure class where exhibitors in Hunt seat tack and attire perform on the flat at a walk, trot, canter, and hand gallop, and then jump two low fences. For this unique variation, riders may be asked to walk, trot, canter, change direction, sit the trot, halt & back up, and jump a cavalletti line, all while holding a glass of "rosé" wine! Class will be pinned on Judges Score adjusted for the "rosé" left in your glass. The winner also takes home a case of (real) rosé wine with bottles of rose' to 8th place. Traditional attire encouraged; salute to sponsor requested. *The Rosé All Day Amateur Classic is generously presented by Absolute Hunters & Jumpers.*

---

## **Rising Stars™ Leadline, #16**

No Fee. Preceding the Pacesetter Mini Prix. Wow the crowd with style and smiles. Prizes to all. Helmet and boots required. *The Rising Stars Leadline is generously presented by presented by KERRITS EQUESTRIAN.*

---

## **Cascade Canine Derby, #17**

A fan-favorite tradition of our July Pacific Crest Open show. Open to all dogs of all sizes and breeds. A team event challenging dogs and their humans over a course of 8 obstacles, with high options. Prizes to 6<sup>th</sup>, smiles for everyone!

---

## **Need For Speed™ Open Jumper, #20**

The Need for Speed Open Jumper will be run as a Table III speed round, with faults converted into seconds. A time limit of 120 seconds will apply, and faults incurred will be penalized by adding four seconds for each occurrence. This class is offered at 1.10m and 1.20m. Entrants must designate which height they intend to compete in at the time they enter. At the 1.10m height a 2 second handicap will be added to each competitor's time. Prize money will be distributed as: 1<sup>st</sup> 30%, 2<sup>nd</sup> 20%, 3<sup>rd</sup> 14%, 4<sup>th</sup> 10%, 5<sup>th</sup> 8%, 6<sup>th</sup> 7%, 7<sup>th</sup> 6%, 8<sup>th</sup> 5% unless otherwise stated. Formal attire required; salute to sponsor requested. *The Need for Speed Open Jumper is generously presented by Voltaire Design.*

---

## **Cascade Hunter Classics, #30-40**

All Classics are two rounds. The final round over fences of the corresponding section is to count as the first round of the respective Classic. Round 2 to be shown over a course of at least 9 obstacles. Hunter Classic horses or ponies must have competed in at least two hunter classes in the corresponding section to compete. Prize money will be distributed as: 1<sup>st</sup> 30%, 2<sup>nd</sup> 25%, 3<sup>rd</sup> 20%, 4<sup>th</sup> 15%, 5<sup>th</sup> 10% unless otherwise stated. Formal attire required; salute to sponsor requested. *Generously presented by KERRITS Equestrian / EQL.*

---

## **Cascade Open Jumper Classics, #60-64**

Jumper Classic riders must have ridden in at least one other class in the corresponding section to compete. Open Jumper Classics are offered at .70m, .80m, .90m and 1.00m. Ribbons to 8<sup>th</sup>, prize money to 5<sup>th</sup>: (30%, 25%, 20%, 15%, 10%).

---

# USHJA NATIONAL HUNTER DERBY SPECIFICATIONS



## Course Requirements Jumps in ALL Rounds

1. Obstacles must simulate those reminiscent of the hunt field and course must offer a variety of Classic jumps with different appearances such as: natural post and rail, stone wall, white board fence or gate, coop, aiken, hedge, oxer, brush, logs, natural foliage.
2. Natural obstacles such as banks and ditches are allowed.
3. A minimum of 2" difference is required for the back element of all oxers.
4. Ground lines are not to exceed 18" in depth from the vertical plane of the jump. For appropriate jumps, no ground line is necessary.
5. The jumpable portion of any fence must be a minimum of 8 feet on its front face.
6. Flat cups may only be used for log fences and in accordance with Federation rules.
7. Distances will not be adjusted for ponies.
8. Fence height 3'0".
9. There must be four option fences set at 3'5".

## First Round: Classic Hunter Course

1. A minimum of ten obstacles must be offered in the Classic Hunter Round.
2. At least one in and out
3. At least one bending line
4. At least one line with an unrelated distance
5. At least one long approach

## Second Round: Handy Hunter Course

1. A minimum of eight obstacles must be offered in the Handy Hunter Round.
2. The course should simulate riding over hunt country and must have a minimum of two handy options, such as: tight turns, different tracks, clever options for jump approaches, pen type obstacles, hand gallop a jump, trot a lowered obstacle not to exceed 2'6" in height, halt and/or back. Gimmicky options are not appropriate.
3. Unless the prize list states that more than 12 entries are to return for the second round, then only the top 12 horses from the first round, after all ties are broken, are eligible to return for the second round.

## Class Specifications

1. All riders in the top twelve overall (or their designated representative if not available) must ride for ribbons to receive prize money. Although not required, a show may choose to award separate ribbons for the first-round if so stated in the prize list.

2. For National Hunter Derby zone HOTY bonus points to be awarded, riders must complete a USHJA Exhibitor Declaration Form. If the Exhibitor Declaration Form is not completed and submitted to the show office at the time of entry or at least one hour prior to the start of the class, riders will not receive zone HOTY bonus points for the National Hunter Derby.
3. Points accrued by horses shown by Professionals may be awarded to the declared Green Hunter 3' or 3'3" section or Performance Hunter 3'3" or Small Hunter.
4. Points accrued by horses shown by Juniors or Amateurs may be awarded to the declared Green 3' or 3'3" section, Performance Hunter 3'3", or the applicable Children's, Pony, Adult Amateur or Amateur Owner 3'3", Small Hunter, or Junior Hunter 3'3".

## Judging System

1. First Round - Judged on performance, hunter pace, jumping style, quality and substance, and movement. After the judge's base score is given, one point will be added for each high option fence jumped. The Option Bonus Score of one additional point must be awarded even if there is a refusal, rail down or loss of good jumping style at that higher height option fence, providing that the horse-and-rider combination does jump the higher height option fence. (Maximum of four points.)
2. Second Round - Judged on performance, hunter pace, jumping style, quality and substance, movement, handiness, and brilliance of pace. Handiness is defined as ground saving movement without adversely affecting performance or style. Brilliance of pace is defined as a faster pace than ordinary, without sacrificing performance or style. Handiness is considered in the judges' base score. After the judges' base score is given, one point will be added for each high option fence jumped. The Option Bonus Score of one additional point must be awarded even if there is a refusal, rail down or loss of good jumping style at that higher height option fence, providing that the horse-and-rider combination. (Maximum of four points.)

## Membership Requirements

1. Riders, owners, and trainers must be a current Active member of USEF and USHJA to participate in this class. (see GR202).
2. Horses and ponies must be registered with USHJA to participate in this class. Exception: Foreign residents and horses and ponies in good standing with their National Federation are eligible to compete in this class.
3. USHJA Zone HOTY bonus points will only be awarded if the owner is a current Active member of USEF, has completed a USHJA Exhibitor Declaration Form and the horse is recorded with USEF and registered with USHJA.

For Full USHJA National Hunter Derby Specifications see: <https://ushja.org/competition/hunter/national-hunter-derby>



## Excited to be a Sponsor & Vendor at Cascade's Cle Elum Shows!



2221 NE 3rd St · Bend, Oregon · 541-388-3855 · [www.TheAbsoluteHorse.com](http://www.TheAbsoluteHorse.com) · [AbsoluteHorse@gmail.com](mailto:AbsoluteHorse@gmail.com)

# much more than just a feed store

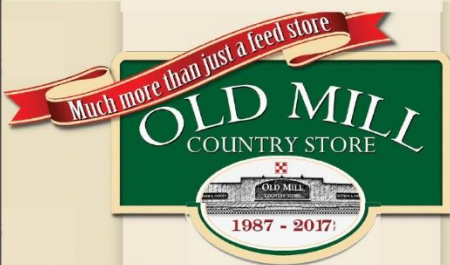

Open 7 Days A Week  
509-925-5397 • 500 W. Third

Whether it's for commercial use or for the animals in your back yard, let our knowledgeable staff help find you the right product to keep your animals healthy and happy.



Old Mill Country Store is your total source supplier of cutting edge animal health and nutrition products





# PACIFIC CREST OPEN

July 13-17, 2022

USEF #332619

# SCHEDULES: PACIFIC CREST OPEN

July 13-17, 2022

## 2022 Pacific Crest Open

Wednesday, July 13, 2022

### Grand Hunter Arena

*Presented by Ariat International*

#### 8:00 AM

645	Warm-Up Hunter 3'6"
325, 326	Green Hunter 3'6"
310, 311	Performance Hunter 3'6"
640	Warm-Up Hunter 3'3"
315, 316	Performance Hunter 3'3"
330, 331	Green Hunter 3'3"
345, 346	Young Hunter 3'3" - Horses 7 & Under
635	Warm-Up Hunter 3'
335, 336	Green Hunter 3'
350, 351	Young Hunter 3' - Horses 6 & Under
450, 451	Small Hunter 3'
515, 516	Large Hunter 3'
480, 481	USHJA 3' Hunter
455, 456	Thoroughbred Hunter 3'
630	Warm-Up Hunter 2'9"
355, 356	Young Hunter 2'9" - Horses 5 & Under
475, 476	USHJA 2'9" Hunter
477	USHJA 2'9" Hunter U/S
470	USHJA 2'6" Hunter U/S
620	Warm-Up Hunter 2'6"
471, 472	USHJA 2'6" Hunter
535, 536	Baby Green Hunter 2'6"
615	Warm-Up Hunter 2'3"
465, 466	USHJA 2'3" Hunter
467	USHJA 2'3" Hunter U/S
610	Warm-Up Hunter 2'
460, 461	USHJA 2' Hunter
462	USHJA 2' Hunter U/S

### Cascade Hunter Arena

*Presented by Legacy Hunters & Jumpers*

#### 8:00 AM

### Grand Jumper Arena

*Presented by Farpoint Farm in honor of Kona Coast*

#### 8:00 AM

660	Warm-Up Jumper .70m IV.1
100	Jumper .70m II.2b
670	Warm-Up Jumper .80m IV.1
110	Jumper .80m II.2b
680	Warm-Up Jumper .90m IV.1
120	Jumper .90m II.2b
140	Jumper 1.00m II.2b
210	Thoroughbred Jumper 1.00m II.2b
180	PNW 5 Y/O Young Jumper 1.00m II.2b
150	Jumper 1.10m II.2b
185	PNW 6 Y/O Young Jumper 1.10m II.2b
250	High Adult Amateur Jumper 1.10m II.2b
255	High Children's Jumper 1.10m II.2b
160	Jumper 1.15m II.2b
190	PNW 7 Y/O Young Jumper 1.15m II.2b
220	Mod. Jr/Amateur Jumper 1.15m II.2b
225	Junior/Amateur Jumper 1.20m II.2b

# 2022 Pacific Crest Open

Thursday, July 14, 2022

## Grand Hunter Arena

*Presented by Ariat International*

### 8:00 AM

- 327 Green Hunter 3'6"
- 328 Green Hunter 3'6" Handy
- 312 Performance Hunter 3'6"
- 313 Performance Hunter 3'6" Handy
- 314 Performance Hunter 3'6" U/S
- 329 Green Hunter 3'6" U/S
- 317 Performance Hunter 3'3"
- 318 Performance Hunter 3'3" Handy
- 347, 348 Young Hunter 3'3" - Horses 7 & Under
- 332 Green Hunter 3'3"
- 333 Green Hunter 3'3" Handy
- 319 Performance Hunter 3'3" U/S
- 349 Young Hunter 3'3" - Horses 7 & Under U/S
- 334 Green Hunter 3'3" U/S
- 337 Green Hunter 3'
- 338 Green Hunter 3' Handy
- 352, 353 Young Hunter 3' - Horses 6 & Under
- 452, 453 Small Hunter 3'
- 517, 518 Large Hunter 3'
- 482, 483 USHJA 3' Hunter
- 457, 458 Thoroughbred Hunter 3'
- 339 Green Hunter 3' U/S
- 454 Small Hunter 3' U/S
- 519 Large Hunter 3' U/S
- 484 USHJA 3' Hunter U/S
- 459 Thoroughbred Hunter 3' U/S
- 354 Young Hunter 3' - Horses 6 & Under U/S
- 357, 358 Young Hunter 2'9" - Horses 5 & Under
- 478, 479 USHJA 2'9" Hunter
- 40 Cascade Classic 2'9"
- 359 Young Hunter 2'9" - Horses 5 & Under U/S
- 537 Baby Green Hunter 2'6" U/S
- 473, 474 USHJA 2'6" Hunter
- 39 Cascade Classic 2'6"
- 538, 539 Baby Green Hunter 2'6"
- 468, 469 USHJA 2'3" Hunter
- 38 Cascade Classic 2'3"
- 463, 464 USHJA 2' Hunter
- 37 Cascade Classic 2'

### 17 Cascade Canine Derby

Presented by TBA

## Cascade Hunter Arena

*Presented by Legacy Hunters & Jumpers*

### 8:00 AM

- 1235, 1236 USHJA Outreach Hunters 2'9"
- 1237 USHJA Outreach Hunters 2'9" U/S
- 1230 USHJA Outreach Hunters 2'6" U/S
- 1231, 1232 USHJA Outreach Hunters 2'6"
- 1225, 1226 USHJA Outreach Hunters 2'3"
- 1227 USHJA Outreach Hunters 2'3" U/S
- 1220 USHJA Outreach Hunters 2' U/S
- 1221, 1222 USHJA Outreach Hunters 2'
- 1215, 1216 USHJA Outreach Hunters 18"
- 1217 USHJA Outreach Hunters 18" U/S

## Grand Jumper Arena

*Presented by Farpoint Farm in honor of Kona Coast*

### 8:00 AM

- 1400 USHJA Outreach Jumper .60m II.2b
- 1401 USHJA Outreach Jumper .60m IV.1
- 1410 USHJA Outreach Jumper .70m II.2b
- 1411 USHJA Outreach Jumper .70m IV.1
- 101 Jumper .70m II.2b
- 102 Jumper .70m IV.2
- 1420 USHJA Outreach Jumper .80m II.2b
- 1421 USHJA Outreach Jumper .80m IV.1
- 111 Jumper .80m II.2b
- 112 Jumper .80m II.1
- 1430 USHJA Outreach Jumper .90m II.2c
- 1431 USHJA Outreach Jumper .90m II.2d
- 121 Jumper .90m II.2c
- 230 Low Adult Amateur Jumper .90m II.2d
- 235 Low Children's Jumper .90m II.2d
- 141 Jumper 1.00m II.2a/b
- 211 Thoroughbred Jumper 1.00m II.2d
- 181 PNW 5 Y/O Young Jumper 1.00m II.2d
- 240 Low Adult Amateur Jumper 1.00m II.2d
- 245 Low Children's Jumper 1.00m II.2d
- 215 Pony Jumper 1.05m II.2d
- 151 Jumper 1.10m II.2c
- 186 PNW 6 Y/O Young Jumper 1.10m II.2d
- 251 High Adult Amateur Jumper 1.10m II.2d
- 256 High Children's Jumper 1.10m II.2d
- 161 Jumper 1.15m II.2c
- 191 PNW 7 Y/O Young Jumper 1.15m II.2d
- 221 Mod. Jr/Amateur Jumper 1.15m II.2d
- 166 Jumper 1.20m II.2c
- 226 Junior/Amateur Jumper 1.20m II.2d
- 165 Cascade Welcome 1.20m II.2a/b**

# 2022 Pacific Crest Open

Friday, July 15, 2022

## Grand Hunter Arena

*Presented by Ariat International*

### 8:00 AM

- 636 Warm-Up Hunter 3'
- 730, 731 Equitation 14 & Under 3' O/F
- 733, 734 Equitation 15-17 3' O/F
- 724, 725 Adult Equitation 18-39 3' O/F
- 727, 728 Adult Equitation 40 & Over 3' O/F
- 732 Equitation 14 & Under 3' Not to jump
- 735 Equitation 15-17 3' Not to jump
- 726 Adult Equitation 18-39 3' Not to jump
- 729 Adult Equitation 40 & Over 3' Not to jump
- 801 WSHJA Good Hands & Seat 3'
- 641 Warm-Up Hunter 3'3"
- 370, 371 Amateur Owner Hunter 18-35 3'3"
- 375, 376 Amateur Owner Hunter 36 & Over 3'3"
- 405, 406 Junior Hunter 14 & Under 3'3"
- 400, 401 Junior Hunter 15-17 3'3"
- 807 USEF/NCEA Junior Hunter Seat Medal 3'3"
- 646 Warm-Up Hunter 3'6"
- 360, 361 Amateur Owner Hunter 18-35 3'6"
- 365, 366 Amateur Owner Hunter 36 & Over 3'6"
- 385, 386 Junior Hunter 14 & Under 3'6"
- 380, 381 Junior Hunter 15-17 3'6"
- 802 WSHJA Good Hands & Seat 3'6"
- 631 Warm-Up Hunter 2'9"
- 721, 722 Pre-Children's/Adult Equitation 2'9" O/F
- 723 Pre-Children's/Adult Equitation 2'9" Not to jump
- 621 Warm-Up Hunter 2'6"
- 715, 716 Low Children's Equitation 2'6" O/F
- 718, 719 Low Adult Equitation 2'6" O/F
- 800 WSHJA Good Hands & Seat 2'6"
- 717 Low Children's Equitation 2'6" Not to jump
- 720 Low Adult Equitation 2'6" Not to jump
- 655 Warm-Up Pony Hunter (respective heights)
- 700, 701 Pony Equitation 2'3", 2'6", 2'9"-3' O/F (respective heights)
- 702 Pony Equitation 2'3", 2'6", 2'9"-3' Not to jump

### 11 Rosé All Day Amateur Classic

*Presented by ABSOLUTE HUNTERS & JUMPERS*

### 3 USHJA National Hunter Derby

*Presented by BRICK ROAD FARMS*

## Cascade Hunter Arena

*Presented by Legacy Hunters & Jumpers*

### 8:00 AM

- 1238 USHJA Outreach Hunters 2'9"
- 1335 USHJA Outreach Equitation 2'9" O/F
- 1336 USHJA Outreach Equitation 2'9" Not to jump
- 622 Warm-Up Hunter 2'6"
- 712, 713 Children's Pony Equitation 2'6" O/F
- 714 Children's Pony Equitation 2', 2'3", 2'6" Not to jump
- 1233 USHJA Outreach Hunters 2'6"
- 1330 USHJA Outreach Equitation 2'6" O/F
- 1331 USHJA Outreach Equitation 2'6" Not to jump
- 706 Short Stirrup Equitation Horse 2'3" Not to jump
- 703 Long Stirrup Equitation 2'3" Not to jump
- 616 Warm-Up Hunter 2'3"
- 707, 708 Short Stirrup Equitation Horse 2'3" O/F
- 704, 705 Long Stirrup Equitation 2'3" O/F
- 712, 713 Children's Pony Equitation 2'3" O/F
- 1228 USHJA Outreach Hunters 2'3"
- 1325 USHJA Outreach Equitation 2'3" O/F
- 1326 USHJA Outreach Equitation 2'3" Not to jump
- 611 Warm-Up Hunter 2'
- 712, 713 Children's Pony Equitation 2' O/F
- 1223 USHJA Outreach Hunters 2'
- 1320 USHJA Outreach Equitation 2' O/F
- 1321 USHJA Outreach Equitation 2' Not to jump
- 600 Warm-Up Hunter 18"
- 709, 710 Short Stirrup Equitation Pony 18" O/F
- 1218 USHJA Outreach Hunters 18"
- 1315 USHJA Outreach Equitation 18" O/F
- 1316 USHJA Outreach Equitation 18" Not to jump
- 711 Short Stirrup Equitation Pony 18" Not to jump
- 1310, 1311 USHJA Outreach Equitation Crossrail O/F
- 1312 USHJA Outreach Equitation Crossrail Not to jump
- 1300, 1301 USHJA Outreach Walk, Trot Equitation Not to jump

## Grand Jumper Arena

*Presented by Farpoint Farm in honor of Kona Coast*

### 8:00 AM

- 1402 USHJA Outreach Jumper .60m II.2b
- 1403 USHJA Outreach Jumper .60m II.1
- 103 Jumper .70m II.2b
- 104 Jumper .70m II.1
- 1412 USHJA Outreach Jumper .70m II.2b
- 1413 USHJA Outreach Jumper .70m II.1
- 113 Jumper .80m II.2b
- 114 Jumper .80m II.1
- 1422 USHJA Outreach Jumper .80m II.2b
- 1423 USHJA Outreach Jumper .80m II.1
- 122 Jumper .90m II.2b
- 231 Low Adult Amateur Jumper .90m II.1
- 236 Low Children's Jumper .90m II.1
- 1432 USHJA Outreach Jumper .90m II.2b
- 1433 USHJA Outreach Jumper .90m II.1
- 142 Jumper 1.00m II.1
- 212 Thoroughbred Jumper 1.00m II.1
- 182 PNW 5 Y/O Young Jumper 1.00m II.2b
- 241 Low Adult Amateur Jumper 1.00m II.1
- 246 Low Children's Jumper 1.00m II.1
- 216 Pony Jumper 1.05m II.2b
- 152 Jumper 1.10m II.2b
- 187 PNW 6 Y/O Young Jumper 1.10m II.2b
- 252 High Adult Amateur Jumper 1.10m II.2b
- 257 High Children's Jumper 1.10m II.1
- 162 Jumper 1.15m II.1
- 192 PNW 7 Y/O Young Jumper 1.15m II.2b
- 222 Mod. Jr/Amateur Jumper 1.15m II.2b

# 2022 Pacific Crest Open

Saturday, July 16, 2022

## Grand Hunter Arena

*Presented by Ariat International*

### 8:00 AM

- 372 Amateur Owner Hunter 18-35 3'3"
- 373 Amateur Owner Hunter 18-35 3'3" Handy
- 377 Amateur Owner Hunter 36 & Over 3'3"
- 378 Amateur Owner Hunter 36 & Over 3'3" Handy
- 374 Amateur Owner Hunter 18-35 3'3" U/S
- 379 Amateur Owner Hunter 36 & Over 3'3" U/S
- 407 Junior Hunter 14 & Under 3'3"
- 408 Junior Hunter 14 & Under 3'3" Handy
- 402 Junior Hunter 15-17 3'3"
- 403 Junior Hunter 15-17 3'3" Handy
- 805 Hamel Foundation NHS Medal 3'3"
- 409 Junior Hunter 14 & Under 3'3" U/S
- 404 Junior Hunter 15-17 3'3" U/S
- 362 Amateur Owner Hunter 18-35 3'6"
- 363 Amateur Owner Hunter 18-35 3'6" Handy
- 367 Amateur Owner Hunter 36 & Over 3'6"
- 368 Amateur Owner Hunter 36 & Over 3'6" Handy
- 364 Amateur Owner Hunter 18-35 3'6" U/S
- 369 Amateur Owner Hunter 36 & Over 3'6" U/S
- 387 Junior Hunter 14 & Under 3'6"
- 388 Junior Hunter 14 & Under 3'6" Handy"
- 382 Junior Hunter 15-17 3'6"
- 383 Junior Hunter 15-17 3'6" Handy
- 803 ASPCA Maclay Horsemanship Medal 3'6"
- 804 Dover Saddlery/USEF Hunter Seat Medal 3'6"
- 389 Junior Hunter 14 & Under 3'6" U/S
- 384 Junior Hunter 15-17 3'6" U/S
- 425, 426 Adult Amateur Hunter 18-39 3'
- 430, 431 Adult Amateur Hunter 40 & Over 3'
- 809 Ariat National Adult Medal 3'
- 813 OHJA Adult Medal 3'
- 435, 436 Children's Hunter 13 & Under 3'
- 440, 441 Children's Hunter 14-17 3'
- 808 Taylor Harris Insurance National Children's Medal 3'
- 812 OHJA Children's Medal 3'
- 520, 521 Pre-Children's/Adult Hunter 2'9"
- 525, 526 Low Children's Hunter 2'6"
- 530, 531 Low Adult Hunter 2'6"
- 811 OHJA Mini Medal 2'6"
- 527 Low Children's Hunter 2'6" U/S
- 532 Low Adult Hunter 2'6" U/S
- 810 Marshall & Sterling U.S. Pony Medal 2'3", 2'6", 2'9"-3' (respective heights)
- 420, 421 Large Pony Hunter 2'9"-3'
- 422 Large Pony Hunter 2'9"-3' U/S

- 415, 416 Medium Pony Hunter 2'6"
- 417 Medium Pony Hunter 2'6" U/S
- 410, 411 Small Pony Hunter 2'3"
- 412 Small Pony Hunter 2'3" U/S

## Cascade Hunter Arena

*Presented by Legacy Hunters & Jumpers*

### 8:00 AM

- 1337, 1338 USHJA Outreach Equitation 2'9" O/F
- 445, 446 Children's Hunter Pony 2'6"
- 1332, 1333 USHJA Outreach Equitation 2'6" O/F
- 500, 501 Short Stirrup Hunter Horse 17 & Under 2'3"
- 510, 511 Long Stirrup Hunter 18 & Over 2'3"
- 445, 446 Children's Hunter Pony 2'3"
- 1327, 1328 USHJA Outreach Equitation 2'3" O/F
- 445, 446 Children's Hunter Pony 2'
- 1322, 1323 USHJA Outreach Equitation 2' O/F
- 505, 506 Short Stirrup Hunter Pony 17 & Under 18"
- 1317, 1318 USHJA Outreach Equitation 18" O/F
- 1313, 1314 USHJA Outreach Equitation Crossrail O/F
- 1302, 1303 USHJA Outreach Walk, Trot Equitation Not to jump
- 1200 USHJA Outreach Hunter Derby

## Grand Jumper Arena

*Presented by Farpoint Farm in honor of Kona Coast*

### 8:00 AM

- 1404 USHJA Outreach Jumper .60m II.2b
- 1405 USHJA Outreach Jumper .60m IV.1
- 105 Jumper .70m II.2b
- 60 Open Jumper Classic .70m II.1
  
- 1414 USHJA Outreach Jumper .70m II.2b
- 1415 USHJA Outreach Jumper .70m II.1
- 115 Jumper .80m II.1
- 61 Open Jumper Classic .80m II.2b
  
- 1424 USHJA Outreach Jumper .80m II.2b
- 1425 USHJA Outreach Jumper .80m IV.1
- 123 Jumper .90m II.2b
- 232 Low Adult Amateur Jumper .90m II.1
- 237 Low Children's Jumper .90m II.1
- 1434 USHJA Outreach Jumper .90m II.2b
- 1435 USHJA Outreach Jumper .90m II.1
- 143 Jumper 1.00m II.2b
- 242 Low Adult Amateur Jumper 1.00m II.1
- 247 Low Children's Jumper 1.00m II.1
- 217 Pony Jumper 1.05m II.1
- 153 Jumper 1.10m II.2b
- 253 High Adult Amateur Jumper 1.10m II.2b
- 258 High Children's Jumper 1.10m II.2b
- 163 Jumper 1.15m II.2b
- 223 Mod. Jr./Amateur Jumper 1.15m II.1
- 167 Jumper 1.20m II.2b
- 227 Junior/Amateur Jumper 1.20m II.1
- 16 Rising Stars™ Leadline**  
Presented by KERRITS EQUESTRIAN
- 4 Pacesetter Mini Prix II.2b**  
Presented by PACESETTER PROPERTIES TEAM

# 2022 Pacific Crest Open

Sunday, July 17, 2022

## Grand Hunter Arena

*Presented by Ariat International*

### 8:00 AM

- 7** **Luxury DerbyCross™ 3'-3'3"**  
Presented by BELUXARI EQ
- 427, 428 Adult Amateur Hunter 18-39 3'  
432, 433 Adult Amateur Hunter 40 & Over 3'  
437, 438 Children's Hunter 13 & Under 3'  
442, 443 Children's Hunter 14-17 3'  
33 Children's/Adult Hunter Classic 3'  
429 Adult Amateur Hunter 18-39 3' U/S  
434 Adult Amateur Hunter 40 & Over 3' U/S  
439 Children's Hunter 13 & Under 3' U/S  
444 Children's Hunter 14-17 3' U/S  
522, 523 Pre-Children's/Adult Hunter 2'9"  
31 Pre-Children's/Adult Hunter Classic 2'9"  
524 Pre-Children's/Adult Hunter 2'9" U/S
- 10** **Junior/Amateur Hunt & Handy**  
Presented by HELITE Equestrian
- 528, 529 Low Children's Hunter 2'6"  
533, 534 Low Adult Hunter 2'6"  
32 Low Children's/Adult Hunter Classic 2'6"  
423 Large Pony Hunter 2'9"-3'  
424 Large Pony Hunter 2'9"-3' Handy  
418 Medium Pony Hunter 2'6"  
419 Medium Pony Hunter 2'6" Handy  
413 Small Pony Hunter 2'3"  
414 Small Pony Hunter 2'3" Handy  
30 Pony Hunter Classic 2'3", 2'6", 2'9"-3' (respective heights)

## Cascade Hunter Arena

*Presented by Legacy Hunters & Jumpers*

### 8:00 AM

- 447, 448 Children's Hunter Pony 2'6"  
34 Children's Hunter Pony Classic 2'6"  
502, 503 Short Stirrup Hunter Horse 17 & Under 2'3"  
512, 513 Long Stirrup Hunter 18 & Over 2'3"  
35 Short/Long Stirrup Hunter Classic 2'3"  
504 Short Stirrup Hunter Horse 17 & Under 2'3" U/S  
514 Long Stirrup Hunter 18 & Over 2'3" U/S  
447, 448 Children's Hunter Pony 2'3"  
34 Children's Hunter Pony Classic 2'3"  
447, 448 Children's Hunter Pony 2'  
34 Children's Hunter Pony Classic 2'  
449 Children's Hunter Pony 2', 2'3", 2'6" U/S  
507 Short Stirrup Hunter Pony 17 & Under 18" U/S  
508, 509 Short Stirrup Hunter Pony 17 & Under 18"  
36 Short Stirrup Hunter Pony Classic 18"

## Grand Jumper Arena

*Presented by Farpoint Farm in honor of Kona Coast*

### 8:00 AM

- 7** **Luxury DerbyCross™ 1.00m-1.05m**  
Presented by BELUXARI EQ
- 68 High Children's/Adult Amateur Jumper Classic 1.10m III
- 20** **Need for Speed™ Open Jumper 1.10m III**  
Presented by VOLTAIRE DESIGN
- 20** **Need for Speed™ Open Jumper 1.20m III**  
Presented by VOLTAIRE DESIGN
- 64 Open Jumper Classic 1.00m III  
243 Low Adult Amateur Jumper 1.00m Stake II.2b  
248 Low Children's Jumper 1.00m Stake II.2b  
62 Open Jumper Classic .90m III  
233 Low Adult Amateur Jumper .90m Stake II.2b  
238 Low Children's Jumper .90m Stake II.2b



# Outreach Entry for 2022 Pacific Crest Open July 13-17

Closing Date of Entries: June 28, 2022

Owner			Rider One			Trainer		
Horse Owner Name			Rider Name			Trainer Name		
Address			Address			Farm/Business Name		
City	State/Province	Zip/PC	City	State/Province	Zip/PC	Address		
Date of Birth			USEF Age	ASPCA #	Zip/PC	City		
Phone			USEF #	USHJA #	USHJA #	State/Province		
Email			Email			USEF #		
Email			Email			USHJA #		
Email			Email			Email		
Recipient of Prize Money Awards								
Individual or Corporation Name			Rider Name			Rider Two		
Social Security # or Federal Tax ID #			Address			Address		
Address			City			State/Province		
City			Date of Birth			USEF Age		
Phone			Phone			USEF #		
Email			Email			USEF #		
Email			Email			USEF #		
Horse								
Horse Name			Breed			Is Pony?		
USEF #			Age			Height		
USHJA #			Color			Sex		
Non-Showing?			Jockey Club Registry #			Measurement Card #		
Sunday Slay-over?			Size			Green Status		
<input type="checkbox"/> Hunter competition <input type="checkbox"/> Jumper competition (Prefer to be Stabled With (if other than Trainer))								
Entry Agreement (sign all other releases at CascadeHorseShows.com)								
<p><b>USHJA Outreach Entry Agreement</b></p> <p><b>ENTRY AGREEMENT - Release, Assumption of Risk, Waiver, and Indemnification.</b> This document waives important legal rights. Read it carefully before signing. I AGREE in consideration for my participation in this Competition to the following: I AGREE that the "Competition" as used herein includes the USHJA and Competition Management, as well as all of their officials, officers, directors, employees, agents, personnel, volunteers and affiliates. I AGREE that I choose to participate voluntarily in the Competition with my horse, as a rider, handler, longeur, lessee, owner, agent, coach, trainer, or as parent or guardian of a junior exhibitor. I am fully aware and acknowledge that horse sports and the Competition involve inherent dangerous risks of accident, loss, and serious bodily injury including broken bones, head injuries, trauma, pain, suffering, or death. ("Harm"). I AGREE to hold harmless and release the USHJA and the Competition from all claims for money damages or otherwise for any Harm to me or my horse and for any Harm of any nature caused by me or my horse to others, even if the Harm arises or results, directly or indirectly, from the negligence of the USHJA or the Competition. I AGREE to expressly assume all risks of Harm to me or my horse, including Harm resulting from the negligence of the USHJA or the Competition. I AGREE to indemnify (that is, to pay any losses, damages, or costs incurred by) the USHJA and the Competition and to hold them harmless with respect to claims for Harm to me or my horse, and for claims made by others for any Harm caused by me or my horse while at the Competition. I understand that I am entitled to wear protective equipment without penalty, and I acknowledge that the USHJA strongly encourages me to do so while WARNING that no protective equipment can guard against all injuries. If I am a parent or guardian of a junior exhibitor, I consent to the child's participation and AGREE to all of the above provisions and AGREE to assume all of the obligations of this release on the child's behalf. I represent that I have the requisite training, coaching and abilities to safely compete in this competition.</p> <p>BY SIGNING BELOW, I AGREE to be bound by the terms and provisions of this entry blank and all terms submitting this Agreement.</p>								
<p><b>USHJA fee \$2</b></p> <p>Credit Card # - 3.5% convenience fee per transaction will be added for CC use.</p> <p>CC Exp Date      CCV #      Zip/PC</p> <p>Name on Card (please print)</p> <p>Billing Address</p> <p>Signature Authorizing Payment</p>								
<p><b>\$340 Competition Deposit Required per Show</b></p> <p>NON REFUNDABLE After Close Date</p>								
Owner/Agent			Rider			Trainer		
Signature (Parent/Guardian required if minor)			Rider One Signature (Parent/Guardian required if minor)			Signature		
Print Name			Rider Two Signature (Parent/Guardian required if minor)			Print Name		
Checks payable to: Cascade Horse Shows Cascade Horse Shows, 311 Avenue C, Snohomish, WA 98290   <a href="http://www.cascadehorsheshows.com">www.cascadehorsheshows.com</a>			Pre-order on website: <a href="http://Shavings/Hay/Feed/">Shavings/Hay/Feed/</a> , request RV Site, Golf Car Show Secretary: Lauren Wasserman   360.573.4360   <a href="mailto:office@cascadehorsheshows.com">office@cascadehorsheshows.com</a>					



## RELEASE OF LIABILITY FOR PROPERTY DAMAGE, PERSONAL INJURY OR DEATH

I **choose to participate voluntarily** in Equine Activities, as that term is defined in the [Revised Code of Washington \(RCW\) 4.24.530\(2\)](#), at the **Washington State Horse Park** ("WSHP"). The WSHP is an equine activity sponsor, as that term is defined in [RCW 4.24.530\(3\)](#). I am fully aware of and acknowledge that Equine Activities involve inherent dangerous risks of accident, loss, and serious bodily injury including broken bones, head injuries, trauma, pain, suffering or death ("Harm").

I **agree** to release WSHP Authority and the individual WSHP Board members and the WSHP Foundation and the individual WSHP Foundation Board Members, their agents, assigns, employees and contractors and members, the City of Cle Elum and Sun Communities (hereinafter collectively referred to as the "Released Parties") from all claims for money damages or loss for any Harm to me, my injury or death, the injury or death of my child(ren) named below ("Child") or my horse or for any Harm caused by me or my horse to others, even if the Harm, directly or indirectly, resulted from the negligence of the Released Parties.

I **agree** to expressly assume all risks of Harm to me or my child or my horse.

I **agree** to indemnify the Released Parties and to hold them harmless from all claims, causes of action and money damages resulting from Harm to me, my Child, or my horse while I am participating in Equine Activities at the WSHP facility.

***Under Washington State law, except as provided in RCW 4.24.540(2), an equine activity sponsor or an equine professional shall not be liable for an injury or the death of a participant engaged in an equine activity, and, except as provided in subsection(s) of this section, no participant nor participant's representative may maintain an action against or recover from an equine activity sponsor or an equine professional for an injury to or the death of a participant engaged in an equine activity.***

I **have read and understand** the Rules and Regulations of WSHP that are posted on the WSHP property. I understand these rules and regulations of WSHP will be changed from time to time and I agree to abide by the changed rules. I represent that I and/or my child have the requisite training, coaching and ability to participate safely in the activities we chose to pursue at WSHP.

## RELEASE OF PHOTOGRAPHIC AND VIDEO IMAGES

I **hereby give permission** to WSHP and those acting with its authority the unrestricted right and permission to use, publish and republish any photographic or video images of me and/or my horse for promotional and marketing purposes of the Horse Park. I also permit the use of any printed material in connection therewith and relinquish any right to review or restrict its use or publication.

I **read and understand these Releases, and my handwritten or digital signature below signifies my acceptance of their terms and conditions. I agree these Releases shall remain in full force and effect until they are specifically revoked by me in writing or superseded by new releases issued by the Horse Park and signed by me. Electronic delivery of this document shall be legally binding, the same as delivery of an original.**

Name of Event: \_\_\_\_\_ Event Date(s): \_\_\_\_\_

Participant's Name: \_\_\_\_\_ DOB if under 18: \_\_\_\_\_

Participant's Signature: \_\_\_\_\_ Date: \_\_\_\_\_

*If Event Participant is under 18 years of age, his/her parent must sign on his/her behalf below:*

Parent's Name: \_\_\_\_\_

Parent's Signature: \_\_\_\_\_ Date: \_\_\_\_\_

Signer's Home Address: \_\_\_\_\_

City: \_\_\_\_\_ State: \_\_\_\_\_ Zip Code: \_\_\_\_\_



# WAIVER AND RELEASE OF LIABILITY, ASSUMPTION OF RISK AND INDEMNITY AGREEMENT

For and in consideration of United States Equestrian Federation, Inc. dba US Equestrian ("USEF") allowing me, the undersigned, to participate in any capacity (including as a rider, driver, handler, vaulter, longeur, lessee, owner, agent, coach, official, trainer or volunteer) in a USEF sanctioned, licensed or approved event or activity, including but not limited to equestrian clinics, practices, shows, competitions and related or incidental activities and ("USEF Event" or "USEF Events"); I, for myself, and on behalf of my spouse, children, heirs and next of kin, and any legal and personal representatives, executors, administrators, successors,, and assigns, hereby agree to and make the following contractual representations pursuant to this Agreement (the "Agreement"):

A. RULES AND REGULATIONS: I hereby agree that I have read, understand, and agree to be bound by all applicable Federation Bylaws, rules, and policies including the USEF Safe Sport Policy and Minor Athlete Abuse Prevention Policies (MAAPP) as published at www.usef.org, as amended from time to time.

B. ACKNOWLEDGMENT OF RISK: I knowingly, willingly, and voluntarily acknowledge the inherent risks associated with the sport of equestrian and know that horseback riding and related equestrian activities are inherently dangerous, and that participation in any USEF Event involves risks and dangers including, without limitation, the potential for serious bodily injury (including broken bones, head or neck injuries), sickness and disease (including communicable diseases), trauma, pain & suffering, permanent disability, paralysis and death; loss of or damage to personal property (including my mount & equipment) arising out of the unpredictable behavior of horses; exposure to extreme conditions and circumstances; accidents involving other participants, event staff, volunteers or spectators; contact or collision with other participants and horses, natural or manmade objects; adverse weather conditions; facilities issues and premises conditions; failure of protective equipment (including helmets); inadequate safety measures; participants of varying skill levels; situations beyond the immediate control of the USEF Event organizers and competition management; and other undefined, not readily foreseeable and presently unknown risks and dangers ("Risks").

### EQUINE ACTIVITY LIABILITY ACT WARNING:

CAUTION: HORSEBACK RIDING AND EQUINE ACTIVITIES CAN BE DANGEROUS. RIDE AT YOUR OWN RISK.

**Under the laws of most States, an equine activity sponsor or equine professional is not liable for any injury to, or the death of, a participant in equine activities resulting from the inherent risks of equine activities.**

C. ASSUMPTION OF RISK: I understand that the aforementioned Risks may be caused in whole or in part or result directly or indirectly from the negligence of my own actions or inactions, the actions or inactions of others participating in the USEF Events, or the negligent acts or omissions of the Released Parties defined below, and I hereby voluntarily and knowingly assume all such Risks and responsibility for any damages, liabilities, losses, or expenses that I incur as a result of my participation in any USEF Events. I also agree to be responsible for any injury or damage caused by me, my horse, my employees or contractors under my direction and control at any USEF Event.

D. WAIVER AND RELEASE OF LIABILITY, HOLD HARMLESS AND INDEMNITY: In conjunction with my participation in any USEF Event, I hereby release, waive and covenant not to sue, and further agree to indemnify, defend and hold harmless the following parties: USEF, USEF Recognized Affiliate Associations, the United States Olympic & Paralympic Committee (USOPC), USEF clubs, members, Event participants (including athletes/riders, coaches, trainers, judges/officials, and other personnel), the Event owner, licensee, and competition managers; the promoters, sponsors, or advertisers of any USEF Event; any charity or other beneficiary which may benefit from the USEF Event; the owners, managers, or lessors of any facilities or premises where a USEF Event may be held; and all directors, officers, employees, agents, contractors, and volunteers of any of the aforementioned parties (**Individually and Collectively, the "Released Parties" or "Event Organizers"**), with respect to any liability, claim(s), demand(s), cause(s) of action, damage(s), loss, or expense (including court costs and reasonable attorney fees) of any kind or nature ("**Liability**") which may arise out of, result from, or relate in any way to my participation in the USEF Events, including claims for Liability caused in whole or in part by the negligent acts or omissions of the Released Parties.

E. COMPLETE AGREEMENT AND SEVERABILITY CLAUSE: This Agreement represents the complete understanding between the parties regarding these issues and no oral representations, statements or inducements have been made apart from this Agreement. If any provision of this Agreement is held to be unlawful, void, or for any reason unenforceable, then that provision shall be deemed severable from this Agreement and shall not affect the validity and enforceability of any remaining provisions.

**I HAVE CAREFULLY READ THIS DOCUMENT IN ITS ENTIRETY, UNDERSTAND ALL OF ITS TERMS AND CONDITIONS, AND KNOW IT CONTAINS AN ASSUMPTION OF RISK, RELEASE AND WAIVER FROM LIABILITY, AS WELL AS A HOLD HARMLESS AND INDEMNIFICATION OBLIGATIONS.**

By signing below, I (as the participant or as the Parent/Legal Guardian of the minor identified below) hereby accept and agree to the terms and conditions of this Agreement in connection with my (or the minor's) participation in any USEF Event. If, despite this Agreement, I, or anyone on my behalf or the minor's behalf, makes a claim for Liability against any of the Released Parties, I will indemnify, defend and hold harmless each of the Released Parties from any such Liabilities as the result of such claim.

**The parties agree that this agreement may be electronically signed. The parties agree that the electronic signatures appearing on this agreement are the same as handwritten signatures for the purposes of validity, enforceability, and admissibility.**

RIDER/DRIVER/HANDLER/VAULTER/LONGEUR  OWNER  TRAINER  OFFICIAL  STAFF  VOLUNTEER  COACH (IF APPLICABLE)

Signature: \_\_\_\_\_ Date: \_\_\_\_\_

Print Name: \_\_\_\_\_

Parent/Guardian Signature: (Required if Rider/Driver/Handler/Vaulter/Longeur is a minor) \_\_\_\_\_ Date: \_\_\_\_\_

Print Parent//Guardian Name: \_\_\_\_\_ Emergency Contact Phone No. \_\_\_\_\_

6.17.20

UNITED STATES EQUESTRIAN FEDERATION : 4001 WING COMMANDER WAY : LEXINGTON, KY 40511 : 859.258.2472 : FAX 859.231.6662 : USEF.ORG



# Credit Card Authorization Form

Please complete all fields.

You may cancel this authorization at any time by contacting:

[office@cascadehorseshows.com](mailto:office@cascadehorseshows.com)

This authorization will remain in effect until it is cancelled.

Name(s) of horse(s): \_\_\_\_\_  
(to credit funds to)

\_\_\_\_\_

Credit Card Information	
Card Type	<input type="checkbox"/> MasterCard <input type="checkbox"/> VISA <input type="checkbox"/> Discover <input type="checkbox"/> AMEX
Cardholder Name (as shown on card)	
Card Number	
Expiration Date (MM/YY)	CVV Code
Cardholder Billing Address ZIP Code	

I, \_\_\_\_\_, authorize Cascade Horse Shows LLC to charge my credit card above for agreed upon charges. I understand that I will be charged a 3.5% credit card service charge and that my information will be saved on file for future transactions on my Cascade Horse Shows LLC account.

\_\_\_\_\_  
Customer Signature

\_\_\_\_\_  
Date

Please send completed authorizations to: [office@cascadehorseshows.com](mailto:office@cascadehorseshows.com)

# USHJA Zone 9 Specifications

(MT, WY, ID, OR, WA)



In accordance with GR1111.4: CA, NV, UT, CO, ND, SD, NE, and Canada are contiguous states.

## JUDGING FOR ALL HUNTER AND EQUITATION SECTIONS:

- To be judged on performance and soundness, suitability to count.
- Horses and Ponies are not required to jog for soundness.
- In Equitation: to be judged on performance, style, form and suitability of horse and rider to count

## ELIGIBILITY FOR ADULT AMATEURS: HUNTER, JUMPER, AND EQUITATION:

- To be ridden by exhibitors who have reached their 18th birthday as of December 1 of the current competition year and who hold a current USEF Amateur certification. Open to horses and ponies.

## ELIGIBILITY FOR CHILDREN'S SECTIONS: HUNTER, JUMPER, AND EQUITATION:

- To be ridden by exhibitors who have not reached their 18th birthday as of December 1 of the current competition year

### ADULT AMATEUR HUNTER

Sections offered and requirements: • Adult Amateurs – may be split into three (3) sections Cross Entry: Riders: Amateur Owner Hunter riders may compete on a maximum of one (1) Adult Amateur Hunter horse that they own at the same competition. Riders may not show in any classes in which the fences are 3'9" and over at the same competition. Horses: Horses entered in Adult Amateur Hunter sections may not compete in the Amateur Owner Hunter sections at the same competition. Horse and Rider Combination: Horse and rider combinations may not cross enter into the Amateur Owner Hunter sections. Fence height: • 3'0" with spreads not to exceed the fence height. • Courses will not be adjusted for ponies. • Combinations will be permitted Combining/Dividing Sections: • Refer to HU137 Awards: Zone Horse of the Year Awards will be presented annually to the following sections: • Adult Amateur Hunter 18- 39 • Adult Amateur 40- 55 • Adult Amateur 56 & over

### LOW ADULT AMATEUR HUNTER

Eligibility: Open to exhibitors who have reached their 18th birthday as of December 1 of the current competition year. Cross Entry: Riders: Riders may not cross enter into any class or section at the same competition where fences exceed 2'9". Fence Height: • 2'6" • Low Adult Amateur Hunter Combining/Dividing Sections: The Low Adult Amateur Hunter and Low Children's Hunter sections may be combined if there are fewer than three (3) entries in either section. Awards: Zone Horse of the Year Awards will be presented annually to the following section: • Low Adult Amateur Hunter

### ADULT AMATEUR JUMPER

Sections offered and requirements: • Low Adult Amateur Jumper • High Adult Amateur Jumper Cross Entry: Rider: Riders may not show in any classes where the jumps exceed 1.20m. Horse/Pony n/chila Horse and Rider Combination: Low Adult Amateur horse and rider combinations may not cross enter into the High Adult Amateur Jumper section at the same competition. High Adult Amateur horse and rider combinations may not cross enter into the Low Adult Amateur Jumper section at the same competition. Fence Height: • Low Adult Amateur Jumper: 0.90m to 1.00m • High Adult Amateur Jumper: 1.10m to 1.15m Combining/Dividing Sections: Adult Amateur Jumper sections may be divided by or combined with Children's Jumper sections, at competition management's discretion, if so stated in the prize list. Awards: Zone Horse of the Year Awards will be presented annually to the following sections: • Low Adult Amateur Jumper • High Adult Amateur Jumper

### EQUITATION: ADULT SECTION

Sections Offered: • Adult Equitation 18- 39 • Adult Equitation 40- 55 • Adult Equitation 56 & Over Cross Entry: • No cross-entry restrictions into another section for horse and rider unless stated in the prize list. Fence Height: • 2'9"- 3'6" with spreads not to exceed fence height • Combinations will be permitted • Management must state in the prize list the height at which sections

are being held. Combining/Dividing Sections: • Refer to HU137. Awards: Zone Horse of the Year Awards will be presented annually to the following section: • Adult Equitation 18- 39 • Adult Equitation 40- 55 • Adult Equitation 56 & Over

### **EQUITATION: CHILDREN'S/JUNIOR SECTION**

Sections Offered: • Equitation 11 & Under • Equitation 12-14 • Equitation 15-17 Cross Entry: • No cross-entry restrictions into another section for horse and rider unless stated in the prize list. Fence Height: • Equitation 11 & Under: o Minimum 2'6", maximum 3' - management must state height at which class will be offered. o Management may offer multiple height options if stated in the prize list, but each course must be set at the same height throughout. o Combinations not permitted • Equitation 12- 14: o Minimum 2'9", maximum 3'3" - management must state height at which class will be offered. o Management may offer multiple height options if stated in the prize list, but each course must be set at the same height throughout. o Combinations are optional • Equitation 15- 17: o Minimum 3'0", maximum 3'6" - management must state height at which class will be offered. o Management may offer multiple height options if stated in the prize list, but each course must be set at the same height throughout. o Combinations are optional Combining/Dividing Sections: • Refer to HU141 Awards: Zone Horse of the Year Awards will be presented annually to the following sections: • Equitation 11 & Under • Equitation 12-14 • Equitation 15-17

### **CHILDREN'S HUNTER HORSE**

Sections offered and requirements: • Children's Hunter Horse 13 & Under • Children's Hunter Horse 14- 17 Cross Entry: Rider: Riders entered in the Children's Hunter section may not compete in the Junior Hunter section at the same competition. Riders may not show in any classes in which the fences are 3'9" and over at the same competition. Horses/Ponies: Horses entered in the Children's Hunter section may not compete in the Junior Hunter section at the same competition. Horse and rider combination: n/a Fence Height: • 3'0" with spreads not to exceed fence height • Combinations will be permitted Combining/Dividing Sections: Refer to HU141 Awards: Zone Horse of the Year Awards will be presented annually to the following sections: • Children's Hunter Horse 13 & Under • Children's Hunter Horse 14- 17.

### **LOW CHILDREN'S HUNTER HORSE**

Eligibility: Open to exhibitors who have not yet reached their 18th birthday as of December 1 of the current competition year. Cross Entry: Riders: Riders may not cross enter at the same competition into any class/ section where fences exceed 2'9" Fence Height: • 2'6" • Low Children's Hunter Horse Combining/Dividing Sections: The Low Children's Hunter and Low Adult Amateur Hunter sections may be combined if there are fewer than three (3) entries in either section. Awards: Zone Horse of the Year Awards will be presented annually to the following section: • Low Children's Hunter Horse.

### **CHILDREN'S HUNTER PONY**

Sections offered and requirements: • Small/Medium Children's Pony • Large Children's Pony Cross Entry: Rider: Children's Hunter Pony riders may compete on a maximum of one (1) Children's Hunter horse section at the same competition and in any class not to exceed 3'0" (Exception: Pony Jumpers). Green and Regular Hunter Pony riders may compete on a maximum of two (2) additional pony in the Children's Hunter Pony section at the same competition. Horse/Pony Ponies may not cross enter into any other rated section at the same competition. Horse and Rider Combination The same pony and rider may not cross enter into any other rated section at the same competition. Fence Height: • Combinations will not be permitted • Classes may run as one or split Small/Medium and Large to run at 2'0", 2'3" and 2'6" respectively. Combining/Dividing Sections: Refer to HU141. Awards: Zone Horse of the Year Awards will be presented annually to the following sections: • Children's Hunter Pony-Small/Medium • Children's Hunter Pony-Large Required distances for the Children's Hunter Pony sections: a. 2'0" Small Children's Hunter Pony should be (based on 9'9" stride): 4 strides at 48'9"; 5 strides at 58'6"; 6 strides at 68'3"; 7 strides at 78'8"; 8 strides at 87'9". b. 2'3" Medium Children's Hunter Pony should be (based on 10'3" stride): 4 strides at 51'3"; 5 strides at 61'6"; 6 strides at 71'9", 8 strides at 82'3". c. 2'6" Large Children's Hunter Pony should be (based on an 11" stride): 4 strides at 55"; 5 strides at 66"; 6 strides at 77"; 7 strides at 88"; 8 strides at 99'.

### **CHILDREN'S JUMPER**

Sections offered and Requirements: • Low Children's Jumper • High Children's Jumper Cross Entry: Rider: Riders may not show in any classes where the jumps exceed 1.20m, except Junior riders competing in FEI Children's classes and USEF Talent Search Class. Horse/Pony n/a Horse and Rider Combination: Low Children's horse and rider combinations may not cross enter into the High Children's Jumpers at the same competition. High Children's horse and rider combinations may not cross enter into the Low Children's Jumpers at the same competition. Fence Height: • Low Children's Jumper: 0.90m to 1.00m • High Children's

Jumper: 1.10m to 1.15m Combining/Dividing Sections: Children's Jumper sections may be divided or combined with Adult Amateur Jumper sections, at competition management's discretion, if so stated in the prize list. Awards: Zone Horse of the Year Awards will be presented annually to the following sections: • Low Children's Jumper • High Children's Jumper.

### **USHJA COMPETITIVE PROGRAMS**

For more information regarding the following programs please click on the links below:

[Green Hunter Incentive](#)

[International Hunter Derby](#)

[National Hunter Derby](#)

[Outreach](#)

[Pony Hunter Derby](#)

[Hunter Team Challenge](#)

[World Championship Hunter Rider](#)

[Zone Horse of the Year Championships](#) (Please check individual zone pages)

[Zone Jumper Championships](#)

### **SPECIAL CLASSES**

[3'3" Jumping Seat Medal](#)

[Green Hunter Challenge](#)

[Gladstone Cup Equitation Classic](#)

Full Specs available at: <https://www.ushja.org/zones-affiliates/zone-9/specifications>.



*Professional Johanna Siefert and Chico Ask competing in the Cascade Grand Jumper ring during the June Alpine Preview horse show. Photo: Gary Voth*

# YOU ARE NOT YOU ALONE



US Equestrian wants you to know: if you are a victim or survivor of sexual abuse or suspect abuse of any kind, there are resources and people to help.

## REPORT

833-5US-SAFE or [uscenterforsafesport.org/report-a-concern](https://uscenterforsafesport.org/report-a-concern)

## 24/7 HELPLINE

866-200-0796 or visit [safesporthepline.org](https://safesporthepline.org)

## TRAINING & RESOURCES

Free to US Equestrian members at [usef.org/safesport](https://usef.org/safesport).

#youarenotalone



USEF Competition Name: Swiftwater Invitational / Alpine Preview

USEF#: 329346 / 330219

Competition Division(s) and Rating(s): USEF National A (Hunter), Jumper Rating 2

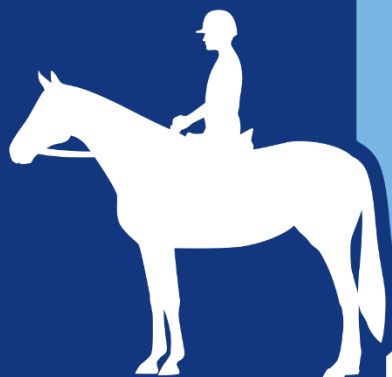

# MAAAP

## MINOR ATHLETE ABUSE PREVENTION

### LEARN ABOUT MAAP POLICIES



SafeSport Training



One-On-One Interactions



Local Travel



Social Media and  
Electronic Communications



Read about these and more at  
[usef.org/MAAPP](https://usef.org/MAAPP)

### REPORT MAAP POLICY VIOLATIONS



[usef.org/safe-sport/reporting](https://usef.org/safe-sport/reporting)  
859-225-6915

