



CASCADE HORSE SHOWS 2022

SEPTEMBER 9-11 **CASCADE FINALS**

USEF Regional I (B) Hunter, Jumper Rating 1

WASHINGTON STATE HORSE PARK, CLE ELUM WASHINGTON

CASCADEHORSESHOWS.COM



Flying over obstacles: This is what trust is all about.

Building a family legacy takes a lifetime. Maintaining it over generations takes our kind of expertise.

Experience tells us that perpetuating wealth is often as much about family dynamics as it is economics. For this reason we focus on your vision and values as tenaciously as we pursue solid returns. Our goal is to empower you, your family, your traditions and culture for generations to come. With Whittier Trust your lasting legacy begins today.

There is a tangible difference that the oldest and largest multi-family office headquartered in the West can mean for your legacy. Experience it. Talk to Lori Houston and Paul Cantor at (206) 332.0836.



Whittier Trust

Investment Management & Consulting | Trust Services | Family Office
Philanthropy & Family Continuity | Real Estate & Energy

SEATTLE OFFICE

520 PIKE STREET, SUITE 1415, SEATTLE, WA 98101
(206) 332.0836

PORTLAND OFFICE

111 S.W. FIFTH AVENUE, SUITE 3150, PORTLAND, OR 97294
(503) 444.3428

SOUTH PASADENA | WEST LOS ANGELES | NEWPORT BEACH | SAN FRANCISCO | RENO | SEATTLE | PORTLAND

TABLE OF CONTENTS

How to Enter	6
Horse Show Approvals	6
Directions to the Washington State Horse Park	6
Cascade Circuit Cup Awards	7
US Equestrian Sections and Ratings	8
Horse Show Officials	10
Horse Show Fees	12
Facilities & Grounds	14
Important Policies of the Show	16
Rules & Regulations	20
Spotlight Classes	27
Hunter Division	30
Equitation Division	35
Jumper Division	38
Championships Offered	41
Specifications	42
Schedules: Cascade Finals	47
Entry Forms	50
USHJA Zone 9 Specifications (MT, WY, ID, OR, WA)	54
USEF Safe Sport / MAAP	57

CASCADE SPONSORS

Cascade Horse Shows gratefully thanks its proud sponsors

Equestrian Brands & Commercial Sponsors



CASCADE SPONSORS

Cascade Horse Shows gratefully thanks its proud sponsors

Premium Show Stables & Individual Patrons



HOW TO ENTER

[Stall reservations](#) are required for entry into the horse show (see page 16).
After reserving stalls, you may enter online at Horseshowing.com or EquestrianConnect.com



Enter by email:

Send scanned entries to
office@cascadehorseshows.com

Mail entries to:

Show Secretary
Cascade Horse Shows
311 Avenue C, Snohomish, WA 98290

Entries postmarked or received online after the close of entries are considered post entries and will incur a \$50 late entry fee.

HORSE SHOW APPROVALS

United States Equestrian Federation (USEF) *Lexington, KY*

United States Hunter Jumper Association (USHJA) *Lexington, KY*

Washington State Hunter Jumper Association (WSHJA) *Sammamish, WA*

Oregon Hunter Jumper Association (OHJA) *Wilsonville, OR*

DIRECTIONS TO THE WASHINGTON STATE HORSE PARK

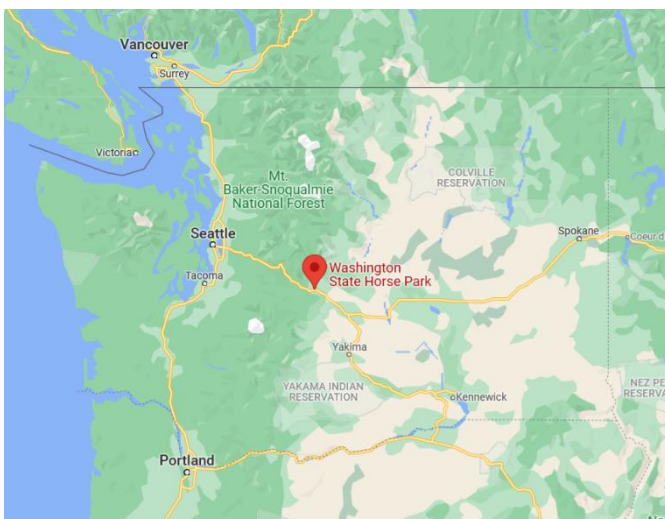

Map courtesy Google.

Washington State Horse Park

1202 Douglas Munro Blvd.
Cle Elum, WA 98922

The Horse Park is conveniently located off Interstate 90 in Cle Elum, Washington, approximately 80 miles from Seattle.

From I90 Westbound:

Take exit 84 from I-90 W toward Cle Elum
Right onto Oakes Ave 0.5 mi
Left onto W 2nd St 0.6 mi
Left onto Forest Service Rd 4517/Douglas Munro Blvd
Right onto Douglas Munro Blvd

From I90 Eastbound:

Take exit 84 from I-90 E toward Cle Elum/S Cle Elum
Continue onto W 1st St 361 ft
Turn left onto Douglas Munro Blvd 0.9 mi
Continue on Douglas Munro Blvd

CIRCUIT CUP AWARDS

The Cascade Circuit Cup Awards are season championships bestowed upon the horses accumulating the most points in one of 5 categories over our rated show season. We recognize that performing well in the arena takes similar courage and commitment, whether competing in the 2' 3" hunters or the 1.30m jumpers (or any height in between).

HONORING OUR 2021 WINNERS!

Congratulations to the following horses, riders, and trainers for their outstanding performances in 2021.

JUMPER 1.10M AND UP

Pimlico

16.3 Bay Warmblood Gelding

Owner & Rider: Elizabeth Champagne

Trainer: Allison Heidmann,
Big Sky Equestrian

JUMPER UP TO 1.05M

Newtorius

16.3 Bay Holsteiner Mare

Owner & Rider: Kelli Webber

Trainer: Shannon Hendrickson,
Signature West Farms

USHJA HUNTER DERBY

Closing Time

16.3 Buckskin Dutch Warmblood Gelding

Owner & Rider: Kelsey King

Trainer: Denise Youell, Farpoint Farm

HUNTER 3' AND UP

MTM Check Me Out

16.1 Bay Warmblood Gelding

Owner & Rider: Mary-Lou Misrahy

Trainer: Shelly Kerron,
Legacy Hunters & Jumpers

HUNTER UP TO 2'9"

Filibuster

16.2 Chestnut Thoroughbred Cross
Gelding

Owner & Rider: Jodi Gearon
Trainer: Sarah Olmstead, Brass Ring Farm

All horses are eligible. Each winner receives valuable prizes honoring their achievement. We are excited to see who this season's big winners will be. See you in September!



US EQUESTRIAN SECTIONS AND RATINGS

CASCADE FINALS | USEF #334509 | JUMPER 1

USEF Rated Regional I (B): Performance Hunter 3'3" & 3'6", Green Hunter 3', 3'3", 3'6", 3'9", Amateur Owner Hunter 3'3" & 3'6", Junior Hunter 3'3" & 3'6"

USEF Rated Regional II (C): Adult Amateur Hunter, Children's Hunter, Children's Hunter Pony, Small Hunter, Thoroughbred Hunter, USHJA Hunter 2', 2'3", 2'6", 2'9", 3'



Four-time World Champion Hunter Rider John French competing in the Cascade USHJA National Hunter Derby sponsored by Brick Road Farms. Photo: Gary Voth



Express your potential

VOLTAIRE
DESIGN



[voltairedesignusa_can](https://www.instagram.com/voltairedesignusa_can)



[Voltaire Design USA & Canada](https://www.facebook.com/VoltaireDesignUSA)



[@VoltaireDesign](https://www.tiktok.com/@VoltaireDesign)

[VoltaireDesign.com](https://www.VoltaireDesign.com)

HORSE SHOW OFFICIALS

Show Manager

JENNIFER HANSEN

Show Secretary

LAUREN WASSERMAN

Marketing, Sponsorships & Community Relations

JESSICA VANIA

Grounds Manager

ADAM CHAMBERLIN

Finance and Operations

NANCY LEWIS

Web Site, Technology & Communications

GARY VOTH

Veterinarian

WASHINGTON STATE UNIVERSITY

Farrier

TRISTEN EVANS

Official Photographer

VIOLA MITCHELL

Horse Park Director

LESLIE THURSTON

Horse Show Advisors

ABBIE BLOCK

ANDREA SCHROEDER

DENISE YUELL

CASCADE FINALS

September 9-11, 2022

Judges, Hunter & Equitation

CINDY ROSS, Camas, WA

KENDRA BEST, Delta, BC

Judge, Jumper

CINDY ROSS, Camas, WA

Course Designers

LINDSEY UYESUGI-LACEY, Snohomish, WA

LIZ HAMBLETON, Sammamish, WA

Steward

ERIC NOEL, Portland, OR



Selling homes for horses and their people



Heidi Davalos

heidid@pacesetterproptiesteam.com

425.870.3334

Raquel Davalos

raquel@pacesetterproptiesteam.com

425.760.8600

Reilly Ochs

reilly@pacesetterproptiesteam.com

206.914.5254

HORSE SHOW FEES

USEF Horse Fee: \$8*

USEF Equine Drug & Medication Fee: \$15*

USEF Show Pass Fee: \$45*

USEF Membership Fee: \$80*

USHJA Fee: \$2*

USHJA Show Pass Fee: \$30*

Stall Fee: \$210

Non-Showing Horse Fee: \$150/show

Haul-In Fee: \$50/horse/day or \$150/horse/show

RV Space: \$300 (Full hookup), \$250 (Partial hookup), \$150/week or \$25/night (no hookup/dry camp)

Tent / Dry Camp Space: \$100/week or \$25/night

Warm-Up / Schooling Fee: \$35

Office Fee: \$50

Per Stall Manure Disposal / Garbage Fee: \$50

Hunter / Jumper Nomination Fee: \$50

**Applies to rated competition only*

CLOSING DATES FOR ENTRIES

Entries received after the closing dates will be charged a \$50 late entry fee.

Swiftwater Invitational: **MAY 20, 2022**

Alpine Preview: **MAY 20, 2022**

Pacific Crest Open: **JUNE 28, 2022**

Cascade Finals: **AUGUST 22, 2022**

HORSE SHOW SERVICES

Show Office Hours

DAY PRECEDING SHOW: 10am – 5pm

DAYS OF SHOW: 7am¹ – 5pm²

¹ or 30 minutes prior to start of the first class

² or 30 minutes after the last regularly scheduled class ends

Concessions Provided By

ONSITE VENDORS

Golf carts

AVAILABLE FOR RENT FROM CHS

A limited number of golf carts are available for rent on a weekly basis during the show from Cascade Horse Shows. Requests can be made from our web site using [our online form](#). Availability is first come, first served until the limited supply is gone.

ONSITE RV POLICY

RV sites are available for request on a first come, first served basis, with consideration given for sponsors, two-week stays and size of RV. Please use our online form at cascadehorsheshows.com to make requests. Choices are not guaranteed, and no requests are final until you receive emailed confirmation from the Show Office and render payment, if required. For cancellations, please see [Cancellations & Refunds](#), page 16.

All sites are assigned by Cascade Horse Shows and will be shared with you upon confirmation. Upon arrival, please find your site at the welcome center or Show Office should you need assistance. An RV Pass must be procured at the Show Office and prominently displayed. Hookups with utilities include 15-amp, 30-amp, or 50-amp power and potable water (availability of 50-amp hookups is limited). Charges apply whether hooked up to utilities or not. Pump out services can be requested in the office on the dates they indicate are available.

FARPOINT FARM TRAINING CENTER

CALGARY | KENTUCKY | CALIFORNIA | THE GREAT NORTHWEST

“The secret of joy in work is contained in one word - excellence. To know how to do something well is to enjoy it.”

~ Pearl S. Buck

Farpoint offers individualized instruction and training in the American Hunter-Jumper Riding System. From ponies to grand prix show jumpers, Farpoint offers an excellent program for Northwest riders to go far beyond where they've gone before.



Denise Youell, Owner & Head Trainer
Snohomish, Washington | 360.668.7128
info@farpointfarm.com

FACILITIES & GROUNDS

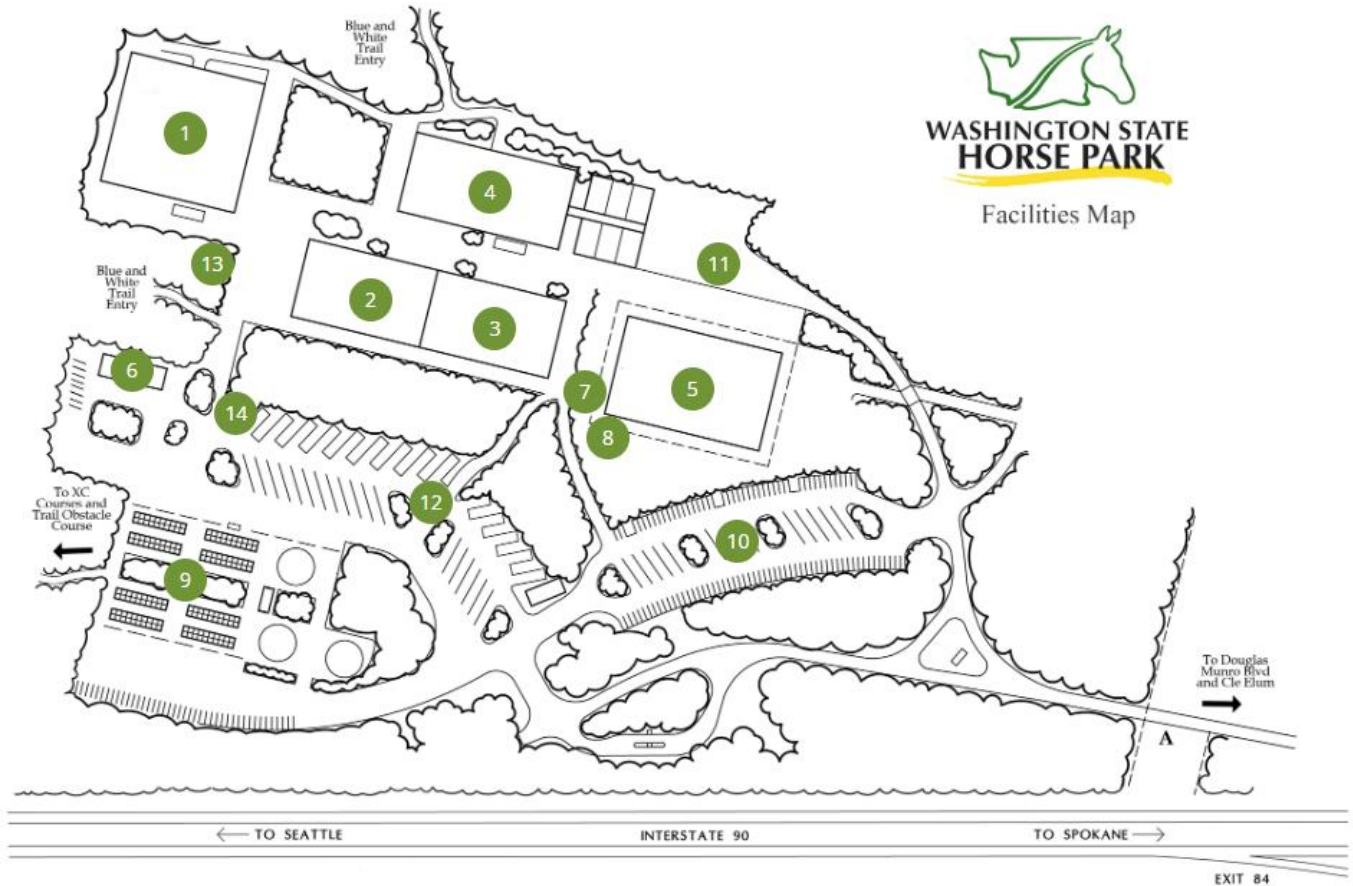

- 1 Kona Coast Grand Jumper (250' x 250')
- 2 Legacy Cascade Hunter (140' x 230')
- 3 Hunter warm-up (130' x 230')
- 4 Jumper warm-up (150' x 300')
- 5 Ariat Grand Hunter (covered arena, 150' x 300') with ample spectator seating
- 6 Show Office
- 7 Prize Store
- 8 Vendor Row
- 9 10 11 Stabling West, East and Northeast
- 12 RV sites: 14 premium full hookup (water, electric, sewer) sites nestled in the trees. 14 standard hookup (water & electric) situated around the tree islands. 24 basic no-hookup spaces
- 13 Windbreaker Lounge: Hospitality tent with lounge seating, plus covered and open picnic areas
- 14 Geneva Financial Lounge: Covered lounge with seating for work or relaxation

Additional Amenities:

- Shower facility with 3 private shower rooms
- Miles of adjacent horse trails with easy access from stabling areas
- Ample trailer parking

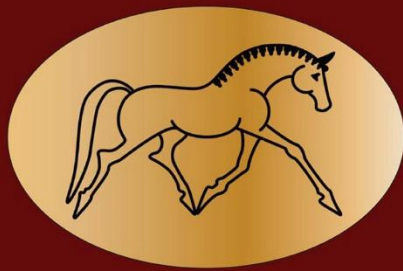

Brick Road Farms

Quality Hunters and Jumpers



Brick Road Farms is the Proud Sponsor of the Cascade Hunter Derby Series

Our farm is located on 25 beautiful acres, with trails on site, riding access to the beach on the Snohomish river.

Along with:

Experienced trainers always on site.

Top quality lesson horses with "A" circuit experience.

30 Matted stalls 12 x 12 and 10 x 13.

12 Acres of pasture turn outs plus winter turn outs.

80 x 250 covered arena with state of the art footing.

200 x 300 outdoor derby field with custom derby jumps.

1,200 square foot viewing room with special amenities, including a wine bar.

LESSONS

TRAINING

SALES

Carol Hinckley | 425-791-0025
Megan Polikretis | 818-324-5683

www.brickroadfarms.com
15000 Tester Road Snohomish, Wa. 98290

IMPORTANT POLICIES OF THE SHOW

STALL RESERVATIONS

Trainers or their authorized agents, or individual exhibitors not affiliated with a trainer, must use our online [Stall Reservation form](#) to reserve stalls in advance of our shows. Entries cannot be accepted without stall reservations. We will confirm your reservation within 7 business days of receiving your form. In the case that stalls sell out prior to the close of entries, we will add your reservations to our waitlist.

You can change your counts by notifying us via email at office@cascadehorsheshows.com or text at 360.573.4360, *however*, your counts will be locked-in after the show scratch / cancellation deadline (see below).

Confirming your counts: When the scratch deadline is approaching, we will contact you at least 72 hours in advance to confirm your final stall count. Stalls you confirm past the scratch deadline will be *final* regardless of whether you have submitted entries, so please only reserve stalls you are confident you will use. If we do not hear back from you at this stage, your stalls will be released to others on the waitlist.

Changes past this deadline: If your needs change past this deadline, you can work with other trainers to take your confirmed stalls—provided you notify us via email. All parties—i.e., you and the other trainer(s)—must be included on this communication to us. You must give us notice of any stall exchanges at least 10 days prior to the start of the show to have this reflected on the stabling chart. In the unlikely case of a misunderstanding between trainers as to who is paying for exchanged stalls, we must hold the trainer who made the original reservation responsible for the stalls.

If something does change, please reach out to us as soon as possible. While the above is our formal policy, with enough notice we will always try to work with you while maintaining a fair approach for all competitors.

CANCELLATIONS & REFUNDS

If circumstances change and you will no longer be able to attend the show, please communicate any desired changes promptly. This helps us accommodate as many competitors as possible.

Show Scratches and Cancellations: The deadline for show cancellations and scratches without penalty will be the *earliest* of these two dates:

- The published close of entry date for the show
- A date we publicly announce that is approximately 6 weeks prior to the show (in the event the show sells out early)

Up until this deadline, you may make changes to or cancel your entries or their associated stall reservations and RV site requests without penalty. Any deposits paid with entries made prior to the scratch deadline will be fully refunded.

After this deadline, you are fully responsible for any stall fees due for your reserved stalls (see above) in addition to office fees due, if any. Refunds for RV sites with hookups are offered prior to the entry close date provided we can resell the space. RV sites are non-refundable past close of entries.

Changes Past the Close of Entries: A \$50 office fee per horse will apply to all entries, scratches and substitutions made after the close of entries. Please note that after a horse has been checked in, there are no refunds of stalls, nomination fees, feed and hay, bedding, RV reservations, schooling fees, office fees, non-showing horse fees, manure and garbage disposal fees or any completed classes.

Refunds: Any refunds due will be credited to your card or mailed to you within 3 weeks following the show.

How to Request Changes: Please communicate your requests to the Show Office promptly at office@cascadehorsheshows.com.

Illness or Injury During the Competition: After the competition starts, if you are unable to compete due to an illness or injury, your remaining class fees will be refunded upon presentation of a doctor's certificate. Stall and other fees will not be refunded. A \$50 office charge will apply.

ADDITIONAL POLICIES

Adds & Scratches Due By 4:00 pm Daily

All changes for the next day, including adds and scratches, must be made by 4:00 pm each day in the office or on horseshowing.com. This allows the next day's schedule to be created with class counts and times and made available to everyone in a timely manner.

Day-of Adds

If wanting to add a class on the same day, approval will be based on schedule availability and management discretion. We cannot guarantee acceptance, and you may be put on the ring wait list. If accepted, day-of adds will be assessed a \$10 per class fee. Enter your classes by 4:00 pm the day prior to avoid the \$10 add fee. See our [full policy](#) on page 21.

Canceling And Combining of Classes

Classes with fewer entries than the minimums may be either canceled or combined with other classes, at management's discretion.

Posted Ring Schedule

The most accurate estimation of the daily ring schedules will be completed after adds and scratches have been entered. We strive to post this schedule by 7:00 pm the day prior. The schedule can be found at our [Competitor Resources page](#).

US EQUESTRIAN MEMBERSHIP STATEMENT

Life, senior active and junior active members shall be eligible to participate in all classes at Regular Competitions, Eventing Competitions at the Modified Level or above and Combined Driving Competitions at the Advanced Level, Dressage, Reining and Vaulting Competitions and Endurance Rides. A nonmember may participate as a handler, rider, driver, owner, lessee, agent, coach or trainer at Regular Competitions, Eventing Competitions, Dressage Competitions, Reining Competitions and Combined Driving Competitions upon payment of a \$45 Show Pass fee. Participants in the following classes are exempted from the Requirements of this rule: 1) leadline; 2) exhibitions; 3) games and races; 4) classes for 4-H members; 5) walk trot (exception: Friesian performance FR222) and academy classes (academy classes are classes limited to horses used regularly in a lesson program); 6) USDF introductory level tests, pas de deux and quadrille classes; 7) NRHA Endorsed Reining Competitions. 8) Opportunity classes, 9) citizens of other nations who have proof, in English, of current membership in good standing of their own National Federation, 10) USEA beginner novice division; and 11) assistant handlers in Dressage Sport Horse Breeding classes.





Ansara Patterson, wife Tracy and daughters Naya and Cayenne.

PHOTO COURTESY PAUL DUDLEY

Family » Home » Heart

Ansara Patterson, A Mortgage Professional You Can Trust.

Serving all of Washington and Our Veterans

Providing Residential Mortgages:

- VA • USDA • FHA
- Conventional
- Refinances
- Manufactured

Ansara Patterson

Loan Officer

NMLS ID 90076

Mobile: **206-714-5733**

Email: ansara@genevafi.com

Web: genevafi.com/ansarapatterson



Home Loans Powered By Humans™



Copyright© 2020 Geneva Financial, LLC, NMLS #42056 • All loans subject to qualifying factors. Not all applicants will qualify. Equal Opportunity Lender and Equal Housing Lender, 3155 S Price Rd Chandler, AZ 85248, 1-888-889-0009, NMLS #42056 BK #0910215



SPOTLIGHT CLASSES

Cascade Mini Prix

Presented by TNT Farrier Services

Sept. 10, 2022 \$2,000 Cascade Mini Prix

Set at 1.15m. To be run as Table II, Sec 2(a) — Time first with a jump off; ties to jump off for first place. Prize money: 1st 30%, 2nd 20%, 3rd 14%, 4th 10%, 5th 8%, 6th 7%, 7th 6%, 8th 5%



Katherine Wade-Easley and Risky Business

RULES & REGULATIONS

Cascade Horse Shows competitions are conducted under current U.S. Equestrian and USHJA rules and are U.S. Equestrian, USHJA, USHJA Zone 9, WSHJA, and OHJA approved.

ENTRIES

Enter online via HorseShowing.com or EquestrianConnect.com. All sites are credit or debit card payment only. Or email scanned entries to:

Show Secretary
Cascade Horse Shows
311 Avenue C, Snohomish, WA 98290
Email: office@cascadehorseshows.com
Text: 360.573.4360

Each show has a published close of entries date. You may enter the shows at any time assuming space availability.

All entries require a Competition Deposit equivalent to the cost of a stall plus a \$50 fee. This deposit will be fully credited to your final show bill upon checkout if entries are received prior to the close of entries date. If your entries are received after the close of entries date, the \$50 per entry fee is forfeit.

SCRATCH DEADLINE

The deadline for refunds in the event of show cancellations or scratches will be the *earliest* of these two dates:

- The published close of entry date for the show
- A date that we publicly announce that is approximately 6 weeks prior to the show if the show sells out early

Refunds for show entries or reserved stalls are not possible for any reason after this deadline. Please contact the Show Office to request refunds.

STALL RESERVATIONS

Trainers or their authorized agents, or individual exhibitors not affiliated with a trainer, may use our online [Stall Reservation form](#) to reserve stalls in advance of our shows. Please see our full [Stall Reservation policy](#) on page 15.

PAYMENT

Pay by check, cash, money order, VISA, MasterCard, Discover, American Express credit or debit card. A valid form of payment must be presented upon check-in at the show. All credit and debit card payments subject to a 3.5% convenience fee.

Canadian Exhibitor entries must be paid by draft payable in US funds or check on Canadian US dollar account or credit card. Canadian checks with US FUNDS written on the face of the check cannot be accepted.

All checks returned by the bank incur a fee of \$50. To retain entries, the fees and penalty must be paid by before 4pm the day before the Show starts. In the event a check is returned after the completion of the show, it will be handled in accordance with US EQUESTRIAN GR913.

Competitors who do not come into the office to close out at the end of the show forfeit the right to adjustments on any show charges. Final balances will be automatically charged to the payment method on file.

TRAINER SPLITS

Trainers having accounts with Cascade Horse Shows may choose to add their show fees and charges to their "trainer splits" to have these charges distributed amongst their clients. Trainers have until 5:00pm Friday of the show to inform the Show Office which charges will be distributed to which clients. It is fully and solely the trainer's responsibility to indicate which items are applicable to the split and to which clients they should be applied. *Exhibitors:* By submitting an entry form, you acknowledge that you fully accept responsibility for the costs assigned to you by your trainer for the show that you are entering.

SUBSTITUTIONS

A new horse may be substituted for a scratched horse. There will be a \$50 office charge for substitutions made after the close of entries.

SHOW SCRATCH and REFUNDS

Refer to [Cancellations & Refunds](#) on page 16.

EVERY CLASS OFFERED HEREIN WHICH IS COVERED BY THE RULES AND SPECIFICATIONS OF THE CURRENT USEF RULE BOOK WILL BE CONDUCTED AND JUDGED IN ACCORDANCE THEREWITH

REQUIRED CREDENTIALS

Exhibitors entering rated competition must present copies of the following current credentials to the horse show: US EQUESTRIAN/USHJA/EC membership card; US EQUESTRIAN/USHJA Amateur certification; US EQUESTRIAN/USHJA Large, Small, Junior Hunter and Pony measurement card; USHJA/EC horse recording card or ID number.

USHJA HORSE REGISTRATIONS

All horses competing in licensed competitions with Hunter, Hunter Breeding, Jumper and/or Hunt Seat Equitation classes (except those activities enumerated in GR901.9, items 1-9) must obtain a Registration Number from USHJA. Not required for Opportunity and Outreach classes.

HORSE MICROCHIP

Note: An ISO 11784/11785 compliant chip is required for entry into ALL USHJA rated hunter/jumper competitions starting with the 2019 season.

MEASUREMENT & AMATEUR CERTIFICATION

All Small, Large, Junior and Pony Hunters must possess and present a current Measurement card to the Show Secretary before numbers may be picked up. If the cards are not available, MEASUREMENT WILL BE REQUIRED. Photocopies of current Amateur Certification or Junior Memberships may be included with entries or made available when picking up numbers. Check in the Show Office for measurements times and dates.

SAFE SPORT

All USEF Life and Senior Active members, as well as participants who have regular contact with minor athletes, are required to comply with the U.S. Center for SafeSport training requirement to be eligible to participate in the competition. All participants must adhere to the U.S. Center for SafeSport Code, USEF Safe Sport Policy, and the Minor Athlete Abuse Prevention Policies. More information about this can be found at www.usef.org.

COMPETITION OFFICE HOURS

Day preceding show: 10:00am-5:00pm. Days of show: 7am-5pm or 30 minutes after the last regular class completes whichever is later. Special classes are excluded. Regardless of closing time all next day class adds are due by 4:00pm.

ARRIVALS AND DEPARTURES

Arrivals: Plan to arrive and move in as early as 2 days prior to the start of the competition. For example, a Tuesday warm-up day with a Wednesday competition start means you move in on Monday starting at 8am. You may arrive later if you like. For approval to arrive earlier than the 2 days before competition start, contact the Show Office at office@cascadehorsheshows.com. Early arrivals incur a per-night fee per-stall and per-RV as applies.

Departures: Plan to depart Stabling and RV locations by 7pm Sunday or pre-pay with the Show Office to stay over Sunday night. The fee is \$35 per horse stall, and you must vacate by 8am on Monday morning. On Sunday night there will be a 10pm stabling 'lights out'. Sunday night RV stays incur a 'per night' RV fee.

4- & 5-YEAR-OLDS and OFF-THE-TRACK THOROUGHBREDS (OTTB) SHOW FREE

Free entry limited to ONE open Hunter or open Jumper section, excluding Spotlight classes and Classics. Each rider (professional, junior, or amateur) is limited to one horse at each Cascade show. Horses that utilize this program are allowed one use per Cascade Horse Show season. Participation in the program is limited to 2 consecutive years. Management reserves the right to cap participation. Horses entered after the entry close date are not eligible.

All participants wishing to utilize this program must email office@cascadehorsheshows.com prior to close date of entries, include horse and rider's name, and trainer's name. Must provide proof of age at time of check-in. Thoroughbreds must have Jockey Club papers and/or proof of breeding including tattoos. All other fees, including stalls, nomination, office, federation, etc. apply. Substitutions are allowed and will follow the regular substitution policy.

STABLING

Stalls with doors are provided; dimensions are 10'x10'. 160 have mats; the remaining have dirt/gravel floors. Requests for specific stalls or stall locations will be considered on an individual basis. Preference given to horses showing both weeks and to sponsors. Portable stalls, with doors, are provided. Bales of shavings will be available by pre-order on entry form and/or during the show by request at the Competition Office. One bale of shavings is included with each stall. Straw is not permitted.

In cases of high demand, management reserves the right to cap how many non-horse stalls are sold, and a ratio of horse stalls to non-horse stalls may be put into effect.

Stalls must be cleaned daily. Dirty bedding must be placed in areas provided. Exhibitors are responsible for cleaning their own stalls and must provide their own feed and buckets. A \$50 manure disposal and garbage fee will be assessed for all stalls. No staples, nails, cutting stalls or removal of top doors permitted. Stabling damage fees will be assessed by the WSHP as follows: Panels – \$100 portable stall, \$200 permanent stall; Stall metal framework - \$200; light cords \$150; Roof Tarps – actual repair/replacement costs. Trash cans and bags will be provided on move out days.

SHARPS CONTAINERS

Sharps containers will be available at the end of each barn aisle way. Please be aware, Competition Management may fine any individual up to \$100 for improper disposal of needles or other sharp disposable instruments. GR1210.4 If needles are dropped in manure, it cannot be composted.

JUMPER / HUNTER / EQ NOMINATING FEE

Horses or ponies entered in any jumper, hunter or equitation classes pay a Nomination Fee (varies per show). This fee allows entries to add classes before 4:00 pm prior to the day of the class.

CLASS ADD / SCRATCH POLICY

Adds — Classes may be added up to a day ahead of time at no charge if the Show Office is notified by 4:00pm. Unless otherwise posted, it should be assumed that there are no day-of adds. If wanting to add a class on the same day, approval will be based on schedule availability and management discretion. We cannot guarantee acceptance, and you may be put on the ring wait list. If accepted, day-of adds will be assessed a \$10 per class fee.

Scratches — With the exception of special classes, if your horse has a written scratch form at the Show Office prior to the start of the class, full class entry fees are refunded minus a \$10 scratch fee. You must scratch your classes BEFORE they start. If you don't scratch them at all or try to scratch them after the class has started, you will be charged the full class entry fee.

SPECIAL / SPOTLIGHT CLASS SCRATCH POLICY

Special / Spotlight classes will be assessed a \$25 scratch fee if scratched on the day of the class.

RIDER DID NOT ENTER (RDNE) FEE

It is the responsibility of the competitor and trainer to ensure they have properly entered all classes they intend to compete in. A "ride-did-not-enter" (RDNE) fee of \$25 will be added to the cost of the class for any rounds competed that cannot be supported by office-approved paperwork.

CLASS WAIT LIST POLICY

Be sure to get all entries planned for the next day in by 4pm. If full ring capacity is reached, any entries received for that ring after 4pm, may be put on a wait list. You are encouraged to enter all classes/divisions for the entire show before 4pm on schooling day to ensure entry in those classes/divisions.

US EQUESTRIAN and USHJA FEES

All horses participating in any competition recognized by the US Equestrian Federation incur the following fees: USEF \$23 fee (\$15 of this fee is a Drugs and Medication fee to provide research, inspection, and enforcement of rules regarding use of medications and drugs: see GR407.1, .2, and .3); USHJA Fee \$7 (National shows) or \$2 (Regional I shows). If you are not a current USEF and USHJA member, a Show Pass fee is assessed by USEF/USHJA (\$45 USEF, \$30 for USHJA). These fees will be added to your show account.

MANAGEMENT CLASS CHANGES

Management reserves the right to cancel or combine any classes as appropriate. Notice will be given to exhibitors affected. Management reserves the right to start the first class of any section 30 minutes earlier than the scheduled time. Management reserves the right to change arenas, judges, or class orders to facilitate time, schedule, and conditions.

Vegetarian, Glycerin-free, Petroleum-free, pH Matched Premium Leather Care

You've certainly invested **A LOT** in your tack, haven't you?

So you can see how it is well worth it to give it the premium care that will help extend its life, can you not?

When you choose Sterling Essentials, you choose life-extending tack care made with pH formulated, all natural vegetarian ingredients, and mold-fighting pure essential oils.

You'll **NEVER** have to use harsh chemicals that damage your tack and harm you and your horse ever again.

Liberate yourself and your horse with Sterling Essentials.

Photo Credit
Genevieve Munson



**STERLING
ESSENTIALS**
— LLC —
EMPOWERED EQUESTRIAN

Purchase your favorite fragrance at retailers nationwide or
learn more at:

WWW.STERLING-ESSENTIALS.COM

PRIZE MONEY PAYMENTS

Exhibitors receive prize money within 3 weeks after the horse show. A valid Social Security or Federal tax ID number must be provided. Prize money won by foreign exhibitors is subject to the US Internal Revenue Service regulation requiring sporting events to withhold 30% of prize money unless they have a US Social Security #.

TROPHIES, RIBBONS, PRIZE MONEY SPLITS

Trophy and ribbons will be awarded to eight places in all Hunter and Equitation classes. Unless stated otherwise, Hunter and Hunter Classic prize money will be divided 30%, 25%, 20%, 15%, 10%. The USHJA National Hunter Derby prize money will be divided 30%, 22%, 13%, 8%, 6%, 5%, 4%, 3%, 2%, 2%, 2%. Trophy and ribbons will be awarded to six places in all Jumper classes. Unless stated otherwise, Jumper prize money will be divided 25%, 23%, 20%, 17%, 15%. The Cascade Welcome and the Cascade DerbyCross™ prize money will be divided 30%, 23%, 15%, 12%, 10%, 10%. The Need for Speed™ Open Jumper will be divided 30%, 20%, 14%, 10%, 8%, 7%, 6%, 5%. The Grand Prix and Mini Prix will be divided 30%, 20%, 15%, 10%, 8%, 6%, 4%, 3%, 2%, 2%.

HUNTER TIES

As stated in [USEF HU154](#), in case of a tie the Championship and/or Reserve is awarded to the horse with the most points over fences. If horses have equal points over fences and no points under saddle, the tied horses will be asked to compete in a hack off (Exception: Green and Young Hunters.) Any competitor may concede and not hack off, or if both competitors agree, break the tie with a coin toss. If horses have an equal number of points over fences, under saddle, and model (i.e., Green Conformation Hunter 3'6" or High-Performance Conformation Hunter) the tie will stand as is and double ribbons will be awarded.

JUMPER TIES

As stated in [USEF JP143](#), Competitors who are tied for first place after the initial round(s) will jump off. Any competitors that compete in the jump off and are still tied for first place shall remain tied. Competitors who are tied for other than first place in all Jumper sections will be placed according to the time taken to complete the first course. Prize money and Championship points shall be combined and divided equally among the tied competitors. Double ribbons will be awarded for division championships. For special classes, the competitors will toss a coin for the ribbon and toss a coin for the special award if any.

JUMPER CLASS SCHEDULE TABLES

Jumper classes not otherwise designated in the class schedules will run as Table II.1, Table II.2.b or Table II.2.c, or Table II.d. Please refer to the daily schedules available in the Competition Office.

STAKE/HANDY HUNTER CLASSES

If a per class entry is offered in a division, horse and rider must have shown in at least one other class in the division to be eligible for the Stake or Handy Hunter Class.

HORSE ILLNESS

In the event of an acute and serious injury or illness of a horse on competition grounds when the owner or trainer of the horse is not present, after reasonable effort to contact that individual has been made, Competition Management, in consultation with a licensed veterinarian, may authorize the provision of emergency veterinary treatment of the horse. If Competition Management authorizes treatment under provisions of this rule, Competition Management and veterinarian are not responsible for any resulting costs, damages, losses, claims, or actions arising directly from the treatment of the horse.

SCHOOLING AND EXERCISE

Schooling areas are available for use before and during the show. All have sand footing. A mandatory schooling fee of \$35 is charged for all horses. Helmets meeting the US Equestrian requirements as well as riding boots must be worn during schooling.

No lungeing is permitted in any of the arenas including the warm-up rings. Please lunge horses on the designated lungeing pads located on the Horse Park near the west and northeast stalls.

WARM-UP RINGS

During competition days, please cede use of the warm-up rings to riders preparing for upcoming classes. When jumping, standards are cleared with the flags on the right, no reversing of directions. Horses approaching a jump must always be given priority. For your safety and the safety of others, always pass "left shoulder to left shoulder" when traveling opposite directions in the arena. More warm-up ring rules and best practices can be found at <https://practicalhorsemanmag.com/training/warm-up-ring-etiquette>

ARENAS & FOOTING

Grand Hunter: 250' X 255'; Hunter 2: 150' X 220'; Grand Jumper (covered): 150' X 300'. All have sand footing.

DOGS

We welcome your dogs at the shows! Keep your dogs and horses safe by always keeping your dogs on leash while on the Horse Park property. We kindly request you pick up after your dog. For their safety, do not let dogs run loose on trails. All dogs are eligible for our Cascade Canine Derby in July!

RVs, MOTORHOMES, TRAILERS, AND CAMPERS

Submit the [RV Site Request form](#) to request your site. RV sites are available by the week only (the night before schooling day through Sunday day only). Additional nights on either end of the reservation may be available for an additional fee with pre-approval. As hookup sites are limited, preference is given for length of stay, sponsors, reservation date, and size of RV. In the event all the hookup sites are reserved, additional requests will be accepted for non-hookup dry-camping sites.

Full payment is required for confirmed sites. Designated trainers having an account with Cascade Horse Shows may choose to add their personal RV site to their show bill to have us do trainer splits. [All other sites](#) must be pre-paid in advance at the time of confirmation. Charges apply to RV site whether hooked to utilities or not.

Upon arrival, an RV Pass must be obtained from Show Office and displayed. Hookup locations are assigned by us—if assigned a site with a hookup, park only in your designated site.

Tent campers must submit a [Tent Camping Request form](#) to request camping on the Horse Park grounds. Upon arrival, camping passes must be obtained from the Show Office and displayed. Campers must camp in designated areas only. See the Tent Camping Request form for fees.

MOTORIZED VEHICLES

Minors who do not have a valid driver's license which allows them to operate a motorized vehicle in the state in which they reside will not be permitted to operate a motorized vehicle of any kind, including, but not limited to, golf carts, motorcycles, scooters, or farm utility vehicles, on the competition grounds of licensed competitions. Minors who have a valid temporary license may operate the above-described motorized vehicles as long as they are accompanied by an adult with a valid driver's license. The parent/legal guardian or individual who signs the entry blank as a parent or guardian of a minor operating a motorized vehicle in violation of this rule are solely responsible for any damages, claims, losses, or actions resulting from that operation. Violations of this rule will be cause for penalties against those responsible for the child committing the offense. Wheelchairs and other mobility assistance devices for individuals with disabilities are exempt from this rule. The unsafe use of personal electronic transport devices, as determined by the competition officials and management in their sole discretion, that do not require a driver's license to operate, including but not limited to Segways, hover boards, and single wheeled scooters is prohibited on competition grounds. Operating such devices in areas where people gather may be deemed "unsafe use" if there is a risk of harm to others. If the operator of the device is a minor, the parent/legal guardian or

individual who signs the entry blank as a parent or guardian of a minor operating the device in violation of this rule is accountable and may be subject to penalties. Wheelchairs and other mobility assistance devices for individuals with disabilities are exempt from this rule.

HELMETS

It is compulsory for all persons at US Equestrian licensed hunter, jumper or hunter/jumper competitions when mounted anywhere on the competition grounds, to wear properly fastened protective headgear which meets or exceeds ASTM (American Society for Testing and Materials)/SEI (Safety Equipment Institute) standards for equestrian use and carries the SEI tag. It must be properly fitted with harness secure

SAFETY AND WELFARE

The nearest hospital is [Kittitas Valley Healthcare](#) which is 24 miles from the Washinton State Horse Park. The nearest level 1 trauma center is [Harborview Medical Center](#) in Seattle, WA which is 83 miles from the Washington State Horse Park.

DISCRETIONARY POLICY

All questions not covered in these rules and regulations shall be decided by Show Management whose decision shall be final.



OLSON'S IS YOUR PACIFIC NORTHWEST

Butet Saddle Dealer



The Portrait of Performance



VISIT OUR WEBSITE:

OLSONSTACK.COM

CALL OR TEXT:

425-454-9453





HORSEWARE®
IRELAND

Horse Therapy From Horseware

SPORTZ-VIBE MASSAGE THERAPY RUG



- Reduces pain and inflammation
- Improves blood supply to tissue
- Relaxes muscles
- Improves quality of life

www.sportzvibe.com



Massage Areas

ICE-VIBE CIRCULATION THERAPY



- Reduces soreness and swelling
- Helps boost circulation
- Stimulates healing
- Strengthens muscle tissue

www.icevibe.com

"We use the ICE-VIBE boots daily as part of our treatment plan on our grand prix horses."

-Richie Maloney *International Show Jumper*

Hunter Derbies

September 11, 2022

\$1,500 USHJA National Hunter Derby
Presented by Brick Road Farms

To be run at 3' with 3'5" options

September 10, 2022

\$1,000 Cascade Hunter Derby
Presented by Signature West Farms

To be run at 2'6" with 2'9" options

September 10, 2022

\$500 Jr./Amateur Hunt & Handy
Presented by HELITE Equestrian

To be run at 2' with 2'3" options

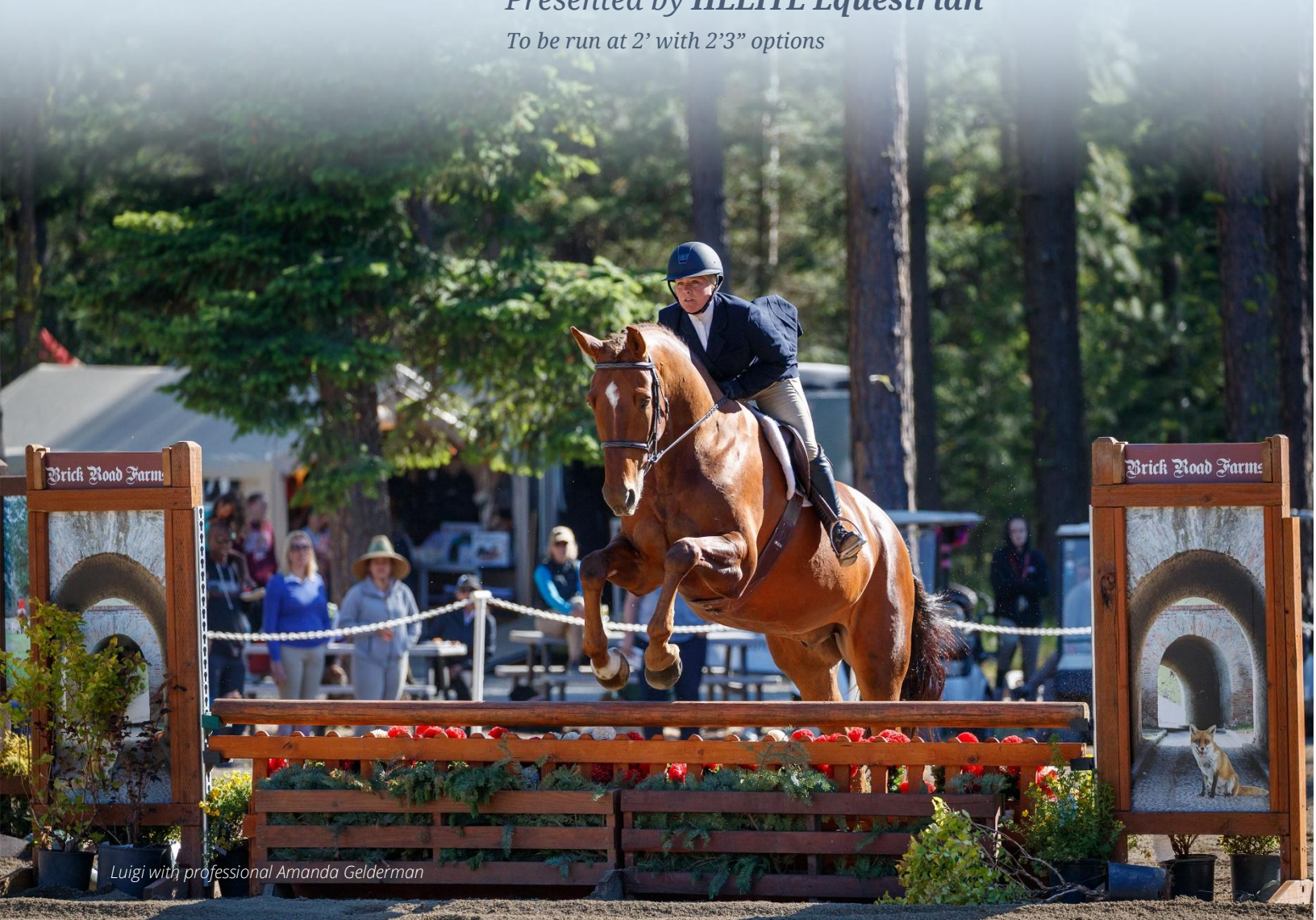

Luigi with professional Amanda Gelderman

SPOTLIGHT CLASSES

Class #	Class	Height	Entry Fee	Prize Money
3	USHJA National Hunter Derby Presented by BRICK ROAD FARMS	3' with 3'5" options	\$140/class	\$1,500
5	Cascade Mini Prix Presented by TNT FARRIER SERVICES	1.15m	\$150/class	\$2,000
10	Helite Junior/Amateur Hunt & Handy Presented by HELITE Equestrian	2' with 2'3" options	\$65/class	\$500
11	Rosé All Day Amateur Classic Presented by RANDI KIBBIE, U.S. BANK HOME MORTGAGE	N/A	\$50/class	\$500
20	Need for Speed™ Open Jumper 1.10 or 1.20m Presented by VOLTAIRE DESIGN	1.10 or 1.20m	\$75/class	\$750
21	Cascade Hunter Derby Presented by SIGNATURE WEST FARMS	2'6" with 2'9" options	\$100/class	\$1,000
23	Cascade Equitation Classic Presented by OLSON'S TACK SHOP	3', 3'3"	\$75/class	
24	Cascade Gambler's Choice 1.00m Presented by KLEAR MONT FARMS	1.00m	\$75/class	\$500

Formal Attire Required — Salute to Sponsors Requested
See full class specifications here: [Specifications](#) on page 42.



Vacation Homes & Cabins

Providing Premier Vacation Homes and Cabins for
Cle Elum, Roslyn, Suncadia Resort, & the Surrounding Areas



Book Direct and Save
The Longer You Stay
The More You Save
CALL 509-649-3099



www.GoASVR.com

Info@AllSeasonsVacationRents.com

SPOTLIGHT CLASSES

Rosé All Day Amateur Classic

Presented by **Randi Kibbie, U.S. Bank Home Mortgage**

September 10, 2022

Run in the spirit of a traditional Hunter Hack for all 21 and older amateur riders...
How much will be left in *your* glass?

The winner takes home a case of rosé wine, bottles to 8th place
Traditional attire encouraged; salute to sponsor requested



HUNTER DIVISION

USEF “B”-RATED HUNTER SECTIONS

Class #	Class (Section Code)	Height	Entry Fee	Prize Money
310, 311 ¹ , 312 ³	Performance Hunter 3’6” (C)	3’6”	\$150/section or \$55/class	\$100
315, 316 ¹ , 317 ³	Performance Hunter 3’3” (D)	3’3”	\$150/section or \$55/class	\$100
320, 321 ¹ , 322 ³	Green Hunter 3’9” (E)	3’9”	\$150/section or \$55/class	\$100
325, 326 ¹ , 327 ³	Green Hunter 3’6” (F)	3’6”	\$150/section or \$55/class	\$100
330, 331 ¹ , 332 ³	Green Hunter 3’3” (G)	3’3”	\$150/section or \$55/class	\$100
335, 336 ¹ , 337 ³	Green Hunter 3’ (H)	3’	\$150/section or \$55/class	\$100
360, 361 ¹ , 362 ³	Amateur Owner Hunter 18-35 3’6” (P)	3’6”	\$150/section or \$55/class	\$100
365, 366 ¹ , 367 ³	Amateur Owner Hunter 36 & Over 3’6” (M)	3’6”	\$150/section or \$55/class	\$100
370, 371 ¹ , 372 ³	Amateur Owner Hunter 18-35 3’3” (O)	3’3”	\$150/section or \$55/class	\$100
375, 376 ¹ , 377 ³	Amateur Owner Hunter 36 & Over 3’3” (N)	3’3”	\$150/section or \$55/class	\$100
380, 381 ¹ , 382 ³	Junior Hunter 15-17 3’6” (Q)	3’6”	\$150/section or \$55/class	\$100
385, 386 ¹ , 387 ³	Junior Hunter 14 & Under 3’6” (R)	3’6”	\$150/section or \$55/class	\$100
400, 401 ¹ , 402 ³	Junior Hunter 15-17 3’3” (U)	3’3”	\$150/section or \$55/class	\$100
405, 406 ¹ , 407 ³	Junior Hunter 14 & Under 3’3” (V)	3’3”	\$150/section or \$55/class	\$100

Class # footnotes: 1 = Handy; 2 = Stake; 3 = Under Saddle; italics = Conformation

Green Hunter: Reference [US Equestrian Rule Book HU](#) for Green Hunter Eligibility and Status. Jog for soundness. Horse may compete in only one green hunter fence height section at any one competition

Young Hunter: Reference [US Equestrian Rule Book HU](#) for Young Hunter Eligibility and Status. Not to Jog.

AO Hunters: Horses competing in 3’6” AO Hunters may not cross-enter 3’3” AO Hunters

Junior Hunter: A large Junior Hunter is over 16.0 hands, and a small Junior Hunter is 16.0 Hands and under. Junior Hunter 3’3” is open to junior riders. Riders may not cross-enter any class at 3’6” or higher in the Hunter division, higher than 3’9” in the Equitation division or higher than 1.20m in the Jumper division at the same competition. Horses entered in the Junior Hunter 3’3” section may not cross-enter the Junior Hunter 3’6” section at the same competition.

Sections may be combined if fewer than 4 entries in section.

ALL HUNTER CLASSES WILL BE JUDGED ON PERFORMANCE AND SOUNDNESS UNLESS OTHERWISE NOTED



TRAINING
PROGRAM

TRAINING AND SHOWING PROGRAM

RIDING
ACADEMY

RIDING LESSON PROGRAM

SUMMER
CAMPS

SUMMER - AGES 7+

LEGACY

Hunters & Jumpers

Shelly Kerron, Owner / Trainer

425.869.1527 | LEAGACYHUNTERSJUMPERS.COM | WOODINVILLE, WA

USEF “C” AND NON-RATED HUNTER SECTIONS

Class #	Class (Section Code)	Height	Entry Fee	Prize Money
425, 426, 427 ³	Adult Amateur Hunter 18-39 3' (Z)	3'	\$135/section or \$50/class	
430, 431, 432 ³	Adult Amateur Hunter 40 & Over 3' (AA)	3'	\$135/section or \$50/class	
435, 436, 437 ³	Children's Hunter 13 & Under 3' (AB)	3'	\$135/section or \$50/class	
440, 441, 442 ³	Children's Hunter 14-17 3' (AC)	3'	\$135/section or \$50/class	
445, 446, 447 ³	Children's Hunter Pony 2', 2'3", 2'6" (AD)	2', 2'3", 2'6"	\$135/section or \$50/class	
450, 451, 452 ³	Small Hunter 3' (AN)	3'	\$135/section or \$50/class	
455, 456, 457 ³	Thoroughbred Hunter 3' (AE)	3'	\$135/section or \$50/class	
460, 461, 462 ³	USHJA 2' Hunter (AF)	2'	\$135/section or \$50/class	
465, 466, 467 ³	USHJA 2'3" Hunter (AG)	2'3"	\$135/section or \$50/class	
470, 471, 472 ³	USHJA 2'6" Hunter (AH)	2'6"	\$135/section or \$50/class	
475, 476, 477 ³	USHJA 2'9" Hunter (AI)	2'9"	\$135/section or \$50/class	
480, 481, 482 ³	USHJA 3' Hunter (AJ)	3'	\$135/section or \$50/class	
500, 501, 502 ³	Short Stirrup Hunter Horse 17 & Under 2'3" (AK)	2'3"	\$135/section or \$50/class	
505, 506, 507 ³	Short Stirrup Hunter Pony 17 & Under 18" (AL)	18"	\$135/section or \$50/class	
510, 511, 512 ³	Long Stirrup Hunter 18 & Over 2'3" (AM)	2'3"	\$135/section or \$50/class	
520, 521, 522 ³	Pre-Children's/Adult Hunter 2'9" (AP)	2'9"	\$135/section or \$50/class	
525, 526, 527 ³	Low Children's Hunter 2'6" (AQ)	2'6"	\$135/section or \$50/class	
530, 531, 532 ³	Low Adult Hunter 2'6" (AS)	2'6"	\$135/section or \$50/class	

Class # footnotes: 1 = Handy; 2 = Stake; 3 = Under Saddle * Indicates a non-rated class.

AA Hunter: To be ridden by amateurs no longer eligible to compete as a Junior. See current [USHJA Zone 9 specifications](#) in this prize list or at [Zone-9 Specifications on USHJA.org](#).

Ponies may not cross into any other rated section at the same show. Riders may compete on a maximum of 1 Children's Hunter horse section at the same show and in any class not to exceed 3' (Exception: Pony Jumpers). Green & Regular Hunter Pony riders may compete on a maximum of 1 additional pony in the Children's Hunter Pony section at the same show.

USHJA Hunter: Open to all horses and ponies.

Short Stirrup: Rider no cross entry into any other classes except Low Under 3' Short Stirrup Equitation and Short Stirrup Pony or Short Stirrup Horse (as applicable to the class)

Long Stirrup: Riders no cross entry into rated classes 3' & up.

Pre-Children's/Adult Hunter: Rider no cross entry into rated sections or classes with fences 3'6" or higher. May be split by age group if entries warrant.

Low Children's / Low Adult Hunter: Please see full [Zone 9 specifications](#) for cross-entry restrictions.

Sections may be combined if fewer than 4 entries in section.

ALL HUNTER CLASSES WILL BE JUDGED ON PERFORMANCE AND SOUNDNESS UNLESS OTHERWISE NOTED.

HUNTER WARM-UP CLASSES (NON-RATED)

Class #	Class	Height	Entry Fee	Prize Money
605	Warm-Up Hunter 18", 2', 2'3"	18", 2', 2'3"	\$50/class	
615	Warm-Up Hunter 2', 2'3", 2'6"	2', 2'3", 2'6"	\$50/class	
635	Warm-Up Hunter 2'6", 2'9"	2'6", 2'9"	\$50/class	
645	Warm-Up Hunter 2'9", 3'	2'9", 3'	\$50/class	
655	Warm-Up Hunter 3', 3'3", 3'6"	3', 3'3", 3'6"	\$50/class	
665	Warm-Up Hunter 3'3", 3'6"	3'3", 3'6"	\$50/class	

Braiding is optional. Not to jog.

Owner/rider Kylie Mulligan with Ipswich Van Shuttershof performing in the 2021 Pacific Crest Preview. Photo: Gary Voth



OPPORTUNITY HUNTER (NON-RATED)

USEF / USHJA memberships and horse recording are not required.

Class #	Class	Height	Entry Fee	Prize Money
900	Opportunity Schooling		\$35/class	
950, 951, 952 ³	Opportunity Cross Pole Hunter		\$90/section or \$35/class	
955, 956, 957 ³	Opportunity Hunter 18"	18"	\$90/section or \$35/class	
960, 961, 962 ³	Opportunity Hunter 2'	2'	\$90/section or \$35/class	



For the Farmer in All of Us!™



THE GRANGE
FOR ALL YOUR HORSE NEEDS

Blankets,
Fly Sheets,
Feed & Treats,
Supplements,
Grooming Supplies,
and more!

145 NE GILMAN BLVD ISSAQUAH, WA 98027

(425) 392-6469 www.grangesupply.com shop.grangesupply.com



EQUITATION DIVISION

EQUITATION SECTIONS

Class #	Class (Section Code)	Height	Entry Fee
703, 704, 705 ³	Long Stirrup Equitation 2'3" (AU)	2'3"	\$135/section or \$50/class
706, 707, 708 ³	Short Stirrup Equitation Horse 2'3" (AV)	2'3"	\$135/section or \$50/class
709, 710, 711 ³	Short Stirrup Equitation Pony 18" (AW)	18"	\$135/section or \$50/class
712, 713, 714 ³	Children's Pony Equitation 2', 2'3", 2'6" (AX)	2', 2'3", 2'6"	\$135/section or \$50/class
715, 716, 717 ³	Low Children's Equitation 2'6" (AY)	2'6"	\$135/section or \$50/class
718, 719, 720 ³	Low Adult Equitation 2'6" (AZ)	2'6"	\$135/section or \$50/class
721, 722, 723 ³	Pre-Children's/Adult Equitation 2'9" (BA)	2'9"	\$135/section or \$50/class
724, 725, 726 ³	Adult Equitation 18-39 3' (BB)	3'	\$135/section or \$50/class
727, 728, 729 ³	Adult Equitation 40 & Over 3' (BC)	3'	\$135/section or \$50/class
730, 731, 732 ³	Equitation 14 & Under 3' (BD)	3'	\$135/section or \$50/class
733, 734, 735 ³	Equitation 15-17 3' (BE)	3'	\$135/section or \$50/class

Class # footnotes: 3 = Not to jump

* Ponies ride respective heights

OPPORTUNITY EQUITATION (NON-RATED)

USEF / USHJA memberships and horse recording are not required.

Class #	Class	Height	Entry Fee
910 ³	Opportunity Walk/Trot Equitation 17 & Under		\$35/class
915 ³	Opportunity Walk/Trot Equitation 18 & Over		\$35/class
925, 926, 927 ³	Opportunity Cross Pole Equitation		\$90/section or \$35/class
930, 931, 932 ³	Opportunity Equitation 18"	18"	\$90/section or \$35/class
935 ³ , 936, 937	Opportunity Equitation 2'	2'	\$90/section or \$35/class

Class # footnotes: 3 = Not to jump

Braiding is optional. Not to jog.

MEDAL CLASSES

Class #	Class	Height	Entry Fee
800	WSHJA Good Hands & Seat 2'6"	2'6"	\$50/class
801	WSHJA Good Hands & Seat 3'	3'	\$50/class
802	WSHJA Good Hands & Seat 3'6"	3'6"	\$50/class
804	Dover Saddlery/USEF Hunter Seat Medal 3'6"	3'6"	\$50/class
805	Hamel Foundation NHS Medal 3'3"	3'3"	\$50/class
806	EMO Insurance/USHJA Jumping Seat Medal 3'3"	3'3"	\$50/class
809	Ariat National Adult Medal 3'	3'	\$50/class

WSHJA Medals: Open to juniors and amateurs. Riders must be WSHJA members prior to the start of the class.

ASPCA Maclay: Open to junior members of USEF or Equine Canada who have not reached their 18th birthday in accordance with GR127. Riders and their trainers or coaches must be current members of the National Horse Show Association ("NHSAA").

Dover Saddlery/USEF Hunter Seat: Open to Individual Junior USEF Members in good standing who have not reached their 18th birthday in accordance with GR127.

Taylor Harris National Children's Medal: Riders not to compete in any hunter or equitation class 3'9" or higher, or jumper class set above 1.20m at same show

Ariat National Adult Medal: Riders not to compete over jumps that exceed 3'6" or 1.20m or higher at same show.

Marshall & Sterling U.S. Pony Medal: tests young riders, judging their ability to compete over a technical and demanding course of fences.

OHJA Mini Medal: No cross entry with 3' medals. Riders must be OHJA members prior to the start of the class.

OHJA Children's Medal: Riders may not cross-enter into junior hunters, junior jumpers, or any 3'6" medal class at the same show. Riders must be OHJA members prior to the start of the class.

OHJA Adult Medal: Riders must be OHJA members prior to the start of the class.



#1

SHINE SPRAY ON THE MARKET

“ THE QUALITY OF EQUIFUSE SHINE IS SIMPLY

perfection in a bottle.

IT'S THE ONLY COAT SHINE SPRAY I TRUST ON MY SENSITIVE MARE. ”



LINDSEY DENOBREGA, EQUIFUSE USER

JUMPER DIVISION

JUMPER CLASSICS

Class #	Class	Height	Entry Fee	Prize Money
60	Open Jumper Classic .60m, .70m, .80m	.60m, .70m, .80m	\$55/class	\$150
63	Open Jumper Classic .90m	.90m	\$55/class	\$150

Formal Attire Required — Salute to Sponsors Requested

Prize Money — 25%, 23%, 20%, 17%, 15%

Jumper Classic riders must have ridden in at least 1 other class to compete.

Junior Cayenne Patterson and Caliente competing in the Open Jumper Classic 1.0m during the 2019 Cascade Finals.

Photo: Gary Voth



JUMPER SECTIONS

Class #	Class	Height	Entry Fee	Prize Money
100, 101, 102, 103	Jumper .60m	.60m	\$180/section or \$50/class	
105, 106, 107, 108	Jumper .70m	.70m	\$180/section or \$50/class	
120, 121, 122, 123	Jumper .80m	.80m	\$180/section or \$50/class	
140, 141, 142	Jumper .90m	.90m	\$135/section or \$50/class	
160, 161, 162	Jumper 1.00m	1.00m	\$135/section or \$50/class	
170, 171, 172	Jumper 1.10m	1.10m	\$150/section or \$55/class	\$100
175, 176, 177	Jumper 1.15m	1.15m	\$150/section or \$55/class	\$100
180, 181, 182	Jumper 1.20m	1.20m	\$150/section or \$55/class	\$100
185, 186	Jumper 1.30m	1.30m	\$55/class	
230, 231, 232 ²	Thoroughbred Jumper 1.00m	1.00m	\$135/section or \$50/class	
240, 241, 242 ²	Mod. Junior/Amateur Jumper 1.15m	1.15m	\$150/section or \$55/class	Stake \$150
250, 251, 252	Low Adult Amateur Jumper .90m	.90m	\$135/section or \$50/class	
255, 256, 257	Low Children's Jumper .90m	.90m	\$135/section or \$50/class	
260, 261, 262	Low Adult Amateur Jumper 1.00m	1.00m	\$150/section or \$55/class	Stake \$150
265, 266, 267	Low Children's Jumper 1.00m	1.00m	\$150/section or \$55/class	Stake \$150
270, 271, 272 ²	High Adult Amateur Jumper 1.10m	1.10m	\$150/section or \$55/class	Stake \$150
275, 276, 277 ²	High Children's Jumper 1.10m	1.10m	\$150/section or \$55/class	Stake \$150

Class # footnotes: 2 = Stake

Stake Classes: Must have ridden in at least one other class in the same section at the same show to ride in any Stake Class

PNW Young Jumpers: Open to jumpers with papers indicating a foaling date the number of years as indicated prior to the current calendar year. WSHJA membership required to qualify for PNW championship. ^ = Clear rounds

Thoroughbred Jumper: Thoroughbred registration verification required according to USEF JP 120. Affiliated with the TAKE2 Thoroughbred League. Points count for USEF and TAKE2

Children's & Adult Amateur jumper riders may not cross-enter classes with fences over 1.15m

Low Children's & Low Adult Amateur horse and rider combinations may not cross-enter the High Children's & High Adult Amateur Jumpers

High Children's & High Adult Amateur horse and rider combinations may not cross-enter the Low Children's & Low Adult Amateur Jumpers

Sections may be split by age group if there are more than 5 horses in each section

SPOTLIGHT CLASSES

Need for Speed™ Open Jumper Classic

Presented by **Voltaire Design**

September 11, 2022

\$750.00 prize money to be distributed 1st through 8th

The winner receives \$500 in Voltaire Design accessories

Formal attire required; salute to sponsor requested

Danielle Bogardus and Naturelle.



CHAMPIONSHIPS OFFERED

Hunter Section Championships

Performance Hunter 3'6" (C)	Adult Amateur Hunter 18-39 3' (Z)	USHJA 2'9" Hunter (AI)
Performance Hunter 3'3" (D)	Adult Amateur Hunter 40 & Over 3' (AA)	USHJA 3' Hunter (AJ)
Green Hunter 3'9" (E)	Children's Hunter 13 & Under 3' (AB)	Short Stirrup Hunter Horse 17 & Under 2'3" (AK)
Green Hunter 3'6" (F)	Children's Hunter 14-17 3' (AC)	Short Stirrup Hunter Pony 17 & Under 18" (AL)
Green Hunter 3'3" (G)	Children's Hunter Pony 2', 2'3", 2'6" (AD)	Small Hunter 3'
Green Hunter 3' (H)	Thoroughbred Hunter 3'	Long Stirrup Hunter 18 & Over 2'3" (AM)
Amateur Owner Hunter 36 & Over 3'6" (M)	USHJA 2' Hunter (AF)	Pre-Children's/Adult Hunter 2'9" (AP)
Amateur Owner Hunter 36 & Over 3'3" (N)	USHJA 2'3" Hunter (AG)	Low Children's Hunter 2'6" (AQ)
Amateur Owner Hunter 18-35 3'3" (O)	USHJA 2'6" Hunter (AH)	Low Adult Hunter 2'6" (AS)
Amateur Owner Hunter 18-35 3'6" (P)		
Junior Hunter 15-17 3'3" (U)		
Junior Hunter 14 & Under 3'3" (V)		

Hunter Championships: Hunter champion and reserve will be awarded to two of the four horses scoring the most points over fences. In addition, only these top four horses will receive full points for ribbons won under saddle and half points for ribbons won in model. Points will be awarded 10, 6, 4, 2, 1, ½.

Equitation Section Championships

Long Stirrup Equitation 2'3" (AU)	Children's Pony Equitation 2', 2'3", 2'6" (AX)	Adult Equitation 18-39 3' (BB)
Short Stirrup Equitation Horse 2'3" (AV)	Low Children's Equitation 2'6" (AY)	Adult Equitation 40 & Over 3' (BC)
Short Stirrup Equitation Pony 18" (AW)	Low Adult Equitation 2'6" (AZ)	Equitation 14 & Under 3' (BD)
	Pre-Children's/Adult Equitation 2'9" (BA)	Equitation 15-17 3' (BE)

Equitation Championships: points for all classes shall be calculated 10, 6, 4, 2, 1, ½. In the case of a tie for champion or reserve, the winner shall be the entry with the most points over fences. If still tied, the entry with the most points in the equitation flat class will win the tie.

Jumper Section Championships

Jumper .60m	High Adult Amateur Jumper 1.10m	Low Children's Jumper .90m
Jumper .70m	High Children's Jumper 1.10m	Low Children's Jumper 1.00m
Jumper .80m	Low Adult Amateur Jumper .90m	Mod. Jr./Amateur Jumper 1.15m
Jumper .90m	Low Adult Amateur Jumper 1.00m	Thoroughbred Jumper 1.00m
Jumper 1.00m		
Jumper 1.10m		
Jumper 1.15m		
Jumper 1.20m		

Jumper Championships: in jumper championships, points for all classes shall be calculated 10, 6, 4, 2, 1, 1/2. In case of a tie for champion or reserve the tied entries shall remain tied and each receive a ribbon and trophy / prize.

All: At least three competitors must compete in the first class of a section for it to run.

Sections codes (in parentheses) allow convenient entry into all classes in section.

SPECIFICATIONS

Cascade Mini Prix, #5

The Grand Prix held at each Cascade show will be run as a Table II, Sec 2(a/b) — Time first with a jump off; ties to jump off for first place. Order of go will be drawn by Show Management under supervision of the USEF Steward and posted by 2pm the day of the class. Prize money will be distributed as 1st 30%, 2nd 20%, 3rd 14%, 4th 10%, 5th 8%, 6th 7%, 7th 6%, 8th 5% unless otherwise stated. Horses and riders must have competed in at least one other class in the competition. Formal attire required; salute to sponsors requested. *The Cascade Mini Prix is generously presented by TNT Farrier Services.*

USHJA National Hunter Derby, #3

The USHJA National Hunter Derby features a two-round format with a minimum of two judges utilizing a numerical system to score competitors in the Classic Hunter Round (first round) on performance, hunter pace, jumping style, quality and substance, and movement. A second round will feature a Handy Hunter course designed to reflect brilliance of pace and handiness. In each round, following the judges' base score, one point will be added for each high-option fence jumped; up to a maximum of four high options may be included. Fences are set at 3' with four high-option fences set at 3'5" (June) or 3'3" (July/September). Prize money will be distributed as: 1st 30%, 2nd 22%, 3rd 13%, 4th 8%, 5th 6%, 6th 5%, 7th 4%, 8th-9th 3%, 10th-12th 2% unless otherwise stated. The top 3 Amateurs/Juniors will also be recognized. Formal attire required; salute to sponsor requested. Full specs can be found in this document and with the United States Hunter Jumper Association. *The Cascade USHJA National Hunter Derby is generously presented by Brick Road Farms.*

Rosé All Day Amateur Classic, #11

Run in the spirit of a traditional Hunter Hack for all 21 & older amateur riders. A Hunter Hack is a type of English pleasure class where exhibitors in Hunt seat tack and attire perform on the flat at a walk, trot, canter, and hand gallop, and then jump two low fences. For this unique variation, riders may be asked to walk, trot, canter, change direction, sit the trot, halt & back up, and jump a cavalletti line, all while holding a glass of "rosé" wine! Class will be pinned on Judges Score adjusted for the "rosé" left in your glass. The winner also takes home a case of (real) rosé wine with bottles of rose' to 8th place. Traditional attire encouraged; salute to sponsor requested. *The Rosé All Day Amateur Classic is generously presented by Randi Kibbie, U.S. Bank Home Mortgage.*

Need For Speed™ Open Jumper, #20

The Need for Speed Open Jumper will be run as a Table III speed round, with faults converted into seconds. A time limit of 120 seconds will apply, and faults incurred will be penalized by adding four seconds for each occurrence. This class is offered at 1.10m and 1.20m. Entrants must designate which height they intend to compete in at the time they enter. At the 1.10m height a 2 second handicap will be added to each competitor's time. Prize money will be distributed as: 1st 30%, 2nd 20%, 3rd 14%, 4th 10%, 5th 8%, 6th 7%, 7th 6%, 8th 5% unless otherwise stated. Formal attire required; salute to sponsor requested. *The Need for Speed Open Jumper is generously presented by Voltaire Design.*

Cascade Hunter Derby 2'6", #21

The Cascade Hunter Derby features a two-round format with a minimum of two judges utilizing a numerical system to score competitors in the Classic Hunter Round (first round) on performance, hunter pace, jumping style, quality and substance, and movement. A second round will feature a Handy Hunter course designed to reflect brilliance of pace and handiness. In each round, following the judges' base score, one point will be added for each high-option fence jumped; up to a maximum of four high options may be included. Fences are set at 2'6" with four high-option fences set at 2'9". Prize money will be distributed as: 1st 30%, 2nd 22%, 3rd 13%, 4th 8%, 5th 6%, 6th 5%, 7th 4%, 8th-9th 3%, 10th-12th 2% unless otherwise stated. The top 3 Amateurs/Juniors will also be recognized. Formal attire required; salute to sponsor requested. *The Cascade Hunter Derby 2'6" is generously presented by Signature West Farms.*

Helite Junior/Amateur Hunt & Handy Classic, #10

In a single round, this class combines a classic Hunter course of 6-8 jumps immediately followed by a Handy course of 4-6 jumps for a total of 12 obstacles. The course will be set at 2'6" with 2'9" options unless otherwise posted. Competitors will be judged on performance, hunter pace, jumping style, quality and substance, movement, and handiness. One point is added to the final score for each high option taken. Prize money to be distributed as 1st 30%, 2nd 25%, 3rd 20%, 4th 15%, 5th 10%, with ribbons to 8th. Formal attire required; salute to sponsor requested. *The Junior/Amateur Hunt & Handy is generously presented by HELITE Equestrian.*

Cascade Equitation Classic, #23

Exhibitors will have the option of competing at 3' or 3'3". Both heights will perform over the same course of at least eight fences with and without wings, and the course must include at least one combination. All riders who complete the course will return for a flat phase during which riders may be asked to walk, trot (posting and sitting), canter, hand gallop, counter canter, lengthen and collect their horse's stride, shoulder in, haunches in, turn on the haunches, turn on the forehand, halt, and rein back. The flat phase shall count for 50% of the riders' overall score.

Cascade Gambler's Choice 1.00m, #24

Eight to ten obstacles will be set in the arena, each obstacle carries 10 to 120 points depending on its difficulty. Combinations are not allowed. Each obstacle must be built so they can be jumped in both directions. Each competitor will have 60 seconds to jump as many obstacles as they choose in either direction, each obstacle can be jumped a maximum of two times. The competitor is credited with the number of points carried by each obstacle they jump correctly. No points will be given if the jump is knocked down. A joker jump worth 200 points will be included in the course. See USEF rule JP 150 for further class detail. *The Cascade Gambler's Choice is generously presented by Klear Mont Farms.*

Cascade Open Jumper Classics, #60-64

Jumper Classic riders must have ridden in at least one other class in the corresponding section to compete. Open Jumper Classics are offered at .60m, .70m, .80m, .90m and 1.00m. Ribbons to 8th, prize money to 5th: (30%, 25%, 20%, 15%, 10%).

USHJA NATIONAL HUNTER DERBY SPECIFICATIONS



Course Requirements Jumps in ALL Rounds

1. Obstacles must simulate those reminiscent of the hunt field and course must offer a variety of Classic jumps with different appearances such as: natural post and rail, stone wall, white board fence or gate, coop, aiken, hedge, oxer, brush, logs, natural foliage.
2. Natural obstacles such as banks and ditches are allowed.
3. A minimum of 2" difference is required for the back element of all oxers.
4. Ground lines are not to exceed 18" in depth from the vertical plane of the jump. For appropriate jumps, no ground line is necessary.
5. The jumpable portion of any fence must be a minimum of 8 feet on its front face.
6. Flat cups may only be used for log fences and in accordance with Federation rules.
7. Distances will not be adjusted for ponies.
8. Fence height 3'0".
9. There must be four option fences set at 3'5".

First Round: Classic Hunter Course

1. A minimum of ten obstacles must be offered in the Classic Hunter Round.
2. At least one in and out
3. At least one bending line
4. At least one line with an unrelated distance
5. At least one long approach

Second Round: Handy Hunter Course

1. A minimum of eight obstacles must be offered in the Handy Hunter Round.
2. The course should simulate riding over hunt country and must have a minimum of two handy options, such as: tight turns, different tracks, clever options for jump approaches, pen type obstacles, hand gallop a jump, trot a lowered obstacle not to exceed 2'6" in height, halt and/or back. Gimmicky options are not appropriate.
3. Unless the prize list states that more than 12 entries are to return for the second round, then only the top 12 horses from the first round, after all ties are broken, are eligible to return for the second round.

Class Specifications

1. All riders in the top twelve overall (or their designated representative if not available) must ride for ribbons to receive prize money. Although not required, a show may choose to award separate ribbons for the first-round if so stated in the prize list.

2. For National Hunter Derby zone HOTY bonus points to be awarded, riders must complete a USHJA Exhibitor Declaration Form. If the Exhibitor Declaration Form is not completed and submitted to the show office at the time of entry or at least one hour prior to the start of the class, riders will not receive zone HOTY bonus points for the National Hunter Derby.
3. Points accrued by horses shown by Professionals may be awarded to the declared Green Hunter 3' or 3'3" section or Performance Hunter 3'3" or Small Hunter.
4. Points accrued by horses shown by Juniors or Amateurs may be awarded to the declared Green 3' or 3'3" section, Performance Hunter 3'3", or the applicable Children's, Pony, Adult Amateur or Amateur Owner 3'3", Small Hunter, or Junior Hunter 3'3".

Judging System

1. First Round - Judged on performance, hunter pace, jumping style, quality and substance, and movement. After the judge's base score is given, one point will be added for each high option fence jumped. The Option Bonus Score of one additional point must be awarded even if there is a refusal, rail down or loss of good jumping style at that higher height option fence, providing that the horse-and-rider combination does jump the higher height option fence. (Maximum of four points.)
2. Second Round - Judged on performance, hunter pace, jumping style, quality and substance, movement, handiness, and brilliance of pace. Handiness is defined as ground saving movement without adversely affecting performance or style. Brilliance of pace is defined as a faster pace than ordinary, without sacrificing performance or style. Handiness is considered in the judges' base score. After the judges' base score is given, one point will be added for each high option fence jumped. The Option Bonus Score of one additional point must be awarded even if there is a refusal, rail down or loss of good jumping style at that higher height option fence, providing that the horse-and-rider combination. (Maximum of four points.)

Membership Requirements

1. Riders, owners, and trainers must be a current Active member of USEF and USHJA to participate in this class. (see GR202).
2. Horses and ponies must be registered with USHJA to participate in this class. Exception: Foreign residents and horses and ponies in good standing with their National Federation are eligible to compete in this class.
3. USHJA Zone HOTY bonus points will only be awarded if the owner is a current Active member of USEF, has completed a USHJA Exhibitor Declaration Form and the horse is recorded with USEF and registered with USHJA.

For Full USHJA National Hunter Derby Specifications see: <https://ushja.org/competition/hunter/national-hunter-derby>



**Excited to be a Sponsor & Vendor at
Cascade's Cle Elum Shows!**



2221 NE 3rd St · Bend, Oregon · 541-388-3855 · www.TheAbsoluteHorse.com · AbsoluteHorse@gmail.com

much more than just a feed store

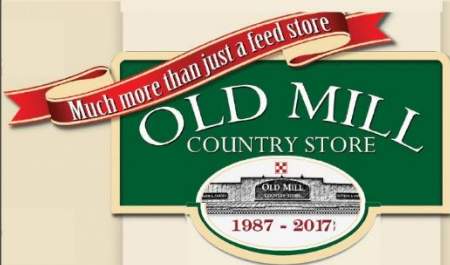

Open 7 Days A Week
509-925-5397 • 500 W. Third

Whether it's for commercial use or for the animals in your back yard, let our knowledgeable staff help find you the right product to keep your animals healthy and happy.



Old Mill Country Store is your total source supplier of cutting edge animal health and nutrition products

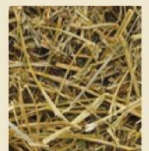



CASCADE FINALS

September 9-11, 2022

USEF #334509

SCHEDULES: CASCADE FINALS

September 9-11, 2022

2022 Cascade Finals

Friday, September 9, 2022

Grand Hunter Arena

Presented by Ariat International

8:00 AM

- 655 Warm-Up Hunter 3', 3'3", 3'6"
- 310 Performance Hunter 3'6"
- 311 Performance Hunter 3'6" Handy
- 315 Performance Hunter 3'3"
- 316 Performance Hunter 3'3" Handy
- 320 Green Hunter 3'9"
- 321 Green Hunter 3'9" Handy
- 325 Green Hunter 3'6"
- 326 Green Hunter 3'6" Handy
- 330 Green Hunter 3'3"
- 331 Green Hunter 3'3" Handy
- 335 Green Hunter 3'
- 336 Green Hunter 3' Handy
- 337 Green Hunter 3' U/S
- 332 Green Hunter 3'3" U/S
- 327 Green Hunter 3'6" U/S
- 322 Green Hunter 3'9" U/S
- 317 Performance Hunter 3'3" U/S
- 312 Performance Hunter 3'6" U/S
- 480, 481 USHJA 3' Hunter
- 455, 456 Thoroughbred Hunter 3'
- 450, 451 Small Hunter 3'
- 482 USHJA 3' Hunter U/S
- 457 Thoroughbred Hunter 3' U/S
- 452 Small Hunter 3' U/S
- 635 Warm-Up Hunter 2'6", 2'9"
- 475, 476 USHJA 2'9" Hunter
- 477 USHJA 2'9" Hunter U/S
- 470, 471 USHJA 2'6" Hunter
- 472 USHJA 2'6" Hunter U/S
- 605 Warm-Up Hunter 18", 2', 2'3"
- 465, 466 USHJA 2'3" Hunter
- 467 USHJA 2'3" Hunter U/S
- 460, 461 USHJA 2' Hunter
- 462 USHJA 2' Hunter U/S

Cascade Hunter Arena

Presented by Legacy Hunters & Jumpers

8:00 AM

- 900 Opportunity Schooling O/F

Grand Jumper Arena

Presented by Farpoint Farm in honor of Kona Coast

8:00 AM

- 160 Jumper 1.00m II.2b
- 161 Jumper 1.00m II.1
- 230 Thoroughbred Jumper 1.00m II.2b
- 231 Thoroughbred Jumper 1.00m II.1
- 170 Jumper 1.10m II.2b
- 171 Jumper 1.10m II.1
- 175 Jumper 1.15m II.2b
- 176 Jumper 1.15m II.1
- 240 Mod. Junior/Amateur Jumper 1.15m II.2b
- 241 Mod. Junior/Amateur Jumper 1.15m II.1
- 180 Jumper 1.20m II.2b
- 185 Jumper 1.30m II.2b
- 100 Jumper .60m II.2b
- 101 Jumper .60m II.1
- 105 Jumper .70m II.2b
- 106 Jumper .70m II.1
- 120 Jumper .80m II.2b
- 121 Jumper .80m II.1
- 140 Jumper .90m II.2b
- 141 Jumper .90m II.1

2022 Cascade Finals

Saturday, September 10, 2022

Grand Hunter Arena

Presented by Ariat International

8:00 AM

- 615 Warm-Up Hunter 2', 2'3", 2'6"
- 445, 446 Children's Hunter Pony 2', 2'3", 2'6" (respective heights)
- 447 Children's Hunter Pony 2', 2'3", 2'6" U/S (respective heights)
- 505, 506 Short Stirrup Hunter Pony 17 & Under 18"
- 507 Short Stirrup Hunter Pony 17 & Under 18" U/S
- 500, 501 Short Stirrup Hunter Horse 17 & Under 2'3"
- 510, 511 Long Stirrup Hunter 18 & Over 2'3"
- 512 Long Stirrup Hunter 18 & Over 2'3" U/S
- 502 Short Stirrup Hunter Horse 17 & Under 2'3" U/S
- 525, 526 Low Children's Hunter 2'6"
- 530, 531 Low Adult Hunter 2'6"
- 527 Low Children's Hunter 2'6" U/S
- 532 Low Adult Hunter 2'6" U/S
- 645 Warm-Up Hunter 2'9", 3'
- 520, 521 Pre-Children's/Adult Hunter 2'9"
- 522 Pre-Children's/Adult Hunter 2'9" U/S
- 425, 426 Adult Amateur Hunter 18-39 3'
- 430, 431 Adult Amateur Hunter 40 & Over 3'
- 435, 436 Children's Hunter 13 & Under 3'
- 440, 441 Children's Hunter 14-17 3'
- 427 Adult Amateur Hunter 18-39 3' U/S
- 432 Adult Amateur Hunter 40 & Over 3' U/S
- 437 Children's Hunter 13 & Under 3' U/S
- 442 Children's Hunter 14-17 3' U/S
- 665 Warm-Up Hunter 3'3", 3'6"
- 370 Amateur Owner Hunter 18-35 3'3"
- 371 Amateur Owner Hunter 18-35 3'3" Handy
- 375 Amateur Owner Hunter 36 & Over 3'3"
- 376 Amateur Owner Hunter 36 & Over 3'3" Handy
- 400 Junior Hunter 15-17 3'3"
- 401 Junior Hunter 15-17 3'3" Handy
- 405 Junior Hunter 14 & Under 3'3"
- 406 Junior Hunter 14 & Under 3'3" Handy
- 360 Amateur Owner Hunter 18-35 3'6"
- 361 Amateur Owner Hunter 18-35 3'6" Handy
- 365 Amateur Owner Hunter 36 & Over 3'6"
- 366 Amateur Owner Hunter 36 & Over 3'6" Handy
- 380 Junior Hunter 15-17 3'6"
- 381 Junior Hunter 15-17 3'6" Handy
- 385 Junior Hunter 14 & Under 3'6"
- 386 Junior Hunter 14 & Under 3'6" Handy
- 372 Amateur Owner Hunter 18-35 3'3" U/S
- 377 Amateur Owner Hunter 36 & Over 3'3" U/S
- 402 Junior Hunter 15-17 3'3" U/S
- 407 Junior Hunter 14 & Under 3'3" U/S
- 362 Amateur Owner Hunter 18-35 3'6" U/S
- 367 Amateur Owner Hunter 36 & Over 3'6" U/S
- 382 Junior Hunter 15-17 3'6" U/S

- 387 Junior Hunter 14 & Under 3'6" U/S
- 10 **Helite Junior/Amateur Hunt & Handy**
Presented by HELITE EQUESTRIAN
- 21 **Cascade Hunter Derby**
Presented by SIGNATURE WEST FARMS
- 805 Hamel Foundation NHS Medal 3'3"
- 23 **Cascade Equitation Classic**
Presented by OLSON'S TACK SHOP

Cascade Hunter Arena

Presented by Legacy Hunters & Jumpers

TBA

- 915 Opportunity Walk/Trot Equitation 18 & Over Not to jump
- 910 Opportunity Walk/Trot Equitation 17 & Under Not to jump
- 950, 951 Opportunity Cross Pole Hunter O/F
- 952 Opportunity Cross Pole Hunter Not to jump
- 955, 956 Opportunity Hunter 18" O/F
- 957 Opportunity Hunter 18" Not to jump
- 960, 961 Opportunity Hunter 2' O/F
- 962 Opportunity Hunter 2' Not to jump
- 11 **Rosé All Day Amateur Classic**
Presented by RANDI KIBBIE, U.S. BANK HOME MORTGAGE

Grand Jumper Arena

Presented by Farpoint Farm in honor of Kona Coast

8:00 AM

- 806 EMO Insurance/USHJA Jumping Seat Medal 3'3"
- 162 Jumper 1.00m II.2b
- 232 Thoroughbred Jumper 1.00m Stake II.2b
- 260 Low Adult Amateur Jumper 1.00m II.2b
- 261 Low Adult Amateur Jumper 1.00m II.1
- 265 Low Children's Jumper 1.00m II.2b
- 266 Low Children's Jumper 1.00m II.1
- 172 Jumper 1.10m II.2b
- 270 High Adult Amateur Jumper 1.10m II.2b
- 271 High Adult Amateur Jumper 1.10m II.2a
- 275 High Children's Jumper 1.10m II.2b
- 276 High Children's Jumper 1.10m II.2a
- 177 Jumper 1.15m II.2b
- 242 Mod. Junior/Amateur Jumper 1.15m Stake II.2b
- 181 Jumper 1.20m II.1
- 186 Jumper 1.30m II.1
- 5 **Cascade Mini Prix II.2a**
Presented by TNT Farrier Services
- 102 Jumper .60m II.2b
- 103 Jumper .60m II.1
- 107 Jumper .70m II.2b
- 108 Jumper .70m II.1
- 122, 123 Jumper .80m II.2b
- 142 Jumper .90m II.2b
- 255 Low Children's Jumper .90m II.2b
- 256 Low Children's Jumper .90m II.1
- 250 Low Adult Amateur Jumper .90m II.2b
- 251 Low Adult Amateur Jumper .90m II.1

2022 Cascade Finals

Sunday, September 11, 2022

Grand Hunter Arena

Presented by Ariat International

8:00 AM

- 3 **USHJA National Hunter Derby**
Presented by BRICK ROAD FARMS
- 724, 725 Adult Equitation 18-39 3' O/F
- 727, 728 Adult Equitation 40 & Over 3' O/F
- 804 Dover Saddlery/USEF Hunter Seat Medal 3'6"
- 730, 731 Equitation 14 & Under 3' O/F
- 733, 734 Equitation 15-17 3' O/F
- 726 Adult Equitation 18-39 3' Not to jump
- 729 Adult Equitation 40 & Over 3' Not to jump
- 732 Equitation 14 & Under 3' Not to jump
- 735 Equitation 15-17 3' Not to jump
- 801 WSHJA Good Hands & Seat 3'
- 809 Ariat National Adult Medal 3'
- 802 WSHJA Good Hands & Seat 3'6"
- 709, 710 Short Stirrup Equitation Pony 18" O/F
- 711 Short Stirrup Equitation Pony 18" Not to jump
- 703, 704 Long Stirrup Equitation 2'3" O/F
- 706, 707 Short Stirrup Equitation Horse 2'3" O/F
- 705 Long Stirrup Equitation 2'3" Not to jump
- 708 Short Stirrup Equitation Horse 2'3" Not to jump
- 712, 713 Children's Pony Equitation 2', 2'3", 2'6" O/F
(respective heights)
- 714 Children's Pony Equitation 2', 2'3", 2'6"
Not to jump
- 715, 716 Low Children's Equitation 2'6" O/F
- 718, 719 Low Adult Equitation 2'6" O/F
- 800 WSHJA Good Hands & Seat 2'6"
- 717 Low Children's Equitation 2'6" Not to jump
- 720 Low Adult Equitation 2'6" Not to jump
- 721, 722 Pre-Children's/Adult Equitation 2'9" O/F
- 723 Pre-Children's/Adult Equitation 2'9" Not to jump

Cascade Hunter Arena

Presented by Legacy Hunters & Jumpers

Upon conclusion of USHJA Derby

- 925, 926 Opportunity Cross Pole Equitation O/F
- 927 Opportunity Cross Pole Equitation Not to jump
- 930, 931 Opportunity Equitation 18" O/F
- 932 Opportunity Equitation 18" Not to jump
- 935 Opportunity Equitation 2' Not to jump
- 936, 937 Opportunity Equitation 2' O/F

Grand Jumper Arena

Presented by Farpoint Farm in honor of Kona Coast

Upon conclusion of USHJA Derby

- 24 **Cascade Gambler's Choice 1.00m III**
Presented by KLEAR MONT FARMS
- 262 Low Adult Amateur Jumper 1.00m Stake II.2b
- 267 Low Children's Jumper 1.00m Stake II.2b
- 272 High Adult Amateur Jumper 1.10m Stake II.2b
- 277 High Children's Jumper 1.10m Stake II.2b
- 20 **Need for Speed™ Open Jumper 1.10 or 1.20m III**
Presented by VOLTAIRE DESIGN
- 182 Jumper 1.20m II.2b
- 63 Open Jumper Classic .90m II.2a
- 252 Low Adult Amateur Jumper .90m II.1
- 257 Low Children's Jumper .90m II.1
- 60 Open Jumper Classic .60m, .70m, .80m II.2b



RELEASE OF LIABILITY FOR PROPERTY DAMAGE, PERSONAL INJURY OR DEATH

I **choose to participate voluntarily** in Equine Activities, as that term is defined in the [Revised Code of Washington \(RCW\) 4.24.530\(2\)](#), at the **Washington State Horse Park** ("WSHP"). The WSHP is an equine activity sponsor, as that term is defined in [RCW 4.24.530\(3\)](#). I am fully aware of and acknowledge that Equine Activities involve inherent dangerous risks of accident, loss, and serious bodily injury including broken bones, head injuries, trauma, pain, suffering or death ("Harm").

I **agree** to release WSHP Authority and the individual WSHP Board members and the WSHP Foundation and the individual WSHP Foundation Board Members, their agents, assigns, employees and contractors and members, the City of Cle Elum and Sun Communities (hereinafter collectively referred to as the "Released Parties") from all claims for money damages or loss for any Harm to me, my injury or death, the injury or death of my child(ren) named below ("Child") or my horse or for any Harm caused by me or my horse to others, even if the Harm, directly or indirectly, resulted from the negligence of the Released Parties.

I **agree** to expressly assume all risks of Harm to me or my child or my horse.

I **agree** to indemnify the Released Parties and to hold them harmless from all claims, causes of action and money damages resulting from Harm to me, my Child, or my horse while I am participating in Equine Activities at the WSHP facility.

Under Washington State law, except as provided in RCW 4.24.540(2), an equine activity sponsor or an equine professional shall not be liable for an injury or the death of a participant engaged in an equine activity, and, except as provided in subsection(s) of this section, no participant nor participant's representative may maintain an action against or recover from an equine activity sponsor or an equine professional for an injury to or the death of a participant engaged in an equine activity.

I **have read and understand** the Rules and Regulations of WSHP that are posted on the WSHP property. I understand these rules and regulations of WSHP will be changed from time to time and I agree to abide by the changed rules. I represent that I and/or my child have the requisite training, coaching and ability to participate safely in the activities we chose to pursue at WSHP.

RELEASE OF PHOTOGRAPHIC AND VIDEO IMAGES

I **hereby give permission** to WSHP and those acting with its authority the unrestricted right and permission to use, publish and republish any photographic or video images of me and/or my horse for promotional and marketing purposes of the Horse Park. I also permit the use of any printed material in connection therewith and relinquish any right to review or restrict its use or publication.

I **read and understand these Releases, and my handwritten or digital signature below signifies my acceptance of their terms and conditions. I agree these Releases shall remain in full force and effect until they are specifically revoked by me in writing or superseded by new releases issued by the Horse Park and signed by me. Electronic delivery of this document shall be legally binding, the same as delivery of an original.**

Name of Event: _____ Event Date(s): _____

Participant's Name: _____ DOB if under 18: _____

Participant's Signature: _____ Date: _____

If Event Participant is under 18 years of age, his/her parent must sign on his/her behalf below:

Parent's Name: _____

Parent's Signature: _____ Date: _____

Signer's Home Address: _____

City: _____ State: _____ Zip Code: _____



WAIVER AND RELEASE OF LIABILITY, ASSUMPTION OF RISK AND INDEMNITY AGREEMENT

For and in consideration of United States Equestrian Federation, Inc. dba US Equestrian ("USEF") allowing me, the undersigned, to participate in any capacity (including as a rider, driver, handler, vaulter, longeur, lessee, owner, agent, coach, official, trainer or volunteer) in a USEF sanctioned, licensed or approved event or activity, including but not limited to equestrian clinics, practices, shows, competitions and related or incidental activities and ("USEF Event" or "USEF Events"); I, for myself, and on behalf of my spouse, children, heirs and next of kin, and any legal and personal representatives, executors, administrators, successors,, and assigns, hereby agree to and make the following contractual representations pursuant to this Agreement (the "Agreement"):

A. RULES AND REGULATIONS: I hereby agree that I have read, understand, and agree to be bound by all applicable Federation Bylaws, rules, and policies including the USEF Safe Sport Policy and Minor Athlete Abuse Prevention Policies (MAAPP) as published at www.usef.org, as amended from time to time.

B. ACKNOWLEDGMENT OF RISK: I knowingly, willingly, and voluntarily acknowledge the inherent risks associated with the sport of equestrian and know that horseback riding and related equestrian activities are inherently dangerous, and that participation in any USEF Event involves risks and dangers including, without limitation, the potential for serious bodily injury (including broken bones, head or neck injuries), sickness and disease (including communicable diseases), trauma, pain & suffering, permanent disability, paralysis and death; loss of or damage to personal property (including my mount & equipment) arising out of the unpredictable behavior of horses; exposure to extreme conditions and circumstances; accidents involving other participants, event staff, volunteers or spectators; contact or collision with other participants and horses, natural or manmade objects; adverse weather conditions; facilities issues and premises conditions; failure of protective equipment (including helmets); inadequate safety measures; participants of varying skill levels; situations beyond the immediate control of the USEF Event organizers and competition management; and other undefined, not readily foreseeable and presently unknown risks and dangers ("Risks").

EQUINE ACTIVITY LIABILITY ACT WARNING:

CAUTION: HORSEBACK RIDING AND EQUINE ACTIVITIES CAN BE DANGEROUS. RIDE AT YOUR OWN RISK.

Under the laws of most States, an equine activity sponsor or equine professional is not liable for any injury to, or the death of, a participant in equine activities resulting from the inherent risks of equine activities.

C. ASSUMPTION OF RISK: I understand that the aforementioned Risks may be caused in whole or in part or result directly or indirectly from the negligence of my own actions or inactions, the actions or inactions of others participating in the USEF Events, or the negligent acts or omissions of the Released Parties defined below, and I hereby voluntarily and knowingly assume all such Risks and responsibility for any damages, liabilities, losses, or expenses that I incur as a result of my participation in any USEF Events. I also agree to be responsible for any injury or damage caused by me, my horse, my employees or contractors under my direction and control at any USEF Event.

D. WAIVER AND RELEASE OF LIABILITY, HOLD HARMLESS AND INDEMNITY: In conjunction with my participation in any USEF Event, I hereby release, waive and covenant not to sue, and further agree to indemnify, defend and hold harmless the following parties: USEF, USEF Recognized Affiliate Associations, the United States Olympic & Paralympic Committee (USOPC), USEF clubs, members, Event participants (including athletes/riders, coaches, trainers, judges/officials, and other personnel), the Event owner, licensee, and competition managers; the promoters, sponsors, or advertisers of any USEF Event; any charity or other beneficiary which may benefit from the USEF Event; the owners, managers, or lessors of any facilities or premises where a USEF Event may be held; and all directors, officers, employees, agents, contractors, and volunteers of any of the aforementioned parties (**Individually and Collectively, the "Released Parties" or "Event Organizers"**), with respect to any liability, claim(s), demand(s), cause(s) of action, damage(s), loss, or expense (including court costs and reasonable attorney fees) of any kind or nature ("**Liability**") which may arise out of, result from, or relate in any way to my participation in the USEF Events, including claims for Liability caused in whole or in part by the negligent acts or omissions of the Released Parties.

E. COMPLETE AGREEMENT AND SEVERABILITY CLAUSE: This Agreement represents the complete understanding between the parties regarding these issues and no oral representations, statements or inducements have been made apart from this Agreement. If any provision of this Agreement is held to be unlawful, void, or for any reason unenforceable, then that provision shall be deemed severable from this Agreement and shall not affect the validity and enforceability of any remaining provisions.

I HAVE CAREFULLY READ THIS DOCUMENT IN ITS ENTIRETY, UNDERSTAND ALL OF ITS TERMS AND CONDITIONS, AND KNOW IT CONTAINS AN ASSUMPTION OF RISK, RELEASE AND WAIVER FROM LIABILITY, AS WELL AS A HOLD HARMLESS AND INDEMNIFICATION OBLIGATIONS.

By signing below, I (as the participant or as the Parent/Legal Guardian of the minor identified below) hereby accept and agree to the terms and conditions of this Agreement in connection with my (or the minor's) participation in any USEF Event. If, despite this Agreement, I, or anyone on my behalf or the minor's behalf, makes a claim for Liability against any of the Released Parties, I will indemnify, defend and hold harmless each of the Released Parties from any such Liabilities as the result of such claim.

The parties agree that this agreement may be electronically signed. The parties agree that the electronic signatures appearing on this agreement are the same as handwritten signatures for the purposes of validity, enforceability, and admissibility.

RIDER/DRIVER/HANDLER/VAULTER/LONGEUR OWNER TRAINER OFFICIAL STAFF VOLUNTEER COACH (IF APPLICABLE)

Signature: _____ Date: _____

Print Name: _____

Parent/Guardian Signature: (Required if Rider/Driver/Handler/Vaulter/Longeur is a minor) _____ Date: _____

Print Parent//Guardian Name: _____ Emergency Contact Phone No. _____

6.17.20

UNITED STATES EQUESTRIAN FEDERATION : 4001 WING COMMANDER WAY : LEXINGTON, KY 40511 : 859.258.2472 : FAX 859.231.6662 : USEF.ORG



Credit Card Authorization Form

Please complete all fields.

You may cancel this authorization at any time by contacting:

office@cascadehorseshows.com

This authorization will remain in effect until it is cancelled.

Name(s) of horse(s): _____
(to credit funds to) _____

Credit Card Information	
Card Type	<input type="checkbox"/> MasterCard <input type="checkbox"/> VISA <input type="checkbox"/> Discover <input type="checkbox"/> AMEX
Cardholder Name (as shown on card)	
Card Number	
Expiration Date (MM/YY)	CVV Code
Cardholder Billing Address ZIP Code	

I, _____, authorize Cascade Horse Shows LLC to charge my credit card above for agreed upon charges. I understand that I will be charged a 3.5% credit card service charge and that my information will be saved on file for future transactions on my Cascade Horse Shows LLC account.

Customer Signature

Date

Please send completed authorizations to: office@cascadehorseshows.com

USHJA Zone 9 Specifications

(MT, WY, ID, OR, WA)



In accordance with GR1111.4: CA, NV, UT, CO, ND, SD, NE, and Canada are contiguous states.

JUDGING FOR ALL HUNTER AND EQUITATION SECTIONS:

- To be judged on performance and soundness, suitability to count.
- Horses and Ponies are not required to jog for soundness.
- In Equitation: to be judged on performance, style, form and suitability of horse and rider to count

ELIGIBILITY FOR ADULT AMATEURS: HUNTER, JUMPER, AND EQUITATION:

- To be ridden by exhibitors who have reached their 18th birthday as of December 1 of the current competition year and who hold a current USEF Amateur certification. Open to horses and ponies.

ELIGIBILITY FOR CHILDREN'S SECTIONS: HUNTER, JUMPER, AND EQUITATION:

- To be ridden by exhibitors who have not reached their 18th birthday as of December 1 of the current competition year

ADULT AMATEUR HUNTER

Sections offered and requirements: • Adult Amateurs – may be split into three (3) sections Cross Entry: Riders: Amateur Owner Hunter riders may compete on a maximum of one (1) Adult Amateur Hunter horse that they own at the same competition. Riders may not show in any classes in which the fences are 3'9" and over at the same competition. Horses: Horses entered in Adult Amateur Hunter sections may not compete in the Amateur Owner Hunter sections at the same competition. Horse and Rider Combination: Horse and rider combinations may not cross enter into the Amateur Owner Hunter sections. Fence height: • 3'0" with spreads not to exceed the fence height. • Courses will not be adjusted for ponies. • Combinations will be permitted Combining/Dividing Sections: • Refer to HU137 Awards: Zone Horse of the Year Awards will be presented annually to the following sections: • Adult Amateur Hunter 18- 39 • Adult Amateur 40- 55 • Adult Amateur 56 & over

LOW ADULT AMATEUR HUNTER

Eligibility: Open to exhibitors who have reached their 18th birthday as of December 1 of the current competition year. Cross Entry: Riders: Riders may not cross enter into any class or section at the same competition where fences exceed 2'9". Fence Height: • 2'6" • Low Adult Amateur Hunter Combining/Dividing Sections: The Low Adult Amateur Hunter and Low Children's Hunter sections may be combined if there are fewer than three (3) entries in either section. Awards: Zone Horse of the Year Awards will be presented annually to the following section: • Low Adult Amateur Hunter

ADULT AMATEUR JUMPER

Sections offered and requirements: • Low Adult Amateur Jumper • High Adult Amateur Jumper Cross Entry: Rider: Riders may not show in any classes where the jumps exceed 1.20m. Horse/Pony n/chila Horse and Rider Combination: Low Adult Amateur horse and rider combinations may not cross enter into the High Adult Amateur Jumper section at the same competition. High Adult Amateur horse and rider combinations may not cross enter into the Low Adult Amateur Jumper section at the same competition. Fence Height: • Low Adult Amateur Jumper: 0.90m to 1.00m • High Adult Amateur Jumper: 1.10m to 1.15m Combining/Dividing Sections: Adult Amateur Jumper sections may be divided by or combined with Children's Jumper sections, at competition management's discretion, if so stated in the prize list. Awards: Zone Horse of the Year Awards will be presented annually to the following sections: • Low Adult Amateur Jumper • High Adult Amateur Jumper

EQUITATION: ADULT SECTION

Sections Offered: • Adult Equitation 18- 39 • Adult Equitation 40- 55 • Adult Equitation 56 & Over Cross Entry: • No cross-entry restrictions into another section for horse and rider unless stated in the prize list. Fence Height: • 2'9"- 3'6" with spreads not to exceed fence height • Combinations will be permitted • Management must state in the prize list the height at which sections

are being held. Combining/Dividing Sections: • Refer to HU137. Awards: Zone Horse of the Year Awards will be presented annually to the following section: • Adult Equitation 18- 39 • Adult Equitation 40- 55 • Adult Equitation 56 & Over

EQUITATION: CHILDREN'S/JUNIOR SECTION

Sections Offered: • Equitation 11 & Under • Equitation 12-14 • Equitation 15-17 Cross Entry: • No cross-entry restrictions into another section for horse and rider unless stated in the prize list. Fence Height: • Equitation 11 & Under: o Minimum 2'6", maximum 3' - management must state height at which class will be offered. o Management may offer multiple height options if stated in the prize list, but each course must be set at the same height throughout. o Combinations not permitted • Equitation 12- 14: o Minimum 2'9", maximum 3'3" - management must state height at which class will be offered. o Management may offer multiple height options if stated in the prize list, but each course must be set at the same height throughout. o Combinations are optional • Equitation 15- 17: o Minimum 3'0", maximum 3'6" - management must state height at which class will be offered. o Management may offer multiple height options if stated in the prize list, but each course must be set at the same height throughout. o Combinations are optional Combining/Dividing Sections: • Refer to HU141 Awards: Zone Horse of the Year Awards will be presented annually to the following sections: • Equitation 11 & Under • Equitation 12-14 • Equitation 15-17

CHILDREN'S HUNTER HORSE

Sections offered and requirements: • Children's Hunter Horse 13 & Under • Children's Hunter Horse 14- 17 Cross Entry: Rider: Riders entered in the Children's Hunter section may not compete in the Junior Hunter section at the same competition. Riders may not show in any classes in which the fences are 3'9" and over at the same competition. Horses/Ponies: Horses entered in the Children's Hunter section may not compete in the Junior Hunter section at the same competition. Horse and rider combination: n/a Fence Height: • 3'0" with spreads not to exceed fence height • Combinations will be permitted Combining/Dividing Sections: Refer to HU141 Awards: Zone Horse of the Year Awards will be presented annually to the following sections: • Children's Hunter Horse 13 & Under • Children's Hunter Horse 14- 17.

LOW CHILDREN'S HUNTER HORSE

Eligibility: Open to exhibitors who have not yet reached their 18th birthday as of December 1 of the current competition year. Cross Entry: Riders: Riders may not cross enter at the same competition into any class/ section where fences exceed 2'9" Fence Height: • 2'6" • Low Children's Hunter Horse Combining/Dividing Sections: The Low Children's Hunter and Low Adult Amateur Hunter sections may be combined if there are fewer than three (3) entries in either section. Awards: Zone Horse of the Year Awards will be presented annually to the following section: • Low Children's Hunter Horse.

CHILDREN'S HUNTER PONY

Sections offered and requirements: • Small/Medium Children's Pony • Large Children's Pony Cross Entry: Rider: Children's Hunter Pony riders may compete on a maximum of one (1) Children's Hunter horse section at the same competition and in any class not to exceed 3'0" (Exception: Pony Jumpers). Green and Regular Hunter Pony riders may compete on a maximum of two (2) additional pony in the Children's Hunter Pony section at the same competition. Horse/Pony Ponies may not cross enter into any other rated section at the same competition. Horse and Rider Combination The same pony and rider may not cross enter into any other rated section at the same competition. Fence Height: • Combinations will not be permitted • Classes may run as one or split Small/Medium and Large to run at 2'0", 2'3" and 2'6" respectively. Combining/Dividing Sections: Refer to HU141. Awards: Zone Horse of the Year Awards will be presented annually to the following sections: • Children's Hunter Pony-Small/Medium • Children's Hunter Pony-Large Required distances for the Children's Hunter Pony sections: a. 2'0" Small Children's Hunter Pony should be (based on 9'9" stride): 4 strides at 48'9"; 5 strides at 58'6"; 6 strides at 68'3"; 7 strides at 78'8"; 8 strides at 87'9". b. 2'3" Medium Children's Hunter Pony should be (based on 10'3" stride): 4 strides at 51'3"; 5 strides at 61'6"; 6 strides at 71'9", 8 strides at 92'3". c. 2'6" Large Children's Hunter Pony should be (based on an 11" stride): 4 strides at 55"; 5 strides at 66"; 6 strides at 77"; 7 strides at 88"; 8 strides at 99'.

CHILDREN'S JUMPER

Sections offered and Requirements: • Low Children's Jumper • High Children's Jumper Cross Entry: Rider: Riders may not show in any classes where the jumps exceed 1.20m, except Junior riders competing in FEI Children's classes and USEF Talent Search Class. Horse/Pony n/a Horse and Rider Combination: Low Children's horse and rider combinations may not cross enter into the High Children's Jumpers at the same competition. High Children's horse and rider combinations may not cross enter into the Low Children's Jumpers at the same competition. Fence Height: • Low Children's Jumper: 0.90m to 1.00m • High Children's

Jumper: 1.10m to 1.15m Combining/Dividing Sections: Children's Jumper sections may be divided or combined with Adult Amateur Jumper sections, at competition management's discretion, if so stated in the prize list. Awards: Zone Horse of the Year Awards will be presented annually to the following sections: • Low Children's Jumper • High Children's Jumper.

USHJA COMPETITIVE PROGRAMS

For more information regarding the following programs please click on the links below:

[Green Hunter Incentive](#)

[International Hunter Derby](#)

[National Hunter Derby](#)

[Outreach](#)

[Pony Hunter Derby](#)

[Hunter Team Challenge](#)

[World Championship Hunter Rider](#)

[Zone Horse of the Year Championships](#) (Please check individual zone pages)

[Zone Jumper Championships](#)

SPECIAL CLASSES

[3'3" Jumping Seat Medal](#)

[Green Hunter Challenge](#)

[Gladstone Cup Equitation Classic](#)

Full Specs available at: <https://www.ushja.org/zones-affiliates/zone-9/specifications>.



Professional Johanna Siefert and Chico Ask competing in the Cascade Grand Jumper ring during the June Alpine Preview horse show. Photo: Gary Voth

YOU ARE NOT YOU ALONE



US Equestrian wants you to know: if you are a victim or survivor of sexual abuse or suspect abuse of any kind, there are resources and people to help.

REPORT

833-5US-SAFE or uscenterforsafesport.org/report-a-concern

24/7 HELPLINE

866-200-0796 or visit safesporthepline.org

TRAINING & RESOURCES

Free to US Equestrian members at usef.org/safesport.

#youarenotalone



USEF Competition Name: Cascade Finals

USEF#: 334509

Competition Division(s) and Rating(s):

USEF Regional I (B) Hunter, Jumper Rating 1

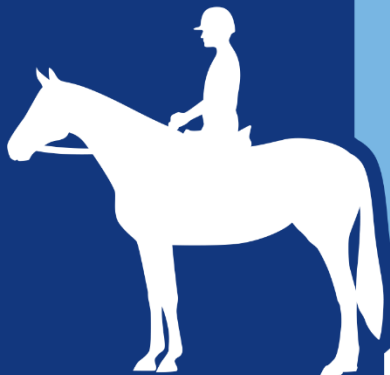

MAAAP

MINOR ATHLETE ABUSE PREVENTION

LEARN ABOUT MAAAP POLICIES



SafeSport Training



One-On-One Interactions



Local Travel



Social Media and
Electronic Communications



Read about these and more at
usef.org/MAAPP

REPORT MAAAP POLICY VIOLATIONS



usef.org/safe-sport/reporting
859-225-6915

