



CASCADE HORSE SHOWS

2023

JUNE 14-18

SWIFTWATER INVITATIONAL

USEF National Hunter (Channel 1), Jumper Rating 2

JUNE 21-25

ALPINE PREVIEW

USEF National Hunter (Channel 1), Jumper Rating 3

WASHINGTON STATE HORSE PARK, CLE ELUM WASHINGTON

CASCADHORSESHOWS.COM

*Georgia Dillon and Flower
Whittier Trust Grand Prix, 2022 Swiftwater Invitational*



**Flying over obstacles:
This is what trust is all about.**

Building a family legacy takes a lifetime. Maintaining it over generations takes our kind of expertise.

Experience tells us that perpetuating wealth is often as much about family dynamics as it is economics. For this reason we focus on your vision and values as tenaciously as we pursue solid returns. Our goal is to empower you, your family, your traditions and culture for generations to come. With Whittier Trust your lasting legacy begins today.

There is a tangible difference that the oldest and largest multi-family office headquartered in the West can mean for your legacy. Experience it. Talk to Lori Houston at (206) 834.1382.



Whittier Trust

Investment Management & Consulting | Trust Services | Family Office
Philanthropy & Family Continuity | Real Estate & Energy

SEATTLE OFFICE

520 PIKE STREET, SUITE 1415, SEATTLE, WA 98101
(206) 332.0836

PORTLAND OFFICE

111 S.W. FIFTH AVENUE, SUITE 3150, PORTLAND, OR 97294
(503) 444.3428

TABLE OF CONTENTS

How to Enter	6
Horse Show Approvals	6
Directions to the Washington State Horse Park	6
US Equestrian Sections and Ratings	8
Horse Show Officials	10
Horse Show Fees	11
Facilities & Grounds	14
Important Policies of the Show	16
Rules & Regulations	20
Cascade Circuit Cup Awards	26
Spotlight Classes	28
Hunter Division	30
Equitation Division	36
Jumper Division	40
Championships Offered	44
Specifications	47
Schedules: Swiftwater Invitational	54
Schedules: Alpine Preview	60
Entry Forms	65
USHJA Zone 9 Specifications (MT, WY, ID, OR, WA)	70
USEF Safe Sport / MAAP	73

CASCADE SPONSORS

Cascade Horse Shows gratefully thanks its proud sponsors

Equestrian Brands & Commercial Sponsors

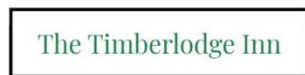

CASCADE SPONSORS

Cascade Horse Shows gratefully thanks its proud sponsors

Premium Show Stables & Individual Patrons

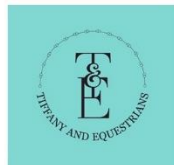

HOW TO ENTER

[Stall reservations](#) are required for entry into the horse show (see page 16).

All entries must be submitted online.

After reserving stalls, you may enter online at Horseshowing.com or EquestrianConnect.com or [on our website](#).



Entries received after the close of entries are considered post entries and will incur a \$50 late entry fee.

HORSE SHOW APPROVALS

United States Equestrian Federation (USEF) *Lexington, KY*

United States Hunter Jumper Association (USHJA) *Lexington, KY*

Washington State Hunter Jumper Association (WSHJA) *Sammamish, WA*

Oregon Hunter Jumper Association (OHJA) *Wilsonville, OR*

DIRECTIONS TO THE WASHINGTON STATE HORSE PARK

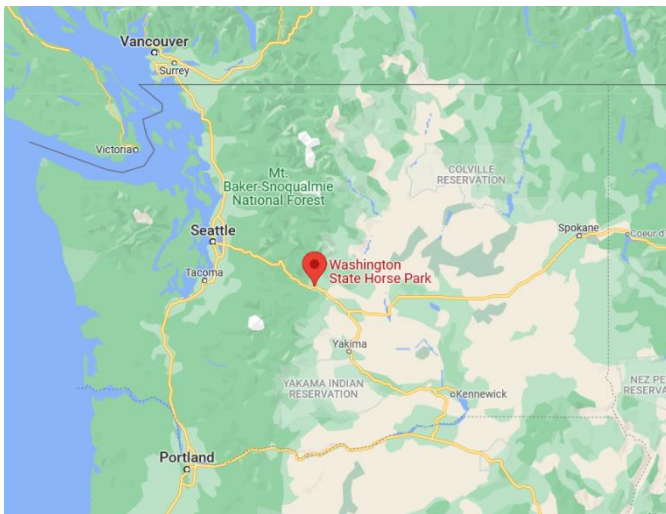

Map courtesy Google.

Washington State Horse Park

1202 Douglas Munro Blvd.
Cle Elum, WA 98922

The Horse Park is conveniently located off Interstate 90 in Cle Elum, Washington, approximately 80 miles from Seattle.

From I90 Westbound:

Take exit 84 from I-90 W toward Cle Elum
Right onto Oakes Ave 0.5 mi
Left onto W 2nd St 0.6 mi
Left onto Forest Service Rd 4517/Douglas Munro Blvd
Right onto Douglas Munro Blvd

From I90 Eastbound:

Take exit 84 from I-90 E toward Cle Elum/S Cle Elum
Continue onto W 1st St 361 ft
Turn left onto Douglas Munro Blvd 0.9 mi
Continue on Douglas Munro Blvd



HORSEWARE®
IRELAND

Horse Therapy From Horseware

SPORTZ-VIBE MASSAGE THERAPY RUG



- Reduces pain and inflammation
- Improves blood supply to tissue
- Relaxes muscles
- Improves quality of life

www.sportzvibe.com



Massage Areas

ICE-VIBE CIRCULATION THERAPY



- Reduces soreness and swelling
- Helps boost circulation
- Stimulates healing
- Strengthens muscle tissue

www.icevibe.com

"We use the ICE-VIBE boots daily as part of our treatment plan on our grand prix horses."

-Richie Maloney *International Show Jumper*

US EQUESTRIAN SECTIONS AND RATINGS

SWIFTWATER INVITATIONAL | USEF #329346 | JUMPER 2

USEF Rated National: High Performance Hunter 3'9", Performance Hunter 3'3" & 3'6", Green Hunter 3', 3'3", 3'6", 3'9", Young Hunter 2'9", 3', 3'3", Amateur Owner Hunter 3'3" & 3'6", Junior Hunter 3'3" & 3'6", Pony Hunters, Green Pony Hunters

USEF Rated Regional II: Adult Amateur Hunter, Children's Hunter, Children's Hunter Pony, Small Hunter, Large Hunter, Thoroughbred Hunter, USHJA Hunter 2', 2'3", 2'6", 2'9", 3'

ALPINE PREVIEW | USEF #330219 | JUMPER 3

USEF Rated National: High Performance Hunter 3'9", Performance Hunter 3'3" & 3'6", Green Hunter 3', 3'3", 3'6", 3'9", Young Hunter 2'9", 3', 3'3", Amateur Owner Hunter 3'3" & 3'6", Junior Hunter 3'3" & 3'6", Pony Hunters, Green Pony Hunters

USEF Rated Regional II: Adult Amateur Hunter, Children's Hunter, Children's Hunter Pony, Small Hunter, Large Hunter, Thoroughbred Hunter, USHJA Hunter 2', 2'3", 2'6", 2'9", 3'



Kelsey King and Closing Time compete in the USHJA National Hunter Derby sponsored by Brick Road Farms at the 2022 Alpine Preview. Trainer: Denise Youell. Photo: Gary Voth

VOLTAIRE
DESIGN



blue *Infinite*

BORN TO PERFORM

HORSE SHOW OFFICIALS

Show Manager

JENNIFER HANSEN

Show Secretary

LAUREN WASSERMAN

Marketing, Sponsorships & Community Relations

JESSICA VANIA

Grounds Manager

ADAM CHAMBERLIN

Web Site, Technology & Communications

GARY VOTH

Official Photographer

VIOLA MITCHELL

Horse Show Advisors

ABBIE BLOCK

DENISE YUELL

SWIFTWATER INVITATIONAL

June 14-18, 2023

Judges, Hunter & Equitation

DIANNE GROD, Ocala FL

INGRID SCHOENLEIN, Lafayette, IN

Judge, Jumper

MAX VON ZIMMERMANN, Selah, WA

Course Designers

NICK TIGHE, Phoenix, NY

MAX VON ZIMMERMAN, Selah, WA

Steward

BRIDGET IMPARATO, Beverly Hill, FL

Veterinarian

DR. KELLY FARNSWORTH (509) 595-3070

Farrier

TRISTEN EVANS (360) 932-5196

ALPINE PREVIEW

June 21-25, 2023

Judges, Hunter & Equitation

CINDI ROSS, Camas, WA

KATHRYN JONES, Watkinsville, GA

Judges, Jumper

MAX VON ZIMMERMANN, Selah, WA

Course Designers

MIKE NIELSEN, Diamond Bar, CA

CRISTINA LARANGEIRO, FEI LEVEL 3, Porto Portugal

Steward

BRIDGET IMPARATO, Beverly Hill, FL

Veterinarians

DR. NICHOLAS HALL (509) 595-7453

Farrier

BRANDON HERMANN (206) 697-1135

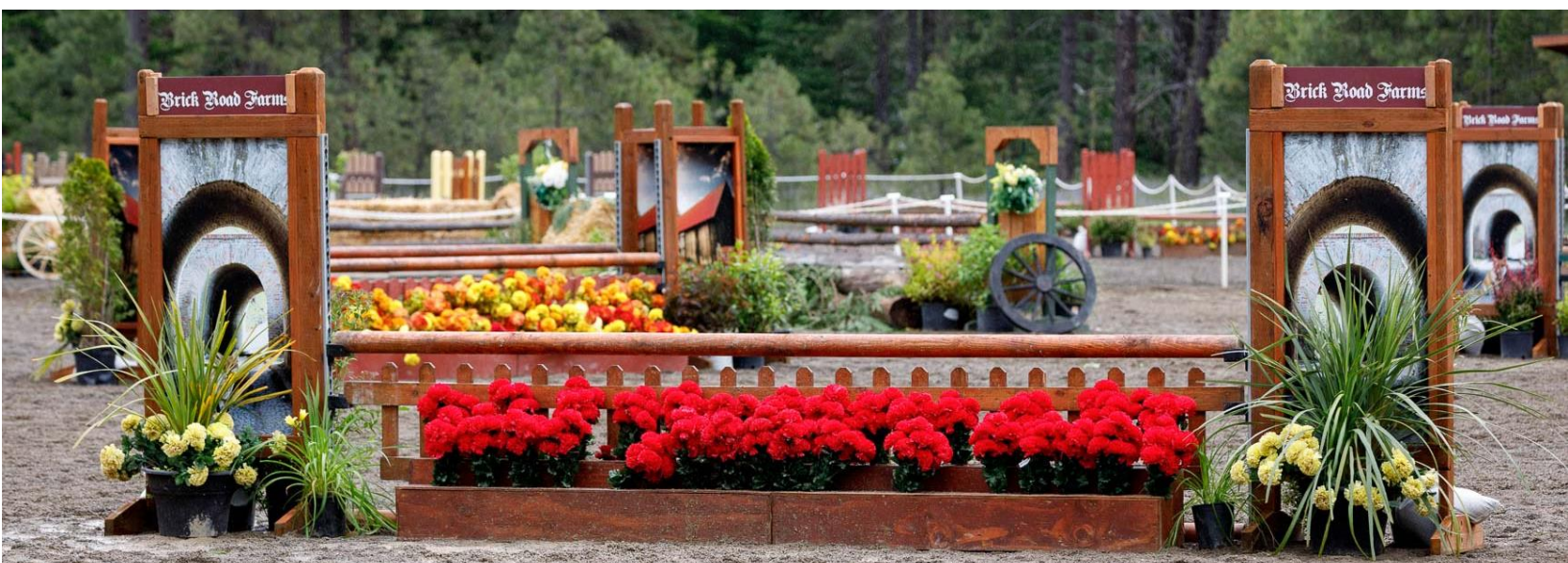

HORSE SHOW FEES

USEF Fee: \$8

USEF Equine Drug & Medication Fee: \$15

USEF Competing Membership Fee: \$80

USHJA Fee: \$7

USHJA Show Pass Fee: \$30

Stall Fee: \$340

Non-Showing Horse Fee: \$175/show

Haul-In Fee: \$50/horse/day or \$150/horse/show

RV Space: \$435 (Full hookup), \$320 (Partial hookup),
\$150/week or \$25/night (no hookup/dry camp)

Tent / Dry Camp Space: \$150/week or \$25/night

Warm-Up / Schooling Fee: \$40

Office Fee: \$50

Sunday Stay-Over (prior to departure): \$50/stall, \$50/RV site

Per Stall Manure Disposal / Garbage Fee: \$60

Hunter / Jumper Nomination Fee: \$75

CLOSING DATES FOR ENTRIES

Entries received after the closing dates will be charged a \$50 late entry fee.

Swiftwater Invitational: **MAY 19, 2023**

Alpine Preview: **MAY 19, 2023**

Pacific Crest Open: **JUNE 2, 2023**

Cascade Finals: **AUGUST 11, 2023**

HORSE SHOW SERVICES

Show Office Hours

DAY PRECEDING SHOW: 10am – 5pm

DAYS OF SHOW: 7am¹ – 5pm²

¹ or 30 minutes prior to start of the first class

² or 30 minutes after the last regularly scheduled class ends

Concessions Provided By

ONSITE VENDORS

Golf carts

AVAILABLE FOR RENT FROM CHS

A limited number of golf carts are available for rent on a weekly basis during the show from Cascade Horse Shows. Requests can be made from our web site using [our online form](#). Availability is first come, first served until the limited supply is gone.

ONSITE RV POLICY

RV sites are available for request on a first come, first served basis, with consideration given for sponsors, multi-week stays and size of RV. Please use our online form at cascadehorsheshows.com to make requests. Choices are not guaranteed, and no requests are final until you receive emailed confirmation from the Show Office and render payment, if required. For cancellations, please see [Cancellations & Refunds](#), page 16.

All sites are assigned by Cascade Horse Shows and will be shared with you upon confirmation. Upon arrival, please find your site at the welcome center or Show Office should you need assistance. An RV Pass must be procured at the Show Office and prominently displayed. Hookups with utilities include 15-amp, 30-amp, or 50-amp power and potable water (availability of 50-amp hookups is limited). Charges apply whether hooked up to utilities or not. Pump out services can be requested in the office on the dates they indicate are available.

Shannon Hendrickson Memorial Grants

Presented by **Sea Mountain / CHUBB**

“The world changes from year to year, our lives from day to day, but the love and memory of those who have positively impacted us shall never pass away...”

The late **Shannon Hendrickson** of Signature West Farms made a strong impact on our enjoyment of horses, set a high standard of horse care, and tirelessly fostered youth participation in Northwest horse sports that will be felt for generations to come.

To honor her memory and further that commitment to young riders, Cascade Horse Shows, in partnership with Sea Mountain Agency / CHUBB Insurance, will offer four grants to riders 18 and younger throughout the show season. Each grant awards \$500 to be applied towards entries at a future Cascade Horse Shows' event.*

To qualify, young riders must submit essays about someone who has made a lasting difference in their enjoyment of horses and the quality of their horsemanship. One grant recipient will be honored and their winning essay read at each of our four Cascade shows. For essay requirements and submissions details, see: <https://www.cascadehorseshow.com/memorial-grants>

2023 Grant Application Deadlines

June 13th | Swiftwater Invitational & Alpine Preview

June 20th | Pacific Crest Open

August 31st | Cascade Finals

2022 Grant recipients, clockwise from left:

Emily Bingham (Swiftwater Invitational)

Claire Kachmarek (Alpine Preview)

Darby Wygal (Pacific Crest Open)

Toko Morimua (Cascade Finals)



Photos courtesy of:
Ashley Bingham
Viola Mitchell Photography
Gary Voth Photography

*Event to be held during current or upcoming show season





Selling homes for horses and their people



Heidi Davalos

heidid@pacesetterproptiesteam.com

425.870.3334

Raquel Davalos

raquel@pacesetterproptiesteam.com

425.760.8600

Reilly Ochs

reilly@pacesetterproptiesteam.com

206.914.5254

FACILITIES & GROUNDS

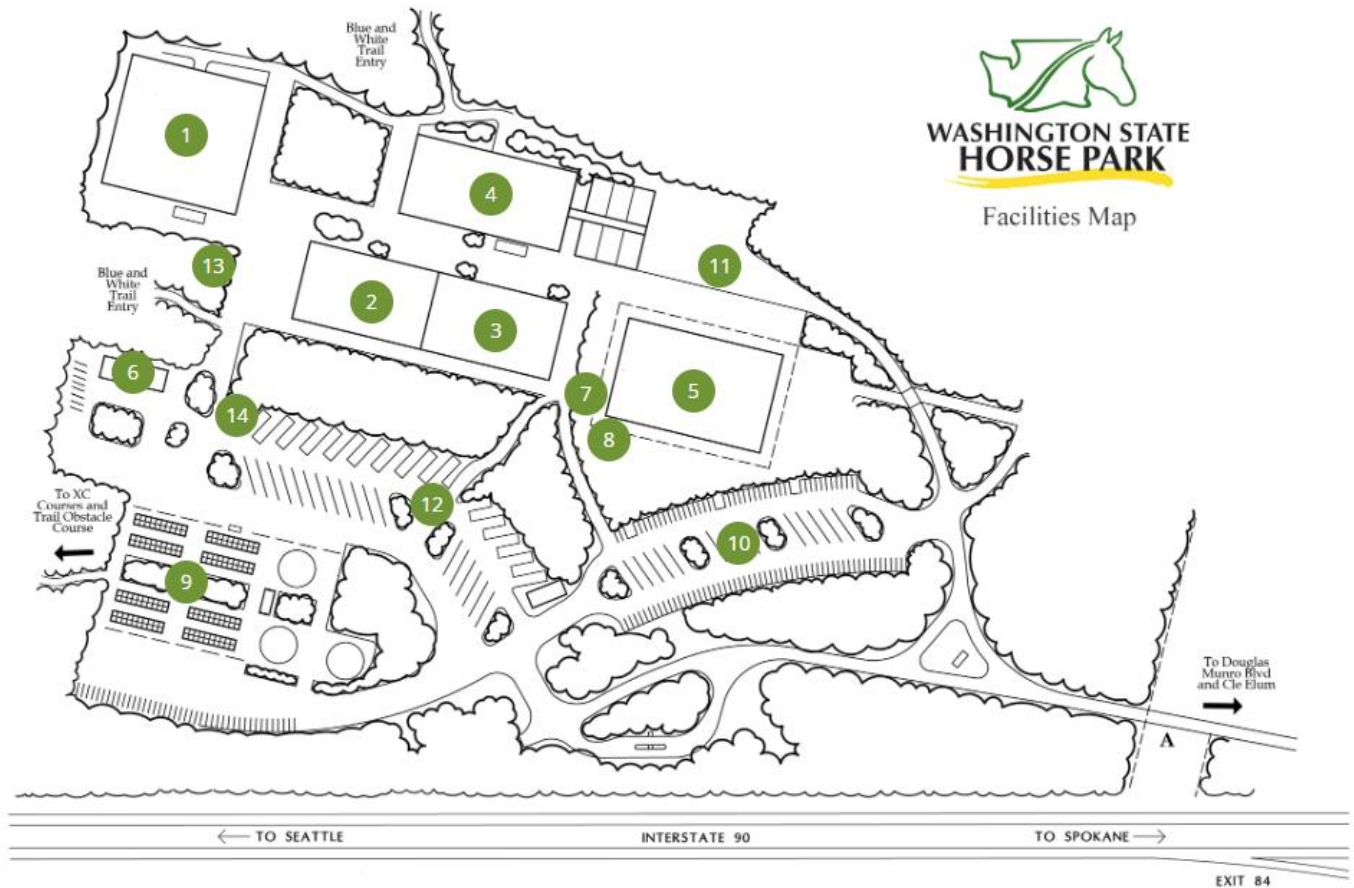

- 1 Parkwood Equestrian Grand Hunter Arena (250' x 250')
- 2 Hunter Warm-up Arena (140' x 230')
- 3 WSHJA Hunter Arena (130' x 230')
- 4 Fast Track Farms Warm-up Arena (150' x 300')
- 5 Farpoint Farm Kona Coast Grand Jumper Arena (covered, 150' x 300') with ample spectator seating
- 6 Show Office
- 7 Hospitality Area
- 8 Vendor Row
- 9 10 11 Stabling West, East and Northeast
- 12 RV sites: 14 premium full hookup (water, electric, sewer) sites nestled in the trees. 14 standard hookup (water & electric) situated around the tree islands. 24 basic no-hookup spaces
- 13 Windbreaker Lounge: Hospitality tent with lounge seating, plus covered and open picnic areas
- 14 Prize Store

Additional Amenities:

- Shower facility with 3 private shower rooms
- Miles of adjacent horse trails with easy access from stabling areas
- Ample trailer parking

Hard to Fit Horse?

Custom sizing no
additional charge



Bridle2Fit, Otto Schumacher,
and Edgewood.

Contact the experts at Olson's to help.



IMPORTANT POLICIES OF THE SHOW

STALL RESERVATIONS

Trainers or their authorized agents, or individual exhibitors not affiliated with a trainer, must use our online [Stall Reservation form](#) to reserve stalls in advance of our shows. Entries cannot be accepted without stall reservations. We will confirm your reservation within 7 business days of receiving your form. In the case that stalls sell out prior to the close of entries, we will add your reservations to our waitlist.

You can change your counts by notifying us via email at office@cascadehorseshows.com or text at 360.573.4360, *however*, your counts will be locked-in after the show scratch / cancellation deadline (see below).

Confirming your counts: When the scratch deadline is approaching, we will contact you at least 72 hours in advance to confirm your final stall count. Stalls you confirm past the scratch deadline will be *final* regardless of whether you have submitted entries, so please only reserve stalls you are confident you will use. If we do not hear back from you at this stage, your stalls will be released to others on the waitlist.

Changes past this deadline: If your needs change past this deadline, you can work with other trainers to take your confirmed stalls—provided you notify us via email. All parties—i.e., you and the other trainer(s)—must be included on this communication to us. You must give us notice of any stall exchanges at least 10 days prior to the start of the show to have this reflected on the stabling chart. In the unlikely case of a misunderstanding between trainers as to who is paying for exchanged stalls, we must hold the trainer who made the original reservation responsible for the stalls.

If something does change, please reach out to us as soon as possible. While the above is our formal policy, with enough notice we will always try to work with you while maintaining a fair approach for all competitors.

CANCELLATIONS & REFUNDS

If circumstances change and you will no longer be able to attend the show, please communicate any desired changes promptly. This helps us accommodate as many competitors as possible.

Show Scratches and Cancellations: The deadline for show cancellations and scratches without penalty will be the *earliest* of these two dates:

- The published close of entry date for the show
- A date we officially announce that is approximately 6 weeks prior to the show (in the event the show sells out early)

Up until this deadline, you may make changes to or cancel your entries or their associated stall reservations and RV site requests without penalty. Any deposits paid with entries made prior to the scratch deadline will be fully refunded.

After this deadline, you are fully responsible for any stall fees due for your reserved stalls (see above) in addition to office fees due, if any. Refunds for RV sites with hookups are offered prior to the entry close date provided we can resell the space. RV sites are non-refundable past close of entries.

Changes Past the Close of Entries: A \$50 office fee per horse will apply to all entries, scratches and substitutions made after the close of entries. Please note that after a horse has been checked in, there are no refunds of stalls, nomination fees, feed and hay, bedding, RV reservations, schooling fees, office fees, non-showing horse fees, manure and garbage disposal fees or any completed classes.

Refunds: Any refunds due will be credited to your card or mailed to you within 3 weeks following the show.

How to Request Changes: Please communicate your requests to the Show Office promptly at office@cascadehorseshows.com.

4- & 5-Year-Old Young Horses & Off-the-Track Thoroughbreds Show FREE!

Presented by **IOS Ranch**

Cascade Horse Shows, together with IOS Ranch, is pleased to provide young horses and OTTB Thoroughbreds with a positive showing experience with a chance to develop success at their own pace.

Qualifying horses may enter any one open Hunter or one open Jumper section at a Cascade event with no entry fees and no nomination fees!*

** Spotlight Classes, Classics, and otherwise restricted sections excluded. Other limitations and fees apply. Applications must be received prior to close of entries. See the Rules & Regulations for full details.*

Chrissy Black and 4-year-old Georgia on My Mind show great form in the .75m Jumpers in the 2022 Swiftwater Invitational. Trainer: Kim Pratt. Photo courtesy Viola Mitchell Photography



Illness or Injury During the Competition: After the competition starts, if you are unable to compete due to an illness or injury, your remaining class fees will be refunded upon presentation of a doctor's certificate. Stall and other fees will not be refunded. A \$50 office charge will apply.

ADDITIONAL POLICIES

Adds & Scratches Due By 4:00 pm Daily

All changes for the next day, including adds and scratches, must be made by 4:00 pm each day in the office or on horseshowing.com. This allows the next day's schedule to be created with class counts and times and made available to everyone in a timely manner.

Day-of Adds

If wanting to add a class on the same day, approval will be based on schedule availability and management discretion. We cannot guarantee acceptance, and you may be put on the ring wait list. If accepted, day-of adds will be assessed a \$10 per class fee. Enter your classes by 4:00 pm the day prior to avoid the \$10 add fee. See our [full policy](#) on page 21.

Canceling And Combining of Classes

Classes with fewer entries than the minimums may be either canceled or combined with other classes, at management's discretion.

Posted Ring Schedule

The most accurate estimation of the daily ring schedules will be completed after adds and scratches have been entered. We strive to post this schedule by 7:00 pm the day prior. The schedule can be found at our [Competitor Resources page](#).

US EQUESTRIAN MEMBERSHIP STATEMENT

Life, senior active and junior active members shall be eligible to participate in all classes at Regular Competitions, Eventing Competitions at the Modified Level or above, Combined Driving Competitions at the Advanced Level, Dressage Competitions, Endurance Rides and Vaulting Competitions: (See GR828.4 of the Federation rules). Life, senior active and junior active members shall be eligible to participate in all classes at Regular Competitions, Eventing Competitions at the Modified Level or above and Combined Driving Competitions at the Advanced Level, Dressage, Reining and Vaulting Competitions and Endurance Rides. A non-member may participate as a handler, rider, driver, owner, lessee, or agent, at Regular Competitions, Eventing Competitions, Dressage Competitions, Reining Competitions and Combined Driving Competitions upon payment of a Show Pass fee. Participants in the following classes are exempted from the Requirements of this rule: 1) leadline; 2) exhibitions; 3) games and races; 4) classes for 4-H members; 5) walk trot (exception: Friesian performance FR231) and academy classes (academy classes are classes limited to horses used regularly in a lesson program); 6) USDF introductory level tests, pas de deux and quadrille classes; 7) NRHA Endorsed Reining Competitions. 8) Opportunity classes, 9) citizens of other nations who have proof, in English, of current membership in good standing of their own National Federation, 10) USEA beginner novice division; and 11) assistant handlers in Dressage Sport Horse Breeding classes.

SPOTLIGHT CLASSES

Cascade Grand Prix

Saturday, June 17, 2023 **\$5,000 Whittier Trust Grand Prix**
Presented by Whittier Trust

Saturday, June 24, 2023 **\$9,999 Horseware Grand Prix**
Presented by The Absolute Horse

*Professional Georgia Dillon pilots Flower,
owned by Mia Hope Heckmann, to victory
in the 2022 Whittier Trust Grand Prix*



RULES & REGULATIONS

Cascade Horse Shows competitions are conducted under current U.S. Equestrian and USHJA rules and are U.S. Equestrian, USHJA, USHJA Zone 9, WSHJA, and OHJA approved.

ENTRIES

Enter online only via HorseShowing.com, EquestrianConnect.com, or [on our website](#). All sites are credit or debit card payment only.

Each show has a published close of entries date. You may enter the shows at any time assuming space availability.

All entries require a Competition Deposit equivalent to the cost of a stall plus a \$50 fee. This deposit will be fully credited to your final show bill upon checkout if entries are received prior to the close of entries date. If your entries are received after the close of entries date, the \$50 per entry fee is forfeited.

SCRATCH DEADLINE

The deadline for refunds in the event of show cancellations or scratches will be the *earliest* of these two dates:

- The published close of entry date for the show
- A date that we publicly announce that is approximately 6 weeks prior to the show if the show sells out early

Refunds for show entries or reserved stalls are not possible for any reason after this deadline. Please contact the Show Office to request refunds.

STALL RESERVATIONS

Trainers or their authorized agents, or individual exhibitors not affiliated with a trainer, may use our online [Stall Reservation form](#) to reserve stalls in advance of our shows. Please see our full [Stall Reservation policy](#) on page 15.

PAYMENT

Pay by check, cash, money order, VISA, MasterCard, Discover, American Express credit or debit card. A valid form of payment must be presented upon check-in at the show. All credit and debit card payments subject to a 3.5% convenience fee.

Canadian Exhibitor entries must be paid by draft payable in US funds or check on Canadian US dollar account or credit card. Canadian checks with US FUNDS written on the face of the check cannot be accepted.

All checks returned by the bank incur a fee of \$50. To retain entries, the fees and penalty must be paid by before 4pm the day before the Show starts. In the event a check is returned after the completion of the show, it will be handled in accordance with US EQUESTRIAN GR913.

Competitors who do not come into the office to close out at the end of the show forfeit the right to adjustments on any show charges. Final balances will be automatically charged to the payment method on file.

TRAINER SPLITS

Trainers having accounts with Cascade Horse Shows may choose to add their show fees and charges to their "trainer splits" to have these charges distributed amongst their clients. Trainers have until 5:00pm Friday of the show to inform the Show Office which charges will be distributed to which clients. It is fully and solely the trainer's responsibility to indicate which items are applicable to the split and to which clients they should be applied. *Exhibitors:* By submitting an entry form, you acknowledge that you fully accept responsibility for the costs assigned to you by your trainer for the show that you are entering.

SUBSTITUTIONS

A new horse may be substituted for a scratched horse. There will be a \$50 office charge for substitutions made after the close of entries.

SHOW SCRATCH and REFUNDS

Refer to [Cancellations & Refunds](#) on page 16.

EVERY CLASS OFFERED HEREIN WHICH IS COVERED BY THE RULES AND SPECIFICATIONS OF THE CURRENT USEF RULE BOOK WILL BE CONDUCTED AND JUDGED IN ACCORDANCE THEREWITH

REQUIRED CREDENTIALS

Exhibitors entering rated competition must present copies of the following current credentials to the horse show: US EQUESTRIAN/USHJA/EC membership card; US EQUESTRIAN/USHJA Amateur certification; US EQUESTRIAN/USHJA Large, Small, Junior Hunter and Pony measurement card; USHJA/EC horse recording card or ID number. If measurement cards are not available, measurement will be required. Check in the Show Office for measurement times and dates.

USHJA HORSE REGISTRATIONS

All horses competing in licensed competitions with Hunter, Hunter Breeding, Jumper and/or Hunt Seat Equitation classes (except those activities enumerated in GR901.9, items 1-9) must obtain a Registration Number from USHJA. Not required for Opportunity and Outreach classes.

HORSE MICROCHIP

Note: An ISO 11784/11785 compliant chip is required for entry into ALL USHJA rated hunter/jumper competitions starting with the 2019 season.

STATEMENT OF HORSE HEALTH / VACCINATIONS

Per GR845 Equine Vaccination Rule: At Federation licensed competitions, horses entering the grounds must be accompanied by documentation of Equine Influenza Virus and Equine Herpes Virus (Rhinopneumonitis) vaccinations within six months prior to entering the stables. Horses not in compliance with this rule may be required to leave the competition grounds upon request by Competition Management. Competitors may be asked to provide proof of vaccination upon check-in or prior to entering the property.

SAFE SPORT

All USEF Life and Senior Active members, as well as participants who have regular contact with minor athletes, are required to comply with the U.S. Center for SafeSport training requirement to be eligible to participate in the competition. All participants must adhere to the U.S. Center for SafeSport Code, USEF Safe Sport Policy, and the Minor Athlete Abuse Prevention Policies. More information about this can be found at www.usef.org.

COMPETITION OFFICE HOURS

Day preceding show: 10:00am-5:00pm. Days of show: 7am-5pm or 30 minutes after the last regular class completes whichever is later. Special classes are excluded. Regardless of closing time all next day class adds are due by 4:00pm.

ARRIVALS AND DEPARTURES

Arrivals: Plan to arrive and move in as early as 2 days prior to the start of the competition. For example, a Tuesday warm-up day with a Wednesday competition start means you move in on Monday starting at 10am. You may arrive later if you like. For approval to arrive earlier than the 2 days before competition start, contact the Show Office at office@cascadehorseshow.com. Early arrivals incur a per-night fee per-stall and per-RV as applies.

Departures: Plan to depart Stabling and RV locations by 7pm Sunday or pre-pay with the Show Office to stay over Sunday night. The fee is \$50 per horse stall, and you must vacate by 8am on Monday morning. On Sunday night there will be a 10pm stabling 'lights out'. Sunday night RV stays incur a 'per night' RV fee.

4- & 5-YEAR-OLDS and OFF-THE-TRACK THOROUGHBREDS (OTTB) SHOW FREE

Free entry limited to ONE open Hunter or open Jumper section, excluding Spotlight classes and Classics. Each rider (professional, junior, or amateur) is limited to one horse at each Cascade show. Horses that utilize this program are allowed one use per Cascade Horse Show season. Participation in the program is limited to 2 consecutive years. Management reserves the right to cap participation. Horses entered after the entry close date are not eligible.

All participants wishing to utilize this program must email office@cascadehorseshow.com prior to close date of entries, include horse and rider's name, and trainer's name. Must provide proof of age at time of check-in. Thoroughbreds must have Jockey Club papers and/or proof of breeding including tattoos. All other fees, including stalls, nomination, office, federation, etc. apply. Substitutions are allowed and will follow the regular substitution policy.

STABLING

Stalls with doors are provided; dimensions are 10'x10'. 160 have mats; the remaining have dirt/gravel floors. Requests for specific stalls or stall locations will be considered on an individual basis. Preference given to horses showing both weeks and to sponsors. Portable stalls, with doors, are provided. Bales of shavings will be available by pre-order on entry form and/or during the show by request at the Competition Office. One bale of shavings is included with each stall during Swiftwater only. Straw is not permitted.

In cases of high demand, management reserves the right to cap how many non-horse stalls are sold, and a ratio of horse stalls to non-horse stalls may be put into effect.

Stalls must be cleaned daily. Dirty bedding must be placed in areas provided. Exhibitors are responsible for cleaning their own stalls and must provide their own feed and buckets. A \$60 manure disposal and garbage fee will be assessed for all stalls. No staples, nails, cutting stalls or removal of top doors permitted. Stabling damage fees will be assessed by the WSHF as follows: Panels – \$100 portable stall, \$200 permanent stall; Stall metal framework - \$200; light cords \$150; Roof Tarps – actual repair/replacement costs. Trash cans and bags will be provided on move out days.

SHARPS CONTAINERS

Sharps containers will be available at the end of each barn aisle way. Please be aware Competition Management may fine any individual up to \$100 for improper disposal of needles or other sharp disposable instruments. GR1210.4 If needles are dropped in manure, it cannot be composted.

JUMPER / HUNTER / EQ NOMINATING FEE

Horses or ponies entered in any jumper, hunter or equitation classes pay a Nomination Fee (varies per show). This fee allows entries to add classes before 4:00 pm prior to the day of the class (see next section).

CLASS ADD / SCRATCH POLICY

Adds — Classes may be added up to a day ahead of time at no charge if the Show Office is notified by 4:00pm. Unless otherwise posted, it should be assumed that there are no day-of adds. If wanting to add a class on the same day, approval will be based on schedule availability and management discretion. We cannot guarantee acceptance, and you may be put on the ring wait list. If accepted, day-of adds will be assessed a \$10 per class fee.

Scratches — With the exception of special classes, if your horse has a written scratch form at the Show Office prior to the start of the class, full class entry fees are refunded minus a \$10 scratch fee. You must scratch your classes BEFORE they start. If you don't scratch them at all or try to scratch them after the class has started, you will be charged the full class entry fee.

SPECIAL / SPOTLIGHT CLASS SCRATCH POLICY

Special / Spotlight classes will be assessed a \$25 scratch fee if scratched on the day of the class.

RIDER DID NOT ENTER (RDNE) FEE

It is the responsibility of the competitor and trainer to ensure they have properly entered all classes they intend to compete in. A "ride-did-not-enter" (RDNE) fee of \$25 will be added to the cost of the class for any rounds competed that cannot be supported by office-approved paperwork.

CLASS WAIT LIST POLICY

Be sure to get all entries planned for the next day in by 4pm. If full ring capacity is reached, any entries received for that ring after 4pm, may be put on a wait list. You are encouraged to enter all classes/divisions for the entire show before 5pm on schooling day to ensure entry in those classes/divisions.

US EQUESTRIAN and USHJA FEES

All horses participating in any competition recognized by the US Equestrian Federation incur the following fees: USEF \$23 fee (\$15 of this fee is a Drugs and Medication fee to provide research, inspection, and enforcement of rules regarding use of medications and drugs: see GR407.1, .2, and .3); USHJA Fee \$7 (National shows) or \$2 (Regional I shows). An active USEF competing membership is required for all riders, trainers, and coaches (including parents signing entry forms as trainers). If you are not a current USHJA member, a Show Pass fee of \$30 is assessed by the USHJA. These fees will be added to your show account.

MANAGEMENT CLASS CHANGES

Management reserves the right to cancel or combine any classes as appropriate. Notice will be given to exhibitors affected. Management reserves the right to start the first class of any section 30 minutes earlier than the scheduled time. Management reserves the right to change arenas, judges, or class orders to facilitate time, schedule, and conditions.

Non-Toxic + Vegetarian + Glycerin-free + Petroleum-free + pH Matched Premium Leather Care

CLEANING UP OUR SPORT...

One saddle at a time...

When you choose Sterling Essentials, you choose life-extending tack care made with pH formulated, all natural vegetarian ingredients, and mold-fighting pure essential oils.

You'll NEVER have to use harsh chemicals that damage your tack and harm you and your horse EVER AGAIN.

Liberate Yourself and Your Horse with Sterling Essentials.

Enjoy 30% Off

Use code 30CHS23

Expires Dec. 31, 2023. Terms and exclusions apply, see www.Sterling-Essentials.com/Policies.



Photo Credit
Genevieve Munson



STERLING
ESSENTIALS
— LLC —
EMPOWERED EQUESTRIAN

Purchase your favorite fragrance at retailers nationwide or
learn more at:

WWW.STERLING-ESSENTIALS.COM

PRIZE MONEY PAYMENTS

Exhibitors receive prize money within 3 weeks after the horse show. A valid Social Security or Federal tax ID number must be provided. Prize money won by foreign exhibitors is subject to the US Internal Revenue Service regulation requiring sporting events to withhold 30% of prize money unless they have a US Social Security #.

TROPHIES, RIBBONS, PRIZE MONEY SPLITS

Trophy and ribbons will be awarded to eight places in all Hunter and Equitation classes. Unless stated otherwise, Hunter and Hunter Classic prize money will be divided 30%, 25%, 20%, 15%, 10%. The USHJA National Hunter Derby prize money will be divided 30%, 22%, 13%, 8%, 6%, 5%, 4%, 3%, 2%, 2%. Trophy and ribbons will be awarded to six places in all Jumper classes. Unless stated otherwise, Jumper prize money will be divided 25%, 23%, 20%, 17%, 15%. The Cascade Welcome 1.30m and the Luxury DerbyCross™ prize money will be divided 30%, 23%, 15%, 12%, 10%, 10%. The Need for Speed™ Open Jumper will be divided 30%, 20%, 14%, 10%, 8%, 7%, 6%, 5%. The Grand Prix and Mini Prix will be divided 30%, 20%, 15%, 10%, 8%, 6%, 4%, 3%, 2%, 2%.

HUNTER PRIZE MONEY

The total Hunter prize money guaranteed in 2023 is \$0 as all classes are run dependent upon posted requirements to fill. However, in the case that all classes do fill, the total amount of Hunter prize money offered in 2023 is: Swiftwater Invitational (329346) and Alpine Preview (330219): \$16,200.00. The total amount of Hunter prize money for 2022 was: Swiftwater Invitational (329346): Offered: \$24,350.00; Paid: \$7,888.75. Alpine Preview (330219): Offered: \$24,350.00; Paid: \$7,752.50.

HUNTER TIES

As stated in [USEF HU154](#), in case of a tie the Championship and/or Reserve is awarded to the horse with the most points over fences. If horses have equal points over fences and no points under saddle, the tied horses will be asked to compete in a hack off (Exception: Green and Young Hunters.) Any competitor may concede and not hack off, or if both competitors agree, break the tie with a coin toss. If horses have an equal number of points over fences, under saddle, and model (i.e., Green Conformation Hunter 3'6" or High-Performance Conformation Hunter) the tie will stand as is and double ribbons will be awarded.

JUMPER TIES

As stated in [USEF JP143](#), Competitors who are tied for first place after the initial round(s) will jump off. Any competitors that compete in the jump off and are still tied for first place shall remain tied. Competitors who are tied for other than first place in all Jumper sections will be placed according to the time taken to complete the first course. Prize money and Championship points shall be combined and divided equally among the tied competitors. Double ribbons will be awarded for division championships. For special classes, the competitors will toss a coin for the ribbon and toss a coin for the special award if any.

JUMPER CLASS SCHEDULE TABLES

Jumper classes not otherwise designated in the class schedules will run as Table II.1, Table II.2.b or Table II.2.c, or Table II.d. Please refer to the daily schedules available in the Competition Office.

STAKE/HANDY HUNTER CLASSES

If a per class entry is offered in a division, horse and rider must have shown in at least one other class in the division to be eligible for the Stake or Handy Hunter Class.

HORSE ILLNESS

In the event of an acute and serious injury or illness of a horse on competition grounds when the owner or trainer of the horse is not present, after reasonable effort to contact that individual has been made, Competition Management, in consultation with a licensed veterinarian, may authorize the provision of emergency veterinary treatment of the horse. If Competition Management authorizes treatment under provisions of this rule, Competition Management and veterinarian are not responsible for any resulting costs, damages, losses, claims, or actions arising directly from the treatment of the horse.

SCHOOLING AND EXERCISE

Schooling areas are available for use before and during the show. A mandatory schooling fee of \$40 is charged for all horses. Helmets meeting the US Equestrian requirements as well as riding boots must be worn during schooling.

No lungeing is permitted in any of the arenas including the warm-up rings. Please lunge horses on the designated lungeing pads located on the Horse Park near the west and northeast stalls.

WARM-UP RINGS

During competition days, please cede use of the warm-up rings to riders preparing for upcoming classes. When jumping, standards are cleared with the flags on the right, no reversing of directions. Horses approaching a jump must always be given priority. For your safety and the safety of others, always pass "left shoulder to left shoulder" when traveling in opposite directions in the arena. More warm-up ring rules and best practices can be found at <https://practicalhorsemanmag.com/training/warm-up-ring-etiquette>

ARENAS & FOOTING

Hunters: 250' X 255'; Hunters: 150' X 220'; Jumpers (covered): 150' X 300'. All have sand footing.

DOGS

We welcome your dogs at the shows! Keep your dogs and horses safe by always keeping your dogs on leash while on the Horse Park property. We kindly request you pick up after your dog. For their safety, do not let dogs run loose on trails. All dogs are eligible for our Cascade Canine Derby! (Class availability varies by show.)

RVs, MOTORHOMES, TRAILERS, AND CAMPERS

Submit the [RV Site Request form](#) to request your site. RV sites are available by the week only (the night before schooling day through Sunday day only). Additional nights on either end of the reservation may be available for an additional fee with pre-approval. As hookup sites are limited, preference is given for length of stay, sponsors, reservation date, and size of RV. In the event all the hookup sites are reserved, additional requests will be accepted for non-hookup dry-camping sites.

Full payment is required for confirmed sites. Designated trainers having an account with Cascade Horse Shows may choose to add their personal RV site to their show bill to have us do trainer splits. [All other sites](#) must be pre-paid in advance at the time of confirmation. Charges apply to RV site whether hooked to utilities or not.

Upon arrival, an RV Pass must be obtained from Show Office and displayed. Hookup locations are assigned by us—if assigned a site with a hookup, park only in your designated site.

Tent campers must submit a [Tent Camping Request form](#) to request camping on the Horse Park grounds. Upon arrival, camping passes must be obtained from the Show Office and displayed. Campers must camp in designated areas only. See the Tent Camping Request form for fees.

MOTORIZED VEHICLES

Minors who do not have a valid driver's license which allows them to operate a motorized vehicle in the state in which they reside will not be permitted to operate a motorized vehicle of any kind, including, but not limited to, golf carts, motorcycles, scooters, or farm utility vehicles, on the competition grounds of licensed competitions. Minors who have a valid temporary license may operate the above described motorized vehicles as long as they are accompanied by an adult with a valid driver's license. The parent/legal guardian or individual who signs the entry blank as a parent or guardian of a minor operating a motorized vehicle in violation of this rule are solely responsible for any damages, claims, losses or actions resulting from that operation. Violations of this rule will be cause for penalties against those responsible for the child committing the offense. Wheelchairs and other mobility assistance devices for individuals with disabilities are exempt from this rule. The unsafe use of personal electronic transport devices, as determined by the competition officials and management in their sole discretion, that do not require a driver's license to operate, including but not limited to segways, hover boards, and single wheeled scooters is prohibited on competition grounds. Operating such devices in areas where people gather may be deemed "unsafe use" if there is a risk of harm to others. If the operator of the device is a minor, the parent/legal guardian or

individual who signs the entry blank as a parent or guardian of a minor operating the device in violation of this rule is accountable and may be subject to penalties. Wheelchairs and other mobility assistance devices for individuals with disabilities are exempt from this rule.

HELMETS

It is compulsory for all persons at US Equestrian licensed hunter, jumper or hunter/jumper competitions when mounted anywhere on the competition grounds, to wear properly fastened protective headgear which meets or exceeds ASTM (American Society for Testing and Materials)/SEI (Safety Equipment Institute) standards for equestrian use and carries the SEI tag. It must be properly fitted with harness secure

SAFETY AND WELFARE

The nearest hospital is [Kittitas Valley Healthcare](#) which is 24 miles from the Washington State Horse Park. The nearest level 1 trauma center is [Harborview Medical Center](#) in Seattle, WA which is 83 miles from the Washington State Horse Park.

DISCRETIONARY POLICY

All questions not covered in these rules and regulations shall be decided by Show Management whose decision shall be final.



Excited to be a Sponsor & Vendor at Cascade's Cle Elum Shows!



2221 NE 3rd St · Bend, Oregon · 541-388-3855 · www.TheAbsoluteHorse.com · AbsoluteHorse@gmail.com

Cascade Memorial Cup

Ride in someone's memory; prize money to charity

Presented by **Deep Creek Farm** in honor of Sally Burge

Friday, June 16, 2023

Up to 8 teams of 4 riders (1 professional and 3 juniors/amateurs) will compete in this unique Team Derby event run in Nations Cup style

Team members will each ride one of 4 Derby rounds: a classic and handy at 2'6", and a classic and handy at 3'. The top 3 combined scores to determine placings for each team.

Prize money to be distributed as 50%, 30%, 10% to the charities of the top three teams' choosing.

Ribbons and prizes to be awarded 1st through 8th

Formal attire required; team flair encouraged!



The winning 2022 Cascade Memorial Cup team featuring Kristen Hwang on Danger Mouse, Ella Hallman-Luhn on Kingston, Lauren Hoyt on Moonstruck, and Rachael Davis on Luxury

CIRCUIT CUP AWARDS

The Cascade Circuit Cup Awards are season championships bestowed upon the horses accumulating the most points in one of 5 categories over our rated show season. We recognize that performing well in the arena takes similar courage and commitment, whether competing in the 2' 3" hunters or the 1.30m jumpers (or any height in between).

HONORING OUR 2022 WINNERS!

Congratulations to the following horses, riders, and trainers for their outstanding performances in 2022.

JUMPER 1.10M AND UP

Gracia Cantura

Bay Holsteiner mare

Owner & Rider: Lindsey Fletcher

Trainer: Lindsey Fletcher,

Flying F Sport Horses

JUMPER UP TO 1.05M

Q It Up

Grey Thoroughbred Cross gelding

Rider: Emily Bingham

Trainer: Tracy Bryant,

Signature West Farms

USHJA HUNTER DERBY

Discotheque

Bay Dutch Warmblood Gelding

Rider: Tami Masters

Owner: Emily Coyle

Trainer: Jennifer Hansen,

Starfire Farm

HUNTER 3' AND UP

Crossgate's Taylor Made

Chestnut Welsh pony gelding

Owner & Rider Taylor Barton

Trainer: Janet Jones,

Elk Grove Riding Club

HUNTER UP TO 2'9"

Secret Romance

Chestnut Brandenburg Gelding

Owner & Rider: Sue Miner

Trainer: Sarah Olmstead,

Brass Ring Farm

The Circuit Cup Awards are announced and presented at the conclusion of the Cascade Finals show in September. All horses are eligible. Each winner receives valuable prizes honoring their achievement. We are excited to see who this season's big winners will be. See you in September!

Full Cascade Circuit Cup specifications can be found at [Cascade-Circuit-Cup-Specs.pdf \(cascadehorseshows.com\)](https://www.cascadehorseshows.com/Cascade-Circuit-Cup-Specs.pdf)



SPOTLIGHT CLASSES

Hunter Derbies

Presented by **Brick Road Farms**

\$2,500 USHJA National Hunter Derby

To be run at 3' with 3'5" options

Sunday, June 18, 2023

Friday, June 23, 2023



Sophia James and Cascade en route to winning the USHJA National Hunter Derby at the 2022 Swiftwater Invitational

Cascade
HORSE SHOWS

SPOTLIGHT CLASSES

Class #	Class	Height	Entry Fee	Prize Money
1	Horseware Grand Prix Presented by THE ABSOLUTE HORSE Offered exclusively at the Alpine Preview (week 2)	1.30m	\$395/class	\$9,999.00
2	Whittier Trust Grand Prix Presented by WHITTIER TRUST Offered exclusively at the Swiftwater Invitational (week 1)	1.30m	\$200/class	\$5,000
3	USHJA National Hunter Derby Presented by BRICK ROAD FARMS	3' with 3'5" options	\$175/class	\$2,500
7	Luxury DerbyCross™ 3'3"-3'6" 1.00m-1.05m Presented by BELUXARI EQ Offered exclusively at the Alpine Preview (week 2)	Hunter course: 3'3" with 3'6" options, Jumper course: 1.00m-1.05m	\$100/class	\$1,000
10	Junior/Amateur Hunt & Handy Presented by OLSON'S TACK SHOP	2' with 2'3" options	\$60/class	\$500
11	Rosé All Day Amateur Classic Presented by AMERICAN MECHANICAL Offered exclusively at the Swiftwater Invitational (week 1)	N/A	\$55/class	\$500
14	No Joke, Hold My Coke Classic Presented by BURKWOOD FARM Offered exclusively at the Alpine Preview (week 2)	N/A	\$25/class	
15	Parents On Parade™ Leadline Presented by LAUREL ZEEMAN, CPA Offered exclusively at the Swiftwater Invitational (week 1)	N/A	Free	
16	Rising Stars™ Leadline Presented by KERRITS EQUESTRIAN Offered exclusively at the Alpine Preview (week 2)	N/A	Free	
19	Cascade Memorial Cup Presented by DEEP CREEK FARM in honor of Sally Burge Offered exclusively at the Swiftwater Invitational (week 1)	2'6", 3'	\$400/class	
20	Need for Speed™ Open Jumper 1.10 or 1.20m Presented by VOLTAIRE DESIGN	1.10 or 1.20m	\$75/class	\$750
186	Cascade Welcome 1.30m Presented by LIONHEART TRAINING This class is included in the Jumper 1.30m section	1.30m	\$100/class	\$1,000

Formal Attire Required — Salute to Sponsors Requested
See full class specifications here: [Specifications](#) on page 44.

SPOTLIGHT CLASSES

Rosé All Day Amateur Classic

Presented by **American Mechanical**

Saturday, June 17, 2023

Run in the spirit of a traditional Hunter Hack for all 21 and older amateur riders...
How much will be left in *your* glass?

\$500 prize money distributed 1st through 5th

The winner takes home a case of rosé wine, bottles to 8th place

Traditional attire encouraged; salute to sponsor requested



Riders competing in the Rosé All Day Amateur Classic at the 2022 Pacific Crest Open

HUNTER DIVISION

HUNTER CLASSICS

Class #	Class	Height	Entry Fee	Prize Money
30	Pony Hunter Classic 2'3", 2'6", 2'9"-3' Presented by KAIDYN GRIGGS	2'3", 2'6", 2'9"-3'	\$60/class	\$500
31	Pre-Children's/Adult Hunter Classic 2'9" Presented by AUVEN EQUESTRIAN	2'9"	\$60/class	\$250
32	Low Children's/Adult Hunter Classic 2'6" Presented by STERLING ESSENTIALS	2'6"	\$60/class	\$250
33	Children's Hunter Classic 3' Presented by VOLTAIRE DESIGN	3'	\$60/class	\$500
70	Adult Hunter Classic 3' Presented by VOLTAIRE DESIGN	3'	\$60/class	\$500
34	Children's Hunter Pony Classic 2', 2'3", 2'6" Presented by FOREST PARK SADDLERY	2', 2'3", 2'6"	\$60/class	\$500
35	Short/Long Stirrup Hunter Classic 2'3" Presented by DIANNA CONNELLY INSURANCE	2'3"	\$60/class	\$250
36	Short Stirrup Hunter Pony Classic 18" Presented by HORSIN' AROUND COOKIE COMPANY	18"	\$60/class	\$250
37	Cascade Hunter Classic 2' Presented by KERRITS EQUESTRIAN / EQL	2'	\$60/class	\$250
38	Cascade Hunter Classic 2'3" Presented by KERRITS EQUESTRIAN / EQL	2'3"	\$60/class	\$250
39	Cascade Hunter Classic 2'6" Presented by KERRITS EQUESTRIAN / EQL	2'6"	\$60/class	\$250
40	Cascade Hunter Classic 2'9" Presented by KERRITS EQUESTRIAN / EQL	2'9"	\$60/class	\$250

Formal Attire Required — Salute to Sponsors Requested

Prize Money — 30%, 25%, 20%, 15%, 10%

All Classics are 2 rounds. The last class of the corresponding division to be the first round of the class. Round 2 to be shown over a course of at least 10 obstacles with at least one combination. Hunter Classic riders must have ridden in at least 2 hunter classes in their division to compete.

USEF NATIONAL-RATED HUNTER SECTIONS

Class #	Class (Section Code)	Height	Entry Fee	Prize Money
305, 306, 307, 308 ¹ , 309 ³	High Performance Hunter 3'9" (B)	3'9"	\$250/section or \$55/class	\$250/\$100 U/S
310, 311, 312, 313 ¹ , 314 ³	Performance Hunter 3'6" (C)	3'6"	\$250/section or \$55/class	\$150/\$100 U/S
315, 316, 317 ³ , 318, 319 ¹	Performance Hunter 3'3" (D)	3'3"	\$250/section or \$55/class	\$150/\$100 U/S
320, 321, 322, 323 ¹ , 324 ³	Green Hunter 3'9" (E)	3'9"	\$250/section	\$150/\$100 U/S
325, 326, 327, 328 ¹ , 329 ³	Green Hunter 3'6" (F)	3'6"	\$250/section	\$150/\$100 U/S
330, 331, 332 ³ , 333, 334	Green Hunter 3'3" (G)	3'3"	\$250/section	\$150/\$100 U/S
335, 336, 337 ³ , 338, 339	Green Hunter 3' (H)	3'	\$250/section	\$150/\$100 U/S
345, 346, 347 ³ , 348, 349	Young Hunter 3'3" - Horses 7 & Under (J)	3'3"	\$250/section or \$55/class	\$100
350, 351, 352, 353, 354 ³	Young Hunter 3' - Horses 6 & Under (K)	3'	\$250/section or \$55/class	\$100
355, 356, 357 ³ , 358, 359	Young Hunter 2'9" - Horses 5 & Under (L)	2'9"	\$250/section or \$55/class	\$100
360, 361, 362, 363 ¹ , 364 ³	Amateur Owner Hunter 18-35 3'6" (P)	3'6"	\$250/section	\$100
365, 366, 367, 368 ¹ , 369 ³	Amateur Owner Hunter 36 & Over 3'6" (M)	3'6"	\$250/section	\$100
370, 371, 372, 373 ¹ , 374 ³	Amateur Owner Hunter 18-35 3'3" (O)	3'3"	\$250/section	\$100
375, 376, 377, 378 ¹ , 379 ³	Amateur Owner Hunter 36 & Over 3'3" (N)	3'3"	\$250/section	\$100
380, 381, 382, 383 ¹ , 384 ³	Junior Hunter 15-17 3'6" (Q)	3'6"	\$250/section	\$100
385, 386, 387, 388 ¹ , 389 ³	Junior Hunter 14 & Under 3'6" (R)	3'6"	\$250/section	\$100
400, 401, 402, 403 ¹ , 404 ³	Junior Hunter 15-17 3'3" (U)	3'3"	\$250/section	\$100
405, 406, 407, 408 ¹ , 409 ³	Junior Hunter 14 & Under 3'3" (V)	3'3"	\$250/section	\$100
410, 411, 412, 413 ³ , 414 ¹	Pony Hunter (SML) 2'3", 2'6", 2'9"-3' (W)	2'3", 2'6", 2'9"-3'	\$250/section	\$75/\$100 U/S
415, 416, 417, 418 ³ , 419 ¹	Green Pony Hunter (SML) 2'3", 2'6", 2'9" (X)	2'3", 2'6", 2'9"	\$250/section	\$50

Class # footnotes: 1 = Handy; 2 = Stake; 3 = Under Saddle; italics = Conformation

Green Hunter: Reference [US Equestrian Rule Book HU](#) for Green Hunter Eligibility and Status. Jog for soundness. Horse may compete in only one green hunter fence height section at any one competition

Young Hunter: Reference [US Equestrian Rule Book HU](#) for Young Hunter Eligibility and Status. Not to Jog.

AO Hunters: Horses competing in 3'6" AO Hunters may not cross-enter 3'3" AO Hunters

Junior Hunter: A large Junior Hunter is over 16.0 hands, and a small Junior Hunter is 16.0 Hands and under. Junior Hunter 3'3" is open to junior riders. Riders may not cross-enter any class at 3'6" or higher in the Hunter division, higher than 3'9" in the Equitation division or higher than 1.20m in the Jumper division at the same competition. Horses entered in the Junior Hunter 3'3" section may not cross-enter the Junior Hunter 3'6" section at the same competition.

SML and Green Pony Hunter: Classes 410 and 415 to be judged 25% Conformation.

Sections may be combined if fewer than 4 entries in section.

ALL HUNTER CLASSES WILL BE JUDGED ON PERFORMANCE AND SOUNDNESS UNLESS OTHERWISE NOTED



Are you looking for
QUALITY PRE-OWNED
children's riding apparel &
pony tack?

SHOP & CONSIGN NOW
www.forestparksaddlery.com

Instagram icon @forestparksaddlery
info@forestparksaddlery.com

DCIS

Dianna Connelly
Insurance Services, LLC

EQUESTRIAN INSURANCE SPECIALIST



- Equine Mortality
- Equine Major Medical
- Instructors & Trainers Liability
- Commercial Equine Liability
- Private Horse Owner Liability
- Stable Liability
- Care, Custody & Control
- Farm Dwellings
- Horse Farm Package
- Auto

(206) 419-0634 - cell
(425) 806-0401 -office
PO Box 2277
Bothell, WA 98041-2277

Dianna@Sea-Mountain.com
www.sea-mountain.com



USEF REGIONAL II AND NON-RATED HUNTER SECTIONS

Class #	Class (Section Code)	Height	Entry Fee	Prize Money
425, 426, 427 ³ , 428, 429	Adult Amateur Hunter 18-39 3' (Z)	3'	\$225/section or \$50/class	
430, 431, 432 ³ , 433, 434	Adult Amateur Hunter 40 & Over 3' (AA)	3'	\$225/section or \$50/class	
435, 436, 437 ³ , 438, 439	Children's Hunter 13 & Under 3' (AB)	3'	\$225/section or \$50/class	
440, 441, 442 ³ , 443, 444	Children's Hunter 14-17 3' (AC)	3'	\$225/section or \$50/class	
445, 446, 447, 448 ³ , 449	Children's Hunter Pony 2', 2'3", 2'6" (AD)	2', 2'3", 2'6"	\$225/section or \$50/class	
450, 451, 452, 453 ³ , 454 ³	Small Hunter 3' (AN)	3'	\$225/section or \$50/class	Stake \$250
455, 456, 457, 458 ² , 459 ³	Thoroughbred Hunter 3' (AE)	3'	\$225/section or \$50/class	Stake \$250
460, 461, 462 ³ , 463, 464	USHJA 2' Hunter (AF)	2'	\$225/section or \$50/class	
465, 466, 467 ³ , 468, 469	USHJA 2'3" Hunter (AG)	2'3"	\$225/section or \$50/class	
470, 471, 472, 473, 474 ³	USHJA 2'6" Hunter (AH)	2'6"	\$225/section or \$50/class	
475, 476, 477 ³ , 478, 479	USHJA 2'9" Hunter (AI)	2'9"	\$225/section or \$50/class	
480, 481, 482, 483, 484 ³	USHJA 3' Hunter (AJ)	3'	\$225/section or \$50/class	
500, 501, 502, 503 ³ , 504	Short Stirrup Hunter Horse 17 & Under 2'3" (AK) *	2'3"	\$225/section or \$50/class	
505, 506, 507, 508 ³ , 509	Short Stirrup Hunter Pony 17 & Under 18" (AL) *	18"	\$225/section or \$50/class	
510, 511, 512, 513 ³ , 514	Long Stirrup Hunter 18 & Over 2'3" (AM) *	2'3"	\$225/section or \$50/class	
515, 516, 517, 518 ² , 519 ³	Large Hunter 3' (AO) *	3'	\$225/section or \$50/class	Stake \$250
520, 521, 522, 523 ³ , 524	Pre-Children's/Adult Hunter 2'9" (AP) *	2'9"	\$225/section or \$50/class	
525, 526, 527 ³ , 528, 529	Low Children's Hunter 2'6" (AQ) *	2'6"	\$225/section or \$50/class	
530, 531, 532 ³ , 533, 534	Low Adult Hunter 2'6" (AS) *	2'6"	\$225/section or \$50/class	
535, 536, 537, 538, 539 ³	Baby Green Hunter 2'6" (AR) *	2'6"	\$225/section or \$50/class	

Class # footnotes: 1 = Handy; 2 = Stake; 3 = Under Saddle * Indicates a non-rated class.

AA Hunter: To be ridden by amateurs no longer eligible to compete as a Junior. See current [USHJA Zone 9 specifications](#) in this prize list or at [Zone-9 Specifications on USHJA.org](#).

Ponies may not cross into any other rated section at the same show. Riders may compete on a maximum of 1 Children's Hunter horse section at the same show and in any class not to exceed 3' (Exception: Pony Jumpers). Green & Regular Hunter Pony riders may compete on a maximum of 1 additional pony in the Children's Hunter Pony section at the same show.

Small Hunters: Open to horses over 14.2 hands and not to exceed 16 hands

Thoroughbred Hunters: Thoroughbred registration verification required, see [USEF HU 106.8](#)

USHJA Hunter: Open to all horses and ponies.

Short Stirrup: Rider no cross entry into any other classes except Low Under 3' Short Stirrup Equitation and Short Stirrup Pony or Short Stirrup Horse (as applicable to the class)

Long Stirrup: Riders no cross entry into rated classes 3' & up.

Large Hunter: Open to Horses Over 16 hands

Pre-Children's/Adult Hunter: Rider no cross entry into rated sections or classes with fences 3'6" or higher. May be split by age group if entries warrant.

Low Children's / Low Adult Hunter: Please see full [Zone 9 Specifications](#) for cross-entry restrictions.

Baby Green: Open to horses and ponies in 1st year of showing.

Sections may be combined if fewer than 4 entries in section.

ALL HUNTER CLASSES WILL BE JUDGED ON PERFORMANCE AND SOUNDNESS UNLESS OTHERWISE NOTED.

HUNTER WARM-UP CLASSES (NON-RATED)

Class #	Class	Height	Entry Fee	Prize Money
600	Warm-Up Hunter 18"	18"	\$55/class	
610	Warm-Up Hunter 2'	2'	\$55/class	
615	Warm-Up Hunter 2', 2'3", 2'6"	2', 2'3", 2'6"	\$55/class	
620, 621	Warm-Up Hunter 2'3"	2'3"	\$55/class	
630, 631, 632	Warm-Up Hunter 2'6"	2'6"	\$55/class	
640, 641	Warm-Up Hunter 2'9"	2'9"	\$55/class	
650, 651, 652	Warm-Up Hunter 3'	3'	\$55/class	
660, 661	Warm-Up Hunter 3'3"	3'3"	\$55/class	
670, 671	Warm-Up Hunter 3'6"	3'6"	\$55/class	
675	Warm-Up Hunter 3'9"	3'9"	\$55/class	
680, 681	Warm-Up Pony Hunter	Respective heights	\$55/class	

Braiding is optional. Not to jog.

Hunter competition in the Cascade Memorial Cup during the 2022 Swiftwater Invitational. Photo: Gary Voth



SPOTLIGHT CLASSES

Luxury DerbyCross

Presented by **Beluxari EQ**

Sunday, June 25, 2023

The Cascade-exclusive Luxury DerbyCross™ is a unique combined class challenging the skills of both rider and horse with back-to-back Handy Hunter and Jumper Speed rounds

Lowest combined score wins

\$1,000 distributed 1st through 6th

New rules for 2023: Formal Hunter attire and tack required; braiding optional

Salute to sponsor requested

Sianna Gable and Navadee en route to victory in the 2022 Alpine Preview's Luxury DerbyCross.



EQUITATION DIVISION

EQUITATION SECTIONS

Class #	Class (Section Code)	Height	Entry Fee
700, 701, 702 ³	Pony Equitation 2'3", 2'6", 2'9"-3' (AT)	2'3", 2'6", 2'9"-3'	\$150/section or \$55/class
703, 704, 705 ³	Long Stirrup Equitation 2'3" (AU)	2'3"	\$150/section or \$55/class
706, 707, 708 ³	Short Stirrup Equitation Horse 2'3" (AV)	2'3"	\$150/section or \$55/class
709, 710, 711 ³	Short Stirrup Equitation Pony 18" (AW)	18"	\$150/section or \$55/class
712, 713, 714 ³	Children's Pony Equitation 2', 2'3", 2'6" (AX)	2', 2'3", 2'6"	\$150/section or \$55/class
715, 716, 717 ³	Low Children's Equitation 2'6" (AY)	2'6"	\$150/section or \$55/class
718, 719, 720 ³	Low Adult Equitation 2'6" (AZ)	2'6"	\$150/section or \$55/class
721, 722, 723 ³	Pre-Children's/Adult Equitation 2'9" (BA)	2'9"	\$150/section or \$55/class
724, 725, 726 ³	Adult Equitation 18-39 3' (BB)	3'	\$150/section or \$55/class
727, 728, 729 ³	Adult Equitation 40 & Over 3' (BC)	3'	\$150/section or \$55/class
730, 731, 732 ³	Equitation 14 & Under 3' (BD)	3'	\$150/section or \$55/class
733, 734, 735 ³	Equitation 15-17 3' (BE)	3'	\$150/section or \$55/class

Class # footnotes: 3 = Not to jump

* Ponies ride respective heights

OPPORTUNITY CLASSES

USEF / USHJA memberships and horse recording are not required.

Class #	Class	Height	Entry Fee
905, 906, 907 ³ , 908, 909	Opportunity Walk/Trot Equitation		\$30/class
920, 921, 922 ³ , 923, 924	Opportunity Walk/Trot/Canter Equitation		\$30/class
925, 926, 927 ³ , 928, 929	Opportunity Cross Pole Equitation		\$30/class

Class # footnotes: 3 = Not to jump

Braiding is optional. Not to jog.



Vacation Homes & Cabins

Providing Premier Vacation Homes and Cabins for
Cle Elum, Roslyn, Suncadia Resort, & the Surrounding Areas



**Book Direct and Save
The Longer You Stay
The More You Save
CALL 509-649-3099**

www.GoASVR.com



Info@AllSeasonsVacationRents.com

MEDAL CLASSES

Class #	Class	Height	Entry Fee
800	WSHJA Good Hands & Seat 2'6"	2'6"	\$55/class
801	WSHJA Good Hands & Seat 3'	3'	\$55/class
802	WSHJA Good Hands & Seat 3'6"	3'6"	\$55/class
803	ASPCA Maclay Horsemanship Medal 3'6"	3'6"	\$55/class
804	Dover Saddlery/USEF Hunter Seat Medal 3'6"	3'6"	\$55/class
805	Hamel Foundation NHS Medal 3'3"	3'3"	\$55/class
806	EMO Insurance/USHJA Jumping Seat Medal 3'3"	3'3"	\$55/class
807	USEF/NCEA Junior Hunter Seat Medal 3'3"	3'3"	\$55/class
808	Taylor Harris Insurance National Children's Medal 3'	3'	\$55/class
809	Ariat National Adult Medal 3'	3'	\$55/class
810	Marshall & Sterling U.S. Pony Medal 2'3", 2'6", 2'9"-3'	Respective heights	\$55/class
811	OHJA Mini Medal 2'6"	2'6"	\$55/class
812	OHJA Children's Medal 3'	3'	\$55/class
813	OHJA Adult Medal 3'	3'	\$55/class
814	USHJA Jumping Seat Medal 3'3"	3'3"	\$55/class
815	USHJA 3'3" Hunter Seat Medal	3'3"	\$55/class
816	USEF Adult Equitation 3'3"	3'3"	\$55/class

WSHJA Medals: Open to juniors and amateurs. Riders must be WSHJA members prior to the start of the class.

ASPCA Maclay: Open to junior members of USEF or Equine Canada who have not reached their 18th birthday in accordance with GR127. Riders and their trainers or coaches must be current members of the National Horse Show Association ("NHSAA").

Dover Saddlery/USEF Hunter Seat: Open to Individual Junior USEF Members in good standing who have not reached their 18th birthday in accordance with GR127.

EMO Insurance/USHJA Jumping Seat: Open to Junior active members of US Equestrian and USHJA who have not reached their 18th birthday as of December 1 of the current competition year (per USEF rules).

USEF/NCEA: NCEA membership is not required to ride the class but only NCEA members receive points and will be included in rankings for the finals

Taylor Harris National Children's Medal: Riders not to compete in any hunter or equitation class 3'9" or higher, or jumper class set above 1.20m at same show

Ariat National Adult Medal: Riders not to compete over jumps that exceed 3'6" or 1.20m or higher at same show.

Marshall & Sterling U.S. Pony Medal: Tests young riders, judging their ability to compete over a technical and demanding course of fences.

OHJA Mini Medal: No cross entry with 3' medals. Riders must be OHJA members prior to the start of the class.

OHJA Children's Medal: Riders may not cross-enter junior hunters, junior jumpers, or any 3'6" medal class at the same show. Riders must be OHJA members prior to the start of the class.

OHJA Adult Medal: Riders must be OHJA members prior to the start of the class.

USHJA Adult Jumping Seat Medal: Open to amateur active USEF/USHJA members 18 years of age or older (per USEF rules).

USHJA 3'3" Hunter Seat Medal: Open to open to Junior Active Members of the USEF and USHJA who have not previously won a USHJA 3'3" Hunter Seat Medal Finals.

USEF Adult Equitation: Open to Amateur Senior Members of the Federation and USHJA.



#1

SHINE SPRAY ON THE MARKET

“ THE QUALITY OF EQUIFUSE SHINE IS SIMPLY

perfection in a bottle.

IT'S THE ONLY COAT SHINE SPRAY I TRUST ON MY SENSITIVE MARE. ”



LINDSEY DENOBREGA, EQUIFUSE USER

JUMPER DIVISION

JUMPER CLASSICS

Class #	Class	Height	Entry Fee	Prize Money
61	Open Jumper Classic .70m Presented by REVUP ENERGY	.70m	\$60/class	\$500
62	Open Jumper Classic .80m Presented by EquiFUSE	.80m	\$60/class	\$500
63	Open Jumper Classic .90m Presented by SUNDANCE EQUESTRIAN	.90m	\$60/class	\$500
64	Open Jumper Classic 1.00m Presented by WSHJA	1.00m	\$75/class	\$750

Formal Attire Required — Salute to Sponsors Requested

Prize Money — 25%, 23%, 20%, 17%, 15%

Jumper Classic riders must have ridden in at least 1 other class to compete.

Erin Lane and Meatloaf show fine form en route to a 3rd place finish in the Cascade Welcome 1.30m during the 2022 Swiftwater Invitational.

Photo: Gary Voth



Whittier Trust
INVESTMENT & WEALTH MANAGEMENT
WHITTIERTRUST.COM

JUMPER SECTIONS

Class #	Class	Height	Entry Fee	Prize Money
105, 106, 107, 108, 109	Jumper .70m	.70m	\$225/section or \$50/class	
120, 121, 122, 123, 124	Jumper .80m	.80m	\$225/section or \$50/class	
140, 141, 142, 143	Jumper .90m	.90m	\$180/section or \$50/class	
160, 161, 162, 163	Jumper 1.00m	1.00m	\$180/section or \$50/class	
170, 171, 172, 173	Jumper 1.10m	1.10m	\$200/section or \$55/class	\$250
175, 176, 177, 178	Jumper 1.15m	1.15m	\$200/section or \$55/class	\$250
180, 181, 182, 183	Jumper 1.20m	1.20m	\$200/section or \$55/class	\$250
185, 186 , 187	Jumper 1.30m	1.30m	\$55/class	\$250/ \$1,000
190, 191, 192	Jumper 1.40m	1.40m	\$55/class	\$250
200, 201, 202	PNW 5 Y/O Young Jumper 1.00m	1.00m	\$165/section or \$60/class	\$200
205, 206, 207	PNW 6 Y/O Young Jumper 1.10m	1.10m	\$165/section or \$60/class	\$200
210, 211, 212	PNW 7 Y/O Young Jumper 1.15m	1.15m	\$165/section or \$60/class	\$200
215, 216, 217	YJC 5 Y/O Young Jumper 1.10m	1.10m	\$165/section or \$60/class	\$200
220, 221, 222	YJC 6 Y/O Young Jumper 1.20m	1.20m	\$165/section or \$60/class	\$200
225, 226, 227	YJC 7 Y/O Young Jumper 1.30m	1.30m	\$165/section or \$60/class	\$200
230, 231, 232, 233 ²	Thoroughbred Jumper 1.00m	1.00m	\$180/section or \$50/class	Stake \$250
235, 236, 237, 238 ²	Pony Jumper 1.05m	1.05m	\$180/section or \$50/class	
240, 241, 242, 243 ²	Mod. Junior/Amateur Jumper 1.15m	1.15m	\$180/section or \$50/class	Stake \$500
245, 246, 247 ²	Junior/Amateur Jumper 1.20m	1.20m	\$150/section or \$55/class	Stake \$500

Class # footnotes: 2 = Stake

Stake Classes: Must have ridden in at least one other class in the same section at the same show to ride in any Stake Class

Class #186 is the Cascade Welcome 1.30m Spotlight class

PNW Young Jumpers: Open to jumpers with papers indicating a foaling date the number of years as indicated prior to the current calendar year. WSHJA membership required to qualify for PNW championship. ^ = Clear rounds

YJC Young Jumpers: Open to all horses. January 1 is the universal birthdate. To qualify for championships must be enrolled with USHJA YJC. Full details at USHJA.org. ^ = Clear rounds

Thoroughbred Jumper: Thoroughbred registration verification required according to USEF JP 120. Affiliated with the TAKE2 Thoroughbred League. Points count for USEF and TAKE2

Sections may be split by age group if there are more than 5 horses in each section

Tami Masters with Discotheque and Patrick Billes with IV Of Diamonds high five after winning the Jumpernite Rider Relay at the 2022 Alpine Preview.



JUMPER SECTIONS (CONTINUED)

Class #	Class	Height	Entry Fee	Prize Money
250, 251, 252, 253 ²	Low Adult Amateur Jumper .90m	.90m	\$180/section or \$50/class	Stake \$150
255, 256, 257, 258 ²	Low Children's Jumper .90m	.90m	\$180/section or \$50/class	Stake \$150
260, 261, 262, 263 ²	Low Adult Amateur Jumper 1.00m	1.00m	\$180/section or \$50/class	Stake \$150
265, 266, 267, 268 ²	Low Children's Jumper 1.00m	1.00m	\$180/section or \$50/class	Stake \$150
270, 271, 272, 273 ²	High Adult Amateur Jumper 1.10m	1.10m	\$180/section or \$50/class	Stake \$250
275, 276, 277, 278 ²	High Children's Jumper 1.10m	1.10m	\$180/section or \$50/class	Stake \$250

Class # footnotes: 2 = Stake

Children's & Adult Amateur jumper riders may not cross-enter classes with fences over 1.15m

Low Children's & Low Adult Amateur horse and rider combinations may not cross-enter the High Children's & High Adult Amateur Jumpers

High Children's & High Adult Amateur horse and rider combinations may not cross-enter the Low Children's & Low Adult Amateur Jumpers

Sections may be split by age group if there are more than 5 horses in each section

JUMPER WARM-UP CLASSES (NON-RATED)

Class #	Class	Height	Entry Fee	Prize Money
685	Warm-Up Jumper .70m	.70m	\$55/class	
690	Warm-Up Jumper .80m	.80m	\$55/class	
695	Warm-Up Jumper .90m	.90m	\$55/class	

SPOTLIGHT CLASSES

Need for Speed™ Open Jumper Classic

Presented by **Voltaire Design**

Sunday, June 18, 2023

Sunday, June 25, 2023

To be run at 1.20m or 1.10m with time penalty

\$750.00 prize money to be distributed 1st through 8th

The winner receives \$500 in Voltaire Design accessories

Formal attire required; salute to sponsor requested

*Lynne Wilber and
Mystic Mojo en route
to a 2nd place finish
in the Need for Speed
at the 2022
Swiftwater
Invitational.*



CHAMPIONSHIPS OFFERED

Hunter Section Championships

High Performance Hunter 3'9" (B)	Junior Hunter 15-17 3'6" (Q)	USHJA 2'6" Hunter (AH)
Performance Hunter 3'6" (C)	Junior Hunter 14 & Under 3'6" (R)	USHJA 2'9" Hunter (AI)
Performance Hunter 3'3" (D)	Junior Hunter 15-17 3'3" (U)	USHJA 3' Hunter (AJ)
Green Hunter 3'9" (E)	Junior Hunter 14 & Under 3'3" (V)	Short Stirrup Hunter Horse 17 & Under 2'3" (AK)
Green Hunter 3'6" (F)	Pony Hunter (SML) 2'3", 2'6", 2'9"-3' (W)	Short Stirrup Hunter Pony 17 & Under 18" (AL)
Green Hunter 3'3" (G)	Green Pony Hunter (SML) 2'3", 2'6", 2'9" (X)Adult	Long Stirrup Hunter 18 & Over 2'3" (AM)
Green Hunter 3' (H)	Amateur Hunter 18-39 3' (Z)	Small Hunter 3' (AN)
Young Hunter 3'3" - Horses 7 & Under (J)	Adult Amateur Hunter 40 & Over 3' (AA)	Large Hunter 3' (AO)
Young Hunter 3' - Horses 6 & Under (K)	Children's Hunter 13 & Under 3' (AB)	Pre-Children's/Adult Hunter 2'9" (AP)
Young Hunter 2'9" - Horses 5 & Under (L)	Children's Hunter 14-17 3' (AC)	Low Children's Hunter 2'6" (AQ)
Amateur Owner Hunter 36 & Over 3'6" (M)	Children's Hunter Pony 2', 2'3", 2'6" (AD)	Baby Green Hunter 2'6" (AR)
Amateur Owner Hunter 36 & Over 3'3" (N)	Thoroughbred Hunter 3' (AE)	Low Adult Hunter 2'6" (AS)
Amateur Owner Hunter 18-35 3'3" (O)	USHJA 2' Hunter (AF)	
Amateur Owner Hunter 18-35 3'6" (P)	USHJA 2'3" Hunter (AG)	

Hunter Championships: Hunter champion and reserve will be awarded to two of the four horses scoring the most points over fences. In addition, only these top four horses will receive full points for ribbons won under saddle and half points for ribbons won in model. Points will be awarded 10, 6, 4, 2, 1, ½.

Equitation Section Championships

Pony Equitation 2'3", 2'6", 2'9"-3' (AT)	Children's Pony Equitation 2', 2'3", 2'6" (AX)	Adult Equitation 18-39 3' (BB)
Long Stirrup Equitation 2'3" (AU)	Low Children's Equitation 2'6" (AY)	Adult Equitation 40 & Over 3' (BC)
Short Stirrup Equitation Horse 2'3" (AV)	Low Adult Equitation 2'6" (AZ)	Equitation 14 & Under 3' (BD)
Short Stirrup Equitation Pony 18" (AW)	Pre-Children's/Adult Equitation 2'9" (BA)	Equitation 15-17 3' (BE)

Equitation Championships: points for all classes shall be calculated 10, 6, 4, 2, 1, ½. In the case of a tie for champion or reserve, the winner shall be the entry with the most points over fences. If still tied, the entry with the most points in the equitation flat class will win the tie.

Jumper Section Championships

Jumper .70m	Jumper 1.20m	Low Adult Amateur Jumper 1.00m
Jumper .80m	Jumper 1.30m	Low Children's Jumper .90m
Jumper .90m	Jumper 1.40m High Adult Amateur Jumper 1.10m	Low Children's Jumper 1.00m
Jumper 1.00m	High Children's Jumper 1.10m	Mod. Junior/Amateur Jumper 1.15m
Jumper 1.10m	Junior/Amateur Jumper 1.20m	Pony Jumper 1.05m
Jumper 1.15m	Low Adult Amateur Jumper .90m	Thoroughbred Jumper 1.00m

Jumper Championships: in jumper championships, points for all classes shall be calculated 10, 6, 4, 2, 1, 1/2. In case of a tie for champion or reserve the tied entries shall remain tied and each receive a ribbon and trophy / prize

All: At least three competitors must compete in the first class of a section for it to run.

Sections codes (in parentheses) allow convenient entry into all classes in section.

Join WSHJA!

Why become a member?

- Opportunity to participate in the WSHJA Annual Awards Program, earning points towards year-end championships.
- Access to WSHJA Scholarships to financially aid in attending Equitation, Hunter, and Jumper Finals.
- Exclusive invitations to educational events, including judges' clinics, trainer symposiums, and much more!
- Access to a community of horse-loving individuals who share your interest and passion for the horse.



2023 WSHJA HORSE SHOWS

SPRING INAUGURAL* - April 5-9

SPRING NATIONAL - April 12-16

PACIFIC NORTHWEST* - May 17-21

EVERGREEN CLASSIC - August 3-6

NORTHWEST AUTUMN CLASSIC -
Sept 13-17

OCTOBER CLASSIC* - October 11-15

* - Outreach Show Overlay



Scan this code to view our website!

Proud Sponsor of

Cascade
HORSE SHOWS

SPOTLIGHT CLASSES

Cascade Welcome 1.30m

Presented by **Lionheart Training**

Thursday, June 15, 2023

Thursday, June 22, 2023

The \$1,000 Cascade Welcome is a thrilling 1.30m Table II, Sec 2(a/b) jumper class—
Time first with a jump off; ties to jump off for first place

\$1,000 prize money distributed 1st through 6th 30%, 23%, 15%, 12%, 10%, 10%

This class counts toward the Jumper 1.30m section championship

Traditional attire encouraged; salute to sponsor requested



Patrick Billes and Esperanto LS fly to first place in the Cascade Welcome 1.30m at the 2022 Alpine Preview

SPECIFICATIONS

Cascade Grand Prix, #1, 2

The Grand Prix held at each Cascade show will be run as a Table II, Sec 2(a/b) — Time first with a jump off; ties to jump off for first place. Order of go will be drawn by Show Management under supervision of the USEF Steward and posted by 2pm the day of the class. Prize money will be distributed as 1st 30%, 2nd 20%, 3rd 14%, 4th 10%, 5th 8%, 6th 7%, 7th 6%, 8th 5% unless otherwise stated. Horses and riders must have competed in at least one other class in the competition. Formal attire required; salute to sponsors requested. June shows qualify for the Washington State Elite Jumper Year End Award sponsored by WSHJA. *The Cascade Grand Prix is generously presented by The Absolute Horse and Whittier Trust.*

USHJA National Hunter Derby, #3

The USHJA National Hunter Derby features a two-round format with a minimum of two judges utilizing a numerical system to score competitors in the Classic Hunter Round (first round) on performance, hunter pace, jumping style, quality and substance, and movement. A second round will feature a Handy Hunter course designed to reflect brilliance of pace and handiness. In each round, following the judges' base score, one point will be added for each high-option fence jumped; up to a maximum of four high options may be included. Fences are set at 3' with four high-option fences set at 3'5" (June) or 3'3" (July/September). Prize money will be distributed as: 1st 30%, 2nd 22%, 3rd 13%, 4th 8%, 5th 6%, 6th 5%, 7th 4%, 8th-9th 3%, 10th-12th 2% unless otherwise stated. The top 3 Amateurs/Juniors will also be recognized. Formal attire required; salute to sponsor requested. Full specs can be found in this document and with the United States Hunter Jumper Association. *The Cascade USHJA National Hunter Derby is generously presented by Brick Road Farms.*

Luxury DerbyCross™, #7

The Luxury DerbyCross is a unique combined class that challenges the skills of a rider and horse pair to perform in both the Hunter and Jumper disciplines. This class features both a Handy Hunter Derby round and a Jumper Speed round which are ridden back-to-back with no break. The Handy Hunter Derby round will include some natural fences, at least one trot fence and bending line and will be judged on performance, hunter pace, style, quality, and handiness. The Jumper speed round will consist of a minimum of 8 jumps 1.00m with a minimum of one combination and will be judged as Table II.1 (a speed class). The Hunter course will have fences at 3' with 2 high options of 3'3". Riders will ride the Hunter course first, then immediately walk on a designated path to the Jumper course to begin their speed round. Riders MUST stay mounted and MUST walk from one ring to the other having NO interaction with trainers, spectators, or family. Upon entering the Jumper ring, the horse and rider will have 5 seconds before the starting whistle. Once the whistle is blown, the horse and rider must cross the start line within the time allowed or face time penalties. A total of two refusals will constitute elimination. Scoring: points will be assigned to both Hunter and Jumper rounds and added together to determine the winner. Horse and rider must be present to ride for ribbons. Prize money will be distributed as: 1st 30%, 2nd 23%, 3rd 15%, 4th 12%, 5th 10%, 6th 10%. Formal attire required; salute to sponsor requested. Formal Hunter attire and tack required. Braiding is optional. *The Luxury DerbyCross is generously presented by BELUXARI EQ*

Cascade Welcome 1.30m, #186

The Cascade Welcome held at each Cascade show will be run as a Table II, Sec 2(a/b) — Time first with a jump off; ties to jump off for first place. Order of go will be drawn by Show Management under supervision of the USEF Steward and posted by 2pm the day of the class. Prize money will be distributed as: 1st 30%, 2nd 23%, 3rd 15%, 4th 12%, 5th 10%, 6th 10% unless otherwise stated. This class counts towards the Jumper 1.30m section championship. *The Cascade Welcome 1.30m is generously presented by Lionheart Training.*

SPECIFICATIONS (CONT.)

Junior/Amateur Hunt & Handy, #10

In a single round, this class combines a classic Hunter course of 6-8 jumps immediately followed by a Handy course of 4-6 jumps for a total of 12 obstacles. The course will be set at 2'6" with 2'9" options unless otherwise posted. Competitors will be judged on performance, hunter pace, jumping style, quality and substance, movement, and handiness. One point is added to the final score for each high option taken. Prize money to be distributed as 1st 30%, 2nd 25%, 3rd 20%, 4th 15%, 5th 10%, with ribbons to 8th. Formal attire required; salute to sponsor requested. *The Junior/Amateur Hunt & Handy is generously presented by Olson's Tack Shop.*

Rosé All Day Amateur Classic, #11

Run in the spirit of a traditional Hunter Hack for all 21 & older amateur riders. A Hunter Hack is a type of English pleasure class where exhibitors in Hunt seat tack and attire perform on the flat at a walk, trot, canter, and hand gallop, and then jump two low fences. For this unique variation, riders may be asked to walk, trot, canter, change direction, sit the trot, halt & back up, and jump a cavalletti line, all while holding a glass of "rosé" wine! Class will be pinned on Judges Score adjusted for the "rosé" left in your glass. Prize money will be distributed as: 1st 50%, 2nd 30%, 3rd 20%. The winner also takes home a case of (real) rosé wine with bottles of rosé to 8th place. Traditional attire encouraged; salute to sponsor requested. *The Rosé All Day Amateur Classic is generously presented by American Mechanical.*

No Joke, Hold My Coke Classic, #14

FOR THE UNDER 21 SET. A team event that involves riding some bounces and bouncing bareback. Fastest time wins. \$25 cash entry only. Prize money distributed as: 1st 50%, 2nd 30%, 3rd 20%. The winner takes home a hippity-hop horse and a case of Coke Classic. Salute to sponsors requested. *The No Joke, Hold My Coke Classic is generously presented by Burkwood Farm.*

Parents on Parade Leadline, #15

No Fee. Swiftwater Invitational - Week 1 preceding the Whittier Trust Grand Prix. All horse show parents, grandparents, godparents and family friends are qualified. Show off your "parental" equestrian skills while being led on course by your young horse show competitor. Smiles for all. Helmet and boots required. *The Parents on Parade Leadline is generously presented by Laurel Zeeman CPA.*

Rising Stars Leadline, #16

No Fee. Alpine Preview - Week 2 preceding the Horseware Grand Prix. Wow the crowd with style and smiles. Prizes to all. Helmet and boots required. *The Rising Stars Leadline is generously presented by presented by Kerrits Equestrian.*

Cascade Memorial Cup, #19

This unique class is modeled after the Nations Cup format. *100% of the proceeds from entry fees for this class will be donated to charity.* Each team will consist of four riders, to include one professional and a combination of either juniors or amateur riders. A total of four rounds will be jumped by each team, two classic hunter rounds and two handy hunter rounds. The sum of the highest three scores for each team will decide the placings. In the case of a tie for first place, each team will choose one team member to ride off. This class will run at two heights, 2'6" and 3', each team will jump a classic and handy round at each height. One team member will ride the classic round and another team member will ride the handy round. Both height options must be completed by the team. Limited to 8 teams total and riders may not ride for more than one team. Each team is responsible for submitting a team biography, to include the team members and their horses, who the team is riding in memory of, and what charity they are riding for. The entry fees are all add-back and a donation to the charity of top three team's choices. No prize money will be paid to riders in this class. Prize money will be distributed as 1st 50%, 2nd 30%, 3rd 10% to the charities of the top three team's choices. Ribbons and prizes will be awarded 1st through 8th. Formal attire required but a team flair is encouraged. *The Cascade Memorial Cup is generously presented by Deep Creek Farm in honor of Sally Burge.*

SPECIFICATIONS (CONT.)

Need For Speed™ Open Jumper, #20

The Need for Speed Open Jumper will be run as a Table III speed round, with faults converted into seconds. A time limit of 120 seconds will apply, and faults incurred will be penalized by adding four seconds for each occurrence. This class is offered at 1.10m and 1.20m. Entrants must designate which height they intend to compete in at the time they enter. At the 1.10m height a 2 second handicap will be added to each competitor's time. Prize money will be distributed as: 1st 30%, 2nd 20%, 3rd 14%, 4th 10%, 5th 8%, 6th 7%, 7th 6%, 8th 5% unless otherwise stated. Formal attire required; salute to sponsor requested. *The Need for Speed Open Jumper is generously presented by Voltaire Design.*

Cascade Hunter Classics, #30-40

All Classics are two rounds. The final round over fences of the corresponding section is to count as the first round of the respective Classic. Round 2 to be shown over a course of at least 9 obstacles. Hunter Classic horses or ponies must have competed in at least two hunter classes in the corresponding section to compete. Prize money will be distributed as: 1st 30%, 2nd 25%, 3rd 20%, 4th 15%, 5th 10% unless otherwise stated. Formal attire required; salute to sponsor requested.

Cascade Open Jumper Classics, #60-62

Jumper Classic riders must have ridden in at least one other class in the corresponding section to compete. Open Jumper Classics are offered at .75m, .85m and .90m. Ribbons to 8th, prize money to 5th: (30%, 25%, 20%, 15%, 10%).



THE GRANGE
SINCE 1934
COUNTRY CO-OP
For the Farmer in All of Us!™

THE GRANGE
FOR ALL YOUR HORSE NEEDS

Blankets,
Fly Sheets,
Feed & Treats,
Supplements,
Grooming Supplies,
and more!

145 NE GILMAN BLVD ISSAQUAH, WA 98027
(425) 392-6469 www.grangesupply.com shop.grangesupply.com

f i

SPOTLIGHT CLASSES

No Joke, Hold My Coke Classic

Presented by **Burkwood Farm**

Saturday, June 24, 2023

A combined event challenging the under-21 set to a bouncy horse / soft drink competition.
(Who said the adults with their Rosé class should have all the fun?)

\$25 cash entry only

Prize money distributed 1st through 3rd, 50%, 30%, 20%

The winner takes home a hippity-hop horse and a case of Coke Classic!

New for 2023: two age brackets!



2022 winner Olivia Taylor

USHJA NATIONAL HUNTER DERBY SPECIFICATIONS



Jumps in ALL Rounds

1. Obstacles will simulate those reminiscent of the hunt field and course must offer a variety of Classic jumps with different appearances such as: natural post and rail, stone wall, white board fence or gate, coop, aiken, hedge, oxer, brush, logs, natural foliage. At least 3 types will be utilized.
2. Natural obstacles such as banks and ditches are allowed.
3. A minimum of 2" difference is required for the back element of all oxers.
4. Ground lines are not to exceed 18" in depth from the vertical plane of the jump. For appropriate jumps, no ground line is necessary.
5. The jumpable portion of any fence must be a minimum of 8 feet on its front face.
6. The top element of all jumps must be in cups except for walls with movable bricks.
7. Flat cups may only be used for log fences and in accordance with Federation rules.
8. Distances will not be adjusted for ponies.
9. Fence height 3'0".
10. There must be four option fences set at 3'5".

First Round: Classic Hunter Course

1. A minimum of ten obstacles must be offered in the Classic Hunter Round.
2. At least one in and out
3. At least one bending line
4. At least one line with an unrelated distance
5. At least one long approach

Second Round: Handy Hunter Course

1. A minimum of eight obstacles must be offered in the Handy Hunter Round.
2. The course should simulate riding over hunt country and must have a minimum of two handy options, such as: tight turns, different tracks, clever options for jump approaches, pen type obstacles, hand gallop a jump, trot a lowered obstacle not to exceed 2'6" in height, halt and/or back. Gimmicky options are not appropriate.
3. Unless the prize list states that more than twelve (12) entries are to return for the second round, then only the top twelve (12) horses from the first round, after all ties are broken, are eligible to return for the second round.

Class Specifications

1. All riders in the top twelve overall (or their designated representative if not available) must ride for ribbons to receive prize money. Although not required, a show may choose to award separate ribbons for the first-round if so stated in the prize list.

2. For National Hunter Derby zone HOTY bonus points to be awarded, riders must complete a USHJA Exhibitor Declaration Form. If the Exhibitor Declaration Form is not completed and submitted to the show office at the time of entry or at least one hour prior to the start of the class, riders will not receive zone HOTY bonus points for the National Hunter Derby.
3. Points accrued by horses shown by Professionals may be awarded to the declared Green Hunter 3' or 3'3" section or Performance Hunter 3'3" or Small Hunter.
4. Points accrued by horses shown by Juniors or Amateurs may be awarded to the declared Green 3' or 3'3" section, Performance Hunter 3'3", or the applicable Children's, Pony, Adult Amateur or Amateur Owner 3'3", Small Hunter, or Junior Hunter 3'3".

Judging System

1. The first round shall be judged on performance, hunter pace, jumping style, quality and substance, and movement. After the judges base score is given, one (1) point will be added for each high option fence jumped. The Option Bonus Score of one additional point must be awarded even if there is a refusal, rail down or loss of good jumping style at that higher height option fence, providing that the horse-and-rider combination does jump the higher height option fence. (Maximum of four points.)
2. The second round shall be judged on performance, hunter pace, jumping style, quality and substance, movement, handiness and brilliance of pace. Handiness is defined as ground saving movement without adversely affecting performance or style. Brilliance of pace is defined as a faster pace than ordinary, without sacrificing performance or style. Handiness is taken into account in the judges' base score. After the judges' base score is given, one (1) point will be added for each high option fence jumped. The Option Bonus Score of one additional point must be awarded even if there is a refusal, rail down or loss of good jumping style at that higher height option fence, providing that the horse-and-rider combination does jump the higher height option fence. (Maximum of four points.)

Membership Requirements

1. Riders, owners, and trainers must be a current Active member of USEF and USHJA to participate in this class. (see GR202).
2. Horses and ponies must be registered with USHJA to participate in this class. Exception: Foreign residents and horses and ponies in good standing with their National Federation are eligible to compete in this class.
3. USHJA Zone HOTY bonus points will only be awarded if the owner is a current Active member of USEF, has completed a USHJA Exhibitor Declaration Form and the horse is recorded with USEF and registered with USHJA.

For Full USHJA National Hunter Derby Specifications see: <https://ushja.org/competition/hunter/national-hunter-derby>

Laurel Zeeman CPA

*It's about more than understanding your taxes...
It's about understanding YOU!*

I prefer to take a proactive — not reactive — approach to your taxes. By keeping current on new tax laws and legislation, I am in a position to identify key tax planning opportunities that minimize both your current and future tax liabilities. And as a horsewoman, I understand the specific needs of the hunter jumper community, and am proud to be a sponsor of Cascade shows.

I provide my clients with the expertise they deserve — *year round.*



CONTACT

211 Taylor Street, # 4,
Port Townsend, Washington
98368
(360) 301-0042 *(no texts please)*
<https://porttownsendcpa.com/>

HOURS

Tax Season (January-April)
Monday - Wednesday 9-5
Thursday-Friday By appointment only
Off Season (May-December)
By appointment only

much more than just a feed store

Much more than just a feed store
OLD MILL
COUNTRY STORE
1987 - 2017

Open 7 Days A Week
509-925-5397 • 500 W. Third

Whether it's for commercial use or for the animals in your back yard, let our knowledgeable staff help find you the right product to keep your animals healthy and happy.

Old Mill Country Store is your total source supplier of cutting edge animal health and nutrition products

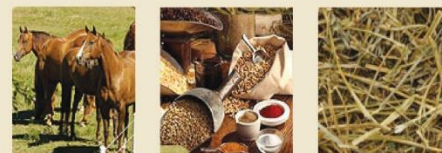



SWIFTWATER INVITATIONAL

June 14-18, 2023

USEF #329346

Rachael Davis and Luxury

Cascade Memorial Cup, 2022 Swiftwater Invitational

SCHEDULES: SWIFTWATER INVITATIONAL

June 14-18, 2023

2023 Swiftwater Invitational

Wednesday, June 14, 2023

Grand Hunter Arena

Presented by Parkwood Equestrian

8:00 AM

670	Warm-Up Hunter 3'6"
325, 326	Green Hunter 3'6"
310, 311	Performance Hunter 3'6"
675	Warm-Up Hunter 3'9"
305, 306	High Performance Hunter 3'9"
320, 321	Green Hunter 3'9"
660	Warm-Up Hunter 3'3"
315, 316	Performance Hunter 3'3"
515, 516	Large Hunter 3'
330, 331	Green Hunter 3'3"
345, 346	Young Hunter 3'3" - Horses 7 & Under
650	Warm-Up Hunter 3'
335, 336	Green Hunter 3'
350, 351	Young Hunter 3' - Horses 6 & Under
450, 451	Small Hunter 3'
480, 481	USHJA 3' Hunter
455, 456	Thoroughbred Hunter 3'
630	Warm-Up Hunter 2'6"
470, 471	USHJA 2'6" Hunter
535, 536	Baby Green Hunter 2'6"

Cascade Hunter Arena

Presented by WA State Hunter Jumper Association

9:00 AM

640	Warm-Up Hunter 2'9"
355, 356	Young Hunter 2'9" - Horses 5 & Under
357	Young Hunter 2'9" - Horses 5 & Under U/S
475, 476	USHJA 2'9" Hunter
477	USHJA 2'9" Hunter U/S
620	Warm-Up Hunter 2'3"
465, 466	USHJA 2'3" Hunter
467	USHJA 2'3" Hunter U/S
610	Warm-Up Hunter 2'
460, 461	USHJA 2' Hunter
462	USHJA 2' Hunter U/S

Grand Jumper Arena

Presented by Farpoint Farm in honor of Kona Coast

8:00 AM

685	Warm-Up Jumper .70m IV.1
105	Jumper .70m II.2b
690	Warm-Up Jumper .80m
120	Jumper .80m II.2b
695	Warm-Up Jumper .90m IV.1
140	Jumper .90m II.2b
160	Jumper 1.00m II.2b
230	Thoroughbred Jumper 1.00m II.2b
200	PNW 5 Y/O Young Jumper 1.00m II.2b
170	Jumper 1.10m II.2b
205	PNW 6 Y/O Young Jumper 1.10m II.2b
215	YJC 5 Y/O Young Jumper 1.10m II.2b
175	Jumper 1.15m II.2b
210	PNW 7 Y/O Young Jumper 1.15m II.2b
180	Jumper 1.20m II.2b
220	YJC 6 Y/O Young Jumper 1.20m II.2b
245	Junior/Amateur Jumper 1.20m II.2b
185	Jumper 1.30m II.2b
225	YJC 7 Y/O Young Jumper 1.30m II.2b
190	Jumper 1.40m II.2b

2023 Swiftwater Invitational

Thursday, June 15, 2023

Grand Hunter Arena

Presented by Parkwood Equestrian

8:00 AM

- 327 Green Hunter 3'6"
- 328 Green Hunter 3'6" Handy
- 312 Performance Hunter 3'6"
- 313 Performance Hunter 3'6" Handy
- 314 Performance Hunter 3'6" U/S
- 329 Green Hunter 3'6" U/S
- 307 High Performance Hunter 3'9"
- 308 High Performance Hunter 3'9" Handy
- 322 Green Hunter 3'9"
- 323 Green Hunter 3'9" Handy
- 309 High Performance Hunter 3'9" U/S
- 324 Green Hunter 3'9" U/S
- 317 Performance Hunter 3'3" U/S
- 332 Green Hunter 3'3" U/S
- 347 Young Hunter 3'3" - Horses 7 & Under U/S
- 318 Performance Hunter 3'3"
- 319 Performance Hunter 3'3" Handy
- 348, 349 Young Hunter 3'3" - Horses 7 & Under
- 333, 334 Green Hunter 3'3"
- 337 Green Hunter 3' U/S
- 338, 339 Green Hunter 3'
- 352, 353 Young Hunter 3' - Horses 6 & Under
- 482, 483 USHJA 3' Hunter
- 457 Thoroughbred Hunter 3'
- 458 Thoroughbred Hunter 3' Stake
- 452 Small Hunter 3'
- 453 Small Hunter 3' Stake
- 517 Large Hunter 3'
- 518 Large Hunter 3' Stake
- 354 Young Hunter 3' - Horses 6 & Under U/S
- 454 Small Hunter 3' U/S
- 519 Large Hunter 3' U/S
- 484 USHJA 3' Hunter U/S
- 459 Thoroughbred Hunter 3' U/S
- 472, 473 USHJA 2'6" Hunter
- 537, 538 Baby Green Hunter 2'6"
- 39 Cascade Hunter Classic 2'6"**
Presented by Kerrits Equestrian
- 539 Baby Green Hunter 2'6" U/S
- 474 USHJA 2'6" Hunter U/S

Cascade Hunter Arena

Presented by WA State Hunter Jumper Association

8:00 AM

- 358, 359 Young Hunter 2'9" - Horses 5 & Under
- 478, 479 USHJA 2'9" Hunter
- 40 Cascade Hunter Classic 2'9"**
Presented by Kerrits Equestrian
- 468, 469 USHJA 2'3" Hunter
- 38 Cascade Hunter Classic 2'3"**
Presented by Kerrits Equestrian
- 463, 464 USHJA 2' Hunter
- 37 Cascade Hunter Classic 2'**
Presented by Kerrits Equestrian

Grand Jumper Arena

Presented by Farpoint Farm in honor of Kona Coast

8:00 AM

- 106 Jumper .70m IV.2b
- 121 Jumper .80m II.2b
- 141 Jumper .90m II.2b
- 250 Low Adult Amateur Jumper .90m II.2b
- 255 Low Children's Jumper .90m II.2b
- 161 Jumper 1.00m II.2c
- 231 Thoroughbred Jumper 1.00m II.2b
- 201 PNW 5 Y/O Young Jumper 1.00m II.2b
- 260 Low Adult Amateur Jumper 1.00m II.2b
- 265 Low Children's Jumper 1.00m II.2b
- 235 Pony Jumper 1.05m II.2b
- 171 Jumper 1.10m II.2c
- 206 PNW 6 Y/O Young Jumper 1.10m II.2b
- 216 YJC 5 Y/O Young Jumper 1.10m II.2b
- 270 High Adult Amateur Jumper 1.10m II.2b
- 275 High Children's Jumper 1.10m II.2b
- 176 Jumper 1.15m II.2c
- 211 PNW 7 Y/O Young Jumper 1.15m II.2b
- 240 Mod. Junior/Amateur Jumper 1.15m II.2b
- 181 Jumper 1.20m II.2c
- 221 YJC 6 Y/O Young Jumper 1.20m II.2b
- 246 Junior/Amateur Jumper 1.20m II.1
- 226 YJC 7 Y/O Young Jumper 1.30m II.2b
- 191 Jumper 1.40m II.2b
- 186 Cascade Welcome 1.30m II.2a/b**
Presented by Lionheart Training
Estimated start: 5:00 PM

2023 Swiftwater Invitational

Friday, June 16, 2023

Grand Hunter Arena

Presented by Parkwood Equestrian

8:00 AM

- 651 Warm-Up Hunter 3'
- 730, 731 Equitation 14 & Under 3' O/F
- 733, 734 Equitation 15-17 3' O/F
- 732 Equitation 14 & Under 3' Not to jump
- 735 Equitation 15-17 3' Not to jump
- 724, 725 Adult Equitation 18-39 3' O/F
- 727, 728 Adult Equitation 40 & Over 3' O/F
- 801 WSHJA Good Hands & Seat 3'
- 726 Adult Equitation 18-39 3' Not to jump
- 729 Adult Equitation 40 & Over 3' Not to jump
- 661 Warm-Up Hunter 3'3"
- 370, 371 Amateur Owner Hunter 18-35 3'3"
- 375, 376 Amateur Owner Hunter 36 & Over 3'3"
- 405, 406 Junior Hunter 14 & Under 3'3"
- 400, 401 Junior Hunter 15-17 3'3"
- 807 USEF/NCEA Junior Hunter Seat Medal 3'3"
- 671 Warm-Up Hunter 3'6"
- 360, 361 Amateur Owner Hunter 18-35 3'6"
- 365, 366 Amateur Owner Hunter 36 & Over 3'6"
- 385, 386 Junior Hunter 14 & Under 3'6"
- 380, 381 Junior Hunter 15-17 3'6"
- 802 WSHJA Good Hands & Seat 3'6"
- 631 Warm-Up Hunter 2'6"
- 715, 716 Low Children's Equitation 2'6" O/F
- 718, 719 Low Adult Equitation 2'6" O/F
- 800 WSHJA Good Hands & Seat 2'6"
- 717 Low Children's Equitation 2'6" Not to jump
- 720 Low Adult Equitation 2'6" Not to jump
- 680 Warm-Up Pony Hunter (respective heights)
- 700, 701 Pony Equitation 2'3", 2'6", 2'9"-3' O/F (respective heights)
- 702 Pony Equitation 2'3", 2'6", 2'9"-3' Not to jump

19 Cascade Memorial Cup

Presented by Deep Creek Farm in honor of Sally Burge

Estimated start: 5:30 PM

Cascade Hunter Arena

Presented by WA State Hunter Jumper Association

8:00 AM

- 641 Warm-Up Hunter 2'9"
- 721, 722 Pre-Children's/Adult Equitation 2'9" O/F
- 723 Pre-Children's/Adult Equitation 2'9" Not to jump
- 621 Warm-Up Hunter 2'3"
- 706, 707 Short Stirrup Equitation Horse 2'3" O/F
- 703, 704 Long Stirrup Equitation 2'3" O/F
- 708 Short Stirrup Equitation Horse 2'3" Not to jump
- 705 Long Stirrup Equitation 2'3" Not to jump
- 615 Warm-Up Hunter 2', 2'3", 2'6" (respective heights)
- 712, 713 Children's Pony Equitation 2', 2'3", 2'6" O/F (respective heights)
- 714 Children's Pony Equitation 2', 2'3", 2'6" Not to jump
- 600 Warm-Up Hunter 18"
- 709, 710 Short Stirrup Equitation Pony 18" O/F
- 711 Short Stirrup Equitation Pony 18" Not to jump
- 925, 926 Opportunity Cross Pole Equitation O/F
- 927 Opportunity Cross Pole Equitation Not to jump
- 920, 921 Opportunity Walk/Trot/Canter Equitation O/F
- 905, 906 Opportunity Walk/Trot Equitation O/F
- 922 Opportunity Walk/Trot/Canter Equitation Not to jump
- 907 Opportunity Walk/Trot Equitation Not to jump

Grand Jumper Arena

Presented by Farpoint Farm in honor of Kona Coast

8:00 AM

- 172 Jumper 1.10m II.2b
- 207 PNW 6 Y/O Young Jumper 1.10m II.2b
- 217 YJC 5 Y/O Young Jumper 1.10m II.2b
- 271 High Adult Amateur Jumper 1.10m II.2b
- 276 High Children's Jumper 1.10m II.2b
- 177 Jumper 1.15m II.2b
- 212 PNW 7 Y/O Young Jumper 1.15m II.2b
- 241 Mod. Junior/Amateur Jumper 1.15m II.2b
- 182 Jumper 1.20m II.2b
- 222 YJC 6 Y/O Young Jumper 1.20m II.2b
- 247 Junior/Amateur Jumper 1.20m Stake II.2b
- 187 Jumper 1.30m II.1
- 227 YJC 7 Y/O Young Jumper 1.30m II.2b
- 192 Jumper 1.40m II.1
- 107 Jumper .70m IV.1
- 108 Jumper .70m II.2b
- 122 Jumper .80m IV.1
- 123 Jumper .80m II.2b
- 142 Jumper .90m II.1
- 251 Low Adult Amateur Jumper .90m II.2b
- 256 Low Children's Jumper .90m II.2b
- 162 Jumper 1.00m II.2b
- 232 Thoroughbred Jumper 1.00m II.1
- 202 PNW 5 Y/O Young Jumper 1.00m II.2b
- 261 Low Adult Amateur Jumper 1.00m II.1
- 266 Low Children's Jumper 1.00m II.1
- 236 Pony Jumper 1.05m IV.2b

64 Open Jumper Classic 1.00m

Presented by WSHJA

2023 Swiftwater Invitational

Saturday, June 17, 2023

Grand Hunter Arena

Presented by Parkwood Equestrian

After USHJA Jumper Medal Class

- 372 Amateur Owner Hunter 18-35 3'3"
- 373 Amateur Owner Hunter 18-35 3'3" Handy
- 377 Amateur Owner Hunter 36 & Over 3'3"
- 378 Amateur Owner Hunter 36 & Over 3'3" Handy
- 374 Amateur Owner Hunter 18-35 3'3" U/S
- 379 Amateur Owner Hunter 36 & Over 3'3" U/S
- 407 Junior Hunter 14 & Under 3'3"
- 408 Junior Hunter 14 & Under 3'3" Handy
- 402 Junior Hunter 15-17 3'3"
- 403 Junior Hunter 15-17 3'3" Handy
- 805 Hamel Foundation NHS Medal 3'3"
- 409 Junior Hunter 14 & Under 3'3" U/S
- 404 Junior Hunter 15-17 3'3" U/S
- 362 Amateur Owner Hunter 18-35 3'6"
- 363 Amateur Owner Hunter 18-35 3'6" Handy
- 367 Amateur Owner Hunter 36 & Over 3'6"
- 368 Amateur Owner Hunter 36 & Over 3'6" Handy
- 364 Amateur Owner Hunter 18-35 3'6" U/S
- 369 Amateur Owner Hunter 36 & Over 3'6" U/S
- 387 Junior Hunter 14 & Under 3'6"
- 388 Junior Hunter 14 & Under 3'6" Handy
- 382 Junior Hunter 15-17 3'6"
- 383 Junior Hunter 15-17 3'6" Handy
- 803 ASPCA Maclay Horsemanship Medal 3'6"
- 804 Dover Saddlery/USEF Hunter Seat Medal 3'6"
- 389 Junior Hunter 14 & Under 3'6" U/S
- 384 Junior Hunter 15-17 3'6" U/S
- 652 Warm-Up Hunter 3'
- 425, 426 Adult Amateur Hunter 18-39 3'
- 430, 431 Adult Amateur Hunter 40 & Over 3'
- 809 Ariat National Adult Medal 3'
- 813 OHJA Adult Medal 3'
- 435, 436 Children's Hunter 13 & Under 3'
- 440, 441 Children's Hunter 14-17 3'
- 808 Taylor Harris Insurance National Children's Medal 3'
- 812 OHJA Children's Medal 3'
- 427 Adult Amateur Hunter 18-39 3' U/S
- 432 Adult Amateur Hunter 40 & Over 3' U/S
- 437 Children's Hunter 13 & Under 3' U/S
- 442 Children's Hunter 14-17 3' U/S
- 632 Warm-Up Hunter 2'6"
- 525, 526 Low Children's Hunter 2'6"
- 530, 531 Low Adult Hunter 2'6"
- 811 OHJA Mini Medal 2'6"
- 527 Low Children's Hunter 2'6" U/S
- 532 Low Adult Hunter 2'6" U/S
- 681 Warm-Up Pony Hunter (respective heights)
- 810 Marshall & Sterling U.S. Pony Medal 2'3", 2'6", 2'9"-3' (respective heights)

- 415 Green Pony Hunter (Large) 2'9" Conformation
- 416 Green Pony Hunter (Large) 2'9"
- 410 Pony Hunter (Large) 2'9"-3' Conformation
- 411 Pony Hunter (Large) 2'9"-3'
- 415 Green Pony Hunter (Medium) 2'6" Conformation
- 416 Green Pony Hunter (Medium) 2'6"
- 410 Pony Hunter (Medium) 2'6" Conformation
- 411 Pony Hunter (Medium) 2'6"
- 415 Green Pony Hunter (Small) 2'3" Conformation
- 416 Green Pony Hunter (Small) 2'3"
- 410 Pony Hunter (Small) 2'3" Conformation
- 411 Pony Hunter (Small) 2'3"
- 418 Green Pony Hunter (SML) 2'3", 2'6", 2'9" U/S (respective heights)
- 413 Pony Hunter (SML) 2'3", 2'6", 2'9"-3' U/S (respective heights)

Cascade Hunter Arena

Presented by WA State Hunter Jumper Association

8:00 AM

- 520, 521, 522 Pre-Children's/Adult Hunter 2'9"
- 523 Pre-Children's/Adult Hunter 2'9" U/S
- 500, 501, 502 Short Stirrup Hunter Horse 17 & Under 2'3"
- 510, 511, 512 Long Stirrup Hunter 18 & Over 2'3"
- 503 Short Stirrup Hunter Horse 17 & Under 2'3" U/S
- 513 Long Stirrup Hunter 18 & Over 2'3" U/S
- 445, 446, 447 Children's Hunter Pony 2', 2'3", 2'6" (respective heights)
- 448 Children's Hunter Pony 2', 2'3", 2'6" U/S (respective heights)
- 505, 506, 507 Short Stirrup Hunter Pony 17 & Under 18"
- 508 Short Stirrup Hunter Pony 17 & Under 18" U/S
- 928, 929 Opportunity Cross Pole Equitation O/F
- 923, 924 Opportunity Walk/Trot/Canter Equitation O/F
- 908, 909 Opportunity Walk/Trot Equitation O/F
- 11 **Rosé All Day Amateur Classic**
Presented by American Mechanical

Grand Jumper Arena

Presented by Farpoint Farm in honor of Kona Coast

8:00 AM

- 806 EMO Insurance/USHJA Jumping Seat Medal 3'3"
- 814 USHJA Jumping Seat Medal 3'3"
- 109 Jumper .70m II.1
- 61 **Open Jumper Classic .70m II.2a/b**
Presented by RevUp Energy
- 124 Jumper .80m II.1
- 62 **Open Jumper Classic .80m II.2a/b**
Presented by EquiFUSE
- 143 Jumper .90m II.2b
- 252 Low Adult Amateur Jumper .90m II.1
- 257 Low Children's Jumper .90m II.1
- 163 Jumper 1.00m II.1
- 233 Thoroughbred Jumper 1.00m Stake II.2b
- 262 Low Adult Amateur Jumper 1.00m II.2c
- 267 Low Children's Jumper 1.00m II.2c
- 237 Pony Jumper 1.05m II.1
- 173 Jumper 1.10m II.1
- 272 High Adult Amateur Jumper 1.10m II.2b
- 277 High Children's Jumper 1.10m II.2b
- 178 Jumper 1.15m II.1
- 242 Mod. Junior/Amateur Jumper 1.15m II.2b
- 183 Jumper 1.20m II.1
- 15 **Parents On Parade™ Leadline**
Presented by Laurel Zeeman CPA
- 2 **Whittier Trust Grand Prix II.2a/b**
Presented by Whittier Trust
Estimated start: 6:00 PM

2023 Swiftwater Invitational

Sunday, June 18, 2023

Grand Hunter Arena

Presented by Parkwood Equestrian

9:00 AM

- 3 **USHJA National Hunter Derby**
Presented by Brick Road Farms
- 428 Adult Amateur Hunter 18-39 3'
- 429 Adult Amateur Hunter 18-39 3' Stake
- 433 Adult Amateur Hunter 40 & Over 3'
- 434 Adult Amateur Hunter 40 & Over 3' Stake
- 438 Children's Hunter 13 & Under 3'
- 439 Children's Hunter 13 & Under 3' Stake
- 443 Children's Hunter 14-17 3'
- 444 Children's Hunter 14-17 3' Stake
- 33 **Children's Hunter Classic 3'**
Presented by Voltaire Design
- 70 **Adult Hunter Classic 3'**
Presented by Voltaire Design
- 528, 529 Low Children's Hunter 2'6"
- 533, 534 Low Adult Hunter 2'6"
- 32 **Low Children's/Adult Hunter Classic 2'6"**
Presented by Sterling Essentials
- 10 **Junior/Amateur Hunt & Handy**
Presented by Olson's Tack Shop
- 30 **Pony Hunter Classic 2'3", 2'6", 2'9"-3'** (respective heights)
Presented by Kaidyn Griggs
- 417 Green Pony Hunter (Large) 2'9"
- 412 Pony Hunter (Large) 2'9"-3'
- 417 Green Pony Hunter (Medium) 2'6"
- 412 Pony Hunter (Medium) 2'6"
- 417 Green Pony Hunter (Small) 2'3"
- 412 Pony Hunter (Small) 2'3"
- 419 Green Pony Hunter (SML) 2'3", 2'6", 2'9" Handy (respective heights)
- 414 Pony Hunter (SML) 2'3", 2'6", 2'9"-3' Handy (respective heights)

Cascade Hunter Arena

Presented by WA State Hunter Jumper Association

8:00 AM

- 449 Children's Hunter Pony 2', 2'3", 2'6" Stake (respective heights)
- 34 **Children's Hunter Pony Classic 2'6"**
Presented by Forest Park Saddlery
- 524 Pre-Children's/Adult Hunter 2'9"
- 31 **Pre-Children's/Adult Hunter Classic 2'9"**
Presented by Aven Equestrian
- 504 Short Stirrup Hunter Horse 17 & Under 2'3"
- 514 Long Stirrup Hunter 18 & Over 2'3"
- 35 **Short/Long Stirrup Hunter Classic 2'3"**
Presented by Dianna Connelly Insurance
- 34 **Children's Hunter Pony Classic 2'3"**
Presented by Forest Park Saddlery
- 34 **Children's Hunter Pony Classic 2'**
Presented by Forest Park Saddlery
- 509 Short Stirrup Hunter Pony 17 & Under 18"
- 36 **Short Stirrup Hunter Pony Classic 18"**
Presented by Horsin' Around Cookie Company

Grand Jumper Arena

Presented by Farpoint Farm in honor of Kona Coast

8:00 AM

- 243 Mod. Junior/Amateur Jumper 1.15m Stake II.2b
- 273 High Adult Amateur Jumper 1.10m Stake II.2b
- 278 High Children's Jumper 1.10m Stake II.2b
- 20 **Need for Speed™ Open Jumper 1.10m III**
Presented by Voltaire Design
- 20 **Need for Speed™ Open Jumper 1.20m III**
Presented by Voltaire Design
- 238 Pony Jumper 1.05m Stake II.2b
- 263 Low Adult Amateur Jumper 1.00m Stake II.2b
- 268 Low Children's Jumper 1.00m Stake II.2b
- 253 Low Adult Amateur Jumper .90m Stake II.2b
- 258 Low Children's Jumper .90m Stake II.2b
- 63 **Open Jumper Classic .90m II.2a/b**
Presented by Sundance Equestrian



ALPINE PREVIEW

June 21-25, 2023
USEF #330219

*Sophie Click and Tarantino 54
Horseware Grand Prix, 2022 Alpine Preview*

SCHEDULES: ALPINE PREVIEW

June 21-25, 2023

2023 Alpine Preview

Wednesday, June 21, 2023

Grand Hunter Arena

Presented by Parkwood Equestrian

8:00 AM

670	Warm-Up Hunter 3'6"
325, 326	Green Hunter 3'6"
310, 311	Performance Hunter 3'6"
675	Warm-Up Hunter 3'9"
305, 306	High Performance Hunter 3'9"
320, 321	Green Hunter 3'9"
660	Warm-Up Hunter 3'3"
315, 316	Performance Hunter 3'3"
330, 331	Green Hunter 3'3"
345, 346	Young Hunter 3'3" - Horses 7 & Under
650	Warm-Up Hunter 3'
335, 336	Green Hunter 3'
350, 351	Young Hunter 3' - Horses 6 & Under
450, 451	Small Hunter 3'
515, 516	Large Hunter 3'
480, 481	USHJA 3' Hunter
455, 456	Thoroughbred Hunter 3'
630	Warm-Up Hunter 2'6"
470, 471	USHJA 2'6" Hunter
535, 536	Baby Green Hunter 2'6"

Cascade Hunter Arena

Presented by WA State Hunter Jumper Association

9:00 AM

640	Warm-Up Hunter 2'9"
355, 356	Young Hunter 2'9" - Horses 5 & Under
357	Young Hunter 2'9" - Horses 5 & Under U/S
475, 476	USHJA 2'9" Hunter
477	USHJA 2'9" Hunter U/S
620	Warm-Up Hunter 2'3"
465, 466	USHJA 2'3" Hunter
467	USHJA 2'3" Hunter U/S
610	Warm-Up Hunter 2'
460, 461	USHJA 2' Hunter
462	USHJA 2' Hunter U/S

Grand Jumper Arena

Presented by Farpoint Farm in honor of Kona Coast

8:00 AM

685	Warm-Up Jumper .70m IV.1
105	Jumper .70m II.2b
690	Warm-Up Jumper .80m IV.1
120	Jumper .80m II.2b
695	Warm-Up Jumper .90m II.2c
140	Jumper .90m II.2b
160	Jumper 1.00m II.2c
230	Thoroughbred Jumper 1.00m II.2b
200	PNW 5 Y/O Young Jumper 1.00m II.2b
170	Jumper 1.10m II.2b
205	PNW 6 Y/O Young Jumper 1.10m II.2b
215	YJC 5 Y/O Young Jumper 1.10m II.2b
175	Jumper 1.15m II.2b
210	PNW 7 Y/O Young Jumper 1.15m II.2b
180	Jumper 1.20m II.2c
220	YJC 6 Y/O Young Jumper 1.20m II.2b
245	Junior/Amateur Jumper 1.20m II.2b
185	Jumper 1.30m II.2b
225	YJC 7 Y/O Young Jumper 1.30m II.2b
190	Jumper 1.40m II.2b

2023 Alpine Preview

Thursday, June 22, 2023

Grand Hunter Arena

Presented by Parkwood Equestrian

8:00 AM

- 327 Green Hunter 3'6"
- 328 Green Hunter 3'6" Handy
- 312 Performance Hunter 3'6"
- 313 Performance Hunter 3'6" Handy
- 314 Performance Hunter 3'6" U/S
- 329 Green Hunter 3'6" U/S
- 307 High Performance Hunter 3'9"
- 308 High Performance Hunter 3'9" Handy
- 322 Green Hunter 3'9"
- 323 Green Hunter 3'9" Handy
- 309 High Performance Hunter 3'9" U/S
- 324 Green Hunter 3'9" U/S
- 317 Performance Hunter 3'3" U/S
- 332 Green Hunter 3'3" U/S
- 347 Young Hunter 3'3" - Horses 7 & Under U/S
- 318 Performance Hunter 3'3"
- 319 Performance Hunter 3'3" Handy
- 348, 349 Young Hunter 3'3" - Horses 7 & Under
- 333, 334 Green Hunter 3'3"
- 337 Green Hunter 3' U/S
- 338, 339 Green Hunter 3'
- 352, 353 Young Hunter 3' - Horses 6 & Under
- 482, 483 USHJA 3' Hunter
- 457 Thoroughbred Hunter 3'
- 458 Thoroughbred Hunter 3' Stake
- 452 Small Hunter 3'
- 453 Small Hunter 3' Stake
- 517 Large Hunter 3'
- 518 Large Hunter 3' Stake
- 354 Young Hunter 3' - Horses 6 & Under U/S
- 454 Small Hunter 3' U/S
- 519 Large Hunter 3' U/S
- 484 USHJA 3' Hunter U/S
- 459 Thoroughbred Hunter 3' U/S
- 472, 473 USHJA 2'6" Hunter
- 537, 538 Baby Green Hunter 2'6"
- 39 Cascade Hunter Classic 2'6"**
Presented by Kerrits Equestrian
- 539 Baby Green Hunter 2'6" U/S
- 474 USHJA 2'6" Hunter U/S

Cascade Hunter Arena

Presented by WA State Hunter Jumper Association

8:00 AM

- 358, 359 Young Hunter 2'9" - Horses 5 & Under
- 478, 479 USHJA 2'9" Hunter
- 40 Cascade Hunter Classic 2'9"**
Presented by Kerrits Equestrian
- 468, 469 USHJA 2'3" Hunter
- 38 Cascade Hunter Classic 2'3"**
Presented by Kerrits Equestrian
- 463, 464 USHJA 2' Hunter
- 37 Cascade Hunter Classic 2'**
Presented by Kerrits Equestrian

Grand Jumper Arena

Presented by Farpoint Farm in honor of Kona Coast

8:00 AM

- 106 Jumper .70m IV.2b
- 121 Jumper .80m II.2b
- 141 Jumper .90m II.2b
- 250 Low Adult Amateur Jumper .90m II.2b
- 255 Low Children's Jumper .90m II.2b
- 161 Jumper 1.00m II.2c
- 231 Thoroughbred Jumper 1.00m II.2b
- 201 PNW 5 Y/O Young Jumper 1.00m II.2b
- 260 Low Adult Amateur Jumper 1.00m II.2b
- 265 Low Children's Jumper 1.00m II.2b
- 235 Pony Jumper 1.05m II.2b
- 171 Jumper 1.10m II.2c
- 206 PNW 6 Y/O Young Jumper 1.10m II.2b
- 216 YJC 5 Y/O Young Jumper 1.10m II.2b
- 270 High Adult Amateur Jumper 1.10m II.2b
- 275 High Children's Jumper 1.10m II.2b
- 176 Jumper 1.15m II.2c
- 211 PNW 7 Y/O Young Jumper 1.15m II.2b
- 240 Mod. Junior/Amateur Jumper 1.15m II.2b
- 181 Jumper 1.20m II.2c
- 221 YJC 6 Y/O Young Jumper 1.20m II.2b
- 246 Junior/Amateur Jumper 1.20m II.1
- 226 YJC 7 Y/O Young Jumper 1.30m II.2b
- 191 Jumper 1.40m II.2b
- 186 Cascade Welcome 1.30m II.2a/b**
Presented by Lionheart Training
Estimated start: 5:00 PM

2023 Alpine Preview

Friday, June 23, 2023

Grand Hunter Arena

Presented by Parkwood Equestrian

8:00 AM

- 651 Warm-Up Hunter 3'
- 730, 731 Equitation 14 & Under 3' O/F
- 733, 734 Equitation 15-17 3' O/F
- 732 Equitation 14 & Under 3' Not to jump
- 735 Equitation 15-17 3' Not to jump
- 724, 725 Adult Equitation 18-39 3' O/F
- 727, 728 Adult Equitation 40 & Over 3' O/F
- 801 WSHJA Good Hands & Seat 3'
- 726 Adult Equitation 18-39 3' Not to jump
- 729 Adult Equitation 40 & Over 3' Not to jump
- 661 Warm-Up Hunter 3'3"
- 370, 371 Amateur Owner Hunter 18-35 3'3"
- 375, 376 Amateur Owner Hunter 36 & Over 3'3"
- 405, 406 Junior Hunter 14 & Under 3'3"
- 400, 401 Junior Hunter 15-17 3'3"
- 816 USEF Adult Equitation 3'3"
- 807 USEF/NCEA Junior Hunter Seat Medal 3'3"
- 671 Warm-Up Hunter 3'6"
- 360, 361 Amateur Owner Hunter 18-35 3'6"
- 365, 366 Amateur Owner Hunter 36 & Over 3'6"
- 385, 386 Junior Hunter 14 & Under 3'6"
- 380, 381 Junior Hunter 15-17 3'6"
- 802 WSHJA Good Hands & Seat 3'6"
- 631 Warm-Up Hunter 2'6"
- 715, 716 Low Children's Equitation 2'6" O/F
- 718, 719 Low Adult Equitation 2'6" O/F
- 800 WSHJA Good Hands & Seat 2'6"
- 717 Low Children's Equitation 2'6" Not to jump
- 720 Low Adult Equitation 2'6" Not to jump
- 680 Warm-Up Pony Hunter (respective heights)
- 700, 701 Pony Equitation 2'3", 2'6", 2'9"-3' O/F (respective heights)
- 702 Pony Equitation 2'3", 2'6", 2'9"-3' Not to jump

3 USHJA National Hunter Derby

Presented by Brick Road Farms

Estimated start: 5:30 PM

Cascade Hunter Arena

Presented by WA State Hunter Jumper Association

8:00 AM

- 641 Warm-Up Hunter 2'9"
- 721, 722 Pre-Children's/Adult Equitation 2'9" O/F
- 723 Pre-Children's/Adult Equitation 2'9" Not to jump
- 621 Warm-Up Hunter 2'3"
- 706, 707 Short Stirrup Equitation Horse 2'3" O/F
- 703, 704 Long Stirrup Equitation 2'3" O/F
- 708 Short Stirrup Equitation Horse 2'3" Not to jump
- 705 Long Stirrup Equitation 2'3" Not to jump
- 625 Warm-Up Hunter 2'3", 2'6", 2'9" (respective heights)
- 712, 713 Children's Pony Equitation 2', 2'3", 2'6" O/F (respective heights)
- 714 Children's Pony Equitation 2', 2'3", 2'6" Not to jump
- 600 Warm-Up Hunter 18"
- 709, 710 Short Stirrup Equitation Pony 18" O/F
- 711 Short Stirrup Equitation Pony 18" Not to jump
- 925, 926 Opportunity Cross Pole Equitation O/F
- 927 Opportunity Cross Pole Equitation Not to jump
- 920, 921 Opportunity Walk/Trot/Canter Equitation O/F
- 905, 906 Opportunity Walk/Trot Equitation O/F
- 922 Opportunity Walk/Trot/Canter Equitation Not to jump
- 907 Opportunity Walk/Trot Equitation Not to jump

Grand Jumper Arena

Presented by Farpoint Farm in honor of Kona Coast

8:00 AM

- 172 Jumper 1.10m II.2b
- 207 PNW 6 Y/O Young Jumper 1.10m II.2b
- 217 YJC 5 Y/O Young Jumper 1.10m II.2b
- 271 High Adult Amateur Jumper 1.10m II.2b
- 276 High Children's Jumper 1.10m II.2b
- 177 Jumper 1.15m II.2b
- 212 PNW 7 Y/O Young Jumper 1.15m II.2b
- 241 Mod. Junior/Amateur Jumper 1.15m II.2b
- 182 Jumper 1.20m II.2b
- 222 YJC 6 Y/O Young Jumper 1.20m II.2b
- 247 Junior/Amateur Jumper 1.20m Stake II.2b
- 187 Jumper 1.30m II.1
- 227 YJC 7 Y/O Young Jumper 1.30m II.2b
- 192 Jumper 1.40m II.1
- 107 Jumper .70m IV.1
- 108 Jumper .70m II.2b
- 122 Jumper .80m IV.1
- 123 Jumper .80m II.2b
- 142 Jumper .90m II.1
- 251 Low Adult Amateur Jumper .90m II.2b
- 256 Low Children's Jumper .90m II.2b
- 162 Jumper 1.00m II.2b
- 232 Thoroughbred Jumper 1.00m II.1
- 202 PNW 5 Y/O Young Jumper 1.00m II.2b
- 261 Low Adult Amateur Jumper 1.00m II.1
- 266 Low Children's Jumper 1.00m II.1
- 236 Pony Jumper 1.05m IV.2b

64 Open Jumper Classic 1.00m

Presented by WSHJA

2023 Alpine Preview

Saturday, June 24, 2023

Grand Hunter Arena

Presented by Parkwood Equestrian

After USHJA Jumper Medal Class

- 372 Amateur Owner Hunter 18-35 3'3"
- 373 Amateur Owner Hunter 18-35 3'3" Handy
- 377 Amateur Owner Hunter 36 & Over 3'3"
- 378 Amateur Owner Hunter 36 & Over 3'3" Handy
- 374 Amateur Owner Hunter 18-35 3'3" U/S
- 379 Amateur Owner Hunter 36 & Over 3'3" U/S
- 407 Junior Hunter 14 & Under 3'3"
- 408 Junior Hunter 14 & Under 3'3" Handy
- 402 Junior Hunter 15-17 3'3"
- 403 Junior Hunter 15-17 3'3" Handy
- 805 Hamel Foundation NHS Medal 3'3"
- 815 USHJA 3'3" Hunter Seat Medal
- 409 Junior Hunter 14 & Under 3'3" U/S
- 404 Junior Hunter 15-17 3'3" U/S
- 362 Amateur Owner Hunter 18-35 3'6"
- 363 Amateur Owner Hunter 18-35 3'6" Handy
- 367 Amateur Owner Hunter 36 & Over 3'6"
- 368 Amateur Owner Hunter 36 & Over 3'6" Handy
- 364 Amateur Owner Hunter 18-35 3'6" U/S
- 369 Amateur Owner Hunter 36 & Over 3'6" U/S
- 387 Junior Hunter 14 & Under 3'6"
- 388 Junior Hunter 14 & Under 3'6" Handy
- 382 Junior Hunter 15-17 3'6"
- 383 Junior Hunter 15-17 3'6" Handy
- 803 ASPCA Maclay Horsemanship Medal 3'6"
- 804 Dover Saddlery/USEF Hunter Seat Medal 3'6"
- 389 Junior Hunter 14 & Under 3'6" U/S
- 384 Junior Hunter 15-17 3'6" U/S
- 652 Warm-Up Hunter 3'
- 425, 426 Adult Amateur Hunter 18-39 3'
- 430, 431 Adult Amateur Hunter 40 & Over 3'
- 809 Ariat National Adult Medal 3'
- 813 OHJA Adult Medal 3'
- 435, 436 Children's Hunter 13 & Under 3'
- 440, 441 Children's Hunter 14-17 3'
- 808 Taylor Harris Insurance National Children's Medal 3'
- 812 OHJA Children's Medal 3'
- 427 Adult Amateur Hunter 18-39 3' U/S
- 432 Adult Amateur Hunter 40 & Over 3' U/S
- 437 Children's Hunter 13 & Under 3' U/S
- 442 Children's Hunter 14-17 3' U/S
- 632 Warm-Up Hunter 2'6"
- 525, 526 Low Children's Hunter 2'6"
- 530, 531 Low Adult Hunter 2'6"
- 811 OHJA Mini Medal 2'6"
- 527 Low Children's Hunter 2'6" U/S
- 532 Low Adult Hunter 2'6" U/S
- 681 Warm-Up Pony Hunter (respective heights)
- 810 Marshall & Sterling U.S. Pony Medal 2'3", 2'6", 2'9"-3' (respective heights)

- 415 Green Pony Hunter (Large) 2'9" Conformation
- 416 Green Pony Hunter (Large) 2'9"
- 410 Pony Hunter (Large) 2'9"-3' Conformation
- 411 Pony Hunter (Large) 2'9"-3'
- 415 Green Pony Hunter (Medium) 2'6" Conformation
- 416 Green Pony Hunter (Medium) 2'6"
- 410 Pony Hunter (Medium) 2'6" Conformation
- 411 Pony Hunter (Medium) 2'6"
- 415 Green Pony Hunter (Small) 2'3" Conformation
- 416 Green Pony Hunter (Small) 2'3"
- 410 Pony Hunter (Small) 2'3" Conformation
- 411 Pony Hunter (Small) 2'3"
- 418 Green Pony Hunter (SML) 2'3", 2'6", 2'9" U/S (respective heights)
- 413 Pony Hunter (SML) 2'3", 2'6", 2'9"-3' U/S (respective heights)

Cascade Hunter Arena

Presented by WA State Hunter Jumper Association

8:00 AM

- 520, 521, 522 Pre-Children's/Adult Hunter 2'9"
- 523 Pre-Children's/Adult Hunter 2'9" U/S
- 500, 501, 502 Short Stirrup Hunter Horse 17 & Under 2'3"
- 510, 511, 512 Long Stirrup Hunter 18 & Over 2'3"
- 503 Short Stirrup Hunter Horse 17 & Under 2'3" U/S
- 513 Long Stirrup Hunter 18 & Over 2'3" U/S
- 445, 446, 447 Children's Hunter Pony 2', 2'3", 2'6" (respective heights)
- 448 Children's Hunter Pony 2', 2'3", 2'6" U/S (respective heights)
- 505, 506, 507 Short Stirrup Hunter Pony 17 & Under 18"
- 508 Short Stirrup Hunter Pony 17 & Under 18" U/S
- 928, 929 Opportunity Cross Pole Equitation O/F
- 923, 924 Opportunity Walk/Trot/Canter Equitation O/F
- 908, 909 Opportunity Walk/Trot Equitation O/F

14 No Joke, Hold My Coke Classic

Presented by Burkwood Farm

Grand Jumper Arena

Presented by Farpoint Farm in honor of Kona Coast

8:00 AM

- 806 EMO Insurance/USHJA Jumping Seat Medal 3'3"
- 814 USHJA Jumping Seat Medal 3'3"
- 109 Jumper .70m II.2b
- 61 **Open Jumper Classic .70m II.2a/b**
Presented by RevUp Energy
- 124 Jumper .80m II.2b
- 62 **Open Jumper Classic .80m II.2a/b**
Presented by EquiFUSE
- 143 Jumper .90m II.2b
- 252 Low Adult Amateur Jumper .90m II.1
- 257 Low Children's Jumper .90m II.1
- 163 Jumper 1.00m II.1
- 233 Thoroughbred Jumper 1.00m Stake II.2b
- 262 Low Adult Amateur Jumper 1.00m II.2c
- 267 Low Children's Jumper 1.00m II.2c
- 237 Pony Jumper 1.05m II.1
- 173 Jumper 1.10m II.1
- 272 High Adult Amateur Jumper 1.10m II.2b
- 277 High Children's Jumper 1.10m II.2b
- 178 Jumper 1.15m II.1
- 242 Mod. Junior/Amateur Jumper 1.15m II.2b
- 183 Jumper 1.20m II.1
- 16 **Rising Stars™ Leadline**
Presented by Kerrits Equestrian
Estimated start: 5:30 PM
- 1 **Horseware Grand Prix II.2a/b**
Presented by The Absolute Horse
Estimated start: 6:00 PM

2023 Alpine Preview

Sunday, June 25, 2023

Grand Hunter Arena

Presented by Parkwood Equestrian

9:00 AM

- 428 Adult Amateur Hunter 18-39 3'
- 429 Adult Amateur Hunter 18-39 3' Stake
- 433 Adult Amateur Hunter 40 & Over 3'
- 434 Adult Amateur Hunter 40 & Over 3' Stake
- 438 Children's Hunter 13 & Under 3'
- 439 Children's Hunter 13 & Under 3' Stake
- 443 Children's Hunter 14-17 3'
- 444 Children's Hunter 14-17 3' Stake
- 33 Children's Hunter Classic 3'**
Presented by Voltaire Design
- 70 Adult Hunter Classic 3'**
Presented by Voltaire Design
- 528, 529 Low Children's Hunter 2'6"
- 533, 534 Low Adult Hunter 2'6"
- 32 Low Children's/Adult Hunter Classic 2'6"**
Presented by Sterling Essentials
- 10 Junior/Amateur Hunt & Handy**
Presented by Olson's Tack Shop
- 30 Pony Hunter Classic 2'3", 2'6", 2'9"-3'** (respective heights)
Presented by Kaidyn Griggs
- 417 Green Pony Hunter (Large) 2'9"
- 412 Pony Hunter (Large) 2'9"-3'
- 417 Green Pony Hunter (Medium) 2'6"
- 412 Pony Hunter (Medium) 2'6"
- 417 Green Pony Hunter (Small) 2'3"
- 412 Pony Hunter (Small) 2'3"
- 419 Green Pony Hunter (SML) 2'3", 2'6", 2'9" Handy (respective heights)
- 414 Pony Hunter (SML) 2'3", 2'6", 2'9"-3' Handy (respective heights)

Cascade Hunter Arena

Presented by WA State Hunter Jumper Association

8:00 AM

- 7 Luxury DerbyCross™ 3'3"-3'6"**
Presented by Beluxari Eq
- 449 Children's Hunter Pony 2', 2'3", 2'6" Stake (respective heights)
- 34 Children's Hunter Pony Classic 2'6"
Presented by Forest Park Saddlery
- 524 Pre-Children's/Adult Hunter 2'9"
- 31 Pre-Children's/Adult Hunter Classic 2'9"**
Presented by Auvén Equestrian
- 504 Short Stirrup Hunter Horse 17 & Under 2'3"
- 514 Long Stirrup Hunter 18 & Over 2'3"
- 35 Short/Long Stirrup Hunter Classic 2'3"**
Presented by Dianna Connelly Insurance
- 34 Children's Hunter Pony Classic 2'3"**
Presented by Forest Park Saddlery
- 34 Children's Hunter Pony Classic 2'**
Presented by Forest Park Saddlery
- 509 Short Stirrup Hunter Pony 17 & Under 18"
- 36 Short Stirrup Hunter Pony Classic 18"**
Presented by Horsin' Around Cookie Company

Grand Jumper Arena

Presented by Farpoint Farm in honor of Kona Coast

8:00 AM

- 7 Luxury DerbyCross™ 1.00m-1.05m**
Presented by Beluxari Eq
- 243 Mod. Junior/Amateur Jumper 1.15m Stake II.2b
- 273 High Adult Amateur Jumper 1.10m Stake II.2b
- 278 High Children's Jumper 1.10m Stake II.2b
- 20 Need for Speed™ Open Jumper 1.10m III**
Presented by Voltaire Design
- 20 Need for Speed™ Open Jumper 1.20m III**
Presented by Voltaire Design
- 238 Pony Jumper 1.05m Stake II.2b
- 263 Low Adult Amateur Jumper 1.00m Stake II.2b
- 268 Low Children's Jumper 1.00m Stake II.2b
- 253 Low Adult Amateur Jumper .90m Stake II.2b
- 258 Low Children's Jumper .90m Stake II.2b
- 63 Open Jumper Classic .90m II.2a/b**
Presented by Sundance Equestrian

Rated Entry for 2023 Swiftwater Invitational June 14-18

Closing Date of Entries: May 19, 2023

Owner		Rider One		Trainer	
Horse Owner Name	Rider Name	Trainer Name			
Address	Address	Farm/Business Name			
City	City	Address	City	State/Province	Zip/PC
State/Province	Zip/PC	State/Province	USPF Age	ASPCA #	Zip/PC
Phone	USFEF #	USFEF #	USFEF #	USFEF #	USFEF #
Email	USHJA #	USHJA #	USHJA #	USHJA #	USHJA #
Recipient of Prize Money Awards		Rider Two			
Individual or Corporation Name	Rider Name				
Social Security # or Federal Tax ID #	Address				
Address	City	State/Province	Zip/PC		
City	State/Province	Zip/PC	Date of Birth	USFEF Age	ASPCA #
Phone	Phone	USFEF #	USFEF #	USHJA #	
Email	Email				
Horse		Horse/Pony Description			
Horse Name	Breed	Color	Sex	Height	Is Pony?
USFEF #	USHJA #	Age	Measurement Card #	Green Status	
Horse Arrival Date	Non-Showing?	Size	Jockey Club Registry #		
	Sunday Stay-over?	S M L	Measurement Card #	Green Status	
I Prefer to be Stabled With (if other than Trainer)		Horse to Primarily Compete in (check all that apply):			
		<input type="checkbox"/> Hunter competition <input type="checkbox"/> Jumper competition			
Entry Agreement (Sign all other releases at CascadeHorseShows.com)					
 <h3>US Equestrian Federation Entry Agreement</h3> <p>By entering a Federation-licensed Competition and signing this entry blank as the Owner, Lessee, Trainer, Manager, Agent, Coach, Driver, Rider, Handler, Valet or Longeur and on behalf of myself and my principals, representatives, employees and agents, I agree that I am subject to the Bylaws and Rules of The United States Equestrian Federation, Inc. (the "Federation") and the local rules of named herein (Competition). I agree to be bound by the Bylaws and Rules of the Federation and of the competition. I will accept as final the decision of the Hearing Committee on any question arising under the Rules, and agree to release and hold harmless the Competition, the Federation, their officials, directors, and employees for any action taken under the Rules. I represent that I am eligible to enter and/or participate under the Rules, and every horse I am entering is eligible as entered. I also agree that as a condition of and in consideration of acceptance of entry, the Federation and/or the Competition may use or assign photographs, videos, audios, cable - casts, broadcasts, Internet, film, new media or other likenesses of me and my horse taken during the Competition for the promotion, coverage or benefit of the Competition, sport, or the Federation. Those likenesses shall not be used to advertise a product and they may not be used in such a way as to jeopardize amateur status. I hereby expressly and irrevocably waive and release any rights in connection with such use, including any claim to compensation, invasion of privacy, right of publicity, or to misappropriation. The construction and application of Federation rules are governed by the laws of the State of New York, and any action instituted against the Federation must be filed in New York State. See G19908.4.</p> <p>BY SIGNING BELOW, I AGREE that I have read, understand, and agree to be bound by all applicable Federation Bylaws, rules, and policies including the USFEF Safe Sport Policy and Minor Athlete Abuse Prevention Policies (MAAPP) as published at www.usfef.org, as amended from time to time, as well as all terms and provisions of this Prize List. If I am signing and submitting this Agreement electronically, I acknowledge that my electronic signature shall have the same validity, force and effect as if I affixed my signature by my own hand.</p>					
Owner/Agent		Rider		Trainer	
Signature (Parent/Guardian required if minor)	Rider One Signature (Parent/Guardian required if minor)	US Citizen?	Signature		
Print Name	Rider Two Signature (Parent/Guardian required if minor)	US Citizen?	Emergency/Contact Phone #		
Checks payable to: Cascade Horse Shows Cascade Horse Shows, 1612 207th Ave NE, Sammamish, WA 98074 www.cascadehorsethows.com					
Pre-order on website: Shavings/Hay/Feed, request RV Site, Golf Car Show Secretary: Lauren Wasserman 360.573.4360 office@cascadehorsethows.com					
US Equestrian fee \$23 (drugs/meds \$15, USFEF \$8) USHJA fee \$7 SHOW PASS FEES: USHJA \$30					
Credit Card # - 3.5% convenience fee per transaction will be added for CC use. CC Exp Date CCV # Zip/PC					
Name on Card (please print) Billing Address Signature Authorizing Payment					
\$390 Competition Deposit Required per Show NON REFUNDABLE after close of entries					
EVERYONE MUST SIGN: Mandatory Liability Releases					
Horse / Tack Stall \$340 QTY:					
Stabling: Mon 10am - Sun 7pm included Sun night: \$50 additional <i>1 free bag of shavings included with each stall (Swiftwater only)</i>					
Non-Showing Horse: Stall fees + \$175 per show Haul-in Fee: \$50/horse/day \$150 horse/show Warm-up / Schooling Fee: \$40 Per-stall Manure Disposal / Garbage Fee: \$60 Office Fee: \$50 Hunter / Jumper Nominating Fee: \$75					



RELEASE OF LIABILITY FOR PROPERTY DAMAGE, PERSONAL INJURY OR DEATH

I choose to participate voluntarily in Equine Activities, as that term is defined in the [Revised Code of Washington \(RCW\) 4.24.530\(2\)](#), at the **Washington State Horse Park** ("WSHP"). The WSHP is an equine activity sponsor, as that term is defined in [RCW 4.24.530\(3\)](#). I am fully aware of and acknowledge that Equine Activities involve inherent dangerous risks of accident, loss, and serious bodily injury including broken bones, head injuries, trauma, pain, suffering or death ("Harm").

I agree to release WSHP Authority and the individual WSHP Board members and the WSHP Foundation and the individual WSHP Foundation Board Members, their agents, assigns, employees and contractors and members, the City of Cle Elum and Sun Communities (hereinafter collectively referred to as the "Released Parties") from all claims for money damages or loss for any Harm to me, my injury or death, the injury or death of my child(ren) named below ("Child") or my horse or for any Harm caused by me or my horse to others, even if the Harm, directly or indirectly, resulted from the negligence of the Released Parties.

I agree to expressly assume all risks of Harm to me or my child or my horse.

I agree to indemnify the Released Parties and to hold them harmless from all claims, causes of action and money damages resulting from Harm to me, my Child, or my horse while I am participating in Equine Activities at the WSHP facility.

Under Washington State law, except as provided in RCW 4.24.540(2), an equine activity sponsor or an equine professional shall not be liable for an injury or the death of a participant engaged in an equine activity, and, except as provided in subsection(s) of this section, no participant nor participant's representative may maintain an action against or recover from an equine activity sponsor or an equine professional for an injury to or the death of a participant engaged in an equine activity.

I have read and understand the Rules and Regulations of WSHP that are posted on the WSHP property. I understand these rules and regulations of WSHP will be changed from time to time and I agree to abide by the changed rules. I represent that I and/or my child have the requisite training, coaching and ability to participate safely in the activities we chose to pursue at WSHP.

RELEASE OF PHOTOGRAPHIC AND VIDEO IMAGES

I hereby give permission to WSHP and those acting with its authority the unrestricted right and permission to use, publish and republish any photographic or video images of me and/or my horse for promotional and marketing purposes of the Horse Park. I also permit the use of any printed material in connection therewith and relinquish any right to review or restrict its use or publication.

I read and understand these Releases, and my handwritten or digital signature below signifies my acceptance of their terms and conditions. I agree these Releases shall remain in full force and effect until they are specifically revoked by me in writing or superseded by new releases issued by the Horse Park and signed by me. Electronic delivery of this document shall be legally binding, the same as delivery of an original.

Name of Event: _____ Event Date(s): _____

Participant's Name: _____ DOB if under 18: _____

Participant's Signature: _____ Date: _____

If Event Participant is under 18 years of age, his/her parent must sign on his/her behalf below:

Parent's Name: _____

Parent's Signature: _____ Date: _____

Signer's Home Address: _____

City: _____ State: _____ Zip Code: _____



WAIVER AND RELEASE OF LIABILITY, ASSUMPTION OF RISK AND INDEMNITY AGREEMENT

For and in consideration of United States Equestrian Federation, Inc. dba US Equestrian ("USEF") allowing me, the undersigned, to participate in any capacity (including as a rider, driver, handler, vaulter, longeur, lessee, owner, agent, coach, official, trainer or volunteer) in a USEF sanctioned, licensed or approved event or activity, including but not limited to equestrian clinics, practices, shows, competitions and related or incidental activities and ("USEF Event" or "USEF Events"); I, for myself, and on behalf of my spouse, children, heirs and next of kin, and any legal and personal representatives, executors, administrators, successors,, and assigns, hereby agree to and make the following contractual representations pursuant to this Agreement (the "Agreement"):

A. RULES AND REGULATIONS: I hereby agree that I have read, understand, and agree to be bound by all applicable Federation Bylaws, rules, and policies including the USEF Safe Sport Policy and Minor Athlete Abuse Prevention Policies (MAAPP) as published at www.usef.org, as amended from time to time.

B. ACKNOWLEDGMENT OF RISK: I knowingly, willingly, and voluntarily acknowledge the inherent risks associated with the sport of equestrian and know that horseback riding and related equestrian activities are inherently dangerous, and that participation in any USEF Event involves risks and dangers including, without limitation, the potential for serious bodily injury (including broken bones, head or neck injuries), sickness and disease (including communicable diseases), trauma, pain & suffering, permanent disability, paralysis and death; loss of or damage to personal property (including my mount & equipment) arising out of the unpredictable behavior of horses; exposure to extreme conditions and circumstances; accidents involving other participants, event staff, volunteers or spectators; contact or collision with other participants and horses, natural or manmade objects; adverse weather conditions; facilities issues and premises conditions; failure of protective equipment (including helmets); inadequate safety measures; participants of varying skill levels; situations beyond the immediate control of the USEF Event organizers and competition management; and other undefined, not readily foreseeable and presently unknown risks and dangers ("Risks").

EQUINE ACTIVITY LIABILITY ACT WARNING:

CAUTION: HORSEBACK RIDING AND EQUINE ACTIVITIES CAN BE DANGEROUS. RIDE AT YOUR OWN RISK.

Under the laws of most States, an equine activity sponsor or equine professional is not liable for any injury to, or the death of, a participant in equine activities resulting from the inherent risks of equine activities.

C. ASSUMPTION OF RISK: I understand that the aforementioned Risks may be caused in whole or in part or result directly or indirectly from the negligence of my own actions or inactions, the actions or inactions of others participating in the USEF Events, or the negligent acts or omissions of the Released Parties defined below, and I hereby voluntarily and knowingly assume all such Risks and responsibility for any damages, liabilities, losses, or expenses that I incur as a result of my participation in any USEF Events. I also agree to be responsible for any injury or damage caused by me, my horse, my employees or contractors under my direction and control at any USEF Event.

D. WAIVER AND RELEASE OF LIABILITY, HOLD HARMLESS AND INDEMNITY: In conjunction with my participation in any USEF Event, I hereby release, waive and covenant not to sue, and further agree to indemnify, defend and hold harmless the following parties: USEF, USEF Recognized Affiliate Associations, the United States Olympic & Paralympic Committee (USOPC), USEF clubs, members, Event participants (including athletes/riders, coaches, trainers, judges/officials, and other personnel), the Event owner, licensee, and competition managers; the promoters, sponsors, or advertisers of any USEF Event; any charity or other beneficiary which may benefit from the USEF Event; the owners, managers, or lessors of any facilities or premises where a USEF Event may be held; and all directors, officers, employees, agents, contractors, and volunteers of any of the aforementioned parties (**Individually and Collectively, the "Released Parties" or "Event Organizers"**), with respect to any liability, claim(s), demand(s), cause(s) of action, damage(s), loss, or expense (including court costs and reasonable attorney fees) of any kind or nature ("**Liability**") which may arise out of, result from, or relate in any way to my participation in the USEF Events, including claims for Liability caused in whole or in part by the negligent acts or omissions of the Released Parties.

E. COMPLETE AGREEMENT AND SEVERABILITY CLAUSE: This Agreement represents the complete understanding between the parties regarding these issues and no oral representations, statements or inducements have been made apart from this Agreement. If any provision of this Agreement is held to be unlawful, void, or for any reason unenforceable, then that provision shall be deemed severable from this Agreement and shall not affect the validity and enforceability of any remaining provisions.

I HAVE CAREFULLY READ THIS DOCUMENT IN ITS ENTIRETY, UNDERSTAND ALL OF ITS TERMS AND CONDITIONS, AND KNOW IT CONTAINS AN ASSUMPTION OF RISK, RELEASE AND WAIVER FROM LIABILITY, AS WELL AS A HOLD HARMLESS AND INDEMNIFICATION OBLIGATIONS.

By signing below, I (as the participant or as the Parent/Legal Guardian of the minor identified below) hereby accept and agree to the terms and conditions of this Agreement in connection with my (or the minor's) participation in any USEF Event. If, despite this Agreement, I, or anyone on my behalf or the minor's behalf, makes a claim for Liability against any of the Released Parties, I will indemnify, defend and hold harmless each of the Released Parties from any such Liabilities as the result of such claim.

The parties agree that this agreement may be electronically signed. The parties agree that the electronic signatures appearing on this agreement are the same as handwritten signatures for the purposes of validity, enforceability, and admissibility.

RIDER/DRIVER/HANDLER/VAULTER/LONGEUR OWNER TRAINER OFFICIAL STAFF VOLUNTEER COACH (IF APPLICABLE)

Signature: _____ Date: _____

Print Name: _____

Parent/Guardian Signature: (Required if Rider/Driver/Handler/Vaulter/Longeur is a minor) _____ Date: _____

Print Parent//Guardian Name: _____ Emergency Contact Phone No. _____

6.17.20

UNITED STATES EQUESTRIAN FEDERATION : 4001 WING COMMANDER WAY : LEXINGTON, KY 40511 : 859.258.2472 : FAX 859.231.6662 : USEF.ORG



Credit Card Authorization Form for 2023 Shows

Please complete all fields. This authorization will remain in effect for the duration of the show season or until cancelled by the signer. The signer may cancel this authorization at any time by contacting: office@cascadehorsheshows.com.

Responsible Party:
(named on entry)

Name(s) of horse(s):
(to credit funds to)

Credit Card Information	
Card Type	
<input type="checkbox"/> MasterCard	<input type="checkbox"/> VISA
<input type="checkbox"/> Discover	<input type="checkbox"/> AMEX
Cardholder Name (as shown on card)	
Card Number	
Expiration Date (MM/YY)	CVV Code
Cardholder Billing ZIP Code	

I, _____, authorize Cascade Horse Shows LLC to charge my credit card above for agreed upon charges. I understand that I will be charged a 3.5% credit card service charge and that my information will be saved on file for future transactions on my Cascade Horse Shows LLC account.

Customer Signature

Date

Please send completed authorizations to: office@cascadehorsheshows.com

USHJA Zone 9 Specifications

(MT, WY, ID, OR, WA)



In accordance with GR1111.4: CA, NV, UT, CO, ND, SD, NE, and Canada are contiguous states.

JUDGING FOR ALL HUNTER AND EQUITATION SECTIONS:

- To be judged on performance and soundness, suitability to count.
- Horses and Ponies are not required to jog for soundness.
- In Equitation: to be judged on performance, style, form and suitability of horse and rider to count

ELIGIBILITY FOR ADULT AMATEURS: HUNTER, JUMPER, AND EQUITATION:

- To be ridden by exhibitors who have reached their 18th birthday as of December 1 of the current competition year and who hold a current USEF Amateur certification. Open to horses and ponies.

ELIGIBILITY FOR CHILDREN'S SECTIONS: HUNTER, JUMPER, AND EQUITATION:

- To be ridden by exhibitors who have not reached their 18th birthday as of December 1 of the current competition year.

ADULT AMATEUR HUNTER

Sections offered and requirements: Adult Amateurs – may be split into three (3) sections • **Cross Entry:** Riders: Amateur Owner Hunter riders may compete on a maximum of one (1) Adult Amateur Hunter horse that they own at the same competition. Riders may not show in any classes in which the fences are 3'9" and over at the same competition. • **Horses:** Horses entered in Adult Amateur Hunter sections may not compete in the Amateur Owner Hunter sections at the same competition. • **Horse and Rider Combination:** Horse and rider combinations may not cross enter into the Amateur Owner Hunter sections. • **Fence height:** 3'0" with spreads not to exceed the fence height. • Courses will not be adjusted for ponies. • Combinations will be permitted • **Combining/Dividing Sections:** Refer to HU137 • **Awards:** Zone Horse of the Year Awards will be presented annually to the following sections: Adult Amateur Hunter 18- 39 • Adult Amateur 40- 55 • Adult Amateur 56 & over.

LOW ADULT AMATEUR HUNTER

Eligibility: Open to exhibitors who have reached their 18th birthday as of December 1 of the current competition year. • **Cross Entry:** Riders: Riders may not cross enter into any class or section at the same competition where fences exceed 2'9". • **Fence Height:** 2'6" • **Combining/Dividing Sections:** The Low Adult Amateur Hunter and Low Children's Hunter sections may be combined if there are fewer than three (3) entries in either section. • **Awards:** Zone Horse of the Year Awards will be presented annually to the following section: Low Adult Amateur Hunter

ADULT AMATEUR JUMPER

Sections offered and requirements: Low Adult Amateur Jumper • High Adult Amateur Jumper • **Cross Entry:** Rider: Riders may not show in any classes where the jumps exceed 1.20m. • **Horse/Pony:** No cross entry restrictions. • **Horse and Rider Combination:** Low Adult Amateur horse and rider combinations may not cross enter into the High Adult Amateur Jumper section at the same competition. • High Adult Amateur horse and rider combinations may not cross enter into the Low Adult Amateur Jumper section at the same competition. • **Fence Height:** *Low Adult Amateur Jumper: 1.00m to 1.05m* • High Adult Amateur Jumper: 1.10m to 1.15m • **Combining/Dividing Sections:** Adult Amateur Jumper sections may be divided by or combined with Children's Jumper sections, at competition management's discretion, if so stated in the prize list. • **Awards:** Zone Horse of the Year Awards will be presented annually to the following sections: Low Adult Amateur Jumper • High Adult Amateur Jumper

AGE GROUP EQUITATION: ADULT SECTION

Sections Offered: Adult Equitation 18- 39 • Adult Equitation 40- 55 • Adult Equitation 56 & Over • **Cross Entry:** No cross entry restrictions into another section for horse and rider unless stated in the prize list. • **Fence Height:** 2'9"- 3'6" with spreads not to exceed fence height • Combinations will be permitted • Management must state in the prize list, the height at which sections

are being held. • **Combining/Dividing Sections:** Refer to HU137. • **Awards:** Zone Horse of the Year Awards will be presented annually to the following section: Adult Equitation 18- 39 • Adult Equitation 40- 55 • Adult Equitation 56 & Over

CHILDREN'S HUNTER HORSE

Sections offered and requirements: Children's Hunter Horse 13 & Under • Children's Hunter Horse 14- 17 • **Cross Entry: Rider:** Riders entered in the Children's Hunter section may not compete in the Junior Hunter section at the same competition. • Riders may not show in any classes in which the fences are 3'9" and over at the same competition. • **Horses/Ponies:** Horses entered in the Children's Hunter section may not compete in the Junior Hunter section at the same competition. • **Horse and rider combination:** No cross entry restrictions • **Fence Height:** 3'0" with spreads not to exceed fence height • Combinations will be permitted. • **Combining/Dividing Sections:** Refer to HU141 • **Awards:** Zone Horse of the Year Awards will be presented annually to the following sections: Children's Hunter Horse 13 & Under • Children's Hunter Horse 14- 17.

LOW CHILDREN'S HUNTER HORSE

Eligibility: Open to exhibitors who have not yet reached their 18th birthday as of December 1 of the current competition year. • **Cross Entry: Riders:** Riders may not cross enter at the same competition into any class/ section where fences exceed 2'9" • **Fence Height:** 2'6" • **Combining/Dividing Sections:** The Low Children's Hunter and Low Adult Amateur Hunter sections may be combined if there are fewer than three (3) entries in either section. • **Awards:** Zone Horse of the Year Awards will be presented annually to the following section: Low Children's Hunter Horse.

CHILDREN'S HUNTER PONY

Sections offered and requirements: Small/Medium Children's Pony • Large Children's Pony • **Cross Entry: Rider:** Children's Hunter Pony riders may compete on a maximum of one (1) Children's Hunter horse section at the same competition and in any class not to exceed 3'0" (Exception: Pony Jumpers). Green and Regular Hunter Pony riders may compete on a maximum of two (2) additional pony in the Children's Hunter Pony section at the same competition. • **Horse/Pony:** Ponies may not cross enter into any other rated section at the same competition. • **Horse and Rider Combination:** The same pony and rider may not cross enter into any other rated section at the same competition. • **Fence Height:** Combinations will not be permitted • Classes may run as one or split Small/Medium and Large to run at 2'0", 2'3" and 2'6" respectively. • **Combining/Dividing Sections:** Refer to HU141. • **Awards:** Zone Horse of the Year Awards will be presented annually to the following sections: Children's Hunter Pony-Small/Medium • Children's Hunter Pony-Large • Required distances for the Children's Hunter Pony sections: 2'0" Small Children's Hunter Pony should be (based on 9'9" stride): 4 strides at 48'9"; 5 strides at 58'6"; 6 strides at 68'3"; 7 strides at 78'8"; 8 strides at 87'9". • 2'3" Medium Children's Hunter Pony should be (based on 10'3" stride): 4 strides at 51'3"; 5 strides at 61'6"; 6 strides at 71'9", 8 strides at 92'3". • 2'6" Large Children's Hunter Pony should be (based on an 11" stride): 4 strides at 55'; 5 strides at 66'; 6 strides at 77'; 7 strides at 88'; 8 strides at 99'.

CHILDREN'S JUMPER

Sections offered and Requirements: Low Children's Jumper • High Children's Jumper • **Cross Entry: Rider:** Riders may not show in any classes where the jumps exceed 1.20m, except Junior riders competing in FEI Children's classes and USEF Talent Search Class. • **Horse/Pony** • No cross entry restrictions • **Horse and Rider Combination:** Low Children's horse and rider combinations may not cross enter into the High Children's Jumpers at the same competition. • High Children's horse and rider combinations may not cross enter into the Low Children's Jumpers at the same competition. • **Fence Height: Low Children's Jumper: 1.00m to 1.05m** • High Children's Jumper: 1.10m to 1.15m • **Combining/Dividing Sections:** Children's Jumper sections may be divided or combined with Adult Amateur Jumper sections, at competition management's discretion, if so stated in the prize list. • **Awards:** Zone Horse of the Year Awards will be presented annually to the following sections: Low Children's Jumper • High Children's Jumper.

AGE GROUP EQUITATION: CHILDREN'S/JUNIOR SECTION

Sections Offered: Equitation 11 & Under • Equitation 12-14 • Equitation 15-17 • **Cross Entry:** No cross entry restrictions into another section for horse and rider unless stated in the prize list. • **Fence Height:** Equitation 11 & Under: Minimum 2'6", maximum 3' - management must state height at which class will be offered. • Management may offer multiple height options if stated in the prize list, but each course must be set at the same height throughout. ◦ Combinations not permitted • Equitation 12- 14: Minimum 2'9", maximum 3'3" - management must state height at which class will be offered. • Management may offer multiple height options if stated in the prize list, but each course must be set at the same height throughout. ◦ Combinations

are optional • Equitation 15- 17: Minimum 3'0", maximum 3'6" - management must state height at which class will be offered. • Management may offer multiple height options if stated in the prize list, but each course must be set at the same height throughout. • Combinations are optional • **Combining/Dividing Sections:** Refer to HU141 • **Awards:** Zone Horse of the Year Awards will be presented annually to the following sections: Equitation 11 & Under • Equitation 12-14 • Equitation 15-17.

USHJA COMPETITIVE PROGRAMS

For more information regarding the following programs please click on the links below:

Hunter Incentive: Click [here](#) for full specifications

Hunter Team Challenge: Click [here](#) for full specifications

International Hunter Derby: Click [here](#) for full specifications

National Hunter Derby: Click [here](#) for full specifications

Outreach: Click [here](#) for full specifications

Pony Hunter Derby: Click [here](#) for full specifications

World Championship Hunter Rider: Click [here](#) for full specifications

Zone Horse of the Year Championships: Please check individual [zone pages](#)

Zone Jumper Team Championships: Click [here](#) for full specifications

1.0/1.05m Child/Adult Zone Jumper Championship: Click [here](#) for full specifications

SPECIAL CLASSES

3'3" Jumping Seat Medal: Click [here](#) for full specifications

3'3" Hunter Seat Medal: Click [here](#) for full specifications

Green Hunter Challenge: Click [here](#) for full specifications

Gladstone Cup Equitation Classic: Click [here](#) for full specifications

Full Specs available at: <https://www.ushja.org/zones-affiliates/zone-9/specifications>.



*Sage and Abbie Block in the Rising Stars
Leadline at the 2022 Alpine Preview.
Photo: Gary Voth*

YOU ARE NOT ALONE



US Equestrian wants you to know: if you are a victim or survivor of sexual abuse or suspect abuse of any kind, there are resources and people to help.

REPORT

833-5US-SAFE or uscenterforsafesport.org/report-a-concern

24/7 HELPLINE

866-200-0796 or visit safesporthepline.org

TRAINING & RESOURCES

Free to US Equestrian members at usef.org/safesport.

#youarenotalone



USEF Competition Name: Swiftwater Invitational / Alpine Preview

USEF#: 329246 / 330219

Competition Division(s) and Rating(s):

USEF National Hunter (Channel 1), Jumper Rating 2



MAAPP

MINOR ATHLETE ABUSE PREVENTION

LEARN ABOUT MAAP POLICIES



Safe Sport Training



Local Travel



One-On-One Interactions



Social Media & Electronic Communications



Read about these & more at usef.org/MAAPP

REPORT MAAP POLICY VIOLATIONS



usef.org/safe-sport/reporting

859-225-6915 or Text Anonymously 855-682-8733



CASCADE SPONSORS

Cascade Horse Shows gratefully thanks its proud sponsors

Equestrian Brands & Commercial Sponsors

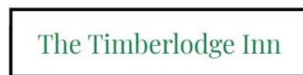

CASCADE SPONSORS

Cascade Horse Shows gratefully thanks its proud sponsors

Premium Show Stables & Individual Patrons

