



# CASCADE HORSE SHOWS

## 2024

JUNE 27-JUNE 30

### **PACIFIC CREST OPEN**

*USEF Regional Hunter (Channel 2), Jumper Rating 2  
USHJA Sanctioned Outreach Event*

SEPTEMBER 5-8

### **CASCADE FINALS**

*USEF Regional Hunter (Channel 2), Jumper Rating 2  
USHJA Sanctioned Outreach Festival Event*

WASHINGTON STATE HORSE PARK, CLE ELUM WASHINGTON

[CASCADEHORSESHOWS.COM](http://CASCADEHORSESHOWS.COM)

*Sophie Smith and Orix Van't Bergske  
Pacesetter Mini Prix, 2023 Pacific Crest Open  
Trainer: Stephanie Barnes*





**Flying over obstacles:  
This is what trust is all about.**

Building a family legacy takes a lifetime. Maintaining it over generations takes our kind of expertise.

Experience tells us that perpetuating wealth is often as much about family dynamics as it is economics. For this reason we focus on your vision and values as tenaciously as we pursue solid returns. Our goal is to empower you, your family, your traditions and culture for generations to come. With Whittier Trust your lasting legacy begins today.

There is a tangible difference that the oldest and largest multi-family office headquartered in the West can mean for your legacy. Experience it. Talk to Lori Houston at (206) 834.1382.



# Whittier Trust

Investment Management & Consulting | Trust Services | Family Office  
Philanthropy & Family Continuity | Real Estate & Energy

---

**SEATTLE OFFICE**

520 PIKE STREET, SUITE 1415, SEATTLE, WA 98101  
(206) 332.0836

**PORTLAND OFFICE**

111 S.W. FIFTH AVENUE, SUITE 3150, PORTLAND, OR 97294  
(503) 444.3428

---

# TABLE OF CONTENTS

How to Enter	6
Horse Show Approvals	6
Directions to the Washington State Horse Park	6
US Equestrian Sections and Ratings	8
Horse Show Officials	10
Horse Show Fees	11
Facilities & Grounds	14
Important Policies of the Show	16
Rules & Regulations	20
Cascade Circuit Cup Awards	27
Spotlight Classes	29
Hunter Division	31
Equitation Division	38
Jumper Division	42
Championships Offered	46
Specifications	49
USHJA National Hunter Derby Quick Specs	52
Schedules: Pacific Crest Open	55
Schedules: Cascade Finals	60
Entry Forms	64
USHJA Zone 9 Specifications (MT, WY, ID, OR, WA)	71
USEF Safe Sport / MAAP	74

# CASCADE SPONSORS

Cascade Horse Shows gratefully thanks its proud sponsors

## Equestrian Brands & Commercial Sponsors

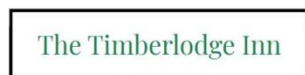



# CASCADE SPONSORS

Cascade Horse Shows gratefully thanks its proud sponsors

*Premium Show Stables & Individual Patrons*

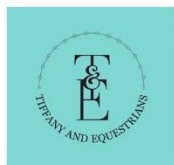

# HOW TO ENTER

[Stall reservations](#) are required for entry into the horse show (see page 16).

All entries must be submitted online.

After reserving stalls, you may enter online at [Horseshowing.com](http://Horseshowing.com) or [EquestrianConnect.com](http://EquestrianConnect.com) or [on our website](#).



Entries received after the close of entries are considered post entries and will incur a \$50 late entry fee.

## HORSE SHOW APPROVALS

**United States Equestrian Federation (USEF)** *Lexington, KY*

**United States Hunter Jumper Association (USHJA)** *Lexington, KY*

**Washington State Hunter Jumper Association (WSHJA)** *Sammamish, WA*

**Oregon Hunter Jumper Association (OHJA)** *Wilsonville, OR*

## DIRECTIONS TO THE WASHINGTON STATE HORSE PARK

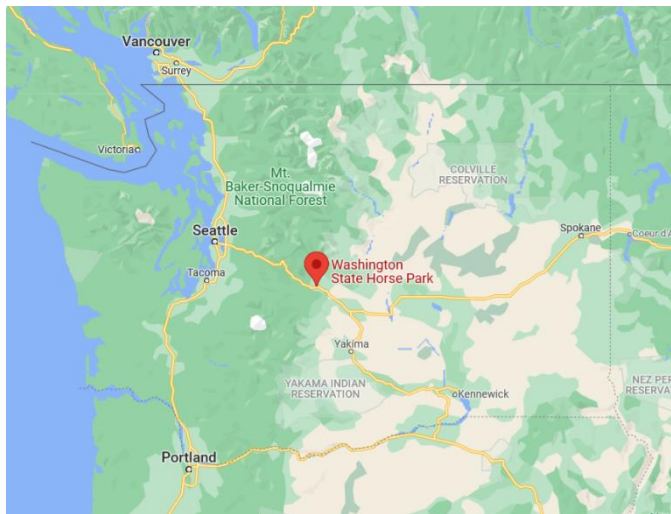

Map courtesy Google.

### Washington State Horse Park

1202 Douglas Munro Blvd.  
Cle Elum, WA 98922

*The Horse Park is conveniently located off Interstate 90 in Cle Elum, Washington, approximately 80 miles from Seattle.*

#### From I90 Westbound:

Take exit 84 from I-90 W toward Cle Elum  
Right onto Oakes Ave 0.5 mi  
Left onto W 2nd St 0.6 mi  
Left onto Forest Service Rd 4517/Douglas Munro Blvd  
Right onto Douglas Munro Blvd

#### From I90 Eastbound:

Take exit 84 from I-90 E toward Cle Elum/S Cle Elum  
Continue onto W 1st St 361 ft  
Turn left onto Douglas Munro Blvd 0.9 mi  
Continue on Douglas Munro Blvd





HORSEWARE®  
IRELAND

# Horse Therapy From Horseware

## SPORTZ-VIBE MASSAGE THERAPY RUG



- Reduces pain and inflammation
- Improves blood supply to tissue
- Relaxes muscles
- Improves quality of life

[www.sportzvibe.com](http://www.sportzvibe.com)



Massage Areas

## ICE-VIBE CIRCULATION THERAPY



- Reduces soreness and swelling
- Helps boost circulation
- Stimulates healing
- Strengthens muscle tissue

[www.icevibe.com](http://www.icevibe.com)

*"We use the ICE-VIBE boots daily as part of our treatment plan on our grand prix horses."*

*-Richie Maloney International Show Jumper*

# US EQUESTRIAN SECTIONS AND RATINGS

## PACIFIC CREST OPEN | USEF #332619 | JUMPER 2

*USEF Rated Regional I:* Performance Hunter 3'3" & 3'6", Green Hunter 3', 3'3", 3'6", Young Hunter 2'9", 3', 3'3", Amateur Owner Hunter 3'3" & 3'6", Junior Hunter 3'3" & 3'6", Pony Hunters

*USEF Rated Regional II:* Adult Amateur Hunter, Children's Hunter, Children's Hunter Pony, Thoroughbred Hunter, USHJA Hunter 2', 2'3", 2'6", 2'9", 3'



## CASCADE FINALS | USEF #334509 | JUMPER 2

*USEF Rated Regional I:* Performance Hunter 3'3" & 3'6", Green Hunter 3', 3'3", 3'6", 3'9", Amateur Owner Hunter 3'3" & 3'6", Junior Hunter 3'3" & 3'6"

*USEF Rated Regional II:* Adult Amateur Hunter, Children's Hunter, Children's Hunter Pony, Thoroughbred Hunter, USHJA Hunter 2', 2'3", 2'6", 2'9", 3'



We are proud to offer the Cascade Finals as a USHJA Outreach Festival event for 2024. For more information, see: [Series and Festivals : USHJA](#)



*Olivia Kibby spends an appreciative moment with Coronado, owned and ridden by Jennifer Wagner-Worley, after his rounds at the Luxury DerbyCross presented by Beluxari EQ at the 2023 Cascade Finals. Coronado, who is wearing the cooler from his and Jennifer's PCO DerbyCross victory, placed third in the Cascade Finals with Jennifer on board.*



VOLTAIRE  
DESIGN



blue *Infinite*

BORN TO PERFORM

# HORSE SHOW OFFICIALS

*Show Manager*

**JENNIFER HANSEN**

*Show Secretary*

**LAUREN WASSERMAN**

*Marketing, Sponsorships & Community Relations*

**JESSICA VANIA**

*Grounds Manager*

**ADAM CHAMBERLIN**

*Website, Technology & Communications*

**GARY VOTH**

*Official Photographer*

**VIOLA MITCHELL**

*Horse Show Advisors*

**ABBIE BLOCK**

**DENISE YUELL**

## PACIFIC CREST OPEN

June 27-June 30, 2024

*Judges, Hunter & Equitation*

**STEPHANIE SIEGEL**, East Port Orchard, WA

**TBD**, TBD

*Judge, Jumper*

**MAX VON ZIMMERMAN**, Selah, WA

*Course Designers*

**CRISTINA LARANGEIRO, FEI LEVEL 3**, Porto, Portugal

**LIZ HAMBLETON**, Chelan, WA

*Steward*

**BRIDGET IMPARATO**, Beverly Hills, FL

*Veterinarian*

**WASHINGTON STATE UNIVERSITY**, TBD

*Farrier*

**BRANDON HARMON**, (206) 697-1135

## CASCADE FINALS

September 5-8, 2024

*Judges, Hunter & Equitation*

**INGRID SCHOENLEIN**, Lafayette, IN

**ROBERT VAN JACOBS**, Seattle, Washington

*Judge, Jumper*

**STEPHANIE SIEGEL**, East Port Orchard, WA

*Course Designers*

**TBD**, TBD

**LIZ HAMBLETON**, Chelan, WA

*Steward*

**ERIC NOEL**, Portland, OR

*Veterinarian*

**WASHINGTON STATE UNIVERSITY**, TBD

*Farrier*

**TRISTEN EVANS**, (360) 932-5196





# HORSE SHOW FEES

**USEF Fee:** \$8\*

**USEF Equine Drug & Medication Fee:** \$15\*

**USEF Competing Membership Fee:** \$80\*

**USHJA Fee:** \$2\*

**USHJA Show Pass Fee:** \$30\*

**Stall Fee:** \$295

**Non-Showing Horse Fee:** \$150/show

**Haul-In Fee:** \$50/horse/day or \$150/horse/show

**RV Space:** \$385 (Full hookup), \$275 (Partial hookup),  
\$125/week or \$25/night (no hookup/dry camp)

**Tent / Dry Camp Space:** \$150/week or \$25/night

**Warm-Up / Schooling Fee:** \$35

**Office Fee:** \$50

**Sunday Stay-Over (prior to departure):** \$50/stall, \$50/RV site

**Per Stall Manure Disposal / Garbage Fee:** \$50

**Hunter / Jumper Nomination Fee:** \$60

*\*Applies to rated competition only*

## CLOSING DATES FOR ENTRIES

Entries received after the closing dates will be charged a \$50 late entry fee.

*Pacific Crest Open:* **MAY 31, 2024**

*Cascade Finals:* **AUGUST 9, 2024**

## HORSE SHOW SERVICES

*Show Office Hours*

**DAY PRECEDING SHOW:** 10am – 5pm

**DAYS OF SHOW:** 7am<sup>1</sup> – 5pm<sup>2</sup>

<sup>1</sup> or 30 minutes prior to start of the first class

<sup>2</sup> or 30 minutes after the last regularly scheduled class ends

*Concessions Provided By*

**ONSITE VENDORS**

*Golf carts*

**AVAILABLE FOR RENT FROM CHS**

A limited number of golf carts are available for rent on a weekly basis during the show from Cascade Horse Shows. Requests can be made from our web site using [our online form](#). Availability is first come, first served until the limited supply is gone.

## ONSITE RV POLICY

RV sites are available for request on a first come, first served basis, with consideration given for sponsors, multi-week stays and size of RV. Please use our online form at [cascadehorsheshows.com](http://cascadehorsheshows.com) to make requests. Choices are not guaranteed, and no requests are final until you receive emailed confirmation from the Show Office and render payment, if required. For cancellations, please see [Cancellations & Refunds](#), page 16.

# Shannon Hendrickson Memorial Grants

Presented by **Eve Willet Consulting**



*“The world changes from year to year, our lives from day to day, but the love and memory of those who have positively impacted us shall never pass away...”*

The late **Shannon Hendrickson** of Signature West Farms made a strong impact on our enjoyment of horses, set a high standard of horse care, and tirelessly fostered youth participation in Northwest horse sports that will be felt for generations to come.

To honor her memory and further that commitment to young riders, Cascade Horse Shows, in partnership with Sea Mountain Agency / CHUBB Insurance, will offer four grants to riders 18 and younger throughout the show season. Each grant awards \$500 to be applied towards entries at a future Cascade Horse Shows' event.\*

To qualify, young riders must submit essays about someone who has made a lasting difference in their enjoyment of horses and the quality of their horsemanship. One grant recipient will be honored and their winning essay read at each of our four Cascade shows. For essay requirements and submissions details, see: <https://www.cascadehorseshow.com/memorial-grants>

## 2024 Grant Application Deadlines

June 11<sup>th</sup> | Swiftwater Invitational

June 18<sup>th</sup> | Alpine Preview

June 26<sup>th</sup> | Pacific Crest Open

September 4<sup>th</sup> | Cascade Finals

2023 Grant recipients, clockwise from left:

**Elizabeth Wagner** (Swiftwater Invitational)

**Lauren Hoyt** (Alpine Preview)

**Ryann Mitchell** (Pacific Crest Open)

**Quinn Henderson** (Cascade Finals)



Photos courtesy of:  
Viola Mitchell Photography  
Gary Voth Photography

\*Event to be held during current or upcoming show season





# Selling homes for horses and their people



**Heidi Davalos**

[heidid@pacesetterproptiesteam.com](mailto:heidid@pacesetterproptiesteam.com)

425.870.3334

**Raquel Davalos**

[raquel@pacesetterproptiesteam.com](mailto:raquel@pacesetterproptiesteam.com)

425.760.8600

**Reilly Ochs**

[reilly@pacesetterproptiesteam.com](mailto:reilly@pacesetterproptiesteam.com)

206.914.5254

# FACILITIES & GROUNDS

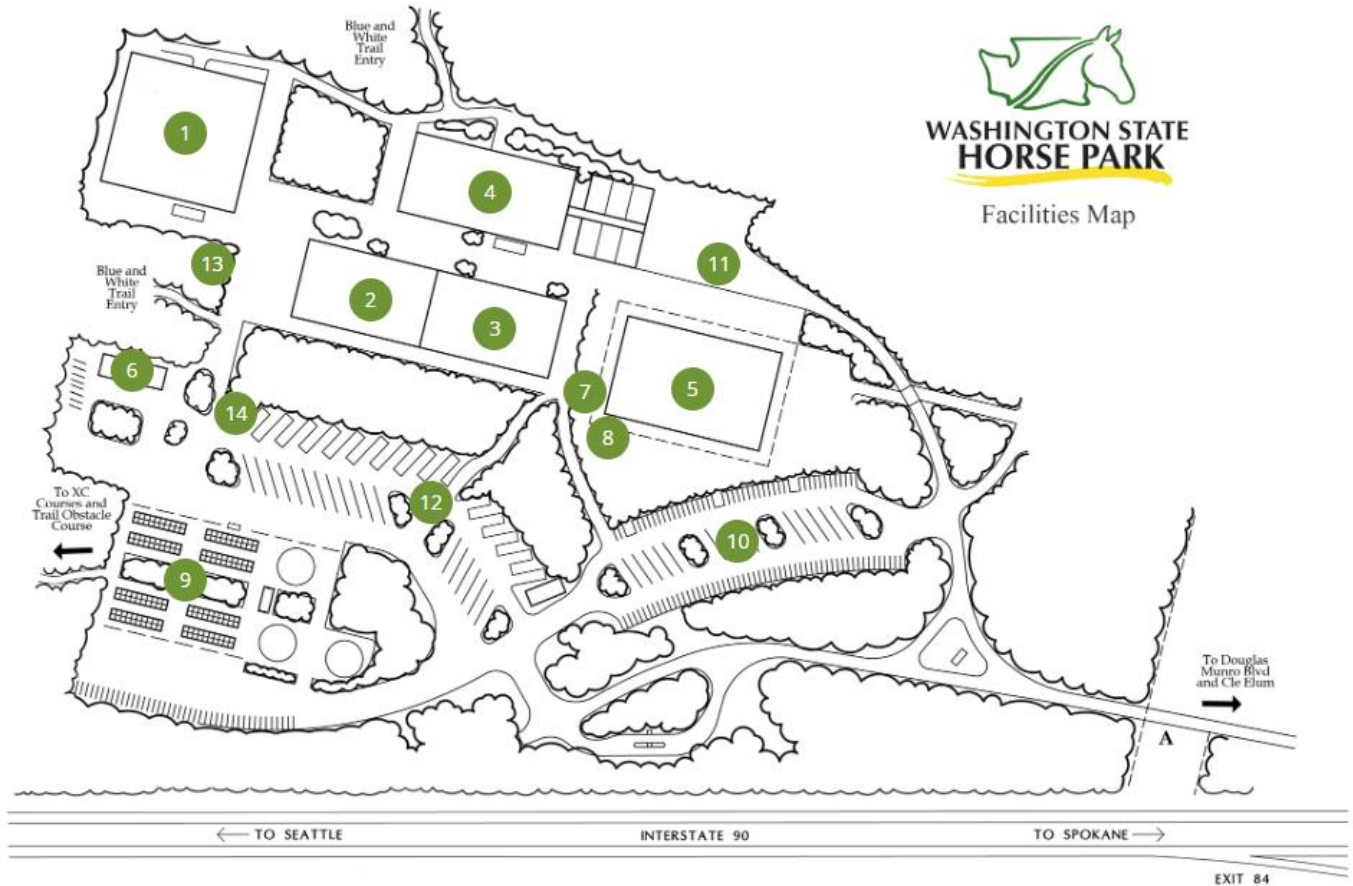

- 1 Grand Jumper Arena (250' x 250')
- 2 Hunter Warm-up Arena (140' x 230')
- 3 WSHJA Hunter Arena (130' x 230')
- 4 Warm-up Arena (150' x 300')
- 5 Grand Hunter Arena (covered, 150' x 300') with ample spectator seating
- 6 Show Office
- 7 Hospitality Area
- 8 Vendor Row
- 9 10 11 Stabling West, East and Northeast
- 12 RV sites: 14 premium full hookup (water, electric, sewer) sites nestled in the trees. 14 standard hookup (water & electric) situated around the tree islands. 24 basic no-hookup spaces
- 13 Windbreaker Lounge: Hospitality tent with lounge seating, plus covered and open picnic areas
- 14 Prize Store

Additional Amenities:

- Shower facility with 3 private shower rooms
- Miles of adjacent horse trails with easy access from stabling areas
- Ample trailer parking



# *Hard to Fit Horse?*

*Custom sizing no  
additional charge*



Bridle2Fit, Otto Schumacher,  
and Edgewood.

Contact the experts at Olson's to help.



# IMPORTANT POLICIES OF THE SHOW

## STALL RESERVATIONS

Trainers or their authorized agents, or individual exhibitors not affiliated with a trainer, must use our online [Stall Reservation form](#) to reserve stalls in advance of our shows. Entries cannot be accepted without stall reservations. We will confirm your reservation within 7 business days of receiving your form. In the case that stalls sell out prior to the close of entries, we will add your reservations to our waitlist.

You can change your counts by notifying us via email at [office@cascadehorseshows.com](mailto:office@cascadehorseshows.com) or text at 360.573.4360, *however*, your counts will be locked-in after the show scratch / cancellation deadline (see below).

**Confirming your counts:** When the scratch deadline is approaching, we will contact you at least 72 hours in advance to confirm your final stall count. Stalls you confirm past the scratch deadline will be *final* regardless of whether you have submitted entries, so please only reserve stalls you are confident you will use. If we do not hear back from you at this stage, your stalls will be released to others on the waitlist.

**Changes past this deadline:** If your needs change past this deadline, you can work with other trainers to take your confirmed stalls—provided you notify us via email. All parties—i.e., you and the other trainer(s)—must be included on this communication to us. You must give us notice of any stall exchanges at least 10 days prior to the start of the show to have this reflected on the stabling chart. In the unlikely case of a misunderstanding between trainers as to who is paying for exchanged stalls, we must hold the trainer who made the original reservation responsible for the stalls.

If something does change, please reach out to us as soon as possible. While the above is our formal policy, with enough notice we will always try to work with you while maintaining a fair approach for all competitors.

## CANCELLATIONS & REFUNDS

If circumstances change and you will no longer be able to attend the show, please communicate any desired changes promptly. This helps us accommodate as many competitors as possible.

**Show Scratches and Cancellations:** The deadline for show cancellations and scratches without penalty will be the *earliest* of these two dates:

- The published close of entry date for the show
- A date we publicly announce that is approximately 6 weeks prior to the show (in the event the show sells out early)

Up until this deadline, you may make changes to or cancel your entries or their associated stall reservations and RV site requests without penalty. Any deposits paid with entries made prior to the scratch deadline will be fully refunded.

After this deadline, you are fully responsible for any stall fees due for your reserved stalls (see above) in addition to office fees due, if any. Refunds for RV sites with hookups are offered prior to the entry close date provided we can resell the space. RV sites are non-refundable past close of entries.

**Changes Past the Close of Entries:** A \$50 office fee per horse will apply to all entries, scratches and substitutions made after the close of entries. Please note that after a horse has been checked in, there are no refunds of stalls, nomination fees, feed and hay, bedding, RV reservations, schooling fees, office fees, non-showing horse fees, manure and garbage disposal fees or any completed classes.

**Refunds:** Any refunds due will be credited to your card or mailed to you within 3 weeks following the show.

**How to Request Changes:** Please communicate your requests to the Show Office promptly at [office@cascadehorseshows.com](mailto:office@cascadehorseshows.com).



# 4-, 5- & 6-Year-Old Young Horses & Off-the-Track Thoroughbreds Show FREE!

Presented by **IOS Ranch**

Cascade Horse Shows, together with IOS Ranch, is pleased to provide young horses and OTTB Thoroughbreds with a positive showing experience with a chance to develop success at their own pace.

Qualifying horses may enter any one open Hunter or one open Jumper section at a Cascade event with no entry fees and no nomination fees!\*

*\* Spotlight Classes, Classics, and otherwise restricted sections excluded. Other limitations and fees apply. Applications must be received prior to close of entries. See the Rules & Regulations for full details.*

*Chrissy Black and 4-year-old Georgia on My Mind show great form in the .75m Jumpers in the 2022 Swiftwater Invitational. Trainer: Kim Pratt. Photo courtesy Viola Mitchell Photography.*



**Illness or Injury During the Competition:** After the competition starts, if you are unable to compete due to an illness or injury, your remaining class fees will be refunded upon presentation of a doctor's certificate. Stall and other fees will not be refunded. A \$50 office charge will apply.

## ADDITIONAL POLICIES

### **Adds & Scratches Due By 4:00 pm Daily**

All changes for the next day, including adds and scratches, must be made by 4:00 pm each day in the office or on [horseshowing.com](http://horseshowing.com). This allows the next day's schedule to be created with class counts and times and made available to everyone in a timely manner.

### **Day-of Adds**

If wanting to add a class on the same day, approval will be based on schedule availability and management discretion. We cannot guarantee acceptance, and you may be put on the ring wait list. If accepted, day-of adds will be assessed a \$10 per class fee. Enter your classes by 4:00 pm the day prior to avoid the \$10 add fee. See our [full policy](#) on page 22.

### **Canceling And Combining of Classes**

Classes with fewer entries than the minimums may be either canceled or combined with other classes, at management's discretion.

### **Posted Ring Schedule**

The most accurate estimation of the daily ring schedules will be completed after adds and scratches have been entered. We strive to post this schedule by 7:00 pm the day prior. The schedule can be found at our [Competitor Resources page](#).

## US EQUESTRIAN MEMBERSHIP STATEMENT

Life, senior active and junior active members shall be eligible to participate in all classes at Regular Competitions, Eventing Competitions at the Modified Level or above and Combined Driving Competitions at the Advanced Level, Dressage, Reining and Vaulting Competitions and Endurance Rides. A non-member may participate as a handler, rider, driver, owner, lessee, or agent at Regular Competitions, Eventing Competitions, Dressage Competitions, Reining Competitions and Combined Driving Competitions upon payment of a Show Pass fee. Participants in the following classes are exempted from the Requirements of this rule: 1) leadline; 2) exhibitions; 3) games and races; 4) classes for 4-H members; 5) walk trot and academy classes (academy classes are classes limited to horses used regularly in a lesson program); 6) USDF introductory level tests, pas de deux and quadrille classes; 7) assistant handlers in Dressage Sport Horse Breeding classes.



## SPOTLIGHT CLASSES

# Cascade Mini Prix

Saturday, June 29, 2024

**\$2,000 Pacesetter Mini Prix**

*Presented by Pacesetter Properties Team*

Saturday, Sep. 7, 2024

**\$2,000 Cascade Mini Prix**

*Presented by TNT Farrier Services*

*To be run as Table II, Sec 2(a/b) — Time first with a jump off; ties to jump off for first place*

*Prize money: 1<sup>st</sup> 30%, 2<sup>nd</sup> 20%, 3<sup>rd</sup> 14%, 4<sup>th</sup> 10%, 5<sup>th</sup> 8%, 6<sup>th</sup> 7%, 7<sup>th</sup> 6%, 8<sup>th</sup> 5%*



*Tami Masters and Varuni Z show fine form in the Pacesetter Mini Prix at the 2023 Pacific Crest Open.*

# RULES & REGULATIONS

Cascade Horse Shows competitions are conducted under current U.S. Equestrian and USHJA rules and are U.S. Equestrian, USHJA, USHJA Zone 9, WSHJA, and OHJA approved.

## ENTRIES

Enter online only via [HorseShowing.com](http://HorseShowing.com), [EquestrianConnect.com](http://EquestrianConnect.com), or [on our website](#). All sites are credit or debit card payment only.

Each show has a published close of entries date. You may enter the shows at any time assuming space availability.

All entries require a Competition Deposit equivalent to the cost of a stall plus a \$50 fee. This deposit will be fully credited to your final show bill upon checkout if entries are received prior to the close of entries date. If your entries are received after the close of entries date, the \$50 per entry fee is forfeited.

## SCRATCH DEADLINE

The deadline for refunds in the event of show cancellations or scratches will be the *earliest* of these two dates:

- The published close of entry date for the show
- A date that we publicly announce that is approximately 6 weeks prior to the show if the show sells out early

Refunds for show entries or reserved stalls are not possible for any reason after this deadline. Please contact the Show Office to request refunds.

## STALL RESERVATIONS

Trainers or their authorized agents, or individual exhibitors not affiliated with a trainer, may use our online [Stall Reservation form](#) to reserve stalls in advance of our shows. Please see our full [Stall Reservation policy](#) on page 15.

## PAYMENT

Pay by check, cash, money order, VISA, MasterCard, Discover, American Express credit or debit card. A valid form of payment must be presented upon check-in at the show. All credit and debit card payments subject to a 3.5% convenience fee.

Canadian Exhibitor entries must be paid by draft payable in US funds or check on Canadian US dollar account or credit card. Canadian checks with US FUNDS written on the face of the check cannot be accepted.

All checks returned by the bank incur a fee of \$50. To retain entries, the fees and penalty must be paid by before 4pm the day before the Show starts. In the event a check is returned after the completion of the show, it will be handled in accordance with US EQUESTRIAN GR913.

Competitors who do not come into the office to close out at the end of the show forfeit the right to adjustments on any show charges. Final balances will be automatically charged to the payment method on file.

## TRAINER SPLITS

Trainers having accounts with Cascade Horse Shows may choose to add their show fees and charges to their "trainer splits" to have these charges distributed amongst their clients. Trainers have until 5:00pm Friday of the show to inform the Show Office which charges will be distributed to which clients. It is fully and solely the trainer's responsibility to indicate which items are applicable to the split and to which clients they should be applied. *Exhibitors:* By submitting an entry form, you acknowledge that you fully accept responsibility for the costs assigned to you by your trainer for the show that you are entering.

## SUBSTITUTIONS

A new horse may be substituted for a scratched horse. There will be a \$50 office charge for substitutions made after the close of entries.

## SHOW SCRATCH and REFUNDS

Refer to [Cancellations & Refunds](#) on page 16.

## EVERY CLASS OFFERED HEREIN WHICH IS COVERED BY THE RULES AND SPECIFICATIONS OF THE CURRENT USEF RULE BOOK WILL BE CONDUCTED AND JUDGED IN ACCORDANCE THEREWITH

## REQUIRED CREDENTIALS

Exhibitors entering rated competition must present copies of the following current credentials to the horse show: US EQUESTRIAN/USHJA/EC membership card; US EQUESTRIAN/USHJA Amateur certification; US EQUESTRIAN/USHJA Large, Small, Junior Hunter and Pony measurement card; USHJA/EC horse recording card or ID number. If measurement cards are not available, measurement will be required. Check in the Show Office for measurement times and dates.

## USHJA HORSE REGISTRATIONS

All horses competing in licensed competitions with Hunter, Hunter Breeding, Jumper and/or Hunt Seat Equitation classes (except those activities enumerated in GR901.9, items 1-9) must obtain a Registration Number from USHJA. Not required for Opportunity and Outreach classes.

## HORSE MICROCHIP

Note: An ISO 11784/11785 compliant chip is required for entry into ALL USHJA rated hunter/jumper competitions starting with the 2019 season.

## STATEMENT OF HORSE HEALTH / VACCINATIONS

Per GR845 Equine Vaccination Rule: At Federation licensed competitions, horses entering the grounds must be accompanied by documentation of Equine Influenza Virus and Equine Herpes Virus (Rhinopneumonitis) vaccinations within six months prior to entering the stables. Horses not in compliance with this rule may be required to leave the competition grounds upon request by Competition Management. Competitors may be asked to provide proof of vaccination upon check-in or prior to entering the property.

## SAFE SPORT

All USEF Life and Senior Active members, as well as participants who have regular contact with minor athletes, are required to comply with the U.S. Center for SafeSport training requirement to be eligible to participate in the competition. All participants must adhere to the U.S. Center for SafeSport Code, USEF Safe Sport Policy, and the Minor Athlete Abuse Prevention Policies. More information about this can be found at [www.usef.org](http://www.usef.org).

## COMPETITION OFFICE HOURS

Day preceding show: 10:00am-5:00pm. Days of show: 7am-5pm or 30 minutes after the last regular class completes whichever is later. Special classes are excluded. Regardless of closing time all next day class adds are due by 4:00pm.



★ INTRODUCING THE ★  
*Golden Backstage Pass*

Earn an exclusive invite to the  
**USHJA National Championships!**



TORI BILAS/USHJA



TRICIA BOOKER/USHJA

Awarded to the highest pointed Gold Level Outreach competitor from each Zone, the Golden Backstage Pass earns the winner premier access to events at the USHJA's annual national competition in Las Vegas, including:

- ★ The opportunity to compete in the USHJA Affiliate Championships held during the USHJA National Championships
- ★ The chance to participate in the National Championship Grand Prix and Hunter Derby course walks, as well as attend educational sessions such as Judge with the Judge and Sports Psychology for Equestrians
- ★ The honor of presenting awards with USHJA President Mary Knowlton and Executive Director Kevin Price



*Learn more about Outreach and earning  
the Golden Backstage Pass at [ushja.org/outreach](http://ushja.org/outreach).*

## ARRIVALS AND DEPARTURES

*Arrivals:* Plan to arrive and move in as early as 2 days prior to the start of the competition. For example, a Tuesday warm-up day with a Wednesday competition start means you move in on Monday starting at 10am. You may arrive later if you like. For approval to arrive earlier than the 2 days before competition start, contact the Show Office at [office@cascadehorseshow.com](mailto:office@cascadehorseshow.com). Early arrivals incur a per-night fee per-stall and per-RV as applies.

*Departures:* Plan to depart Stabling and RV locations by 7pm Sunday or pre-pay with the Show Office to stay over Sunday night. The fee is \$50 per horse stall, and you must vacate by 8am on Monday morning. On Sunday night there will be a 10pm stabling 'lights out'. Sunday night RV stays incur a 'per night' RV fee.

## 4-, 5- & 6-YEAR-OLDS and OFF-THE-TRACK THOROUGHBREDS (OTTB) SHOW FREE

Free entry limited to ONE open Hunter or open Jumper section, excluding Spotlight classes and Classics. Each rider (professional, junior, or amateur) is limited to one horse at each Cascade show. Horses that utilize this program are allowed one use per Cascade Horse Show season. Participation in the program is limited to 2 consecutive years. Management reserves the right to cap participation. Horses entered after the entry close date are not eligible.

All participants wishing to utilize this program must email [office@cascadehorseshow.com](mailto:office@cascadehorseshow.com) prior to close date of entries, include horse and rider's name, and trainer's name. Must provide proof of age at time of check-in. Thoroughbreds must have Jockey Club papers and/or proof of breeding including tattoos. All other fees, including stalls, nomination, office, federation, etc. apply. Substitutions are allowed and will follow the regular substitution policy.

## STABLING

Stalls with doors are provided; dimensions are 10'x10'. 160 have mats; the remaining have dirt/gravel floors. Requests for specific stalls or stall locations will be considered on an individual basis. Preference given to horses showing both weeks and to sponsors. Bales of shavings will be available by pre-order on entry form and/or during the show by request at the Competition Office. Straw is not permitted.

In cases of high demand, management reserves the right to cap how many non-horse stalls are sold, and a ratio of horse stalls to non-horse stalls may be put into effect.

Stalls must be cleaned daily. Dirty bedding must be placed in areas provided. Exhibitors are responsible for cleaning their own stalls and must provide their own feed and buckets. A \$50 manure disposal and garbage fee will be assessed for all stalls. No staples, nails, cutting stalls or removal of top doors permitted. Stabling damage fees will be assessed by the WSHP as follows: Panels – \$100 portable stall, \$200 permanent stall; Stall metal framework - \$200; light cords \$150; Roof Tarps – actual repair/replacement costs. Trash cans and bags will be provided on move out days.

## SHARPS CONTAINERS

Sharps containers will be available at the end of each barn aisle way. Please be aware Competition Management may fine any individual up to \$100 for improper disposal of needles or other sharp disposable instruments. GR1210.4 If needles are dropped in manure, it cannot be composted.

## JUMPER / HUNTER / EQ NOMINATING FEE

Horses or ponies entered in any jumper, hunter or equitation classes pay a Nomination Fee (varies per show). This fee allows entries to add classes before 4:00 pm prior to the day of the class (see next section).

## CLASS ADD / SCRATCH POLICY

**Adds** — Classes may be added up to a day ahead of time at no charge if the Show Office is notified by 4:00pm. Unless otherwise posted, it should be assumed that there are no day-of adds. If wanting to add a class on the same day, approval will be based on schedule availability and management discretion. We cannot guarantee acceptance, and you may be put on the ring wait list. If accepted, day-of adds will be assessed a \$10 per class fee.

**Scratches** — With the exception of special classes, if your horse has a written scratch form at the Show Office prior to the start of the class, full class entry fees are refunded minus a \$10 scratch fee. You must scratch your classes BEFORE they start. If you don't scratch them at all or try to scratch them after the class has started, you will be charged the full class entry fee.

## SPECIAL / SPOTLIGHT CLASS SCRATCH POLICY

Special / Spotlight classes will be assessed a \$25 scratch fee if scratched on the day of the class.

## RIDER DID NOT ENTER (RDNE) FEE

It is the responsibility of the competitor and trainer to ensure they have properly entered all classes they intend to compete in. A "ride-did-not-enter" (RDNE) fee of \$25 will be added to the cost of the class for any rounds competed that cannot be supported by office-approved paperwork.

## CLASS WAIT LIST POLICY

Be sure to get all entries planned for the next day in by 4pm. If full ring capacity is reached, any entries received for that ring after 4pm, may be put on a wait list. You are encouraged to enter all classes/divisions for the entire show before 4pm on schooling day to ensure entry in those classes/divisions.

## US EQUESTRIAN and USHJA FEES

All horses participating in any competition recognized by the US Equestrian Federation incur the following fees: USEF \$23 fee (\$15 of this fee is a Drugs and Medication fee to provide research, inspection, and enforcement of rules regarding use of medications and drugs: see GR407.1, .2, and .3); USHJA Fee \$7 (National shows) or \$2 (Regional I shows). An active USEF competing membership is required for all riders, trainers, and coaches (including parents signing entry forms as trainers) participating in rated classes. If you are not a current USHJA member, a Show Pass fee of \$30 is assessed by the USHJA if entering rated classes. These fees will be added to your show account.

## MANAGEMENT CLASS CHANGES

Management reserves the right to cancel or combine any classes as appropriate. Notice will be given to exhibitors affected. Management reserves the right to start the first class of any section 30 minutes earlier than the scheduled time. Management reserves the right to change arenas, judges, or class orders to facilitate time, schedule, and conditions.



Non-Toxic + Vegetarian + Glycerin-free + Petroleum-free + pH Matched Premium Leather Care

# CLEANING UP OUR SPORT...

One saddle at a time...

When you choose Sterling Essentials, you choose life-extending tack care made with pH formulated, all natural vegetarian ingredients, and mold-fighting pure essential oils.

You'll NEVER have to use harsh chemicals that damage your tack and harm you and your horse EVER AGAIN.

Liberate Yourself and Your Horse with Sterling Essentials.

**Enjoy 30% Off**

Use code 30CHS23

Expires Dec. 31, 2023. Terms and exclusions apply, see [www.Sterling-Essentials.com/Policies](http://www.Sterling-Essentials.com/Policies).

Photo Credit  
Genevieve Munson



**STERLING  
ESSENTIALS**  
— LLC —  
EMPOWERED EQUESTRIAN

Purchase your favorite fragrance at retailers nationwide or  
learn more at:

[WWW.STERLING-ESSENTIALS.COM](http://WWW.STERLING-ESSENTIALS.COM)

## PRIZE MONEY PAYMENTS

Exhibitors receive prize money within 3 weeks after the horse show. A valid Social Security or Federal tax ID number must be provided. Prize money won by foreign exhibitors is subject to the US Internal Revenue Service regulation requiring sporting events to withhold 30% of prize money unless they have a US Social Security #.

## TROPHIES, RIBBONS, PRIZE MONEY SPLITS

Trophy and ribbons will be awarded to eight places in all Hunter and Equitation classes. Unless stated otherwise, Hunter and Hunter Classic prize money will be divided 30%, 25%, 20%, 15%, 10%. The USHJA National Hunter Derby prize money will be divided 30%, 22%, 13%, 8%, 6%, 5%, 4%, 3%, 3%, 2%, 2%, 2%. Trophy and ribbons will be awarded to six places in all Jumper classes. Unless stated otherwise, Jumper prize money will be divided 25%, 23%, 20%, 17%, 15%. The Cascade Welcome and the Luxury DerbyCross™ prize money will be divided 30%, 23%, 15%, 12%, 10%, 10%. The Need for Speed™ Open Jumper will be divided 30%, 20%, 14%, 10%, 8%, 7%, 6%, 5%. The Grand Prix and Mini Prix will be divided 30%, 20%, 15%, 10%, 8%, 6%, 4%, 3%, 2%, 2%.

## HUNTER PRIZE MONEY

The total Hunter prize money guaranteed in 2024 is \$0 as all classes are run dependent upon posted requirements to fill. However, in the case that all classes do fill, the total amount of Hunter prize money offered in 2024 is: Pacific Crest Open (332619) and Cascade Finals (334509): \$7,166.00. The total amount of Hunter prize money for 2023 was: Pacific Crest Open (332619): Offered: \$6,417.00; Paid: \$3,643.22. Cascade Finals (334509): Offered: \$6,417.00; Paid: \$4,392.23.

## HUNTER TIES

As stated in [USEF HU154](#), in case of a tie the Championship and/or Reserve is awarded to the horse with the most points over fences. If horses have equal points over fences and no points under saddle, the tied horses will be asked to compete in a hack off (Exception: Green and Young Hunters.) Any competitor may concede and not hack off, or if both competitors agree, break the tie with a coin toss. If horses have an equal number of points over fences, under saddle, and model (i.e., Green Conformation Hunter 3'6" or High-Performance Conformation Hunter) the tie will stand as is and double ribbons will be awarded.

## JUMPER TIES

As stated in [USEF JP143](#), Competitors who are tied for first place after the initial round(s) will jump off. Any competitors that compete in the jump off and are still tied for first place shall remain tied. Competitors who are tied for other than first place in all Jumper sections will be placed according to the time taken to complete the first course. Prize money and Championship points shall be combined and divided equally among the tied competitors. Double ribbons will be awarded for division championships. For special classes, the competitors will toss a coin for the ribbon and toss a coin for the special award if any.

## JUMPER CLASS SCHEDULE TABLES

Jumper classes not otherwise designated in the class schedules will run as Table II.1, Table II.2.b or Table II.2.c, or Table II.d. Please refer to the daily schedules available in the Competition Office.

## STAKE/HANDY HUNTER CLASSES

If a per class entry is offered in a division, horse and rider must have shown in at least one other class in the division to be eligible for the Stake or Handy Hunter Class.

## POLING / OFFSETS

Manual poling, or the use of offsets, is prohibited on competition grounds (GR838).

## HORSE ILLNESS

In the event of an acute and serious injury or illness of a horse on competition grounds when the owner or trainer of the horse is not present, after reasonable effort to contact that individual has been made, Competition Management, in consultation with a licensed veterinarian, may authorize the provision of emergency veterinary treatment of the horse. If Competition Management authorizes treatment under provisions of this rule, Competition Management and veterinarian are not responsible for any resulting costs, damages, losses, claims, or actions arising directly from the treatment of the horse.

## SCHOOLING AND EXERCISE

Schooling areas are available for use before and during the show. A mandatory schooling fee of \$35 is charged for all horses. Helmets meeting the US Equestrian requirements as well as riding boots must be worn during schooling.

No lungeing is permitted in any of the arenas, including the warm-up rings. Please lunge horses on the designated lungeing pads located on the Horse Park near the west and northeast stalls.

## WARM-UP RINGS

During competition days, please cede use of the warm-up rings to riders preparing for upcoming classes. When jumping, standards are cleared with the flags on the right, no reversing of directions. Horses approaching a jump must always be given priority. For your safety and the safety of others, always pass "left shoulder to left shoulder" when traveling in opposite directions in the arena. More warm-up ring rules and best practices can be found at <https://practicalhorsemanmag.com/training/warm-up-ring-etiquette>

## ARENAS & FOOTING

Jumpers: 250' X 255'; Hunters: 150' X 220'; Hunters (covered): 150' X 300'. All have sand footing.

## DOGS

We welcome your dogs at the shows! Keep your dogs and horses safe by always keeping your dogs on leash while on the Horse Park property. We kindly request you pick up after your dog. For their safety, do not let dogs run loose on trails. All dogs are eligible for our Cascade Canine Derby! (Class availability varies by show.)

## RVs, MOTORHOMES, TRAILERS, AND CAMPERS

Submit the [RV Site Request form](#) to request your site. RV sites are available by the week only (the night before schooling day through Sunday day only). Additional nights on either end of the reservation may be available for an additional fee with pre-approval. As hookup sites are limited, preference is given for length of stay, sponsors, reservation date, and size of RV. In the event all the hookup sites are reserved, additional requests will be accepted for non-hookup dry-camping sites.

Full payment is required for confirmed sites. Designated trainers having an account with Cascade Horse Shows may choose to add their personal RV site to their show bill to have us do trainer splits. [All other sites](#) must be pre-paid in advance at the time of confirmation. Charges apply to RV site whether hooked to utilities or not.

Upon arrival, an RV Pass must be obtained from Show Office and displayed. Hookup locations are assigned by us—if assigned a site with a hookup, park only in your designated site.



Tent campers must submit a [Tent Camping Request form](#) to request camping on the Horse Park grounds. Upon arrival, camping passes must be obtained from the Show Office and displayed. Campers must camp in designated areas only. See the Tent Camping Request form for fees.

**MOTORIZED VEHICLES**

Minors who do not have a valid driver's license which allows them to operate a motorized vehicle in the state in which they reside will not be permitted to operate a motorized vehicle of any kind, including, but not limited to, golf carts, motorcycles, scooters, or farm utility vehicles, on the competition grounds of licensed competitions. Minors who have a valid temporary license may operate the above described motorized vehicles as long as they are accompanied by an adult with a valid driver's license. The parent/legal guardian or individual who signs the entry blank as a parent or guardian of a minor operating a motorized vehicle in violation of this rule are solely responsible for any damages, claims, losses, or actions resulting from that operation. Violations of this rule will be cause for penalties against those responsible for the child committing the offense. Wheelchairs and other mobility assistance devices for individuals with disabilities are exempt from this rule.

The unsafe use of personal electronic transport devices, as determined by the competition officials and management in their sole discretion, that do not require a driver's license to operate, including but not limited to segways, hover boards, and single wheeled scooters is prohibited on competition grounds. Operating such devices in areas where people gather may be

individual who signs the entry blank as a parent or guardian of a minor operating the device in violation of this rule is accountable and may be subject to penalties. Wheelchairs and other mobility assistance devices for individuals with disabilities are exempt from this rule.

**HELMETS**

It is compulsory for all persons at US Equestrian licensed hunter, jumper or hunter/jumper competitions when mounted anywhere on the competition grounds, to wear properly fastened protective headgear which meets or exceeds ASTM (American Society for Testing and Materials)/SEI (Safety Equipment Institute) standards for equestrian use and carries the SEI tag. It must be properly fitted with harness secure

**SAFETY AND WELFARE**

The nearest hospital is [Kittitas Valley Healthcare](#) which is 24 miles from the Washington State Horse Park. The nearest level 1 trauma center is [Harborview Medical Center](#) in Seattle, WA which is 83 miles from the Washington State Horse Park.

**DISCRETIONARY POLICY**

**All questions not covered in these rules and regulations shall be decided by Show Management whose decision shall be final.**



**Excited to be a Sponsor & Vendor at  
Cascade's Cle Elum Shows!**



2221 NE 3rd St · Bend, Oregon · 541-388-3855 · [www.TheAbsoluteHorse.com](http://www.TheAbsoluteHorse.com) · [AbsoluteHorse@gmail.com](mailto:AbsoluteHorse@gmail.com)

## SPOTLIGHT CLASSES

# Cascade Welcome 1.20m

Presented by **Cascade Partners**

Thursday, June 27, 2024

Thursday, September 5, 2024

The \$1,000 Cascade Welcome is a thrilling 1.20m Table II, Sec 2(a/b) jumper class—  
Time first with a jump off; ties to jump off for first place

*\$1,000 prize money distributed 1<sup>st</sup> through 6<sup>th</sup> 30%, 23%, 15%, 12%, 10%, 10%*

*This class counts toward the Jumper 1.30m section championship*

*Traditional attire encouraged; salute to sponsor requested*

*Noelle Chandler with  
MTM I Believe  
competing in the  
Cascade Welcome  
1.20m at the 2022  
Pacific Crest Open.*





# CIRCUIT CUP AWARDS

The Cascade Circuit Cup Awards are season championships bestowed upon the horses accumulating the most points in one of 5 categories over our rated show season.

## HONORING OUR 2023 WINNERS!

Congratulations to the following horses, riders, and trainers for their outstanding performances in 2023.

### JUMPER 1.10M AND UP

#### Gracia Cantura

9-year-old Holsteiner mare  
Owned, trained, and ridden by  
Lindsey Fletcher

### JUMPER UP TO 1.05M

#### Hastings

11-year-old Thoroughbred  
Owned and ridden by  
Pam Watterson-Terry  
Trained by Nancy Free and Sarah  
Olmsted

### USHJA HUNTER DERBY

#### Moonstruck

17-year-old Holsteiner gelding  
Owned and ridden by Lauren Hoyt  
Trained by Marybeth Davis

### HUNTER 3' AND UP

#### Cathmore Du Vlist

12-year-old Warmblood gelding  
Owned and ridden by Laurel Zeeman  
Trained by Amanda Gederman

### HUNTER UP TO 2'9"

#### Midnight Sun

5-year-old Welsh Pony  
Leased and ridden by Olivia Kibbie  
Trained by Jennifer Wagner-Worley

The Circuit Cup Awards are announced and presented at the conclusion of the Cascade Finals show in September. All horses competing in rated classes are eligible. Each winner receives valuable prizes honoring their achievement. We are excited to see who this season's big winners will be. See you in September!

Full Cascade Circuit Cup specifications can be found at [Cascade-Circuit-Cup-Specs.pdf \(cascadehorseshows.com\)](https://www.cascadehorseshows.com/Cascade-Circuit-Cup-Specs.pdf)





# Hunter Derbies

Friday, June 28, 2024

**\$1,500 USHJA National Hunter Derby**

*To be run at 3' with 3'5" options*

*Presented by **Brick Road Farms***

Sunday, June 30, 2024

**USHJA Outreach Hunter Derby**

*To be run at 2'6" with 2'9" options*

**USHJA Outreach Hunter Derby**

*To be run at 2' with 2'3" options*

*Both Presented by **Sharkey Farm***

*Winners Heidi Kauffman and Riviera Balou competing in the USHJA National Hunter Derby presented by Brick Road Farms at the 2023 Cascade Finals.*





## SPOTLIGHT CLASSES

Class #	Class	Height	Entry Fee	Prize Money
3	<b>USHJA National Hunter Derby</b> Presented by BRICK ROAD FARMS	3' with 3'5" options	\$150/class	\$1,500
4	<b>Pacesetter Mini Prix</b> Presented by PACESETTER PROPERTIES TEAM Offered exclusively at the Pacific Crest Open	1.15m	\$150/class	\$2,000
5	<b>Cascade Mini Prix</b> Presented by TNT Farrier Services Offered exclusively at the Cascade Finals	1.15m	\$150/class	\$2,000
11	<b>Rosé All Day Amateur Classic</b> Presented during the PCO by BRASS RING FARM	N/A	\$50/class	\$500
16	<b>Rising Stars™ Leadline</b> Presented by KERRITS EQUESTRIAN	N/A	Free	
17	<b>Cascade Canine Derby</b> Presented by EVOLUTION EQUESTRIAN	Varied	Free	
20	<b>Need for Speed™ Open Jumper 1.10 or 1.20m</b> Presented by VOLTAIRE DESIGN	1.10 or 1.20m	\$75/class	\$750
25	<b>Luxury DerbyCross™ 3'-3'3"   .90m</b> Presented by BELUXARI EQ	Hunter course: 3' with 3'3" options, Jumper course: .90m	\$110/class	\$750
181	<b>Cascade Welcome 1.20m</b> Presented by CASCADE PARTNERS This class is included in the Jumper 1.20m section	1.20m	\$100/class	\$1,000

**Formal Attire Required** — Salute to Sponsors Requested

See full class specifications here: [Specifications](#) on page 47.

## SPOTLIGHT CLASSES

# Rosé All Day Amateur Classic

Presented by **Cascade Partners**

Friday, June 28, 2024

Friday, September 6, 2024

Run in the spirit of a traditional Hunter Hack for all 21 and older amateur riders...  
How much will be left in *your* glass?

*\$500 prize money distributed 1<sup>st</sup> through 5<sup>th</sup>*

*The winner takes home a case of rosé wine, bottles to 8<sup>th</sup> place*

*Traditional attire encouraged; salute to sponsor requested*



*Rosé All Day winners Laurel Zeeman and Connect The Dots pose with sponsors Sarah Olmsted & Lauren Free of Brass Ring Farm at the 2023 Pacific Crest Open.*



# HUNTER DIVISION

## HUNTER CLASSICS

Class #	Class	Height	Entry Fee	Prize Money
30	<b>Pony Hunter Classic 2'3", 2'6", 2'9"-3'</b> Presented by KAIDYN GRIGGS	2'3", 2'6", 2'9"-3'	\$50/class	\$499
31	<b>Pre-Children's/Adult Hunter Classic 2'9"</b> Presented by CASCADE PARTNERS	2'9"	\$50/class	\$250
32	<b>Low Children's/Adult Hunter Classic 2'6"</b> Presented by STERLING ESSENTIALS	2'6"	\$50/class	\$499
33	<b>Children's Hunter Classic 3'</b> Presented by VOLTAIRE DESIGN	3'	\$50/class	\$499
70	<b>Adult Hunter Classic 3'</b> Presented by VOLTAIRE DESIGN	3'	\$50/class	\$499
34	<b>Children's Hunter Pony Classic 2', 2'3", 2'6"</b> Presented by FOREST PARK SADDLERY	2', 2'3", 2'6"	\$50/class	\$250
35	<b>Short/Long Stirrup Hunter Classic 2'3"</b> Presented by DIANNA CONNELLY INSURANCE	2'3"	\$50/class	\$250
36	<b>Short Stirrup Hunter Pony Classic 18"</b> Presented by HORSIN' AROUND COOKIE COMPANY	18"	\$50/class	\$250

**Formal Attire Required** — Salute to Sponsors Requested

**Prize Money** — 30%, 25%, 20%, 15%, 10%

All Classics are 2 rounds. The last class of the corresponding division to be the first round of the class. Round 2 to be shown over a course of at least 10 obstacles with at least one combination. Hunter Classic riders must have ridden in at least 2 hunter classes in their division to compete.

## USEF REGIONAL I-RATED HUNTER SECTIONS

Class #	Class (Section Code)	Height	Entry Fee	Prize Money
310, 311 <sup>1</sup> , 312 <sup>3</sup>	<b>Performance Hunter 3'6" (C)</b>	3'6"	\$150/section or \$55/class	\$90
315, 316 <sup>1</sup> , 317 <sup>3</sup>	<b>Performance Hunter 3'3" (D)</b>	3'3"	\$150/section or \$55/class	\$75
325, 326 <sup>1</sup> , 327 <sup>3</sup>	<b>Green Hunter 3'6" (F)</b>	3'6"	\$150/section or \$55/class	\$75
330, 331 <sup>1</sup> , 332 <sup>3</sup>	<b>Green Hunter 3'3" (G)</b>	3'3"	\$150/section or \$55/class	\$75
335, 336 <sup>1</sup> , 337 <sup>3</sup>	<b>Green Hunter 3' (H)</b>	3'	\$150/section or \$55/class	\$75
345, 346, 347 <sup>3</sup>	<b>Young Hunter 3'3" - Horses 7 &amp; Under (J)</b>	3'3"	\$150/section or \$55/class	
350, 351, 352 <sup>3</sup>	<b>Young Hunter 3' - Horses 6 &amp; Under (K)</b>	3'	\$150/section or \$55/class	
355, 356, 357 <sup>3</sup>	<b>Young Hunter 2'9" - Horses 5 &amp; Under (L)</b>	2'9"	\$150/section or \$55/class	
410, 411, 412 <sup>3</sup> , 413, 414 <sup>1</sup>	<b>Pony Hunter (SML) 2'3", 2'6", 2'9"-3' (W)</b>	2'3", 2'6", 2'9"-3'	\$225/section or \$55/class	\$50

Class # footnotes: 1 = Handy; 2 = Stake; 3 = Under Saddle; italics = Conformation

**Green Hunter:** Reference [US Equestrian Rule Book HU](#) for Green Hunter Eligibility and Status. Jog for soundness (Option A per HU118.3). Horse may compete in only one green hunter fence height section at any one competition.

**Young Hunter:** Reference [US Equestrian Rule Book HU](#) for Young Hunter Eligibility and Status. Not to Jog.

**AO Hunters:** Horses competing in 3'6" AO Hunters may not cross-enter 3'3" AO Hunters

**Junior Hunter:** A large Junior Hunter is over 16.0 hands, and a small Junior Hunter is 16.0 Hands and under. Junior Hunter 3'3" is open to junior riders. Riders may not cross-enter any class at 3'6" or higher in the Hunter division, higher than 3'9" in the Equitation division or higher than 1.20m in the Jumper division at the same competition. Horses entered in the Junior Hunter 3'3" section may not cross-enter the Junior Hunter 3'6" section at the same competition.

**SML Pony Hunter:** Classes 410, 415, and 420 are to be judged 25% Conformation.

**Sections may be combined if fewer than 4 entries in section.**

ALL HUNTER CLASSES WILL BE JUDGED ON PERFORMANCE AND SOUNDNESS UNLESS OTHERWISE NOTED



Are you looking for  
QUALITY PRE-OWNED  
children's riding apparel &  
pony tack?

**SHOP & CONSIGN NOW**  
[www.forestparksaddlery.com](http://www.forestparksaddlery.com)

@forestparksaddlery  
info@forestparksaddlery.com

# DCIS

*Dianna Connelly*  
Insurance Services, LLC

## EQUESTRIAN INSURANCE SPECIALIST



- Equine Mortality
- Equine Major Medical
- Instructors & Trainers Liability
- Commercial Equine Liability
- Private Horse Owner Liability
- Stable Liability
- Care, Custody & Control
- Farm Dwellings
- Horse Farm Package
- Auto

(206) 419-0634 - cell  
(425) 806-0401 - office  
PO Box 2277  
Bothell, WA 98041-2277

Dianna@Sea-Mountain.com  
[www.sea-mountain.com](http://www.sea-mountain.com)

 **Sea Mountain**  
INSURANCE

## USEF REGIONAL II AND NON-RATED HUNTER SECTIONS

Class #	Class (Section Code)	Height	Entry Fee	Prize Money
425, 426, 427, 428, 429 <sup>3</sup>	<b>Adult Amateur Hunter 18-39 3' (Z)</b>	3'	\$225/section or \$50/class	
430, 431, 432, 433, 434 <sup>3</sup>	<b>Adult Amateur Hunter 40 &amp; Over 3' (AA)</b>	3'	\$225/section or \$50/class	
435, 436, 437, 438, 439 <sup>3</sup>	<b>Children's Hunter 13 &amp; Under 3' (AB)</b>	3'	\$225/section or \$50/class	
440, 441, 442, 443, 444 <sup>3</sup>	<b>Children's Hunter 14-17 3' (AC)</b>	3'	\$225/section or \$50/class	
445, 446, 447 <sup>3</sup> , 448, 449	<b>Children's Hunter Pony 2', 2'3", 2'6" (AD)</b>	2', 2'3", 2'6"	\$225/section or \$50/class	
455, 456, 457 <sup>3</sup>	<b>Thoroughbred Hunter 3' (AE)</b>	3'	\$135/section or \$50/class	
460, 461, 462 <sup>3</sup>	<b>USHJA 2' Hunter (AF)</b>	2'	\$135/section or \$50/class	
465, 466, 467 <sup>3</sup>	<b>USHJA 2'3" Hunter (AG)</b>	2'3"	\$135/section or \$50/class	
470, 471, 472 <sup>3</sup>	<b>USHJA 2'6" Hunter (AH)</b>	2'6"	\$135/section or \$50/class	
475, 476, 477 <sup>3</sup>	<b>USHJA 2'9" Hunter (AI)</b>	2'9"	\$135/section or \$50/class	
480, 481, 482 <sup>3</sup>	<b>USHJA 3' Hunter (AJ)</b>	3'	\$135/section or \$50/class	
500, 501, 502, 503, 504 <sup>3</sup>	<b>Short Stirrup Hunter Horse 17 &amp; Under 2'3" (AK) *</b>	2'3"	\$225/section or \$50/class	
505, 506, 507 <sup>3</sup> , 508, 509	<b>Short Stirrup Hunter Pony 17 &amp; Under 18" (AL) *</b>	18"	\$225/section or \$50/class	
510, 511, 512, 513, 514 <sup>3</sup>	<b>Long Stirrup Hunter 18 &amp; Over 2'3" (AM) *</b>	2'3"	\$225/section or \$50/class	
515, 516, 517 <sup>3</sup>	<b>Large Hunter 3' (AO) *</b>	3'	\$135/section or \$50/class	
520, 521, 522, 523, 524 <sup>3</sup>	<b>Pre-Children's/Adult Hunter 2'9" (AP) *</b>	2'9"	\$225/section or \$50/class	
525, 526, 527 <sup>3</sup> , 528, 529	<b>Low Children's Hunter 2'6" (AQ) *</b>	2'6"	\$225/section or \$50/class	
530, 531, 532 <sup>3</sup> , 533, 534	<b>Low Adult Hunter 2'6" (AS) *</b>	2'6"	\$225/section or \$50/class	
535, 536, 537 <sup>3</sup>	<b>Baby Green Hunter 2'6" (AR) *</b>	2'6"	\$135/section or \$50/class	

Class # footnotes: 1 = Handy; 2 = Stake; 3 = Under Saddle \* Indicates a non-rated class.

**AA Hunter:** To be ridden by amateurs no longer eligible to compete as a Junior. See current [USHJA Zone 9 specifications](#) in this prize list or at [Zone-9 Specifications on USHJA.org](#).

**Ponies** may not cross into any other rated section at the same show. Riders may compete on a maximum of 1 Children's Hunter horse section at the same show and in any class not to exceed 3' (Exception: Pony Jumpers). Green & Regular Hunter Pony riders may compete on a maximum of 1 additional pony in the Children's Hunter Pony section at the same show.

**Thoroughbred Hunters:** Thoroughbred registration verification required, see [USEF HU 106.8](#)

**USHJA Hunter:** Open to all horses and ponies.

**Short Stirrup:** Rider no cross entry into any other classes except Low Under 3' Short Stirrup Equitation and Short Stirrup Pony or Short Stirrup Horse (as applicable to the class)

**Long Stirrup:** Riders no cross entry into rated classes 3' & up.

**Large Hunter:** Open to Horses Over 16 hands

**Pre-Children's/Adult Hunter:** Rider no cross entry into rated sections or classes with fences 3'6" or higher. May be split by age group if entries warrant.

**Low Children's Hunter:** Open to exhibitors who have not yet reached their 18th birthday as of December 1 of the current competition year. Riders may not cross enter at the same competition into any class/ section where fences exceed 2'9".

**Low Adult Hunter:** Open to exhibitors who have reached their 18th birthday as of December 1 of the current competition year. Riders may not cross enter into any class or section at the same competition where fences exceed 2'9".

**Baby Green:** Open to horses and ponies in 1st year of showing.

**Sections may be combined if fewer than 4 entries in section.**

ALL HUNTER CLASSES WILL BE JUDGED ON PERFORMANCE AND SOUNDNESS UNLESS OTHERWISE NOTED.



## HUNTER WARM-UP CLASSES (NON-RATED)

Class #	Class	Height	Entry Fee	Prize Money
600	<b>Warm-Up Hunter 18"</b>	18"	\$50/class	
610, 611	<b>Warm-Up Hunter 2'</b>	2'	\$50/class	
620, 621	<b>Warm-Up Hunter 2'3"</b>	2'3"	\$50/class	
630, 631, 632	<b>Warm-Up Hunter 2'6"</b>	2'6"	\$50/class	
640, 641	<b>Warm-Up Hunter 2'9"</b>	2'9"	\$50/class	
650, 651	<b>Warm-Up Hunter 3'</b>	3'	\$50/class	
660, 661	<b>Warm-Up Hunter 3'3"</b>	3'3"	\$50/class	
670, 671	<b>Warm-Up Hunter 3'6"</b>	3'6"	\$50/class	
680	<b>Warm-Up Pony Hunter</b>	Respective heights	\$50/class	

Braiding is optional. Not to jog.



*Tristen Evans and Azul Wh compete in the USHA National Hunter Derby presented by Brick Road Farms at the 2023 Cascade Finals. Owned and trained by Carol Hinckley.*

## USHJA OUTREACH HUNTER CLASSES (NON-RATED)

USEF / USHJA memberships and horse recording are not required.

Class #	Class	Height	Entry Fee	Prize Money
1200	<b>USHJA Outreach Hunter Derby 2'6"-2'9"</b> Presented by SHARKEY FARM	2'6" with 2'9" options	\$50/class	
1201	<b>USHJA Outreach Hunter Derby 2'-2'3"</b> Presented by SHARKEY FARM	2' with 2'3" options	\$50/class	
1203	<b>USHJA Outreach Hunt &amp; Handy</b>	2' with 2'3" options	\$50/class	
1205 <sup>3</sup> , 1206, 1207	<b>USHJA Outreach Hunters Walk/Trot Poles</b>		\$165/section or \$30/class	
1210 <sup>3</sup> , 1211, 1212, 1213, 1214	<b>USHJA Outreach Hunters Crossrail</b>		\$165/section or \$30/class	
1215, 1216, 1217 <sup>3</sup> , 1218, 1219	<b>USHJA Outreach Hunters 18"</b>	18"	\$120/section or \$35/class	
1220, 1221, 1222 <sup>3</sup> , 1223, 1224	<b>USHJA Outreach Hunters 2'</b>	2'	\$120/section or \$35/class	
1225 <sup>3</sup> , 1226, 1227, 1228, 1229	<b>USHJA Outreach Hunters 2'3"</b>	2'3"	\$120/section or \$35/class	
1230, 1231, 1232 <sup>3</sup> , 1233, 1234	<b>USHJA Outreach Hunters 2'6"</b>	2'6"	\$120/section or \$35/class	
1235 <sup>3</sup> , 1236, 1237, 1238, 1239	<b>USHJA Outreach Hunters 2'9"</b>	2'9"	\$120/section or \$35/class	
1240, 1241, 1242 <sup>3</sup> , 1243, 1244	<b>USHJA Outreach Hunters 3'</b>	3'	\$120/section or \$35/class	

Class # footnotes: 3 = Under Saddle

**THE GRANGE**  
SINCE 1934  
COUNTRY CO-OP  
For the Farmer in All of Us!™

**THE GRANGE**  
FOR ALL YOUR HORSE NEEDS

Blankets,  
Fly Sheets,  
Feed & Treats,  
Supplements,  
Grooming Supplies,  
and more!

145 NE GILMAN BLVD ISSAQUAH, WA 98027  
(425) 392-6469 [www.grangesupply.com](http://www.grangesupply.com) [shop.grangesupply.com](http://shop.grangesupply.com)

f i



## SPOTLIGHT CLASSES

# Luxury DerbyCross

Presented by **Beluxari EQ**

Sunday, June 30, 2024

Sunday, September 8, 2024

The Cascade-exclusive Luxury DerbyCross™ is a unique combined class challenging the skills of both rider and horse with back-to-back Handy Hunter and Jumper Speed rounds

*Lowest combined score wins*

*\$1,000 distributed 1st through 6th*

*Formal Hunter attire and tack required; braiding optional*

*Salute to sponsor requested*

*Hinkapy Van Teigenloo and Brooklyn Thurman, right, lead the top placers in the traditional Cascade "V for victory" after winning the Luxury DerbyCross at the 2023 Cascade Finals. Owner and trainer: Amalia Raemy.*



# EQUITATION DIVISION

## EQUITATION SECTIONS

Class #	Class (Section Code)	Height	Entry Fee
700, 701, 702 <sup>3</sup>	<b>Pony Equitation 2'3", 2'6", 2'9"-3' (AT)</b>	2'3", 2'6", 2'9"-3'	\$135/section or \$50/class
703 <sup>3</sup> , 704, 705	<b>Long Stirrup Equitation 2'3" (AU)</b>	2'3"	\$135/section or \$50/class
706 <sup>3</sup> , 707, 708	<b>Short Stirrup Equitation Horse 2'3" (AV)</b>	2'3"	\$135/section or \$50/class
709, 710, 711 <sup>3</sup>	<b>Short Stirrup Equitation Pony 18" (AW)</b>	18"	\$135/section or \$50/class
712, 713, 714 <sup>3</sup>	<b>Children's Pony Equitation 2', 2'3", 2'6" (AX)</b>	2', 2'3", 2'6"	\$135/section or \$50/class
715, 716, 717 <sup>3</sup>	<b>Low Children's Equitation 2'6" (AY)</b>	2'6"	\$135/section or \$50/class
718, 719, 720 <sup>3</sup>	<b>Low Adult Equitation 2'6" (AZ)</b>	2'6"	\$135/section or \$50/class
721, 722, 723 <sup>3</sup>	<b>Pre-Children's/Adult Equitation 2'9" (BA)</b>	2'9"	\$135/section or \$50/class
724, 725, 726 <sup>3</sup>	<b>Adult Equitation 18-39 3' (BB)</b>	3'	\$135/section or \$50/class
727, 728, 729 <sup>3</sup>	<b>Adult Equitation 40 &amp; Over 3' (BC)</b>	3'	\$135/section or \$50/class
730, 731, 732 <sup>3</sup>	<b>Equitation 14 &amp; Under 3' (BD)</b>	3'	\$135/section or \$50/class
733, 734, 735 <sup>3</sup>	<b>Equitation 15-17 3' (BE)</b>	3'	\$135/section or \$50/class

Class # footnotes: 3 = Not to jump

\* Ponies ride respective heights

## USHJA OUTREACH EQUITATION (NON-RATED)

*USEF / USHJA memberships and horse recording are not required.*

Class #	Class	Height	Entry Fee
1300 <sup>3</sup> , 1301 <sup>3</sup> , 1302 <sup>3</sup> , 1303 <sup>3</sup>	<b>USHJA Outreach Walk, Trot Equitation</b>		\$150/section or \$35/class
1310, 1311 <sup>3</sup> , 1312, 1313	<b>USHJA Outreach Equitation Crossrail</b>		\$150/section or \$35/class
1315, 1316 <sup>3</sup> , 1317, 1318	<b>USHJA Outreach Equitation 18"</b>	18"	\$120/section or \$35/class
1320, 1321 <sup>3</sup> , 1322, 1323	<b>USHJA Outreach Equitation 2'</b>	2'	\$120/section or \$35/class
1325, 1326 <sup>3</sup> , 1327, 1328	<b>USHJA Outreach Equitation 2'3"</b>	2'3"	\$120/section or \$35/class
1330, 1331 <sup>3</sup> , 1332, 1333	<b>USHJA Outreach Equitation 2'6"</b>	2'6"	\$120/section or \$35/class
1335, 1336 <sup>3</sup> , 1337, 1338	<b>USHJA Outreach Equitation 2'9"</b>	2'6"	\$120/section or \$35/class
1340, 1341 <sup>3</sup> , 1342, 1343	<b>USHJA Outreach Equitation 3'</b>	3'	\$120/section or \$35/class

Class # footnotes: 3 = Not to jump

Braiding is optional. Not to jog.



## Laurel Zeeman CPA

*It's about more than understanding your taxes...  
It's about understanding YOU!*

I prefer to take a proactive — not reactive — approach to your taxes. By keeping current on new tax laws and legislation, I am in a position to identify key tax planning opportunities that minimize both your current and future tax liabilities. And as a horsewoman, I understand the specific needs of the hunter jumper community, and am proud to be a sponsor of Cascade shows.

I provide my clients with the expertise they deserve — *year round.*

### CONTACT

211 Taylor Street, # 4,  
Port Townsend, Washington  
98368  
(360) 301-0042 (no texts please)  
<https://porttownsendcpa.com/>

### HOURS

*Tax Season (January-April)*  
Monday - Wednesday 9-5  
Thursday-Friday By appointment only  
*Off Season (May-December)*  
By appointment only



# much more than just a feed store

*Much more than just a feed store*

**OLD MILL  
COUNTRY STORE**

1987 - 2017

Open 7 Days A Week  
**509-925-5397 • 500 W. Third**

Whether it's for commercial use or for the animals  
in your back yard, let our knowledgeable staff help  
find you the right product to keep your animals  
healthy and happy.

Old Mill Country Store  
is your total source  
supplier of  
cutting edge animal  
health and nutrition  
products

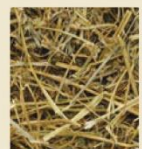

## MEDAL CLASSES

Class #	Class	Height	Entry Fee
800	<b>WSHJA Good Hands &amp; Seat 2'6"</b>	2'6"	\$50/class
801	<b>WSHJA Good Hands &amp; Seat 3'</b>	3'	\$50/class
802	<b>WSHJA Good Hands &amp; Seat 3'6"</b>	3'6"	\$50/class
803	<b>ASPCA Maclay Horsemanship Medal 3'6"</b>	3'6"	\$50/class
804	<b>Dover Saddlery/USEF Hunter Seat Medal 3'6"</b>	3'6"	\$50/class
805	<b>Hamel Foundation NHS Medal 3'3"</b>	3'3"	\$50/class
807	<b>USEF/NCEA Junior Hunter Seat Medal 3'3"</b>	3'3"	\$50/class
808	<b>Taylor Harris Insurance National Children's Medal 3'</b>	3'	\$50/class
809	<b>Ariat National Adult Medal 3'</b>	3'	\$50/class
810	<b>Marshall &amp; Sterling U.S. Pony Medal 2'3", 2'6", 2'9"-3'</b>	Respective heights	\$50/class
811	<b>OHJA Mini Medal 2'6"</b>	2'6"	\$50/class
812	<b>OHJA Children's Medal 3'</b>	3'	\$50/class
813	<b>OHJA Adult Medal 3'</b>	3'	\$50/class
814	<b>USHJA Jumping Seat Medal 3'3"</b>	3'3"	\$50/class

**WSHJA Medals:** Open to juniors and amateurs. Riders must be WSHJA members prior to the start of the class.

**ASPCA Maclay:** Open to junior members of USEF or Equine Canada who have not reached their 18th birthday in accordance with GR127. Riders and their trainers or coaches must be current members of the National Horse Show Association ("NHS").

**Dover Saddlery/USEF Hunter Seat:** Open to Individual Junior USEF Members in good standing who have not reached their 18th birthday in accordance with GR127.

**USEF/NCEA:** NCEA membership is not required to ride the class but only NCEA members receive points and will be included in rankings for the finals

**Taylor Harris National Children's Medal:** Riders not to compete in any hunter or equitation class 3'9" or higher, or jumper class set above 1.20m at same show

**Ariat National Adult Medal:** Riders not to compete over jumps that exceed 3'6" or 1.20m or higher at same show.

**Marshall & Sterling U.S. Pony Medal:** Tests young riders, judging their ability to compete over a technical and demanding course of fences.

**OHJA Mini Medal:** No cross entry with 3' medals. Riders must be OHJA members prior to the start of the class.

**OHJA Children's Medal:** Riders may not cross-enter junior hunters, junior jumpers, or any 3'6" medal class at the same show. Riders must be OHJA members prior to the start of the class.

**OHJA Adult Medal:** Riders must be OHJA members prior to the start of the class.





#1

# SHINE SPRAY ON THE MARKET

“ THE QUALITY OF EQUIFUSE SHINE IS SIMPLY

*perfection in a bottle.*

IT'S THE ONLY COAT SHINE SPRAY I TRUST ON MY SENSITIVE MARE. ”



LINDSEY DENOBREGA, EQUIFUSE USER

# JUMPER DIVISION

## JUMPER CLASSICS

Class #	Class	Height	Entry Fee	Prize Money
60	<b>Open Jumper Classic .60m, .70m, .80m</b> Presented by NARROWS EQUESTRIAN	.60m, .70m, .80m	\$60/class	\$300
63	<b>Open Jumper Classic .90m</b> Presented by SUNDANCE EQUESTRIAN	.90m	\$60/class	\$500
64	<b>Open Jumper Classic 1.00m</b> Presented by VOLTAIRE DESIGN	1.00m	\$60/class	\$500

**Formal Attire Required** — Salute to Sponsors Requested

Prize Money — 25%, 23%, 20%, 17%, 15%

Jumper Classic riders must have ridden in at least 1 other class to compete.



*Owner, rider, and trainer Patrick Billes sails over a jump aboard Rabenschwartz during the Cascade Mini Prix presented by TNT Farrier Services at the 2023 Cascade Finals. The pair were second in the class which Patrick won with his other entry, Espartano Ls.*



## JUMPER SECTIONS

Class #	Class	Height	Entry Fee	Prize Money
105, 106, 107, 108, 109	<b>Jumper .70m</b>	.70m	\$225/section or \$50/class	
120, 121, 122, 123, 124	<b>Jumper .80m</b>	.80m	\$225/section or \$50/class	
140, 141, 142, 143	<b>Jumper .90m</b>	.90m	\$180/section or \$50/class	
160, 161, 162	<b>Jumper 1.00m</b>	1.00m	\$180/section or \$50/class	
170, 171, 172	<b>Jumper 1.10m</b>	1.10m	\$200/section or \$55/class	\$100
175, 176, 177	<b>Jumper 1.15m</b>	1.15m	\$200/section or \$55/class	\$100
180, 181, 182, 183	<b>Jumper 1.20m</b>	1.20m	\$55/\$100/class	\$100/\$1,000
200, 201, 202	<b>PNW 5 Y/O Young Jumper 1.00m</b> To run at 1.15m during Cascade Finals	1.00m	\$165/section or \$60/class	
205, 206, 207	<b>PNW 6 Y/O Young Jumper 1.10m</b> To run at 1.25m during Cascade Finals	1.10m	\$165/section or \$60/class	
210, 211, 212	<b>PNW 7 Y/O Young Jumper 1.15m</b> To run at 1.30m during Cascade Finals	1.15m	\$165/section or \$60/class	
230, 231, 232	<b>Thoroughbred Jumper 1.00m</b>	1.00m	\$135/section or \$50/class	
240, 241, 242 <sup>2</sup>	<b>Mod. Junior/Amateur Jumper 1.15m</b>	1.15m	\$180/section or \$50/class	Stake \$500
245, 246, 247 <sup>2</sup>	<b>Junior/Amateur Jumper 1.20m</b>	1.20m	\$165/section or \$60/class	Stake \$500
250, 251, 252, 253 <sup>2</sup>	<b>Low Adult Amateur Jumper .90m</b>	.90m	\$180/section or \$50/class	Stake \$150
255, 256, 257, 258 <sup>2</sup>	<b>Low Children's Jumper .90m</b>	.90m	\$180/section or \$50/class	Stake \$150
260, 261, 262, 263 <sup>2</sup>	<b>Low Adult Amateur Jumper 1.00m</b>	1.00m	\$180/section or \$50/class	Stake \$150
265, 266, 267, 268 <sup>2</sup>	<b>Low Children's Jumper 1.00m</b>	1.00m	\$180/section or \$50/class	Stake \$150
270, 271, 272	<b>High Adult Amateur Jumper 1.10m</b>	1.10m	\$180/section or \$50/class	Stake \$150
275, 276, 277	<b>High Children's Jumper 1.10m</b>	1.10m	\$180/section or \$50/class	Stake \$150

Class # footnotes: 2 = Stake

**Stake Classes:** Must have ridden in at least one other class in the same section at the same show to ride in any Stake Class

**Class #181** is the Cascade Welcome 1.20m Spotlight class

**PNW Young Jumpers:** Open to jumpers with papers indicating a foaling date the number of years as indicated prior to the current calendar year. WSHJA membership required to qualify for PNW championship. ^ = Clear rounds

**Thoroughbred Jumper:** Thoroughbred registration verification required according to USEF JP 120. Affiliated with the TAKE2 Thoroughbred League. Points count for USEF and TAKE2

**Children's & Adult Amateur** jumper riders may not cross-enter classes with fences over 1.15m

**Low Children's & Low Adult Amateur** horse and rider combinations may not cross-enter the High Children's & High Adult Amateur Jumpers

**High Children's & High Adult Amateur** horse and rider combinations may not cross-enter the Low Children's & Low Adult Amateur Jumpers

Sections may be split by age group if there are more than 5 horses in each section

USHJA Outreach competition at Cascade shows offers a great learning experience for upcoming horses and riders. Photo courtesy of Viola Mitchell Photography.



## USHJA OUTREACH JUMPER CLASSICS (NON-RATED)

Class #	Class	Height	Entry Fee	Prize Money
1455	<b>USHJA Outreach Jumper Classic</b> Presented by the LAKE WASHINGTON SADDLE CLUB (LWSC)	.60m, .70m, .80m	\$40/class	\$300

## USHJA OUTREACH JUMPER CLASSES (NON-RATED)

USEF / USHJA memberships and horse recording are not required.

Class #	Class	Height	Entry Fee	Prize Money
1400, 1401, 1402, 1403, 1404, 1405	<b>USHJA Outreach Jumper .60m</b>	.60m	\$180/section or \$35/class	
1410, 1411, 1412, 1413, 1414, 1415	<b>USHJA Outreach Jumper .70m</b>	.70m	\$180/section or \$35/class	
1420, 1421, 1422, 1423, 1424, 1425	<b>USHJA Outreach Jumper .80m</b>	.80m	\$180/section or \$35/class	
1430, 1431, 1432, 1433, 1434, 1435	<b>USHJA Outreach Jumper .90m</b>	.90m	\$180/section or \$35/class	
1440, 1441, 1442, 1443	<b>USHJA Outreach Jumper 1.00-1.05m</b>	1.00-1.05m	\$180/section or \$35/class	
1445, 1446, 1447, 1448	<b>USHJA Outreach Jumper 1.10-1.15m</b>	1.10-1.15m	\$180/section or \$35/class	
1450, 1451, 1452, 1453	<b>USHJA Outreach Jumper 1.20m</b>	1.20m	\$180/section or \$35/class	



## SPOTLIGHT CLASSES

# Need for Speed™ Open Jumper Classic

Presented by **Voltaire Design**

Sunday, June 30, 2024

Sunday, September 8, 2024

*To be run at 1.20m or 1.10m with time penalty*

*\$750.00 prize money to be distributed 1<sup>st</sup> through 8<sup>th</sup>*

*The winner receives \$500 in Voltaire Design accessories*

*Formal attire required; salute to sponsor requested*

*Owner/rider Sahale Fox and Salsa Verde compete in the Need for Speed  
Open Jumper at the 2023 Cascade Finals. Trainer: Annika Mertel.*



# CHAMPIONSHIPS OFFERED

## Hunter Section Championships

Performance Hunter 3'6" (C)	Adult Amateur Hunter 18-39 3' (Z)	Short Stirrup Hunter Horse 17 & Under 2'3" (AK)
Performance Hunter 3'3" (D)	Adult Amateur Hunter 40 & Over 3' (AA)	Short Stirrup Hunter Pony 17 & Under 18" (AL)
Green Hunter 3'6" (F)	Children's Hunter 13 & Under 3' (AB)	Long Stirrup Hunter 18 & Over 2'3" (AM)
Green Hunter 3'3" (G)	Children's Hunter 14-17 3' (AC)	Large Hunter 3' (AO)
Green Hunter 3' (H)	Children's Hunter Pony 2', 2'3", 2'6" (AD)	Pre-Children's/Adult Hunter 2'9" (AP)
Young Hunter 3'3" - Horses 7 & Under (J)	Thoroughbred Hunter 3' (AE)	Low Children's Hunter 2'6" (AQ)
Young Hunter 3' - Horses 6 & Under (K)	USHJA 2' Hunter (AF)	Baby Green Hunter 2'6" (AR)
Young Hunter 2'9" - Horses 5 & Under (L)	USHJA 2'3" Hunter (AG)	Low Adult Hunter 2'6" (AS)
Pony Hunter (SML) 2'3", 2'6", 2'9"-3' (W)	USHJA 2'6" Hunter (AH)	
	USHJA 2'9" Hunter (AI)	
	USHJA 3' Hunter (AJ)	

**Hunter Championships:** Hunter champion and reserve will be awarded to two of the four horses scoring the most points over fences. In addition, only these top four horses will receive full points for ribbons won under saddle and half points for ribbons won in model. Points will be awarded 10, 6, 4, 2, 1, ½.

## Equitation Section Championships

Pony Equitation 2'3", 2'6", 2'9"-3' (AT)	Children's Pony Equitation 2', 2'3", 2'6" (AX)	Adult Equitation 18-39 3' (BB)
Long Stirrup Equitation 2'3" (AU)	Low Children's Equitation 2'6" (AY)	Adult Equitation 40 & Over 3' (BC)
Short Stirrup Equitation Horse 2'3" (AV)	Low Adult Equitation 2'6" (AZ)	Equitation 14 & Under 3' (BD)
Short Stirrup Equitation Pony 18" (AW)	Pre-Children's/Adult Equitation 2'9" (BA)	Equitation 15-17 3' (BE)

**Equitation Championships:** points for all classes shall be calculated 10, 6, 4, 2, 1, ½. In the case of a tie for champion or reserve, the winner shall be the entry with the most points over fences. If still tied, the entry with the most points in the equitation flat class will win the tie.

## Jumper Section Championships

Jumper .70m	High Adult Amateur Jumper 1.10m	Mod. Junior/Amateur Jumper 1.15m
Jumper .80m	High Children's Jumper 1.10m	Thoroughbred Jumper 1.00m
Jumper .90m	Junior/Amateur Jumper 1.20m	
Jumper 1.00m	Low Adult Amateur Jumper .90m	
Jumper 1.10m	Low Adult Amateur Jumper 1.00m	
Jumper 1.15m	Low Children's Jumper .90m	
Jumper 1.20m	Low Children's Jumper 1.00m	

**Jumper Championships:** in jumper championships, points for all classes shall be calculated 10, 6, 4, 2, 1, 1/2. In case of a tie for champion or reserve the tied entries shall remain tied and each receive a ribbon and trophy / prize.

## USHJA Outreach Section Championships

**Outreach Hunter, Equitation and Jumper Championships:** Championships are offered for every Outreach hunter, equitation, and jumper section. Please refer to the class and section tables for a full list of Outreach sections.

**All:** At least three competitors must compete in the first class of a section for it to run.

**Sections codes** (in parentheses) allow convenient entry into all classes in section.



# Join WSHJA!

## Why become a member?

- Opportunity to participate in the WSHJA Annual Awards Program, earning points towards year-end championships.
- Access to WSHJA Scholarships to financially aid in attending Equitation, Hunter, and Jumper Finals.
- Exclusive invitations to educational events, including judges' clinics, trainer symposiums, and much more!
- Access to a community of horse-loving individuals who share your interest and passion for the horse.



### 2023 WSHJA HORSE SHOWS

SPRING INAUGURAL\* - April 5-9

SPRING NATIONAL - April 12-16

PACIFIC NORTHWEST\* - May 17-21

EVERGREEN CLASSIC - August 3-6

NORTHWEST AUTUMN CLASSIC -  
Sept 13-17

OCTOBER CLASSIC\* - October 11-15

\* - Outreach Show Overlay



**Scan this code to view our website!**

*Proud Sponsor of*

**Cascade**  
HORSE SHOWS

## SPOTLIGHT CLASSES

# Cascade Canine Derby

Presented by **Evolution Equestrian**

Saturday, June 29, 2024

Saturday, September 7, 2024

A fan-favorite tradition! Open to dogs of all sizes and breeds.

*A team event challenging dogs and their humans over a course of 8 obstacles, with high options.  
Prizes to 6<sup>th</sup>, smiles for everyone!*

Congratulations to our 2023 Champions:

*Pacific Crest Open:*

**Zoot** – Handler: Mark Zeeman

*Reserve Champions:*

**Coco** – Handler: Kaidyn Griggs





# SPECIFICATIONS

---

## **Pacesetter Mini Prix, #4**

The Grand Prix held at each Cascade show will be run as a Table II, Sec 2(a) — Time first with a jump off; ties to jump off for first place. Order of go will be drawn by Show Management under supervision of the USEF Steward and posted by 2pm the day of the class. Prize money will be distributed as 1<sup>st</sup> 30%, 2<sup>nd</sup> 20%, 3<sup>rd</sup> 14%, 4<sup>th</sup> 10%, 5<sup>th</sup> 8%, 6<sup>th</sup> 7%, 7<sup>th</sup> 6%, 8<sup>th</sup> 5% unless otherwise stated. Horses and riders must have competed in at least one other class in the competition. Formal attire required; salute to sponsors requested.

---

## **Cascade Mini Prix, #5**

The Grand Prix held at each Cascade show will be run as a Table II, Sec 2(a) — Time first with a jump off; ties to jump off for first place. Order of go will be drawn by Show Management under supervision of the USEF Steward and posted by 2pm the day of the class. Prize money will be distributed as 1<sup>st</sup> 30%, 2<sup>nd</sup> 20%, 3<sup>rd</sup> 14%, 4<sup>th</sup> 10%, 5<sup>th</sup> 8%, 6<sup>th</sup> 7%, 7<sup>th</sup> 6%, 8<sup>th</sup> 5% unless otherwise stated. Horses and riders must have competed in at least one other class in the competition. Formal attire required; salute to sponsors requested.

---

## **USHJA National Hunter Derby, #3**

The USHJA National Hunter Derby features a two-round format with a minimum of two judges utilizing a numerical system to score competitors in the Classic Hunter Round (first round) on performance, hunter pace, jumping style, quality and substance, and movement. A second round will feature a Handy Hunter course designed to reflect brilliance of pace and handiness. In each round, following the judges' base score, one point will be added for each high-option fence jumped; up to a maximum of four high options may be included. Fences are set at 3' with four high-option fences set at 3'5" (June) or 3'3" (July/September). Prize money will be distributed as: 1<sup>st</sup> 30%, 2<sup>nd</sup> 22%, 3<sup>rd</sup> 13%, 4<sup>th</sup> 8%, 5<sup>th</sup> 6%, 6<sup>th</sup> 5%, 7<sup>th</sup> 4%, 8<sup>th</sup>–9<sup>th</sup> 3%, 10<sup>th</sup>–12<sup>th</sup> 2% unless otherwise stated. The top 3 Amateurs/Juniors will also be recognized. Formal attire required; salute to sponsor requested. Full specs can be found in this document and with the United States Hunter Jumper Association.

---

## **Luxury DerbyCross™, #25**

The Luxury DerbyCross is a unique combined class that challenges the skills of a rider and horse pair to perform in both the Hunter and Jumper disciplines. This class features both a Handy Hunter Derby round and a Jumper Speed round which are ridden back-to-back with no break. The Handy Hunter Derby round will include some natural fences, at least one trot fence and bending line and will be judged on performance, hunter pace, style, quality, and handiness. The Jumper speed round will consist of a minimum of 8 jumps 1.00m with a minimum of one combination and will be judged as Table II.1 (a speed class). The Hunter course will have fences at 3' with 2 high options of 3'3". Riders will ride the Hunter course first, then immediately walk on a designated path to the Jumper course to begin their speed round. Riders MUST stay mounted and MUST walk from one ring to the other having NO interaction with trainers, spectators, or family. Upon entering the Jumper ring, the horse and rider will have 5 seconds before the starting whistle. Once the whistle is blown, the horse and rider must cross the start line within the time allowed or face time penalties. A total of two refusals will constitute elimination. Scoring: points will be assigned to both Hunter and Jumper rounds and added together to determine the winner. Horse and rider must be present to ride for ribbons. Prize money will be distributed as: 1<sup>st</sup> 30%, 2<sup>nd</sup> 23%, 3<sup>rd</sup> 15%, 4<sup>th</sup> 12%, 5<sup>th</sup> 10%, 6<sup>th</sup> 10%. Formal attire required; salute to sponsor requested. Formal Hunter attire and tack required. Braiding is optional.

---

## **Cascade Welcome 1.20m, #181**

The Cascade Welcome held at each Cascade show will be run as a Table II, Sec 2(a/b) — Time first with a jump off; ties to jump off for first place. Order of go will be drawn by Show Management under supervision of the USEF Steward and posted by 2pm the day of the class. Prize money will be distributed as: 1<sup>st</sup> 30%, 2<sup>nd</sup> 23%, 3<sup>rd</sup> 15%, 4<sup>th</sup> 12%, 5<sup>th</sup> 10%, 6<sup>th</sup> 10% unless otherwise stated. This class counts towards the Jumper 1.20m section championship.

---

# SPECIFICATIONS (CONT.)

---

## **Rosé All Day Amateur Classic, #11**

Run in the spirit of a traditional Hunter Hack for all 21 & older amateur riders. A Hunter Hack is a type of English pleasure class where exhibitors in Hunt seat tack and attire perform on the flat at a walk, trot, canter, and hand gallop, and then jump two low fences. For this unique variation, riders may be asked to walk, trot, canter, change direction, sit the trot, halt & back up, and jump a cavalletti line, all while holding a glass of “rosé” wine! Class will be pinned on Judges Score adjusted for the “rosé” left in your glass. The winner also takes home a case of (real) rosé wine with bottles of rosé to 8th place. Traditional attire encouraged; salute to sponsor requested.

---

## **Rising Stars™ Leadline, #16**

No Fee. Preceding the Mini Prix events. Wow the crowd with style and smiles. Prizes to all. Helmet and boots required.

---

## **Cascade Canine Derby, #17**

A fan-favorite tradition of our Pacific Crest Open show. Open to all dogs of all sizes and breeds. A team event challenging dogs and their humans over a course of 8 obstacles, with high options. Prizes to 6<sup>th</sup>, smiles for everyone!

---

## **Need For Speed™ Open Jumper, #20**

The Need for Speed Open Jumper will be run as a Table III speed round, with faults converted into seconds. A time limit of 120 seconds will apply, and faults incurred will be penalized by adding four seconds for each occurrence. This class is offered at 1.10m and 1.20m. Entrants must designate which height they intend to compete in at the time they enter. At the 1.10m height a 2 second handicap will be added to each competitor's time. Prize money will be distributed as: 1<sup>st</sup> 30%, 2<sup>nd</sup> 20%, 3<sup>rd</sup> 14%, 4<sup>th</sup> 10%, 5<sup>th</sup> 8%, 6<sup>th</sup> 7%, 7<sup>th</sup> 6%, 8<sup>th</sup> 5% unless otherwise stated. Formal attire required; salute to sponsor requested.

---

## **Cascade Open Jumper Classics, #60-64**

Jumper Classic riders must have ridden in at least one other class in the corresponding section to compete. Open Jumper Classics are offered at .70m, .80m, .90m and 1.00m. Ribbons to 8<sup>th</sup>, prize money to 5<sup>th</sup>: (30%, 25%, 20%, 15%, 10%).

---



# New and Improved!

## USHJA Outreach Rewards and Awards

Earn points towards year-end rewards and awards with a free USHJA Outreach Membership!

USHJA Outreach Competitions and Classes provide opportunity to earn national recognition in classes from walk/trot to 3'0" in hunter, equitation, and .60m-1.20m in jumper sections at rated and unrated local shows.

### Rewards

Riders and owners of USHJA Outreach registered horses can earn level status and points to redeem at the end of the year for items such as USHJA logo wear, Outreach ribbons or Outreach medallions.

**Bronze Level:** Riders or horses must earn at least 50-74 points during the competition year

**Silver Level:** Riders or horses must earn at least 75-99 points during the competition year

**Gold Level:** Riders or horses must earn at least 100 points during the competition year

### Awards

*New! Exciting year-end awards will be given to trainers, riders and horses.*

**Trainers**—Earn the USHJA Outreach High Point Trainer Award by being the leading trainer in your zone whose riders have earned 100 or more points cumulatively in USHJA Outreach Classes.

**Riders**— In addition to awards and rewards, one high point rider from each Zone will earn a Golden Backstage Pass to participate in the USHJA National Championship Affiliate sections and get exclusive access to free educational sessions and National Championship Grand Prix and Hunter Derby course walks!

**Horses**—While horse recording and microchipping is not required to participate in Outreach classes, owners wishing for their horses to earn points must have them recorded with USHJA (\$20/annual or \$75/lifetime). Horses will have their Outreach points tracked and ranked within their USHJA Zone and displayed on ushja.org.

### For more information

and to find a USHJA Outreach Competition near you, visit [ushja.org/Outreach](http://ushja.org/Outreach).

**Questions?** Contact Melanie Mader at [mmader@ushja.org](mailto:mmader@ushja.org).



USHJA Outreach Champion



USHJA Outreach Champion



USHJA Outreach Champion



USHJA Outreach Champion



# USHJA NATIONAL HUNTER DERBY QUICK SPECS

For full specifications see: <https://ushja.org/competition/hunter/national-hunter-derby>

## Membership Requirements

1. Riders, owners, and trainers must be a current Active member of USEF and USHJA to participate in this class. (see GR202).
2. Horses and ponies must be registered with USHJA to participate in this class.
3. Exception: Foreign residents and horses and ponies in good standing with their National Federation are eligible to compete in this class but will not receive points unless they follow 1 and 2.
4. USHJA Zone HOTY bonus points will only be awarded if the owner is a current Active member of USEF and USHJA and the horse is recorded with USEF and registered with USHJA.
5. Money won will only count for any USHJA National Hunter Derby standings or awards if the rider, owner and trainer are current Active members of USEF and USHJA, and the horse is registered with USHJA.

## Course Requirements: Jumps in ALL Rounds

1. Obstacles must simulate those reminiscent of the hunt field and course must offer a variety of Classic jumps with different appearances such as: natural post and rail, stone wall, white board fence or gate, coop, aiken, hedge, oxer, brush, logs, natural foliage.
2. Natural obstacles such as banks and ditches are allowed.
3. A minimum of 2" difference is required for the back element of all oxers.
4. Ground lines are not to exceed 18" in depth from the vertical plane of the jump. For appropriate jumps, no ground line is necessary.
5. The jumpable portion of any fence must be a minimum of 8 feet on its front face
6. The top element of all jumps must be in cups except for walls with movable bricks.
7. Flat cups may only be used for log fences and in accordance with Federation rules.
8. Distances will not be adjusted for ponies.
9. Fence height 3'0"
10. There must be four option fences set at 3'5". If there is a difference in difficulty between any two tracks containing height options, the higher options should include the more inviting, less difficult track.

## First Round: Classic Hunter Course

1. A minimum of ten obstacles must be offered in the Classic Hunter Round.

2. At least three of the following types of fences must be utilized: natural post and rail, stone wall, white board fence, riviera gate, coop, aiken, hedge, brush or logs.
3. At least one in and out
4. At least one bending line
5. At least one line with an unrelated distance
6. At least one long approach

## Second Round: Handy Hunter Course

1. A minimum of eight obstacles must be offered in the Handy Hunter Round.
2. At least three of the following types of fences must be utilized: natural post and rail, stone wall, white board fence, riviera gate, coop, aiken, hedge, brush or logs.
3. The course should simulate riding over hunt country and must have a minimum of two handy options, such as: tight turns, different tracks, clever options for jump approaches, pen type obstacles, hand gallop a jump, trot a lowered obstacle not to exceed 2'6" in height, halt and/or back. Gimmicky options are not appropriate.
4. Unless the prize list states that more than twelve (12) entries are to return for the second round, then only the top twelve (12) horses from the first round, after all ties are broken, are eligible to return for the second round..

## Awards and HOTY Points Specifications

1. All riders in the top twelve overall (or their designated representative if not available) must ride for ribbons to receive prize money. Although not required, a show may choose to award separate ribbons for the first-round if so stated in the prize list.
2. For National Hunter Derby Zone HOTY points to be awarded, riders must complete a USHJA Exhibitor Declaration Form prior to the conclusion of the competition.
3. Points accrued by horses shown by Professionals may be awarded to the declared Green Hunter 3'0", Green Hunter 3'3", Performance Hunter 3'3", Small Hunter, Young Hunter 5 and under- 2'9", Young Hunter 6 and under- 3', or Young Hunter 7 and under- 3'3".
4. Points accrued by horses shown by Juniors or Amateurs may be awarded to the declared Green Hunter 3'0", Green Hunter 3'3" Performance Hunter 3'3", or the applicable Children's, Pony, Adult Amateur, Amateur Owner 3'3", Small Hunter or Junior Hunter 3'3, Young Hunter 5 and under- 2'9", Young Hunter 6 and under- 3', or Young Hunter 7 and under- 3'3".



## Judging System

1. The first round shall be judged on performance, hunter pace, jumping style, quality and substance, and movement. After the judge(s) base score is given, one (1) point will be added for each high option fence jumped. The Option Bonus Score of one additional point must be awarded even if there is a refusal, rail down or loss of good jumping style at that higher height option fence, providing that the horse-and-rider combination does jump the higher height option fence. (Maximum of four points.)
2. The second round shall be judged on performance, hunter pace, jumping style, quality and substance, movement, handiness and brilliance of pace. Handiness is defined as ground saving movement without adversely affecting performance or style. Brilliance of pace is defined as a faster pace than ordinary, without sacrificing performance or style. Handiness is taken into account in the judges' base score. After the judge(s) base score is given, one (1) point will be added for each high option fence jumped. The Option Bonus Score of one additional point must be awarded even if there is a refusal, rail down or loss of good jumping style at that higher height option fence, providing that the horse-and-rider combination does jump the higher height option fence. (Maximum of four points.)

For Full USHJA National Hunter Derby Specifications see: <https://ushja.org/competition/hunter/national-hunter-derby>







# PACIFIC CREST OPEN

June 27 – June 30, 2024

USEF #332619

*Owner, trainer, and rider Jennifer Wagner-Worley and Coronado  
Luxury DerbyCross, 2023 Pacific Crest Open*



# SCHEDULES: PACIFIC CREST OPEN

June 27 – June 30, 2024

## 2024 Pacific Crest Open

Thursday, June 27, 2024

### Grand Hunter Arena

*Presented by Ariat International*

#### 8:00 AM

670	Warm-Up Hunter 3'6"
325	Green Hunter 3'6"
326	Green Hunter 3'6" Handy
310	Performance Hunter 3'6"
311	Performance Hunter 3'6" Handy
327	Green Hunter 3'6" U/S
312	Performance Hunter 3'6" U/S
660	Warm-Up Hunter 3'3"
315	Performance Hunter 3'3"
316	Performance Hunter 3'3" Handy
330	Green Hunter 3'3"
331	Green Hunter 3'3" Handy
345, 346	Young Hunter 3'3" - Horses 7 & Under
317	Performance Hunter 3'3" U/S
332	Green Hunter 3'3" U/S
347	Young Hunter 3'3" - Horses 7 & Under U/S
650	Warm-Up Hunter 3'
335	Green Hunter 3'
336	Green Hunter 3' Handy
350, 351	Young Hunter 3' - Horses 6 & Under
515, 516	Large Hunter 3'
480, 481	USHJA 3' Hunter
455, 456	Thoroughbred Hunter 3'
337	Green Hunter 3' U/S
352	Young Hunter 3' - Horses 6 & Under U/S
517	Large Hunter 3' U/S
457	Thoroughbred Hunter 3' U/S
482	USHJA 3' Hunter U/S
640	Warm-Up Hunter 2'9"
355, 356	Young Hunter 2'9" - Horses 5 & Under
475, 476	USHJA 2'9" Hunter
477	USHJA 2'9" Hunter U/S
357	Young Hunter 2'9" - Horses 5 & Under U/S
630	Warm-Up Hunter 2'6"
470, 471	USHJA 2'6" Hunter
535, 536	Baby Green Hunter 2'6"
472	USHJA 2'6" Hunter U/S
537	Baby Green Hunter 2'6" U/S
620	Warm-Up Hunter 2'3"
465, 466	USHJA 2'3" Hunter
467	USHJA 2'3" Hunter U/S
610	Warm-Up Hunter 2'
460, 461	USHJA 2' Hunter
462	USHJA 2' Hunter U/S

### Cascade Hunter Arena

*Presented by WA State Hunter Jumper Association*

#### 8:00 AM

1215, 1216	USHJA Outreach Hunters 18"
1217	USHJA Outreach Hunters 18" U/S
1220, 1221	USHJA Outreach Hunters 2'
1222	USHJA Outreach Hunters 2' U/S
1225	USHJA Outreach Hunters 2'3" U/S
1226, 1227	USHJA Outreach Hunters 2'3"
1230, 1231	USHJA Outreach Hunters 2'6"
1232	USHJA Outreach Hunters 2'6" U/S
1235	USHJA Outreach Hunters 2'9" U/S
1236, 1237	USHJA Outreach Hunters 2'9"
1240, 1241	USHJA Outreach Hunters 3'
1242	USHJA Outreach Hunters 3' U/S
1205	USHJA Outreach Hunters Walk/Trot Poles U/S
1210	USHJA Outreach Hunters Crossrail U/S
1206, 1207	USHJA Outreach Hunters Walk/Trot Poles
1211, 1212	USHJA Outreach Hunters Crossrail

### Grand Jumper Arena

*Presented by Farpoint Farm in honor of Kona Coast*

#### 8:00 AM

1400	USHJA Outreach Jumper .60m II.2b
1401	USHJA Outreach Jumper .60m IV.1
1410	USHJA Outreach Jumper .70m II.2b
1411	USHJA Outreach Jumper .70m IV.1
105	Jumper .70m IV.2
106	Jumper .70m
1420	USHJA Outreach Jumper .80m II.2b
1421	USHJA Outreach Jumper .80m IV.1
120	Jumper .80m II.1
121	Jumper .80m
1430	USHJA Outreach Jumper .90m II.2c
1431	USHJA Outreach Jumper .90m II.2d
140	Jumper .90m II.2c
141	Jumper .90m
250	Low Adult Amateur Jumper .90m II.2d
255	Low Children's Jumper .90m II.2d
1440, 1441	USHJA Outreach Jumper 1.00-1.05m
160	Jumper 1.00m II.2a/b
230	Thoroughbred Jumper 1.00m II.2d
200	PNW 5 Y/O Young Jumper 1.00m II.2d
260	Low Adult Amateur Jumper 1.00m II.2d
265	Low Children's Jumper 1.00m II.2d
1445, 1446	USHJA Outreach Jumper 1.10-1.15m
170	Jumper 1.10m II.2c
205	PNW 6 Y/O Young Jumper 1.10m II.2d
270	High Adult Amateur Jumper 1.10m II.2d
275	High Children's Jumper 1.10m II.2d
175	Jumper 1.15m II.2c
210	PNW 7 Y/O Young Jumper 1.15m II.2d
240	Mod. Junior/Amateur Jumper 1.15m II.2d
1450, 1451	USHJA Outreach Jumper 1.20m
180	Jumper 1.20m II.2c
245	Junior/Amateur Jumper 1.20m II.2d
<b>181</b>	<b>Cascade Welcome 1.20m II.2a/b</b>

*Presented by Cascade Partners*

# 2024 Pacific Crest Open

Friday, June 28, 2024

## Grand Hunter Arena

*Presented by Ariat International*

### 8:00 AM

- 651 Warm-Up Hunter 3'
- 730, 731 Equitation 14 & Under 3' O/F
- 733, 734 Equitation 15-17 3' O/F
- 724, 725 Adult Equitation 18-39 3' O/F
- 727, 728 Adult Equitation 40 & Over 3' O/F
- 732 Equitation 14 & Under 3' Not to jump
- 735 Equitation 15-17 3' Not to jump
- 726 Adult Equitation 18-39 3' Not to jump
- 729 Adult Equitation 40 & Over 3' Not to jump
- 801 WSHJA Good Hands & Seat 3'
- 661 Warm-Up Hunter 3'3"
- 807 USEF/NCEA Junior Hunter Seat Medal 3'3"
- 671 Warm-Up Hunter 3'6"
- 802 WSHJA Good Hands & Seat 3'6"
- 641 Warm-Up Hunter 2'9"
- 721, 722 Pre-Children's/Adult Equitation 2'9" O/F
- 723 Pre-Children's/Adult Equitation 2'9" Not to jump
- 631 Warm-Up Hunter 2'6"
- 715, 716 Low Children's Equitation 2'6" O/F
- 718, 719 Low Adult Equitation 2'6" O/F
- 800 WSHJA Good Hands & Seat 2'6"
- 717 Low Children's Equitation 2'6" Not to jump
- 720 Low Adult Equitation 2'6" Not to jump
- 680 Warm-Up Pony Hunter (respective heights)
- 700, 701 Pony Equitation 2'3", 2'6", 2'9"-3' O/F (respective heights)
- 702 Pony Equitation 2'3", 2'6", 2'9"-3' Not to jump
- 712, 713 Children's Pony Equitation 2', 2'3", 2'6" O/F (respective heights)
- 714 Children's Pony Equitation 2', 2'3", 2'6" Not to jump

### 11 Rosé All Day Amateur Classic

*Presented by Brass Ring Farm*

### 3 USHJA National Hunter Derby

*Presented by Brick Road Farms*

## Cascade Hunter Arena

*Presented by WA State Hunter Jumper Association*

### 8:00 AM

- 600 Warm-Up Hunter 18"
- 709, 710 Short Stirrup Equitation Pony 18" O/F
- 1218, 1219 USHJA Outreach Hunters 18"
- 1315 USHJA Outreach Equitation 18" O/F
- 1316 USHJA Outreach Equitation 18" Not to jump
- 711 Short Stirrup Equitation Pony 18" Not to jump
- 611 Warm-Up Hunter 2'
- 1223, 1224 USHJA Outreach Hunters 2'
- 1320 USHJA Outreach Equitation 2' O/F
- 1321 USHJA Outreach Equitation 2' Not to jump
- 706 Short Stirrup Equitation Horse 2'3" Not to jump
- 703 Long Stirrup Equitation 2'3" Not to jump
- 621 Warm-Up Hunter 2'3"
- 707, 708 Short Stirrup Equitation Horse 2'3" O/F
- 704, 705 Long Stirrup Equitation 2'3" O/F
- 1228, 1229 USHJA Outreach Hunters 2'3"
- 1325 USHJA Outreach Equitation 2'3" O/F
- 1326 USHJA Outreach Equitation 2'3" Not to jump
- 632 Warm-Up Hunter 2'6"
- 1233, 1234 USHJA Outreach Hunters 2'6"
- 1330 USHJA Outreach Equitation 2'6" O/F
- 1331 USHJA Outreach Equitation 2'6" Not to jump
- 1238, 1239 USHJA Outreach Hunters 2'9"
- 1335 USHJA Outreach Equitation 2'9" O/F
- 1336 USHJA Outreach Equitation 2'9" Not to jump
- 1243, 1244 USHJA Outreach Hunters 3'
- 1340 USHJA Outreach Equitation 3' O/F
- 1341 USHJA Outreach Equitation 3' Not to jump
- 1213, 1214 USHJA Outreach Hunters Crossrail
- 1310 USHJA Outreach Equitation Crossrail O/F
- 1311 USHJA Outreach Equitation Crossrail Not to jump
- 1300, 1301 USHJA Outreach Walk, Trot Equitation Not to jump

## Grand Jumper Arena

*Presented by Farpoint Farm in honor of Kona Coast*

### 8:00 AM

- 814 USHJA Jumping Seat Medal 3'3"
- 161 Jumper 1.00m II.1
- 231 Thoroughbred Jumper 1.00m II.1
- 201 PNW 5 Y/O Young Jumper 1.00m II.2b
- 261 Low Adult Amateur Jumper 1.00m II.1
- 266 Low Children's Jumper 1.00m II.1
- 1447 USHJA Outreach Jumper 1.10-1.15m
- 171 Jumper 1.10m II.2b
- 206 PNW 6 Y/O Young Jumper 1.10m II.2b
- 271 High Adult Amateur Jumper 1.10m II.2b
- 276 High Children's Jumper 1.10m II.1
- 176 Jumper 1.15m II.1
- 211 PNW 7 Y/O Young Jumper 1.15m II.2b
- 241 Mod. Junior/Amateur Jumper 1.15m II.2b
- 1452 USHJA Outreach Jumper 1.20m
- 182 Jumper 1.20m
- 246 Junior/Amateur Jumper 1.20m
- 1402 USHJA Outreach Jumper .60m II.2b
- 1403 USHJA Outreach Jumper .60m II.1
- 107 Jumper .70m II.2b
- 108 Jumper .70m II.1
- 1412 USHJA Outreach Jumper .70m II.2b
- 1413 USHJA Outreach Jumper .70m II.1
- 122 Jumper .80m II.2b
- 123 Jumper .80m II.1
- 1422 USHJA Outreach Jumper .80m II.2b
- 1423 USHJA Outreach Jumper .80m II.1
- 142 Jumper .90m II.2b
- 251 Low Adult Amateur Jumper .90m II.1
- 256 Low Children's Jumper .90m II.1
- 1432 USHJA Outreach Jumper .90m II.2b
- 1433 USHJA Outreach Jumper .90m II.1
- 1442 USHJA Outreach Jumper 1.00-1.05m



# 2024 Pacific Crest Open

Saturday, June 29, 2024

## Grand Hunter Arena

*Presented by Ariat International*

### 8:00 AM

- 805 Hamel Foundation NHS Medal 3'3"
- 803 ASPCA Maclay Horsemanship Medal 3'6"
- 804 Dover Saddlery/USEF Hunter Seat Medal 3'6"
- 425, 426 Adult Amateur Hunter 18-39 3'
- 430, 431 Adult Amateur Hunter 40 & Over 3'
- 809 Ariat National Adult Medal 3'
- 813 OHJA Adult Medal 3'
- 435, 436 Children's Hunter 13 & Under 3'
- 440, 441 Children's Hunter 14-17 3'
- 808 Taylor Harris Insurance National Children's Medal 3'
- 812 OHJA Children's Medal 3'
- 520, 521 Pre-Children's/Adult Hunter 2'9"
- 525, 526 Low Children's Hunter 2'6"
- 530, 531 Low Adult Hunter 2'6"
- 811 OHJA Mini Medal 2'6"
- 527 Low Children's Hunter 2'6" U/S
- 532 Low Adult Hunter 2'6" U/S
- 810 Marshall & Sterling U.S. Pony Medal 2'3", 2'6", 2'9"-3' (respective heights)
- 410, 411 Pony Hunter (Large) 2'9"-3'
- 412 Pony Hunter (Large) 2'9"-3' U/S
- 410, 411 Pony Hunter (Medium) 2'6"
- 412 Pony Hunter (Medium) 2'6" U/S
- 410, 411 Pony Hunter (Small) 2'3"
- 412 Pony Hunter (Small) 2'3" U/S
- 445, 446 Children's Hunter Pony 2', 2'3", 2'6" (respective heights)
- 447 Children's Hunter Pony 2', 2'3", 2'6" U/S (respective heights)

### 17 Cascade Canine Derby

*Presented by Evolution Equestrian*

## Cascade Hunter Arena

*Presented by WA State Hunter Jumper Association*

### 8:00 AM

- 1302, 1303 USHJA Outreach Walk, Trot Equitation Not to jump
- 1312, 1313 USHJA Outreach Equitation Crossrail O/F
- 505, 506 Short Stirrup Hunter Pony 17 & Under 18"
- 1317, 1318 USHJA Outreach Equitation 18" O/F
- 1322, 1323 USHJA Outreach Equitation 2' O/F
- 500, 501 Short Stirrup Hunter Horse 17 & Under 2'3"
- 510, 511 Long Stirrup Hunter 18 & Over 2'3"
- 1327, 1328 USHJA Outreach Equitation 2'3" O/F
- 1332, 1333 USHJA Outreach Equitation 2'6" O/F
- 1337, 1338 USHJA Outreach Equitation 2'9" O/F
- 1342, 1343 USHJA Outreach Equitation 3' O/F

### 1203 USHJA Outreach Hunt & Handy

## Grand Jumper Arena

*Presented by Farpoint Farm in honor of Kona Coast*

### 8:00 AM

- 1404 USHJA Outreach Jumper .60m II.2b
- 1405 USHJA Outreach Jumper .60m IV.1
- 109 Jumper .70m II.2b
- 1414 USHJA Outreach Jumper .70m II.2b
- 1415 USHJA Outreach Jumper .70m II.1
- 124 Jumper .80m II.1
- 1424 USHJA Outreach Jumper .80m II.2b
- 1425 USHJA Outreach Jumper .80m IV.1
- 143 Jumper .90m II.2b
- 252 Low Adult Amateur Jumper .90m II.1
- 257 Low Children's Jumper .90m II.1
- 1434 USHJA Outreach Jumper .90m II.2b
- 1435 USHJA Outreach Jumper .90m II.1
- 1443 USHJA Outreach Jumper 1.00-1.05m
- 162 Jumper 1.00m II.2b
- 232 Thoroughbred Jumper 1.00m
- 202 PNW 5 Y/O Young Jumper 1.00m
- 262 Low Adult Amateur Jumper 1.00m II.1
- 267 Low Children's Jumper 1.00m II.1
- 1448 USHJA Outreach Jumper 1.10-1.15m
- 172 Jumper 1.10m II.2b
- 207 PNW 6 Y/O Young Jumper 1.10m
- 272 High Adult Amateur Jumper 1.10m II.2b
- 277 High Children's Jumper 1.10m II.2b
- 177 Jumper 1.15m II.2b
- 212 PNW 7 Y/O Young Jumper 1.15m
- 242 Mod. Junior/Amateur Jumper 1.15m Stake II.1
- 1453 USHJA Outreach Jumper 1.20m
- 183 Jumper 1.20m II.2b
- 247 Junior/Amateur Jumper 1.20m Stake II.1
- 16

### Rising Stars™ Leadline

*Presented by Kerrits Equestrian*

### 4 Pacesetter Mini Prix II.2a

*Presented by Pacesetter Properties Team*

# 2024 Pacific Crest Open

Sunday, June 30, 2024

## Grand Hunter Arena

*Presented by Ariat International*

### 8:00 AM

- 25 **Luxury DerbyCross™ 3-3'3"**  
*Presented by Beluxari Eq*
- 427, 428 Adult Amateur Hunter 18-39 3'
- 432, 433 Adult Amateur Hunter 40 & Over 3'
- 437, 438 Children's Hunter 13 & Under 3'
- 442, 443 Children's Hunter 14-17 3'
- 33 **Children's Hunter Classic 3'**  
*Presented by Voltaire Design*
- 70 **Adult Hunter Classic 3'**  
*Presented by Voltaire Design*
- 429 Adult Amateur Hunter 18-39 3' U/S
- 434 Adult Amateur Hunter 40 & Over 3' U/S
- 439 Children's Hunter 13 & Under 3' U/S
- 444 Children's Hunter 14-17 3' U/S
- 522, 523 Pre-Children's/Adult Hunter 2'9"
- 31 **Pre-Children's/Adult Hunter Classic 2'9"**  
*Presented by Cascade Partners*
- 524 Pre-Children's/Adult Hunter 2'9" U/S
- 528, 529 Low Children's Hunter 2'6"
- 533, 534 Low Adult Hunter 2'6"
- 32 **Low Children's/Adult Hunter Classic 2'6"**  
*Presented by Sterling Essentials*
- 413 Pony Hunter (Large) 2'9"-3'
- 414 Pony Hunter (Large) 2'9"-3' Handy
- 413 Pony Hunter (Medium) 2'6"
- 414 Pony Hunter (Medium) 2'6" Handy
- 413 Pony Hunter (Small) 2'3"
- 414 Pony Hunter (Small) 2'3" Handy
- 30 **Pony Hunter Classic 2'3", 2'6", 2'9"-3'** (respective heights)  
*Presented by Kaidyn Griggs*
- 448, 449 Children's Hunter Pony 2', 2'3", 2'6" (respective heights)
- 34 **Children's Hunter Pony Classic 2', 2'3", 2'6"** (respective heights)  
*Presented by Forest Park Saddlery*

## Cascade Hunter Arena

*Presented by WA State Hunter Jumper Association*

### 8:00 AM

- 1201 **USHJA Outreach Hunter Derby 2'-2'3"**
- 1200 **USHJA Outreach Hunter Derby 2'6"-2'9"**  
*Presented by Sharkey Farm*
- 502, 503 Short Stirrup Hunter Horse 17 & Under 2'3"
- 512, 513 Long Stirrup Hunter 18 & Over 2'3"
- 35 **Short/Long Stirrup Hunter Classic 2'3"**  
*Presented by Dianna Connelly Insurance*
- 504 Short Stirrup Hunter Horse 17 & Under 2'3" U/S
- 514 Long Stirrup Hunter 18 & Over 2'3" U/S
- 507 Short Stirrup Hunter Pony 17 & Under 18" U/S
- 508, 509 Short Stirrup Hunter Pony 17 & Under 18"
- 36 **Short Stirrup Hunter Pony Classic 18"**  
*Presented by Horsin' Around Cookie Company*

## Grand Jumper Arena

*Presented by Farpoint Farm in honor of Kona Coast*

### 8:00 AM

- 25 **Luxury DerbyCross™ .90m**  
*Presented by Beluxari Eq*
- 20 **Need for Speed™ Open Jumper 1.10m III**  
*Presented by Voltaire Design*
- 20 **Need for Speed™ Open Jumper 1.20m III**  
*Presented by Voltaire Design*
- 64 **Open Jumper Classic 1.00m III**  
*Presented by WSHJA*
- 263 Low Adult Amateur Jumper 1.00m Stake II.2b
- 268 Low Children's Jumper 1.00m Stake II.2b
- 63 **Open Jumper Classic .90m III**  
*Presented by Sundance Equestrian*
- 253 Low Adult Amateur Jumper .90m Stake II.2b
- 258 Low Children's Jumper .90m Stake II.2b
- 60 **Open Jumper Classic .60m, .70m, .80m**  
*Presented by Narrows Equestrian*
- 1455 **USHJA Outreach Jumper Classic**  
*Presented by the Lake Washington Saddle Club*





# CASCADE FINALS

September 5 - 8, 2024  
USEF #334509

*Brooklyn Thurman and Hinkapy Van Teigenloo  
Luxury DerbyCross, 2023 Cascade Finals  
Owner and trainer: Amalia Roemy*

# SCHEDULES: CASCADE FINALS

September 5-8, 2024

## 2024 Cascade Finals

Thursday, September 5, 2024

### Grand Hunter Arena

*Presented by Ariat International*

#### 8:00 AM

- 670 Warm-Up Hunter 3'6"
- 325 Green Hunter 3'6"
- 326 Green Hunter 3'6" Handy
- 310 Performance Hunter 3'6"
- 311 Performance Hunter 3'6" Handy
- 327 Green Hunter 3'6" U/S
- 312 Performance Hunter 3'6" U/S
- 660 Warm-Up Hunter 3'3"
- 315 Performance Hunter 3'3"
- 316 Performance Hunter 3'3" Handy
- 330 Green Hunter 3'3"
- 331 Green Hunter 3'3" Handy
- 345, 346 Young Hunter 3'3" - Horses 7 & Under
- 317 Performance Hunter 3'3" U/S
- 332 Green Hunter 3'3" U/S
- 347 Young Hunter 3'3" - Horses 7 & Under U/S
- 650 Warm-Up Hunter 3'
- 335 Green Hunter 3'
- 336 Green Hunter 3' Handy
- 350, 351 Young Hunter 3' - Horses 6 & Under
- 515, 516 Large Hunter 3'
- 480, 481 USHJA 3' Hunter
- 455, 456 Thoroughbred Hunter 3'
- 337 Green Hunter 3' U/S
- 352 Young Hunter 3' - Horses 6 & Under U/S
- 517 Large Hunter 3' U/S
- 457 Thoroughbred Hunter 3' U/S
- 482 USHJA 3' Hunter U/S
- 640 Warm-Up Hunter 2'9"
- 355, 356 Young Hunter 2'9" - Horses 5 & Under
- 475, 476 USHJA 2'9" Hunter
- 477 USHJA 2'9" Hunter U/S
- 357 Young Hunter 2'9" - Horses 5 & Under U/S
- 630 Warm-Up Hunter 2'6"
- 470, 471 USHJA 2'6" Hunter
- 535, 536 Baby Green Hunter 2'6"
- 472 USHJA 2'6" Hunter U/S
- 537 Baby Green Hunter 2'6" U/S
- 620 Warm-Up Hunter 2'3"
- 465, 466 USHJA 2'3" Hunter
- 467 USHJA 2'3" Hunter U/S
- 610 Warm-Up Hunter 2'
- 460, 461 USHJA 2' Hunter
- 462 USHJA 2' Hunter U/S

### Cascade Hunter Arena

*Presented by WA State Hunter Jumper Association*

#### 8:00 AM

- 1215, 1216 USHJA Outreach Hunters 18"
- 1217 USHJA Outreach Hunters 18" U/S
- 1220, 1221 USHJA Outreach Hunters 2'
- 1222 USHJA Outreach Hunters 2' U/S
- 1225 USHJA Outreach Hunters 2'3" U/S
- 1226, 1227 USHJA Outreach Hunters 2'3"
- 1230, 1231 USHJA Outreach Hunters 2'6"
- 1232 USHJA Outreach Hunters 2'6" U/S
- 1235 USHJA Outreach Hunters 2'9" U/S
- 1236, 1237 USHJA Outreach Hunters 2'9"
- 1240, 1241 USHJA Outreach Hunters 3'
- 1242 USHJA Outreach Hunters 3' U/S
- 1205 USHJA Outreach Hunters Walk/Trot Poles U/S
- 1210 USHJA Outreach Hunters Crossrail U/S
- 1206, 1207 USHJA Outreach Hunters Walk/Trot Poles
- 1211, 1212 USHJA Outreach Hunters Crossrail

### Grand Jumper Arena

*Presented by Farpoint Farm in honor of Kona Coast*

#### 8:00 AM

- 1400 USHJA Outreach Jumper .60m II.2b
- 1401 USHJA Outreach Jumper .60m IV.1
- 1410 USHJA Outreach Jumper .70m II.2b
- 1411 USHJA Outreach Jumper .70m IV.1
- 105 Jumper .70m IV.2
- 106 Jumper .70m
- 1420 USHJA Outreach Jumper .80m II.2b
- 1421 USHJA Outreach Jumper .80m IV.1
- 120 Jumper .80m II.1
- 121 Jumper .80m
- 1430 USHJA Outreach Jumper .90m II.2c
- 1431 USHJA Outreach Jumper .90m II.2d
- 140 Jumper .90m II.2c
- 141 Jumper .90m
- 250 Low Adult Amateur Jumper .90m II.2d
- 255 Low Children's Jumper .90m II.2d
- 1440, 1441 USHJA Outreach Jumper 1.00-1.05m
- 160 Jumper 1.00m II.2a/b
- 230 Thoroughbred Jumper 1.00m II.2d
- 200 PNW 5 Y/O Young Jumper 1.15m II.2d
- 260 Low Adult Amateur Jumper 1.00m II.2d
- 265 Low Children's Jumper 1.00m II.2d
- 1445, 1446 USHJA Outreach Jumper 1.10-1.15m
- 170 Jumper 1.10m II.2c
- 205 PNW 6 Y/O Young Jumper 1.25m II.2d
- 270 High Adult Amateur Jumper 1.10m II.2d
- 275 High Children's Jumper 1.10m II.2d
- 175 Jumper 1.15m II.2c
- 210 PNW 7 Y/O Young Jumper 1.30m II.2d
- 240 Mod. Junior/Amateur Jumper 1.15m II.2d
- 1450, 1451 USHJA Outreach Jumper 1.20m
- 180 Jumper 1.20m II.2c
- 245 Junior/Amateur Jumper 1.20m II.2d
- 181 Cascade Welcome 1.20m II.2a/b**

*Presented by Cascade Partners*



# 2024 Cascade Finals

Friday, September 6, 2024

## Grand Hunter Arena

*Presented by Ariat International*

### 8:00 AM

- 651 Warm-Up Hunter 3'
- 730, 731 Equitation 14 & Under 3' O/F
- 733, 734 Equitation 15-17 3' O/F
- 724, 725 Adult Equitation 18-39 3' O/F
- 727, 728 Adult Equitation 40 & Over 3' O/F
- 732 Equitation 14 & Under 3' Not to jump
- 735 Equitation 15-17 3' Not to jump
- 726 Adult Equitation 18-39 3' Not to jump
- 729 Adult Equitation 40 & Over 3' Not to jump
- 801 WSHJA Good Hands & Seat 3'
- 661 Warm-Up Hunter 3'3"
- 807 USEF/NCEA Junior Hunter Seat Medal 3'3"
- 671 Warm-Up Hunter 3'6"
- 802 WSHJA Good Hands & Seat 3'6"
- 641 Warm-Up Hunter 2'9"
- 721, 722 Pre-Children's/Adult Equitation 2'9" O/F
- 723 Pre-Children's/Adult Equitation 2'9" Not to jump
- 631 Warm-Up Hunter 2'6"
- 715, 716 Low Children's Equitation 2'6" O/F
- 718, 719 Low Adult Equitation 2'6" O/F
- 800 WSHJA Good Hands & Seat 2'6"
- 717 Low Children's Equitation 2'6" Not to jump
- 720 Low Adult Equitation 2'6" Not to jump
- 680 Warm-Up Pony Hunter (respective heights)
- 700, 701 Pony Equitation 2'3", 2'6", 2'9"-3' O/F (respective heights)
- 702 Pony Equitation 2'3", 2'6", 2'9"-3' Not to jump
- 712, 713 Children's Pony Equitation 2', 2'3", 2'6" O/F (respective heights)
- 714 Children's Pony Equitation 2', 2'3", 2'6" Not to jump

### 11 Rosé All Day Amateur Classic

*Presented by Cascade Partners*

### 3 USHJA National Hunter Derby

*Presented by Brick Road Farms*

## Cascade Hunter Arena

*Presented by WA State Hunter Jumper Association*

### 8:00 AM

- 600 Warm-Up Hunter 18"
- 709, 710 Short Stirrup Equitation Pony 18" O/F
- 1218, 1219 USHJA Outreach Hunters 18"
- 1315 USHJA Outreach Equitation 18" O/F
- 1316 USHJA Outreach Equitation 18" Not to jump
- 711 Short Stirrup Equitation Pony 18" Not to jump
- 611 Warm-Up Hunter 2'
- 1223, 1224 USHJA Outreach Hunters 2'
- 1320 USHJA Outreach Equitation 2' O/F
- 1321 USHJA Outreach Equitation 2' Not to jump
- 706 Short Stirrup Equitation Horse 2'3" Not to jump
- 703 Long Stirrup Equitation 2'3" Not to jump
- 621 Warm-Up Hunter 2'3"
- 707, 708 Short Stirrup Equitation Horse 2'3" O/F
- 704, 705 Long Stirrup Equitation 2'3" O/F
- 1228, 1229 USHJA Outreach Hunters 2'3"
- 1325 USHJA Outreach Equitation 2'3" O/F
- 1326 USHJA Outreach Equitation 2'3" Not to jump
- 632 Warm-Up Hunter 2'6"
- 1233, 1234 USHJA Outreach Hunters 2'6"
- 1330 USHJA Outreach Equitation 2'6" O/F
- 1331 USHJA Outreach Equitation 2'6" Not to jump
- 1238, 1239 USHJA Outreach Hunters 2'9"
- 1335 USHJA Outreach Equitation 2'9" O/F
- 1336 USHJA Outreach Equitation 2'9" Not to jump
- 1243, 1244 USHJA Outreach Hunters 3'
- 1340 USHJA Outreach Equitation 3' O/F
- 1341 USHJA Outreach Equitation 3' Not to jump
- 1213, 1214 USHJA Outreach Hunters Crossrail
- 1310 USHJA Outreach Equitation Crossrail O/F
- 1311 USHJA Outreach Equitation Crossrail Not to jump
- 1300, 1301 USHJA Outreach Walk, Trot Equitation Not to jump

## Grand Jumper Arena

*Presented by Farpoint Farm in honor of Kona Coast*

### 8:00 AM

- 814 USHJA Jumping Seat Medal 3'3"
- 161 Jumper 1.00m II.1
- 231 Thoroughbred Jumper 1.00m II.1
- 201 PNW 5 Y/O Young Jumper 1.15m II.2b
- 261 Low Adult Amateur Jumper 1.00m II.1
- 266 Low Children's Jumper 1.00m II.1
- 1447 USHJA Outreach Jumper 1.10-1.15m
- 171 Jumper 1.10m II.2b
- 206 PNW 6 Y/O Young Jumper 1.25m II.2b
- 271 High Adult Amateur Jumper 1.10m II.2b
- 276 High Children's Jumper 1.10m II.1
- 176 Jumper 1.15m II.1
- 211 PNW 7 Y/O Young Jumper 1.30m II.2b
- 241 Mod. Junior/Amateur Jumper 1.15m II.2b
- 1452 USHJA Outreach Jumper 1.20m
- 182 Jumper 1.20m
- 246 Junior/Amateur Jumper 1.20m
- 1402 USHJA Outreach Jumper .60m II.2b
- 1403 USHJA Outreach Jumper .60m II.1
- 107 Jumper .70m II.2b
- 108 Jumper .70m II.1
- 1412 USHJA Outreach Jumper .70m II.2b
- 1413 USHJA Outreach Jumper .70m II.1
- 122 Jumper .80m II.2b
- 123 Jumper .80m II.1
- 1422 USHJA Outreach Jumper .80m II.2b
- 1423 USHJA Outreach Jumper .80m II.1
- 142 Jumper .90m II.2b
- 251 Low Adult Amateur Jumper .90m II.1
- 256 Low Children's Jumper .90m II.1
- 1432 USHJA Outreach Jumper .90m II.2b
- 1433 USHJA Outreach Jumper .90m II.1
- 1442 USHJA Outreach Jumper 1.00-1.05m

# 2024 Cascade Finals

Saturday, September 7, 2024

## Grand Hunter Arena

*Presented by Ariat International*

### 8:00 AM

- 805 Hamel Foundation NHS Medal 3'3"
- 803 ASPCA Maclay Horsemanship Medal 3'6"
- 804 Dover Saddlery/USEF Hunter Seat Medal 3'6"
- 425, 426 Adult Amateur Hunter 18-39 3'
- 430, 431 Adult Amateur Hunter 40 & Over 3'
- 809 Ariat National Adult Medal 3'
- 813 OHJA Adult Medal 3'
- 435, 436 Children's Hunter 13 & Under 3'
- 440, 441 Children's Hunter 14-17 3'
- 808 Taylor Harris Insurance National Children's Medal 3'
- 812 OHJA Children's Medal 3'
- 520, 521 Pre-Children's/Adult Hunter 2'9"
- 525, 526 Low Children's Hunter 2'6"
- 530, 531 Low Adult Hunter 2'6"
- 811 OHJA Mini Medal 2'6"
- 527 Low Children's Hunter 2'6" U/S
- 532 Low Adult Hunter 2'6" U/S
- 810 Marshall & Sterling U.S. Pony Medal 2'3", 2'6", 2'9"-3' (respective heights)
- 410, 411 Pony Hunter (Large) 2'9"-3'
- 412 Pony Hunter (Large) 2'9"-3' U/S
- 410, 411 Pony Hunter (Medium) 2'6"
- 412 Pony Hunter (Medium) 2'6" U/S
- 410, 411 Pony Hunter (Small) 2'3"
- 412 Pony Hunter (Small) 2'3" U/S
- 445, 446 Children's Hunter Pony 2', 2'3", 2'6" (respective heights)
- 447 Children's Hunter Pony 2', 2'3", 2'6" U/S (respective heights)

### 17 Cascade Canine Derby

*Presented by Evolution Equestrian*

## Cascade Hunter Arena

*Presented by WA State Hunter Jumper Association*

### 8:00 AM

- 1302, 1303 USHJA Outreach Walk, Trot Equitation Not to jump
- 1312, 1313 USHJA Outreach Equitation Crossrail O/F
- 505, 506 Short Stirrup Hunter Pony 17 & Under 18"
- 1317, 1318 USHJA Outreach Equitation 18" O/F
- 1322, 1323 USHJA Outreach Equitation 2' O/F
- 500, 501 Short Stirrup Hunter Horse 17 & Under 2'3"
- 510, 511 Long Stirrup Hunter 18 & Over 2'3"
- 1327, 1328 USHJA Outreach Equitation 2'3" O/F
- 1332, 1333 USHJA Outreach Equitation 2'6" O/F
- 1337, 1338 USHJA Outreach Equitation 2'9" O/F
- 1342, 1343 USHJA Outreach Equitation 3' O/F

### 1203 USHJA Outreach Hunt & Handy

## Grand Jumper Arena

*Presented by Farpoint Farm in honor of Kona Coast*

### 8:00 AM

- 1404 USHJA Outreach Jumper .60m II.2b
- 1405 USHJA Outreach Jumper .60m IV.1
- 109 Jumper .70m II.2b
- 1414 USHJA Outreach Jumper .70m II.2b
- 1415 USHJA Outreach Jumper .70m II.1
- 124 Jumper .80m II.1
- 1424 USHJA Outreach Jumper .80m II.2b
- 1425 USHJA Outreach Jumper .80m IV.1
- 143 Jumper .90m II.2b
- 252 Low Adult Amateur Jumper .90m II.1
- 257 Low Children's Jumper .90m II.1
- 1434 USHJA Outreach Jumper .90m II.2b
- 1435 USHJA Outreach Jumper .90m II.1
- 1443 USHJA Outreach Jumper 1.00-1.05m
- 162 Jumper 1.00m II.2b
- 232 Thoroughbred Jumper 1.00m
- 202 PNW 5 Y/O Young Jumper 1.15m
- 262 Low Adult Amateur Jumper 1.00m II.1
- 267 Low Children's Jumper 1.00m II.1
- 1448 USHJA Outreach Jumper 1.10-1.15m
- 172 Jumper 1.10m II.2b
- 207 PNW 6 Y/O Young Jumper 1.25m
- 272 High Adult Amateur Jumper 1.10m II.2b
- 277 High Children's Jumper 1.10m II.2b
- 177 Jumper 1.15m II.2b
- 212 PNW 7 Y/O Young Jumper 1.30m
- 242 Mod. Junior/Amateur Jumper 1.15m Stake II.1
- 1453 USHJA Outreach Jumper 1.20m
- 183 Jumper 1.20m II.2b
- 247 Junior/Amateur Jumper 1.20m Stake II.1

### 16 Rising Stars™ Leadline

*Presented by Kerrits Equestrian*

### 5 Cascade Mini Prix II.2a

*Presented by TNT Farrier Services*



# 2024 Cascade Finals

Sunday, September 8, 2024

## Grand Hunter Arena

*Presented by Ariat International*

### 8:00 AM

- 25 **Luxury DerbyCross™ 3-3'3"**  
*Presented by Beluxari Eq*
- 427, 428 Adult Amateur Hunter 18-39 3'
- 432, 433 Adult Amateur Hunter 40 & Over 3'
- 437, 438 Children's Hunter 13 & Under 3'
- 442, 443 Children's Hunter 14-17 3'
- 33 **Children's Hunter Classic 3'**  
*Presented by Voltaire Design*
- 70 **Adult Hunter Classic 3'**  
*Presented by Voltaire Design*
- 429 Adult Amateur Hunter 18-39 3' U/S
- 434 Adult Amateur Hunter 40 & Over 3' U/S
- 439 Children's Hunter 13 & Under 3' U/S
- 444 Children's Hunter 14-17 3' U/S
- 522, 523 Pre-Children's/Adult Hunter 2'9"
- 31 **Pre-Children's/Adult Hunter Classic 2'9"**  
*Presented by Cascade Partners*
- 524 Pre-Children's/Adult Hunter 2'9" U/S
- 528, 529 Low Children's Hunter 2'6"
- 533, 534 Low Adult Hunter 2'6"
- 32 **Low Children's/Adult Hunter Classic 2'6"**  
*Presented by Sterling Essentials*
- 413 Pony Hunter (Large) 2'9"-3'
- 414 Pony Hunter (Large) 2'9"-3' Handy
- 413 Pony Hunter (Medium) 2'6"
- 414 Pony Hunter (Medium) 2'6" Handy
- 413 Pony Hunter (Small) 2'3"
- 414 Pony Hunter (Small) 2'3" Handy
- 30 **Pony Hunter Classic 2'3", 2'6", 2'9"-3'** (respective heights)  
*Presented by Kaidyn Griggs*
- 448, 449 Children's Hunter Pony 2', 2'3", 2'6" (respective heights)
- 34 **Children's Hunter Pony Classic 2', 2'3", 2'6"** (respective heights)  
*Presented by Forest Park Saddlery*

## Cascade Hunter Arena

*Presented by WA State Hunter Jumper Association*

### 8:00 AM

- 1201 **USHJA Outreach Hunter Derby 2'-2'3"**
- 1200 **USHJA Outreach Hunter Derby 2'6"-2'9"**  
*Presented by Sharkey Farm*
- 502, 503 Short Stirrup Hunter Horse 17 & Under 2'3"
- 512, 513 Long Stirrup Hunter 18 & Over 2'3"
- 35 **Short/Long Stirrup Hunter Classic 2'3"**  
*Presented by Dianna Connelly Insurance*
- 504 Short Stirrup Hunter Horse 17 & Under 2'3" U/S
- 514 Long Stirrup Hunter 18 & Over 2'3" U/S
- 507 Short Stirrup Hunter Pony 17 & Under 18" U/S
- 508, 509 Short Stirrup Hunter Pony 17 & Under 18"
- 36 **Short Stirrup Hunter Pony Classic 18"**  
*Presented by Horsin' Around Cookie Company*

## Grand Jumper Arena

*Presented by Farpoint Farm in honor of Kona Coast*

### 8:00 AM

- 25 **Luxury DerbyCross™ .90m**  
*Presented by Beluxari Eq*
- 20 **Need for Speed™ Open Jumper 1.10m III**  
*Presented by Voltaire Design*
- 20 **Need for Speed™ Open Jumper 1.20m III**  
*Presented by Voltaire Design*
- 64 **Open Jumper Classic 1.00m III**
- 263 Low Adult Amateur Jumper 1.00m Stake II.2b
- 268 Low Children's Jumper 1.00m Stake II.2b
- 63 **Open Jumper Classic .90m III**  
*Presented by Sundance Equestrian*
- 253 Low Adult Amateur Jumper .90m Stake II.2b
- 258 Low Children's Jumper .90m Stake II.2b
- 60 **Open Jumper Classic .60m, .70m, .80m**
- 1455 **USHJA Outreach Jumper Classic**  
*Presented by the Lake Washington Saddle Club*

# Rated Entry for 2024 Pacific Crest Open June 27 – June 30

Closing Date of Entries: May 31, 2024

Owner		Rider One		Trainer	
Horse Owner Name	Rider Name	Trainer Name			
Address	Address	Farm/Business Name			
City	City	Address			
State/Province	State/Province	City	State/Province	Zip/PC	
Zip/PC	Date of Birth	USEF Age	ASPCA #		
Phone	Phone	USEF #	USHJA #		
USEF #	USEF #	USEF #	USHJA #		
USHJA #	USHJA #	USHJA #	USHJA #		
Email	Email	Email			
<b>Recipient of Prize Money Awards</b>		<b>Rider Two</b>		<b>Stabling, Fees and Payment Information</b>	
Individual or Corporation Name	Rider Name	<b>EVERYONE MUST SIGN: Mandatory Liability Releases</b>			
Social Security # or Federal Tax ID #	Address	<b>Horse / Tack Stall \$295</b>			
Address	City	State/Province	Zip/PC	<b>Stabling: Tues 10 am - Sun 7 pm included</b>	
City	Date of Birth	USEF Age	ASPCA #	<b>Sun night: \$50 additional</b>	
State/Province	Phone	USEF #	USHJA #		
Zip/PC	USEF #	USHJA #			
Phone	USEF #	USHJA #			
Email	Email				
<b>Horse</b>		<b>Horse/Pony Description</b>		<b>Non-Showing Horse: Stall fees + \$150 per show</b>	
Horse Name	USEF #	Breed	Is Pony?	<b>Haul-in Fee: \$50/horse/day   \$150 horse/show</b>	
USHJA #	USHJA #	Age	Color	<b>Warm-up / Schooling Fee: \$35</b>	
Horse Annual Date	Sunday Stay-over?	Non-Showing?	Sex	<b>Per-stall Manure Disposal / Garbage Fee: \$50</b>	
Prefer to be Stabled With: (if other than Trainer)	Horse to Primarily Compete In (check all that apply):	<input type="checkbox"/> Hunter competition	Jockey Club Registry #	<b>Office Fee: \$50</b>	
		<input type="checkbox"/> Jumper competition	Measurement Card #	<b>Hunter / Jumper Nominating Fee: \$60</b>	
<b>Entry Agreement (sign all other releases at CascadeHorseShows.com)</b>					
 <p><b>US Equestrian Federation Entry Agreement</b></p> <p>By entering a Federation-licensed competition and signing this entry blank as the Owner, Lessee, Trainer, Manager, Agent, Coach, Driver, Rider, Handler, Vaultor or Longeur and on behalf of myself and my principals, representatives, employees and agents, I agree that I am subject to the Bylaws and Rules of the United States Equestrian Federation, Inc. (the "Federation") and the local rules of Cascade Horse Shows (competitively, employees and agents, I agree to be bound by the Bylaws and Rules of the Federation, and of the competition. I will accept as final the decision of the Hearing Committee on any question arising under the Rules, and agree to release and hold harmless the competition, the Federation, their officials, directors and employees for any action taken under the Rules. I represent that I am eligible to enter and/or participate under the Rules, and every horse I am entering is eligible as entered. I also agree that as a condition of and in consideration of acceptance of entry, the Federation and/or the competition may use or assign photographs, videos, audios, cable casts, broadcasts, internet, film, new media or other likenesses of me and my horse taken during the course of the competition for the promotion, coverage or benefit of the competition, sport, or the Federation. Those likenesses shall not be used to advertise a product and they may not be used in such a way as to jeopardize amateur status. I hereby expressly and irrevocably waive and release any rights in connection with such use, including any claim to compensation, invasion of privacy, right of publicity, or to misappropriation. The construction and application of Federation rules are governed by the laws of the State of New York, and any action instituted against the Federation must be filed in New York State. See GI909.4.</p> <p>If not currently a USEF Active Competing member or Subscriber, I acknowledge that I will be enrolled for no cost as a USEF Fan and my USEF Fan Account will continue to annually automatically renew in USEF's sole discretion. Additionally, I acknowledge that the benefits of a USEF Fan are subject to change without notice. USEF may in its sole discretion, at any time, terminate my USEF Fan status.</p> <p>BY SIGNING BELOW, I AGREE that I have read, understand, and agree to be bound by all applicable Federation Bylaws, rules, and policies including the USEF Safe Sport Policy and Minor Athlete Abuse Prevention Policies (MAAAP) as published at www.usef.org, as amended from time to time, as well as all terms and provisions of this Prize List. If I am signing and submitting this Agreement electronically, I acknowledge that my electronic signature shall have the same validity, force and effect as if I affixed my signature by my own hand.</p>					
<b>Owner/Agent</b>		<b>Rider</b>		<b>Trainer</b>	
Signature (Parent/Guardian required if minor)	Rider One Signature (Parent/Guardian required if minor)	US Citizen?	Signature		
Print Name	Rider Two Signature (Parent/Guardian required if minor)	US Citizen?	Emergency Contact Phone #		
<p>Checks payable to: Cascade Horse Shows</p> <p>Cascade Horse Shows, 1612 207th Ave NE, Sammamish, WA 98074   <a href="http://www.cascadehorsheshows.com">www.cascadehorsheshows.com</a></p> <p>Pre-order on website: <a href="http://Shavings/Hay/Feed/">Shavings/Hay/Feed/</a>, request RV Site, Golf Cart</p> <p>Show Secretary: Lauren Wasserman   360.573.4360   <a href="mailto:office@cascadehorsheshows.com">office@cascadehorsheshows.com</a></p>					
				<b>\$345 Competition Deposit Required per Show</b>	
				NON REFUNDABLE after close date	
				Signature Authorizing Payment	
				Billing Address	
				Name on Card (Please print)	
				CCV #	
				Zip/PC	
				Signature	
				Print Name	



Owner				Rider One				Trainer					
Horse Owner Name				Rider Name				Trainer Name					
Address				Address				Farm/Business Name					
City	State/Province	Zip/PC		City	State/Province	Zip/PC		Address					
Phone	USEF #	USHJA #		Date of Birth	USEF Age	ASPCA #		City	State/Province	Zip/PC			
Email				Phone	USEF #	USHJA #		Phone	USEF #	USHJA #			
				Email				Email					
Recipient of Prize Money Awards				Rider Two				Stabling, Fees and Payment Information					
Individual or Corporation Name				Rider Name				<b>EVERYONE MUST SIGN: Mandatory Liability Releases</b>  <b>Horse / Tack Stall \$295</b>  Stabling: Tues 10 am - Sun 7 pm included Sun night: \$50 additional  Non-Showing Horse: Stall fees + \$150 per show Haul-in Fee: \$50/horse/day   \$150 horse/show Warm-up / Schooling Fee: \$35 Per-stall Manure Disposal / Garbage Fee: \$50 Office Fee: \$50 Hunter / Jumper Nominating Fee: \$60					
Social Security # or Federal Tax ID #				Address									
Address				City									
City				State/Province									
Phone				Date of Birth				ASPCA #					
Email				Phone				USHJA #					
Horse				Horse/Pony Description									
Horse Name				Breed		Is Pony?		Height		Green Status			
USEF #				Age		Sex		Color		Measurement Card #			
USHJA #				Sunday Stay-over?		Jockey Club Registry #		Hunter competition <input type="checkbox"/>		Jumper competition <input type="checkbox"/>			
Non-Showing?				Horse to Primarily Compete in (check all that apply):									
Entry Agreement (sign all other releases at <a href="http://CascadeHorseShows.com">CascadeHorseShows.com</a> )				<p><b>USHJA Outreach Entry Agreement</b>                      ENTRY AGREEMENT - Release, Assumption of Risk, Waiver, and Indemnification. This document waives important legal rights. Read it carefully before signing. I AGREE in consideration for my participation in this Competition to the following: I AGREE that the "Competition" as used herein includes the USHJA and Competition Management, as well as all of their officials, officers, directors, employees, agents, personnel, volunteers and affiliates. I AGREE that I choose to participate voluntarily in the Competition with my horse, as a rider, handler, longeur, lessee, owner, agent, coach, trainer, or as parent or guardian of a junior exhibitor. I am fully aware and acknowledge that horse sports and the Competition involve inherent dangerous risks of accident, loss, and serious bodily injury including broken bones, head injuries, trauma, pain, suffering, or death. ("Harm"). I AGREE to hold harmless and release the USHJA and the Competition from all claims for money damages or otherwise for any Harm to me or my horse and for any Harm of any nature caused by me or my horse to others, even if the Harm arises or results, directly or indirectly, from the negligence of the USHJA or the Competition. I AGREE to expressly assume all risks of Harm to me or my horse, including Harm resulting from the negligence of the USHJA or the Competition. I AGREE to indemnify (that is, to pay any losses, damages, or costs incurred by) the USHJA and the Competition and to hold them harmless with respect to claims for Harm to me or my horse, and for claims made by others for any Harm caused by me or my horse while at the Competition. I understand that I am entitled to wear protective equipment without penalty, and I acknowledge that the USHJA strongly encourages me to do so while WARNING that no protective equipment can guard against all injuries. If I am a parent or guardian of a junior exhibitor, I consent to the child's participation and AGREE to all of the above provisions and AGREE to assume all of the obligations of this Release on the child's behalf. I represent that I have the requisite training, coaching and abilities to safely compete in this competition.</p> <p>BY SIGNING BELOW, I AGREE to be bound by the terms and provisions of this entry blank and all terms submitting this Agreement.</p>									
Signature (Parent/Guardian required if minor) Signature (Parent/Guardian required if minor)				Signature Signature				Signature Signature					
Print Name Print Name				US Citizen? US Citizen?				US Citizen? US Citizen?					
Checks payable to: Cascade Horse Shows Cascade Horse Shows, 1612 207th Ave NE, Sammamish, WA 98074   <a href="http://www.cascadehorseshow.com">www.cascadehorseshow.com</a>				Show Secretary: Lauren Wasserman   360.573.4360   <a href="mailto:office@cascadehorseshow.com">office@cascadehorseshow.com</a>				Pre-order on website: <a href="http://Shavines/Hay/Feed">Shavines/Hay/Feed</a> , request RV Site, <a href="http://Golf Car">Golf Car</a>					
Owner/Agent				Rider				Trainer					
Signature (Parent/Guardian required if minor)				Signature				Signature					
Print Name				Print Name				Print Name					
<b>\$345 Competition Deposit Required per Show</b> NON REFUNDABLE After Close Date													

# Rated Entry for 2024 Cascade Finals Sept. 5-8

Closing Date of Entries: August 9, 2024

Owner		Rider One		Trainer			
Horse Owner Name		Rider Name		Trainer Name			
Address		Address		Farm/Business Name			
City	State/Province	City	State/Province	Address	City		
	Zip/PC		Zip/PC	State/Province	Zip/PC		
Phone	USFE #	USFE #	USFE #	Phone	USFE #		
	USHIA #		USHIA #	Phone	USHIA #		
				Email			
<b>Recipient of Prize Money Awards</b>		<b>Rider Two</b>		<b>Stabling, Fees and Payment Information</b>			
Individual or Corporation Name		Rider Name		<b>EVERYONE MUST SIGN: Mandatory Liability Releases</b>			
Social Security # or Federal Tax ID #		Address					
Address	City	State/Province	Zip/PC				
City	State/Province	Date of Birth	USFE Age				
Phone	State/Province	Date of Birth	USFE Age	<b>Horse / Tack Stall \$295</b>			
	Zip/PC		USFE #	Stabling: Tues 10 am - Sun 7 pm included Sun night: \$50 additional			
Phone	Phone	Phone	USFE #	<b>Non-Showing Horse: Stall fees + \$150 per show</b> <b>Haul-in Fee: \$50/horse/day   \$150 horse/show</b> <b>Warm-up / Schooling Fee: \$35</b> <b>Per-stall Manure Disposal / Garbage Fee: \$50</b> <b>Office Fee: \$50</b> <b>Hunter / Jumper Nominating Fee: \$60</b>			
			USHIA #				
Email	Email						
<b>Horse</b>		<b>Horse/Pony Description</b>		<b>US Equestrian fee \$23 (drugs/meds \$15, USFE \$8)   USHIA fee \$2</b> <b>SHOW PASS FEES: USHIA \$30</b> Credit Card # - 3.5% convenience fee per transaction will be added for CC use. CC Exp Date      CCV #      Zip/PC Name on Card (please print) Billing Address Signature Authorizing Payment			
Horse Name	USFE #	Breed	Age			Color	Sex
	USHIA #						
Horse Annual Date	Non-Showing?	Size	S			M	L
	Sunday Stay-over?	Jockey Club Registry #	Measurement Card #	Green Status			
I Prefer to be Stabled With (if other than Trainer)		Horse to Primarily Compete in (check all that apply):		<input type="checkbox"/> Hunter competition <input type="checkbox"/> Jumper competition			
<b>Entry Agreement (sign all other releases at CascadeHorseShows.com)</b>							
 <b>US Equestrian Federation Entry Agreement</b>							
By entering a Federation-licensed Competition and signing this entry blank as the Owner, Lessee, Trainer, Manager, Agent, Coach, Driver, Rider, Handler, Vaultor or Longeur and on behalf of myself and my principals, representatives, employees and agents, I agree that I am subject to the Bylaws and Rules of the United States Equestrian Federation, Inc. (the "Federation") and the local rules of Cascade Horse Shows (Competition). I agree to be bound by the Bylaws and Rules of the Federation and of the competition. I will accept as final the decision of the Hearing Committee on any question arising under the Rules, and agree to release and hold harmless the competition, the Federation, their officials, directors and employees for any action taken under the Rules. I represent that I am eligible to enter and/or participate under the Rules, and every horse I am entering is eligible as entered. I also agree that as a condition of and in consideration of acceptance of entry, the Federation and/or the Competition may use or assign photographs, videos, audios, cable casts, broadcasts, internet, film, new media or other likenesses of me and my horse taken during the course of the competition for the promotion, coverage or benefit of the competition, sport, or the Federation. Those likenesses shall not be used to advertise a product and they may not be used in such a way as to jeopardize amateur status. I hereby expressly and irrevocably waive and release any rights in connection with such use, including any claim to compensation, invasion of privacy, right of publicity, or to misappropriation. The construction and application of Federation rules are governed by the laws of the State of New York, and any action instituted against the Federation must be filed in New York State. See GR908.4.							
If not currently a USFE Active Competing member or Subscriber, I acknowledge that I will be enrolled for no cost as a USFE Fan and my USFE Fan Account will continue to annually automatically renew in USFE's sole discretion. Additionally, I acknowledge that the benefits of a USFE Fan are subject to change without notice. USFE may in its sole discretion, at any time, terminate my USFE Fan status.							
BY SIGNING BELOW, I AGREE that I have read, understand, and agree to be bound by all applicable Federation Bylaws, rules, and policies including the USFE Safe Sport Policy and Minor Athlete Abuse Prevention Policies (MAAAP) as published at www.usfe.org, as amended from time to time, as well as all terms and provisions of this Prize List. If I am signing and submitting this Agreement electronically, I acknowledge that my electronic signature shall have the same validity, force and effect as if I affixed my signature by my own hand.							
<b>Owner/Agent</b>		<b>Rider</b>		<b>Trainer</b>			
Signature (Parent/Guardian required if minor)		Rider One Signature (Parent/Guardian required if minor)		Signature			
Print Name		Rider Two Signature (Parent/Guardian required if minor)		Emergency Contact Phone #			
Checks payable to: Cascade Horse Shows Cascade Horse Shows, 1612 207th Ave NE, Sammamish, WA 98074   <a href="http://www.cascadehorsheshows.com">www.cascadehorsheshows.com</a>		US Citizen?		Pre-order on website: <a href="http://Shavings/Hay/Feed/">Shavings/Hay/Feed/</a> , request RV Site, Golf Car Show Secretary: Lauren Wasserman   360.573.4360   <a href="mailto:office@cascadehorsheshows.com">office@cascadehorsheshows.com</a>			
		US Citizen?		Signature			
		US Citizen?		Print Name			



Owner			Rider One			Trainer		
Horse Owner Name			Rider Name			Trainer Name		
Address			Address			Farm/Business Name		
City	State/Province	Zip/PC	City	State/Province	Zip/PC	Address	State/Province	Zip/PC
Phone	USEF #	USHJA #	Date of Birth	USEF Age	ASPCA #	City	USEF #	USHJA #
Email			Phone	USEF #	USHJA #	Phone	USEF #	USHJA #
			Email			Email		
Recipient of Prize Money Awards			Rider Two			Stabling, Fees and Payment Information		
Individual or Corporation Name			Rider Name			<b>EVERYONE MUST SIGN: Mandatory Liability Releases</b>  <b>Horse / Tack Stall \$295</b>  Stabling: Tues 10 am - Sun 7 pm included Sun night: \$50 additional  Non-Showing Horse: Stall fees + \$150 per show Haul-in Fee: \$50/horse/day   \$150 horse/show Warm-up / Schooling Fee: \$35 Per-stall Manure Disposal / Garbage Fee: \$50 Office Fee: \$50 Hunter / Jumper Nominating Fee: \$60		
Social Security # or Federal Tax ID #			Address					
Address			City					
City			State/Province					
State/Province			USEF Age			QTY:		
Zip/PC			USEF #			Stabling: Tues 10 am - Sun 7 pm included		
Phone			USEF #			Sun night: \$50 additional		
Email			Email			Non-Showing Horse: Stall fees + \$150 per show		
Horse			Horse/Pony Description					
Horse Name	USEF #	Breed	Age	Color	Sex	Height	Is Pony?	
USHJA #	Non-Showing?	Size	S	M	L	Jockey Club Registry #	Measurement Card #	
Horse Arrival Date	Sunday Stay-over?	Horse to Primarily Compete in (check all that apply): <input type="checkbox"/> Hunter competition <input type="checkbox"/> Jumper competition						
(Prefer to be Stabled With (if other than Trainer))								
Entry Agreement (sign all other releases at CascadeHorseShows.com)								
<b>USHJA Outreach Entry Agreement</b> ENTRY AGREEMENT - Release, Assumption of Risk, Waiver, and Indemnification. This document waives important legal rights. Read it carefully before signing. I AGREE in consideration for my participation in this Competition to the following: I AGREE that the "Competition" as used herein includes the USHJA and Competition Management, as well as all of their officials, officers, directors, employees, agents, personnel, volunteers and affiliates. I AGREE that I choose to participate voluntarily in the Competition with my horse, as a rider, handler, longeur, lessee, owner, agent, coach, trainer, or as parent or guardian of a junior exhibitor. I am fully aware and acknowledge that horse sports and the Competition involve inherent dangerous risks of accident, loss, and serious bodily injury including broken bones, head injuries, trauma, pain, suffering, or death. ("Harm"). I AGREE to hold harmless and release the USHJA and the Competition from all claims for money damages or otherwise for any Harm to me or my horse and for any Harm of any nature caused by me or my horse to others, even if the Harm arises or results, directly or indirectly, from the negligence of the USHJA or the Competition. I AGREE to expressly assume all risks of Harm to me or my horse, including Harm resulting from the negligence of the USHJA or the Competition. I AGREE to indemnify (that is, to pay any losses, damages, or costs incurred by) the USHJA and the Competition and to hold them harmless with respect to claims for Harm to me or my horse, and for claims made by others for any Harm caused by me or my horse while at the Competition. I understand that I am entitled to wear protective equipment without penalty, and I acknowledge that the USHJA strongly encourages me to do so while WARNING that no protective equipment can guard against all injuries. If I am a parent or guardian of a junior exhibitor, I consent to the child's participation and AGREE to all of the above provisions and AGREE to assume all of the obligations of this Release on the child's behalf. I represent that I have the requisite training, coaching and abilities to safely compete in this competition.								
BY SIGNING BELOW, I AGREE to be bound by the terms and provisions of this entry blank and all terms submitting this Agreement.								
Owner/Agent			Rider			Trainer		
Signature (Parent/Guardian required if minor)			Signature			Signature		
Print Name			Signature			Print Name		
Rider One Signature (Parent/Guardian required if minor)			US Citizen?			Signature		
Rider Two Signature (Parent/Guardian required if minor)			US Citizen?			Emergency Contact Phone #		
Checks payable to: Cascade Horse Shows <b>Cascade Horse Shows, 1612 207th Ave NE, Sammamish, WA 98074   <a href="http://www.cascadehorseshow.com">www.cascadehorseshow.com</a></b>								
Pre-order on website: <a href="http://Shavings/Hav/Feed">Shavings/Hav/Feed</a> , request <a href="http://RV Site">RV Site</a> , <a href="http://Golf Car">Golf Car</a> <b>Show Secretary:</b> Lauren Wasserman   360.573.4360   <a href="mailto:office@cascadehorseshow.com">office@cascadehorseshow.com</a>						<b>\$345 Competition Deposit Required per Show</b> NON REFUNDABLE after close date		



## RELEASE OF LIABILITY FOR PROPERTY DAMAGE, PERSONAL INJURY OR DEATH

I choose to participate voluntarily in Equine Activities, as that term is defined in the [Revised Code of Washington \(RCW\) 4.24.530\(2\)](#), at the **Washington State Horse Park** ("WSHP"). The WSHP is an equine activity sponsor, as that term is defined in [RCW 4.24.530\(3\)](#). I am fully aware of and acknowledge that Equine Activities involve inherent dangerous risks of accident, loss, and serious bodily injury including broken bones, head injuries, trauma, pain, suffering or death ("Harm").

I agree to release WSHP Authority and the individual WSHP Board members and the WSHP Foundation and the individual WSHP Foundation Board Members, their agents, assigns, employees and contractors and members, the City of Cle Elum and Sun Communities (hereinafter collectively referred to as the "Released Parties") from all claims for money damages or loss for any Harm to me, my injury or death, the injury or death of my child(ren) named below ("Child") or my horse or for any Harm caused by me or my horse to others, even if the Harm, directly or indirectly, resulted from the negligence of the Released Parties.

I agree to expressly assume all risks of Harm to me or my child or my horse.

I agree to indemnify the Released Parties and to hold them harmless from all claims, causes of action and money damages resulting from Harm to me, my Child, or my horse while I am participating in Equine Activities at the WSHP facility.

*Under Washington State law, except as provided in RCW 4.24.540(2), an equine activity sponsor or an equine professional shall not be liable for an injury or the death of a participant engaged in an equine activity, and, except as provided in subsection(s) of this section, no participant nor participant's representative may maintain an action against or recover from an equine activity sponsor or an equine professional for an injury to or the death of a participant engaged in an equine activity.*

I have read and understand the Rules and Regulations of WSHP that are posted on the WSHP property. I understand these rules and regulations of WSHP will be changed from time to time and I agree to abide by the changed rules. I represent that I and/or my child have the requisite training, coaching and ability to participate safely in the activities we chose to pursue at WSHP.

## RELEASE OF PHOTOGRAPHIC AND VIDEO IMAGES

I hereby give permission to WSHP and those acting with its authority the unrestricted right and permission to use, publish and republish any photographic or video images of me and/or my horse for promotional and marketing purposes of the Horse Park. I also permit the use of any printed material in connection therewith and relinquish any right to review or restrict its use or publication.

I read and understand these Releases, and my handwritten or digital signature below signifies my acceptance of their terms and conditions. I agree these Releases shall remain in full force and effect until they are specifically revoked by me in writing or superseded by new releases issued by the Horse Park and signed by me. Electronic delivery of this document shall be legally binding, the same as delivery of an original.

Name of Event: \_\_\_\_\_ Event Date(s): \_\_\_\_\_

Participant's Name: \_\_\_\_\_ DOB if under 18: \_\_\_\_\_

Participant's Signature: \_\_\_\_\_ Date: \_\_\_\_\_

*If Event Participant is under 18 years of age, his/her parent must sign on his/her behalf below:*

Parent's Name: \_\_\_\_\_

Parent's Signature: \_\_\_\_\_ Date: \_\_\_\_\_

Signer's Home Address: \_\_\_\_\_

City: \_\_\_\_\_ State: \_\_\_\_\_ Zip Code: \_\_\_\_\_





# WAIVER AND RELEASE OF LIABILITY, ASSUMPTION OF RISK AND INDEMNITY AGREEMENT

For and in consideration of United States Equestrian Federation, Inc. dba US Equestrian (“USEF”) allowing me, the undersigned, to participate in any capacity (including as a rider, driver, handler, vaulter, longeur, lessee, owner, agent, coach, official, trainer or volunteer) in a USEF sanctioned, licensed or approved event or activity, including but not limited to equestrian clinics, practices, shows, competitions and related or incidental activities and \_\_\_\_\_ (“USEF Event” or “USEF Events”); I, for myself, and on behalf of my spouse, children, heirs and next of kin, and any legal and personal representatives, executors, administrators, successors,, and assigns, hereby agree to and make the following contractual representations pursuant to this Agreement (the “**Agreement**”):

A. **RULES AND REGULATIONS:** I hereby agree that I have read, understand, and agree to be bound by all applicable Federation Bylaws, rules, and policies including the USEF Safe Sport Policy and Minor Athlete Abuse Prevention Policies (MAAPP) as published at www.usef.org, as amended from time to time.

B. **ACKNOWLEDGMENT OF RISK:** I knowingly, willingly, and voluntarily acknowledge the inherent risks associated with the sport of equestrian and know that horseback riding and related equestrian activities are inherently dangerous, and that participation in any USEF Event involves risks and dangers including, without limitation, the potential for serious bodily injury (including broken bones, head or neck injuries), sickness and disease (including communicable diseases), trauma, pain & suffering, permanent disability, paralysis and death; loss of or damage to personal property (including my mount & equipment) arising out of the unpredictable behavior of horses; exposure to extreme conditions and circumstances; accidents involving other participants, event staff, volunteers or spectators; contact or collision with other participants and horses, natural or manmade objects; adverse weather conditions; facilities issues and premises conditions; failure of protective equipment (including helmets); inadequate safety measures; participants of varying skill levels; situations beyond the immediate control of the USEF Event organizers and competition management; and other undefined, not readily foreseeable and presently unknown risks and dangers (“**Risks**”).

**EQUINE ACTIVITY LIABILITY ACT WARNING:**

CAUTION: HORSEBACK RIDING AND EQUINE ACTIVITIES CAN BE DANGEROUS. RIDE AT YOUR OWN RISK.

**Under the laws of most States, an equine activity sponsor or equine professional is not liable for any injury to, or the death of, a participant in equine activities resulting from the inherent risks of equine activities.**

C. **ASSUMPTION OF RISK:** I understand that the aforementioned Risks may be caused in whole or in part or result directly or indirectly from the negligence of my own actions or inactions, the actions or inactions of others participating in the USEF Events, or the negligent acts or omissions of the Released Parties defined below, and I hereby voluntarily and knowingly assume all such Risks and responsibility for any damages, liabilities, losses, or expenses that I incur as a result of my participation in any USEF Events. I also agree to be responsible for any injury or damage caused by me, my horse, my employees or contractors under my direction and control at any USEF Event.

D. **WAIVER AND RELEASE OF LIABILITY, HOLD HARMLESS AND INDEMNITY:** In conjunction with my participation in any USEF Event, I hereby release, waive and covenant not to sue, and further agree to indemnify, defend and hold harmless the following parties: USEF, USEF Recognized Affiliate Associations, the United States Olympic & Paralympic Committee (USOPC), USEF clubs, members, Event participants (including athletes/riders, coaches, trainers, judges/officials, and other personnel), the Event owner, licensee, and competition managers; the promoters, sponsors, or advertisers of any USEF Event; any charity or other beneficiary which may benefit from the USEF Event; the owners, managers, or lessors of any facilities or premises where a USEF Event may be held; and all directors, officers, employees, agents, contractors, and volunteers of any of the aforementioned parties (**Individually and Collectively, the “Released Parties” or “Event Organizers”**), with respect to any liability, claim(s), demand(s), cause(s) of action, damage(s), loss, or expense (including court costs and reasonable attorney fees) of any kind or nature (“**Liability**”) which may arise out of, result from, or relate in any way to my participation in the USEF Events, including claims for Liability caused in whole or in part by the negligent acts or omissions of the Released Parties.

E. **COMPLETE AGREEMENT AND SEVERABILITY CLAUSE:** This Agreement represents the complete understanding between the parties regarding these issues and no oral representations, statements or inducements have been made apart from this Agreement. If any provision of this Agreement is held to be unlawful, void, or for any reason unenforceable, then that provision shall be deemed severable from this Agreement and shall not affect the validity and enforceability of any remaining provisions.

**I HAVE CAREFULLY READ THIS DOCUMENT IN ITS ENTIRETY, UNDERSTAND ALL OF ITS TERMS AND CONDITIONS, AND KNOW IT CONTAINS AN ASSUMPTION OF RISK, RELEASE AND WAIVER FROM LIABILITY, AS WELL AS A HOLD HARMLESS AND INDEMNIFICATION OBLIGATIONS.**

By signing below, I (as the participant or as the Parent/Legal Guardian of the minor identified below) hereby accept and agree to the terms and conditions of this Agreement in connection with my (or the minor’s) participation in any USEF Event. If, despite this Agreement, I, or anyone on my behalf or the minor’s behalf, makes a claim for Liability against any of the Released Parties, I will indemnify, defend and hold harmless each of the Released Parties from any such Liabilities as the result of such claim.

**The parties agree that this agreement may be electronically signed. The parties agree that the electronic signatures appearing on this agreement are the same as handwritten signatures for the purposes of validity, enforceability, and admissibility.**

RIDER/DRIVER/HANDLER/VAULTER/LONGEUR  OWNER  TRAINER  OFFICIAL  STAFF  VOLUNTEER  COACH (IF APPLICABLE)

Signature: \_\_\_\_\_ Date: \_\_\_\_\_ Print Name: \_\_\_\_\_

Parent/Guardian Signature: (Required if Rider/Driver/Handler/Vaulter/Longeur is a minor) \_\_\_\_\_ Date: \_\_\_\_\_

Print Parent//Guardian Name: \_\_\_\_\_ Emergency Contact Phone No. \_\_\_\_\_

11.16.23

UNITED STATES EQUESTRIAN FEDERATION : 4001 WING COMMANDER WAY : LEXINGTON, KY 40511 : 859.810.8733 : FAX 859.721.1151 : USEF.ORG

© United States Equestrian Federation® All rights reserved. Reproduction without permission is strictly prohibited.



# Credit Card Authorization Form for 2024 Shows

Please complete all fields. This authorization will remain in effect for the duration of the show season or until cancelled by the signer. The signer may cancel this authorization at any time by contacting: [office@cascadehorshesows.com](mailto:office@cascadehorshesows.com).

Responsible Party:  
(named on entry)

---

Name(s) of horse(s):  
(to credit funds to)

---

---

Credit Card Information	
Card Type	
<input type="checkbox"/> MasterCard	<input type="checkbox"/> VISA
<input type="checkbox"/> Discover	<input type="checkbox"/> AMEX
Cardholder Name (as shown on card)	
Card Number	
Expiration Date (MM/YY)	CVV Code
Cardholder Billing ZIP Code	

I, \_\_\_\_\_, authorize Cascade Horse Shows LLC to charge my credit card above for agreed upon charges. I understand that I will be charged a 3.5% credit card service charge and that my information will be saved on file for future transactions on my Cascade Horse Shows LLC account.

\_\_\_\_\_  
Customer Signature

\_\_\_\_\_  
Date

Please send completed authorizations to: [office@cascadehorshesows.com](mailto:office@cascadehorshesows.com)



# USHJA Zone 9 Specifications

(MT, WY, ID, OR, WA)



In accordance with GR1111.4: CA, NV, UT, CO, ND, SD, NE, and Canada are contiguous states.

## JUDGING FOR ALL HUNTER AND EQUITATION SECTIONS:

- To be judged on performance and soundness, suitability to count.
- Horses and Ponies are not required to jog for soundness.
- In Equitation: to be judged on performance, style, form and suitability of horse and rider to count

## ELIGIBILITY FOR ADULT AMATEURS: HUNTER, JUMPER AND EQUITATION:

- To be ridden by exhibitors who have reached their 18<sup>th</sup> birthday as of December 1 of the current competition year and who hold a current USEF Amateur certification. Open to horses and ponies.

## ELIGIBILITY FOR CHILDREN'S SECTIONS: HUNTER, JUMPER AND EQUITATION:

- To be ridden by exhibitors who have not reached their 18th birthday as of December 1 of the current competition year.

## ADULT AMATEUR HUNTER

**Sections offered and requirements:** • Adult Amateurs – may be split into three (3) sections **Cross Entry: Riders:** Amateur Owner Hunter riders may compete on a maximum of one (1) Adult Amateur Hunter horse that they own at the same competition. Riders may not show in any classes in which the fences are 3'9" and over at the same competition. **Horses:** Horses entered in Adult Amateur Hunter sections may not compete in the Amateur Owner Hunter sections at the same competition. **Horse and Rider Combination:** Horse and rider combinations may not cross enter into the Amateur Owner Hunter sections. **Fence height:** 3'0" with spreads not to exceed the fence height. Courses will not be adjusted for ponies. In and outs will be permitted **Combining/Dividing Sections:** Refer to HU137 **Awards:** Zone Horse of the Year Awards will be presented annually to the following sections: Adult Amateur Hunter 18- 39 Adult Amateur 40- 55 Adult Amateur 56 & over.

## LOW ADULT AMATEUR HUNTER

**Eligibility:** Open to exhibitors who have reached their 18th birthday as of December 1 of the current competition year. **Cross Entry: Riders:** Riders may not cross enter into any class or section at the same competition where fences exceed 2'9". **Fence Height:** 2'6" In and outs will not be permitted. **Combining/Dividing Sections:** The Low Adult Amateur Hunter and Low Children's Hunter sections may be combined if there are fewer than three (3) entries in either section. **Awards:** Zone Horse of the Year Awards will be presented annually to the following section: Low Adult Amateur Hunter

## AMATEUR JUMPER

**Sections offered and requirements:** 1.00/1.05m Amateur Jumper 1.10/1.15m Amateur Jumper **Cross Entry: Rider:** Riders may not show in any classes where the jumps exceed 1.20m. **Horse/Pony:** No cross entry restrictions. **Horse and Rider Combination:** 1.00/1.05m Amateur horse and rider combinations may not cross enter into the 1.10/1.15m Amateur Jumper section at the same competition. 1.10/1.15m Amateur horse and rider combinations may not cross enter into the 1.00/1.05m Amateur Jumper section at the same competition. **Fence Height:** Amateur Jumper: 1.00m to 1.05m Amateur Jumper: 1.10m to 1.15m **Combining/Dividing Sections:** Amateur Jumper sections may be divided by or combined with Junior Jumper sections, at competition management's discretion, if so stated in the prize list. **Awards:** Zone Horse of the Year Awards will be presented annually to the following sections: 1.00/1.05m Amateur Jumper 1.10/1.15m Amateur Jumper

## EQUITATION

### AGE GROUP EQUITATION: ADULT SECTION

**Sections Offered:** Adult Equitation 18- 39 Adult Equitation 40- 55 Adult Equitation 56 & Over **Cross Entry:** No cross entry restrictions into another section for horse and rider unless stated in the prize list. **Fence Height:** 2'9"- 3'6" with spreads not to exceed fence height Combinations will be permitted Management must state in the prize list, the height at which sections are being held. **Combining/Dividing Sections:** Refer to HU159. **Awards:** Zone Horse of the Year Awards will be presented annually to the following section: Adult Equitation 18- 39 Adult Equitation 40- 55 Adult Equitation 56 & Over.

## CHILDREN'S HUNTER HORSE

**Sections offered and requirements:** Children's Hunter Horse 13 & Under Children's Hunter Horse 14- 17 **Cross Entry: Rider:** Riders entered in the Children's Hunter section may not compete in the Junior Hunter section at the same competition. Riders may not show in any classes in which the fences are 3'9" and over at the same competition. **Horses/Ponies:** Horses entered in the Children's Hunter section may not compete in the Junior Hunter section at the same competition. **Horse and rider combination:** No cross entry restrictions **Fence Height:** 3'0" with spreads not to exceed fence height In and outs will be permitted **Combining/Dividing Sections:** Refer to HU141 **Awards:** Zone Horse of the Year Awards will be presented annually to the following sections: Children's Hunter Horse 13 & Under Children's Hunter Horse 14- 17

## LOW CHILDREN'S HUNTER HORSE

**Eligibility:** Open to exhibitors who have not yet reached their 18th birthday as of December 1 of the current competition year. **Cross Entry: Riders:** Riders may not cross enter at the same competition into any class/ section where fences exceed 2'9" **Fence Height:** 2'6" *In and outs will not be permitted.* **Combining/Dividing Sections:** The Low Children's Hunter and Low Adult Amateur Hunter sections may be combined if there are fewer than three (3) entries in either section. **Awards:** Zone Horse of the Year Awards will be presented annually to the following section: Low Children's Hunter Horse

## CHILDREN'S HUNTER PONY

**Sections offered and requirements:** Small/Medium Children's Pony Large Children's Pony **Cross Entry: Rider:** Children's Hunter Pony riders may compete on a maximum of one (1) Children's Hunter horse section at the same competition and in any class not to exceed 3'0" (Exception: Pony Jumpers). Green and Regular Hunter Pony riders may compete on a maximum of two (2) additional pony in the Children's Hunter Pony section at the same competition. **Horse/Pony:** Ponies may not cross enter into any other rated section at the same competition. **Horse and Rider Combination:** The same pony and rider may not cross enter into any other rated section at the same competition. **Fence Height:** In and outs will not be permitted Classes may run as one or split Small/Medium and Large to run at 2'0" and 2'6" respectively. **Combining/Dividing Sections:** Refer to HU141. **Awards:** Zone Horse of the Year Awards will be presented annually to the following sections: Children's Hunter Pony-Small/Medium Children's Hunter Pony-Large *Required distances for the Children's Hunter Pony sections:* 2'0" Small Children's Hunter Pony should be (based on 9'9" stride): 4 strides at 48'9"; 5 strides at 58'6"; 6 strides at 68'3"; 7 strides at 78'8"; 8 strides at 87'9". *2'0"* Medium Children's Hunter Pony should be (based on 10'3" stride): 4 strides at 51'3"; 5 strides at 61'6"; 6 strides at 71'9", 7 strides *at 82'2"*, 8 strides at 92'3". 2'6" Large Children's Hunter Pony should be (based on an 11" stride): 4 strides at 55"; 5 strides at 66'; 6 strides at 77'; 7 strides at 88'; 8 strides at 99'.

## JUNIOR JUMPER

**Sections offered and Requirements:** 1.00/1.05m Junior Jumper High Children's **Entry: Rider:** Riders may not show in any classes where the jumps exceed 1.20m, except Junior riders competing in FEI Children's classes and USEF Talent Search Class. **Horse/Pony** No cross entry restrictions **Horse and Rider Combination:** *1.00/1.05m Junior* horse and rider combinations may not cross enter into the *1.10/1.15m Junior* Jumpers at the same competition. *1.10/1.15m Junior* horse and rider combinations may not cross enter into the *1.00/1.05m Junior* Jumpers at the same competition. **Fence Height:** Junior Jumper: 1.00m to 1.05m Junior Jumper: 1.10m to 1.15m **Combining/Dividing Sections:** *Junior's* Jumper sections may be divided or combined with Amateur Jumper sections, at competition management's discretion, if so stated in the prize list. **Awards:** Zone Horse of the Year Awards will be presented annually to the following sections: 1.00/1.05m Junior Jumper 1.10/1.15m Junior Jumper

## AGE GROUP EQUITATION: CHILDREN'S/JUNIOR SECTION

**Sections Offered:** Equitation 11 & Under Equitation 12-14 Equitation 15-17 **Cross Entry:** No cross entry restrictions into another section for horse and rider unless stated in the prize list. **Fence Height:** Equitation 11 & Under: Minimum 2'6", maximum 3' - management must state height at which class will be offered. Management may offer multiple height options if stated in the prize list, but each course must be set at the same height throughout. o Combinations not permitted Equitation 12- 14: Minimum 2'9", maximum 3'3" - management must state height at which class will be offered. Management may offer multiple height options if stated in the prize list, but each course must be set at the same height throughout. o Combinations are optional Equitation 15- 17: Minimum 3'0", maximum 3'6" - management must state height at which class will be offered. Management may offer multiple height options if stated in the prize list, but each course must be set at the same height throughout. Combinations are optional **Combining/Dividing Sections:** Refer to HU159 **Awards:** Zone Horse of the Year Awards will be presented annually to the following sections: Equitation 11 & Under Equitation 12-14 Equitation 15-17



## USHJA COMPETITIVE PROGRAMS

For more information regarding the following programs please click on the links below:

Green Hunter Incentive Click [here](#) for full specifications

Hunter Team Challenge Click [here](#) for full specifications

International Hunter Derby Click [here](#) for full specifications National Hunter Derby Click [here](#) for full specifications

Outreach Click [here](#) for full specifications

Pony Hunter Derby Click [here](#) for full specifications

World Championship Hunter Rider Click [here](#) for full specifications

Zone Horse of the Year Championships

Please check individual [zone pages](#)

Zone Jumper Team Championships Click [here](#) for full specifications

1.0/1.05m Junior/Amateur Zone Jumper Championship Click [here](#) for full specifications

## SPECIAL CLASSES

3'3" Jumping Seat Medal Click [here](#) for full specifications

3'3" Hunter Seat Medal Click [here](#) for full specifications Green Hunter Challenge Click [here](#) for full specifications

Gladstone Cup Equitation Classic Click [here](#) for full specifications

Full Specs available at: <https://www.ushja.org/zones-affiliates/zone-9/specifications>.

*Cristina Larangeiro, FEI Level 3 Course Designer from Porto, Portugal, center, and Cascade Horse Shows Grounds Manager and partner Adam Chamberlin, left rear, pose with a tired but happy Cascade jump crew following the final round of the 2023 Pacific Crest Open.*



USEF Competition Name: Pacific Crest Open / Cascade Finals

USEF#: 332619 / 334509

Competition Division(s) and Rating(s):

USEF Regional Hunter (Channel 2), Jumper Rating 2



# MAAPP

## MINOR ATHLETE ABUSE PREVENTION

### LEARN ABOUT MAAP POLICIES



Safe Sport Training



Local Travel



One-On-One Interactions



Social Media & Electronic Communications



Read about these & more at [usef.org/MAAPP](https://usef.org/MAAPP)

### REPORT MAAP POLICY VIOLATIONS



[usef.org/safe-sport/reporting](https://usef.org/safe-sport/reporting)

859-225-6915 or Text Anonymously 855-682-8733





# CASCADE SPONSORS

Cascade Horse Shows gratefully thanks its proud sponsors

## Equestrian Brands & Commercial Sponsors

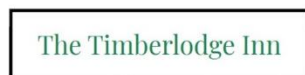

# CASCADE SPONSORS

Cascade Horse Shows gratefully thanks its proud sponsors

*Premium Show Stables & Individual Patrons*

