



CASCADE HORSE SHOWS

2026

JUNE 17-21

CASCADE CLASSIC

USEF National Hunter (Channel I), Jumper Rating 3

JUNE 24-28

CASCADE OPEN

USEF National Hunter (Channel II), Jumper Rating 3

USHJA Sanctioned Outreach Event

WASHINGTON STATE HORSE PARK, CLE ELUM WASHINGTON

CASCADEHORSESHOWS.COM

*Michelle Bion and Madges Lane Gem
celebrate their victory in the Barn Pros Grand Prix
during the 2025 Cascade Classic.*



**Flying over obstacles:
This is what trust is all about.**

Building a family legacy takes a lifetime. Maintaining it over generations takes our kind of expertise.

Experience tells us that perpetuating wealth is often as much about family dynamics as it is economics. For this reason we focus on your vision and values as tenaciously as we pursue solid returns. Our goal is to empower you, your family, your traditions and culture for generations to come. With Whittier Trust your lasting legacy begins today.

There is a tangible difference that the oldest and largest multi-family office headquartered in the West can mean for your legacy. Experience it. Talk to Lori Houston at (206) 834.1382.



Whittier Trust

Investment Management & Consulting | Trust Services | Family Office
Philanthropy & Family Continuity | Real Estate & Energy

SEATTLE OFFICE

520 PIKE STREET, SUITE 1415, SEATTLE, WA 98101
(206) 332.0836

PORTLAND OFFICE

111 S.W. FIFTH AVENUE, SUITE 3150, PORTLAND, OR 97294
(503) 444.3428



HORSEWARE®
IRELAND

Horse Therapy From Horseware

SPORTZ-VIBE MASSAGE THERAPY RUG



- Reduces pain and inflammation
- Improves blood supply to tissue
- Relaxes muscles
- Improves quality of life

www.sportzvibe.com



Massage Areas

ICE-VIBE CIRCULATION THERAPY



- Reduces soreness and swelling
- Helps boost circulation
- Stimulates healing
- Strengthens muscle tissue

www.icevibe.com

"We use the ICE-VIBE boots daily as part of our treatment plan on our grand prix horses."

-Richie Maloney *International Show Jumper*



www.horseware.com

TABLE OF CONTENTS

How to Enter	8
Horse Show Approvals	8
Directions to the Washington State Horse Park	8
US Equestrian Sections and Ratings	10
Horse Show Officials	12
Horse Show Fees	13
Facilities & Grounds	15
Important Policies of the Show	17
Rules & Regulations	20
2026 Cascade Classic	29
2026 Cascade Open	51
Entry Forms & Waivers	73
Specifications	79
Federation Page: Safe Sport/MAAPP	87

CASCADE SPONSORS

Cascade Horse Shows gratefully thanks its proud sponsors

Equestrian Brands & Commercial Sponsors

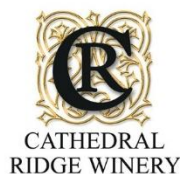

CASCADE SPONSORS

Cascade Horse Shows gratefully thanks its proud sponsors

Premium Show Stables & Individual Patrons

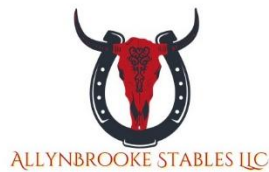



BARN PROS[®]

NATIONWIDE[®]

Luxury barn building packages refined since 1988

Residential | Equine | Shop

barnpros.com

HOW TO ENTER

[Stall reservations](#) are required for entry into the horse show (see page 17).

All entries must be submitted online.

After receiving confirmation of your stall reservation, you may enter online at [HorseSpot.net](https://www.horsecountry.com).



Entries received after the close of entries are considered post entries and will incur a \$50 late entry fee.

HORSE SHOW APPROVALS

United States Equestrian Federation (USEF) *Lexington, KY*

United States Hunter Jumper Association (USHJA) *Lexington, KY*

Washington State Hunter Jumper Association (WSHJA) *Sammamish, WA*

Oregon Hunter Jumper Association (OHJA) *Wilsonville, OR*

DIRECTIONS TO THE WASHINGTON STATE HORSE PARK

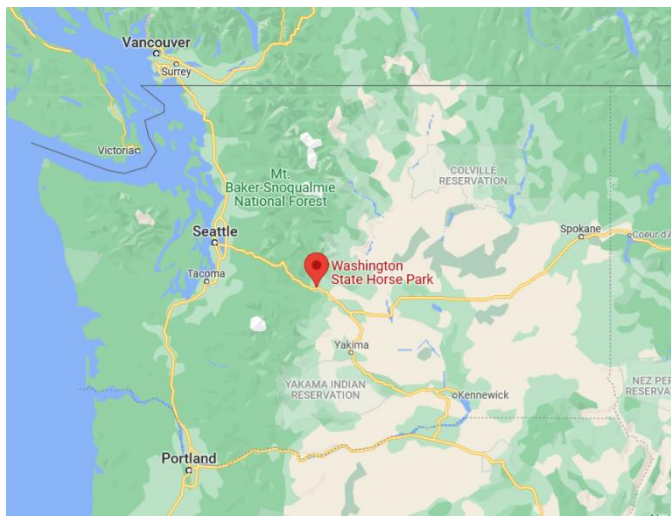

Map courtesy Google.

Washington State Horse Park

1202 Douglas Munro Blvd.
Cle Elum, WA 98922

The Horse Park is conveniently located off Interstate 90 in Cle Elum, Washington, approximately 80 miles from Seattle.

From I90 Westbound:

Take exit 84 from I-90 W toward Cle Elum
Right onto Oakes Ave 0.5 mi
Left onto W 2nd St 0.6 mi
Left onto Forest Service Rd 4517/Douglas Munro Blvd
Right onto Douglas Munro Blvd

From I90 Eastbound:

Take exit 84 from I-90 E toward Cle Elum/S Cle Elum
Continue onto W 1st St 361 ft
Turn left onto Douglas Munro Blvd 0.9 mi
Continue on Douglas Munro Blvd

HORSE SPOT

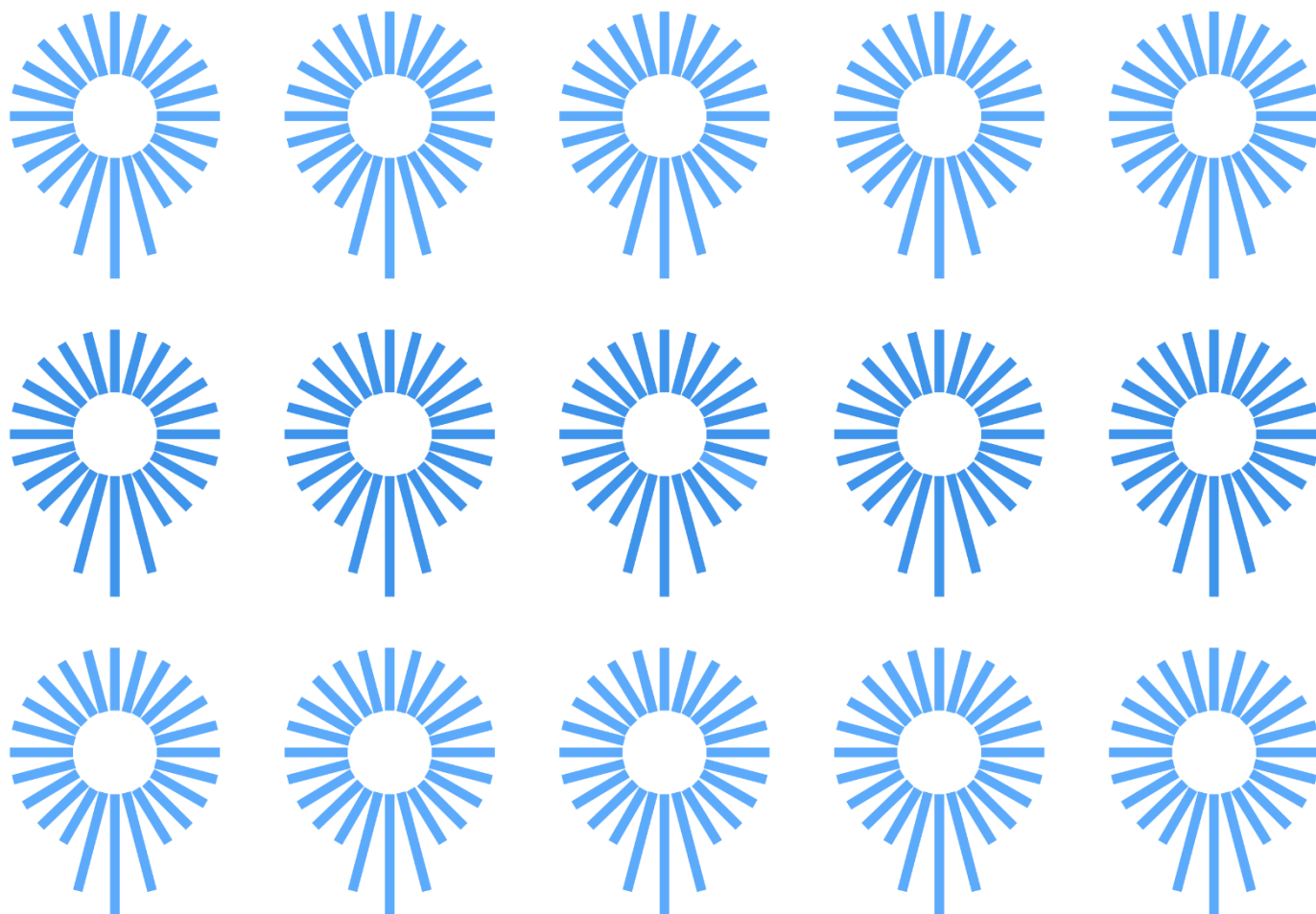

Ride & Shine to all exhibitors

Head to **HorseSpot.net** to discover schedules with real-time updates, live ringside results, posted orders, and important show information. Create a profile to submit entries, manage adds & scratches, and view personalized dashboards.

HAVE QUESTIONS? Support@HorseSpot.net

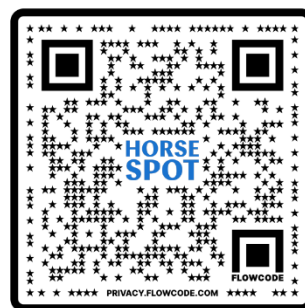

@HorseSpotShows on IG
@Horse Spot on Facebook

US EQUESTRIAN SECTIONS AND RATINGS

CASCADE CLASSIC | USEF #330219 | JUMPER 3

USEF Rated National: High Performance Hunter 3'9", Performance Hunter 3'3" & 3'6", Green Hunter 3', 3'3", 3'6", 3'9", Young Hunter 2'9", 3', 3'3", Amateur Owner Hunter 3'3" & 3'6", Junior Hunter 3'3" & 3'6", Pony Hunters

USEF Rated Regional II: Adult Amateur Hunter, Children's Hunter, Children's Hunter Pony, Small Hunter, Thoroughbred Hunter, USHJA Hunter 2', 2'3", 2'6", 2'9", 3'

CASCADE OPEN | USEF #332619 | JUMPER 3

USEF Rated Regional I: Performance Hunter 3'3", Green Hunter 3', 3'3", Young Hunter 2'9", 3', 3'3"

USEF Rated Regional II: Adult Amateur Hunter, Children's Hunter, Children's Hunter Pony, Thoroughbred Hunter, USHJA Hunter 2', 2'3", 2'6", 2'9", 3'



Victors Deisy Jimenez and Utmost (left) lead the winning field in the famous Cascade "V for victory" celebration following the USHA National Hunter Derby at the 2025 Cascade Open.

VOLTAIRE
DESIGN



PARTNER
OF THE
CASCADE HORSE SHOWS



HORSE SHOW OFFICIALS

Show Manager

JENNIFER HANSEN

Show Secretary

LAUREN WASSERMAN

Marketing, Sponsorships & Community Relations

JESSICA VANIA

Grounds Manager

TREVOR PETERSON

Website, Technology & Communications

GARY VOTH

Official Photographer

VIOLA MITCHELL

Horse Show Advisors

**CASCADE HORSE SHOWS
ADVISORY GROUP**

CASCADE CLASSIC

June 17-21, 2026

Judges, Hunter & Equitation

KATHRYN JONES, *Watkinsville, GA*

Judges, Jumper

MAX VON ZIMMERMAN, *Selah, WA*

Course Designers

MAX VON ZIMMERMAN, *Selah, WA*

NICK TIGHE, *Kirkville, NY*

Steward

BRIDGET IMPARATO-MONCADA, *Hollywood, FL*

Veterinarians

WA STATE UNIVERSITY

Farrier

KYLE LONG, (360) 927-2016

CASCADE OPEN

June 24-28, 2026

Judges, Hunter & Equitation

BRIDGET IMPARATO-MONCADA, *Hollywood, FL*

STEPHANIE SIEGEL, *East Port Orchard, WA*

Judges, Jumper

MAX VON ZIMMERMAN, *Selah, WA*

Course Designers

NICK TIGHE, *Kirkville, NY*

Steward

BRIDGET IMPARATO-MONCADA, *Hollywood, FL*

Veterinarian

WA STATE UNIVERSITY

Farrier

JOHN MAY, (253) 740-0917

HORSE SHOW FEES

Stall Fee: \$360

Non-Showing Horse Fee: \$175/show

Haul-In Fee: \$50/horse/day or \$150/horse/show

USEF Fee: \$10

USEF Equine Drug & Medication Fee: \$15

USEF Competing Membership Fee: \$100

USHJA Fee: \$10 (National), \$5 (Regional), \$5 (Outreach)

USHJA Show Pass Fee: \$30

RV Space: \$485 (Full hookup), \$375 (Partial hookup)

Tent / Dry Camp Space: \$150/week or \$25/night

Golf Cart Rental: \$600/week

Warm-Up / Schooling Fee: \$40

Office Fee: \$60

Sunday Stay-Over (prior to departure): \$50/stall, \$50/RV site

Per Stall Manure Disposal / Garbage Fee: \$60

Hunter / Jumper Nomination Fee: \$75

CLOSING DATES FOR ENTRIES

Entries received after closing dates will be charged a \$50 late entry fee.

Cascade Classic: **MAY 18, 2026**

Cascade Open: **MAY 18, 2026**

HORSE SHOW SERVICES

Show Office Hours

DAY PRECEDING SHOW: 10am – 5pm

DAYS OF SHOW: 7am¹ – 5pm²

¹ or 30 minutes prior to start of the first class

² or 30 minutes after the last regularly scheduled class ends

Concessions Provided By

ONSITE VENDORS

Golf carts

AVAILABLE FOR RENT

A limited number of golf carts are available for rent on a weekly basis during the show from Cascade Horse Shows. Requests can be made from our web site using [our online form](#). Availability is first come, first served until the limited supply is gone.

ONSITE RV POLICY

RV sites are available for request on a first-come, first-served basis, with consideration given for sponsors, multi-week stays and size of RV. Please use our online form at cascadehorsheshows.com to make requests. Choices are not guaranteed, and no requests are final until you receive emailed confirmation from the Show Office and render payment, if required. For cancellations, please see [Cancellations & Refunds](#), page 17.

All sites are assigned by Cascade Horse Shows and will be shared with you upon confirmation. Upon arrival, please find your site at the welcome center or Show Office should you need assistance. An RV Pass must be procured at the Show Office and prominently displayed. Full hookups include sewage + utilities. Partial hookups include utilities. Pump outs available (requires signup in the Show Office). Hookups with utilities may include 15-amp, 30-amp, or 50-amp power (varies by site). Availability of 50-amp hookups is limited. All sites have potable water. Charges apply whether hooked up to utilities or not.



Selling homes for horses and their people



Heidi Davalos

heidid@pacesetterproptiesteam.com

425.870.3334

Raquel Davalos

raquel@pacesetterproptiesteam.com

425.760.8600

Reilly Ochs

reilly@pacesetterproptiesteam.com

206.914.5254

FACILITIES & GROUNDS

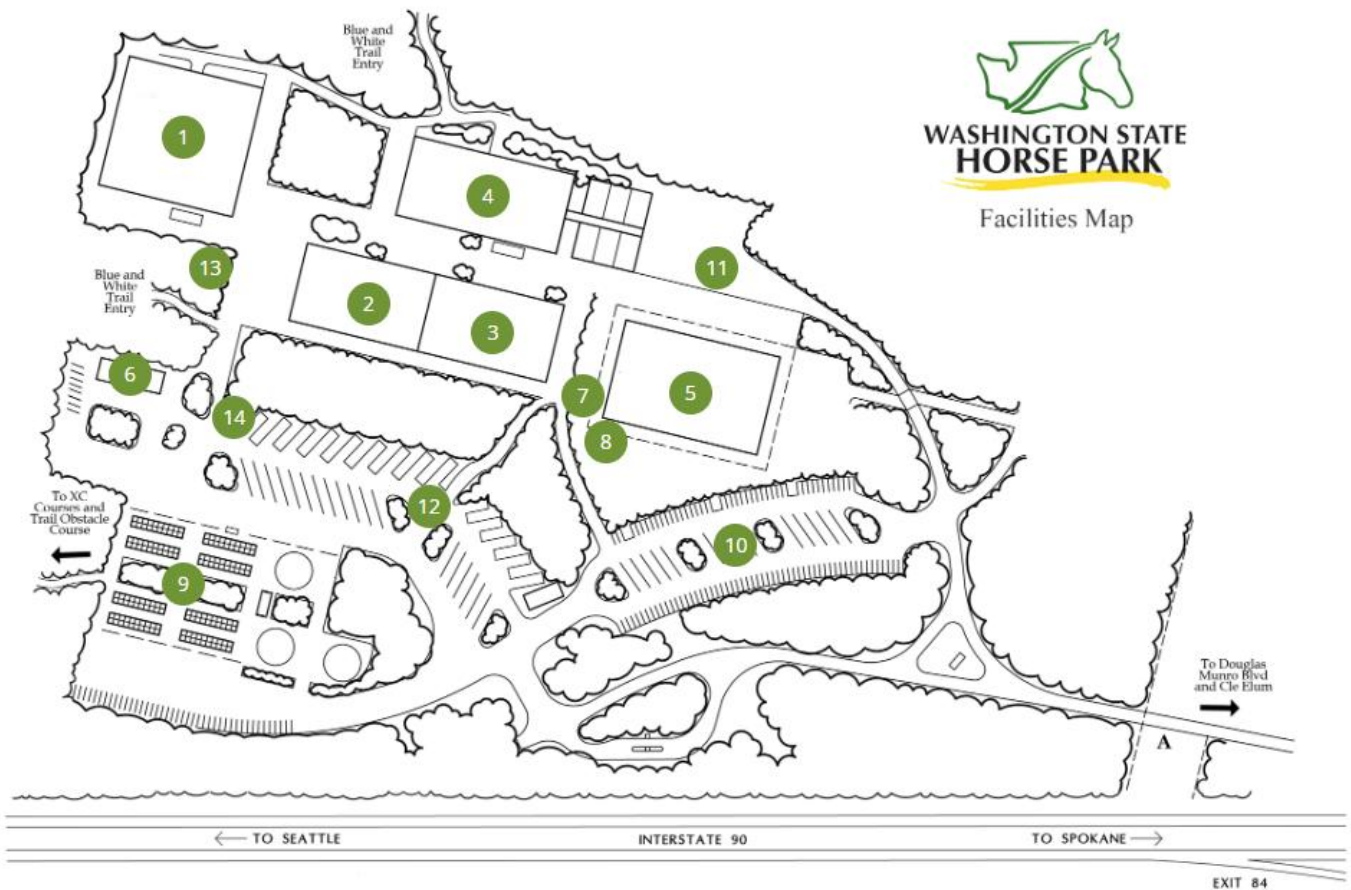

- ① Grand Hunter Arena (250' x 250')
- ② Hunter Warm-up Arena (140' x 230')
- ③ Hunter Arena (130' x 230')
- ④ Warm-up Arena (150' x 300')
- ⑤ Grand Jumper Arena (covered, 150' x 300') with ample spectator seating
- ⑥ Show Office
- ⑦ Hospitality Area
- ⑧ Vendor Row
- ⑨ ⑩ ⑪ Stabling West, East and Northeast
- ⑫ RV sites: 14 premium full hookup (water, electric, sewer) sites nestled in the trees. 14 standard hookup (water & electric) situated around the tree islands. 24 basic no-hookup spaces
- ⑬ Windbreaker Lounge: Hospitality tent with lounge seating, plus covered and open picnic areas
- ⑭ Prize Store

Additional Amenities:

- Shower facility with 3 private shower rooms
- Miles of adjacent horse trails with easy access from stabling areas
- Ample trailer parking

OLSON'S

— TACK SHOP —

EST. 1945

Serving the equestrian community since 1945



Our passionate team of riders and horse enthusiasts are here to answer your questions to help you find the perfect fit, and ensure you have everything you need to get in the ring.

Call/Text (425)454-9453

Shop online at www.olsonstack.com

~Free Shipping on Orders Over \$99~



IMPORTANT POLICIES OF THE SHOW

STALL RESERVATIONS

Trainers or their authorized agents, or individual exhibitors not affiliated with a trainer, must use our online [Stall Reservation form](#) to reserve stalls in advance of our shows. Entries cannot be accepted without stall reservations. We will confirm your reservation within 7 business days of receiving your form. In the case that stalls sell out prior to the close of entries, we will add your reservations to our waitlist.

You can change your counts by notifying us via email at office@cascadehorsheshows.com or text at 360.573.4360, *however*, your counts will be locked-in after the show scratch / cancellation deadline (see below).

Confirming your counts: When the scratch deadline is approaching, we will contact you at least 72 hours in advance to confirm your final stall count. Stalls you confirm past the scratch deadline will be *final* regardless of whether you have submitted entries, so please only reserve stalls you are confident you will use. If we do not hear back from you at this stage, your stalls will be released to others on the waitlist.

Changes past this deadline: If your needs change past this deadline, you can work with other trainers to take your confirmed stalls—provided you notify us via email. All parties—i.e., you and the other trainer(s)—must be included on this communication to us. You must give us notice of any stall exchanges at least 10 days prior to the start of the show to have this reflected on the stabling chart. In the unlikely case of a misunderstanding between trainers as to who is paying for exchanged stalls, we must hold the trainer who made the original reservation responsible for the stalls.

If something does change, please reach out to us as soon as possible. While the above is our formal policy, with enough notice we will always try to work with you while maintaining a fair approach for all competitors.

CANCELLATIONS & REFUNDS

If circumstances change and you will no longer be able to attend the show, please communicate any desired changes promptly. This helps us accommodate as many competitors as possible.

Show Scratches and Cancellations: The deadline for show cancellations and scratches without penalty will be the *earliest* of these two dates:

- The published close of entry date for the show
- A date we officially announce that is approximately 6 weeks prior to the show (in the event the show sells out early)

Up until this deadline, you may make changes to or cancel your entries or their associated stall reservations and RV site requests without penalty. Any deposits paid with entries made prior to the scratch deadline will be fully refunded.

After this deadline, you are fully responsible for any stall fees due for your reserved stalls (see above) in addition to office fees due, if any. Refunds for RV sites with hookups are offered prior to the entry close date provided we can resell the space. RV sites are non-refundable past close of entries.

Changes Past the Close of Entries: A \$50 office fee per horse will apply to all entries, scratches and substitutions made after the close of entries. Please note that after a horse has been checked in, there are no refunds of stalls, nomination fees, feed and hay, bedding, RV reservations, schooling fees, office fees, non-showing horse fees, manure and garbage disposal fees or any completed classes.

Refunds: Any refunds due will be credited to your card or mailed to you within 3 weeks following the show.

How to Request Changes: Please communicate your requests to the Show Office promptly at office@cascadehorsheshows.com.

Illness or Injury During the Competition: After the competition starts, if you are unable to compete due to an illness or injury, your remaining class fees will be refunded upon presentation of a doctor's certificate. Stall and other fees will not be refunded. A \$50 office charge will apply.

ADDITIONAL POLICIES

Adds & Scratches Due By 4:00 pm Daily

All changes for the next day, including adds and scratches, must be made by 4:00 pm each day in the office or on [horseshowing.com](https://www.horseshowing.com). This allows the next day's schedule to be created with class counts and times and made available to everyone in a timely manner.

Day-of Adds

If wanting to add a class on the same day, approval will be based on schedule availability and management discretion. We cannot guarantee acceptance, and you may be put on the ring wait list. If accepted, day-of adds will be assessed a \$10 per class fee. Enter your classes by 4:00 pm the day prior to avoid the \$10 add fee. See our [full policy](#) on page 21.

Canceling And Combining of Classes

Classes with fewer entries than the minimums may be either canceled or combined with other classes, at management's discretion.

Posted Ring Schedule

The most accurate estimation of the daily ring schedules will be completed after adds and scratches have been entered. We strive to post this schedule by 7:00 pm the day prior. The schedule can be found at our [Competitor Resources page](#).

US EQUESTRIAN MEMBERSHIP STATEMENT

Life, senior active and junior active members shall be eligible to participate in all classes at Regular Competitions, Eventing Competitions at the Modified Level or above and Combined Driving Competitions at the Advanced Level, Dressage, Reining and Vaulting Competitions and Endurance Rides. A non-member may participate as a handler, rider, driver, owner, lessee, or agent at Regular Competitions, Eventing Competitions, Dressage Competitions, Reining Competitions and Combined Driving Competitions upon payment of a Show Pass fee. Participants in the following classes are exempted from the Requirements of this rule: 1) leadline; 2) exhibitions; 3) games and races; 4) classes for 4-H members; 5) walk trot and academy classes (academy classes are classes limited to horses used regularly in a lesson program); 6) USDF introductory level tests, pas de deux and quadrille classes; 7) assistant handlers in Dressage Sport Horse Breeding classes.

Laurel Zeeman CPA

*It's about more than understanding your taxes...
It's about understanding YOU!*

I prefer to take a proactive — not reactive — approach to your taxes. By keeping current on new tax laws and legislation, I am in a position to identify key tax planning opportunities that minimize both your current and future tax liabilities. And as a horsewoman, I understand the specific needs of the hunter jumper community, and am proud to be a sponsor of Cascade shows.

I provide my clients with the expertise they deserve — year round.



CONTACT

211 Taylor Street, # 4,
Port Townsend, Washington
98368
(360) 301-0042 (no texts please)
<https://porttownsendcpa.com/>

HOURS

Tax Season (January-April)
Monday - Wednesday 9-5
Thursday-Friday By appointment only
Off Season (May-December)
By appointment only

much more than just a feed store

Much more than just a feed store

OLD MILL
COUNTRY STORE

1987 - 2017

Open 7 Days A Week
509-925-5397 • 500 W. Third

Whether it's for commercial use or for the animals in your back yard, let our knowledgeable staff help find you the right product to keep your animals healthy and happy.

Old Mill Country Store is your total source supplier of cutting edge animal health and nutrition products



RULES & REGULATIONS

Cascade Horse Shows competitions are conducted under current U.S. Equestrian and USHJA rules and are U.S. Equestrian, USHJA, USHJA Zone 9, WSHJA, and OHJA approved.

EVERY CLASS OFFERED HEREIN WHICH IS COVERED BY THE RULES AND SPECIFICATIONS OF THE CURRENT USEF RULE BOOK WILL BE CONDUCTED AND JUDGED IN ACCORDANCE THEREWITH.

ENTRIES

Enter online only via [Horse Spot](#).

Each show has a published close of entries date after which refunds are limited. However, you may enter the shows at any time assuming space availability.

All entries require a Competition Deposit equivalent to the cost of a stall plus a \$50 fee. This deposit will be fully credited to your final show bill upon checkout if entries are received prior to the close of entries date. If your entries are received after the close of entries date, the \$50 per entry fee is forfeited.

SCRATCH DEADLINE

The deadline for refunds in the event of show cancellations or scratches will be the *earliest* of these two dates:

- The published close of entry date for the show
- A date that we publicly announce that is approximately 6 weeks prior to the show if the show sells out early

Refunds for show entries or reserved stalls are not possible for any reason after this deadline. Please contact the Show Office to request refunds.

STALL RESERVATIONS

Trainers or their authorized agents, or individual exhibitors not affiliated with a trainer, may use our online [Stall Reservation form](#) to reserve stalls in advance of our shows. Please see our full [Stall Reservation policy](#) on page 16.

PAYMENT

Pay by check, cash, money order, VISA, MasterCard, Discover, American Express credit or debit card. A valid form of payment must be presented upon check-in at the show. All credit and debit card payments are subject to a 4% convenience fee.

Canadian Exhibitor entries must be paid by draft payable in US funds or check on Canadian US dollar account or credit card. Canadian checks with US FUNDS written on the face of the check cannot be accepted.

All checks returned by the bank incur a fee of \$50. To retain entries, the fees and penalty must be paid by before 4pm the day before the Show starts. In the event a check is returned after the completion of the show, it will be handled in accordance with US EQUESTRIAN GR913.

Competitors who do not come into the office to close out at the end of the show forfeit the right to adjustments on any show charges. Final balances will be automatically charged to the payment method on file.

TRAINER SPLITS

Trainers having accounts with Cascade Horse Shows may choose to add their show fees and charges to their "trainer splits" to have these charges distributed amongst their clients. Trainers have until 5:00pm Friday of the show to inform the Show Office which charges will be distributed to which clients. It is fully and solely the trainer's responsibility to indicate which items are applicable to the split and to which clients they should be applied. *Exhibitors:* By submitting an entry form, you acknowledge that you fully accept responsibility for the costs assigned to you by your trainer for the show that you are entering.

SUBSTITUTIONS

A new horse may be substituted for a scratched horse. There will be a \$50 office charge for substitutions made after the close of entries.

SHOW SCRATCH and REFUNDS

Refer to [Cancellations & Refunds](#) on page 17.

REQUIRED CREDENTIALS

Exhibitors entering rated competition must present copies of the following current credentials to the horse show: US EQUESTRIAN/USHJA/EC membership card; US EQUESTRIAN/USHJA Amateur certification; US EQUESTRIAN/USHJA Large, Small, Junior Hunter and Pony measurement card; USHJA/EC horse recording card or ID number. If measurement cards are not available, measurement will be required. Check in the Show Office for measurement times and dates.

USHJA HORSE REGISTRATIONS

All horses competing in licensed competitions with Hunter, Hunter Breeding, Jumper and/or Hunt Seat Equitation classes (except those activities enumerated in GR901.9, items 1-9) must obtain a Registration Number from USHJA. Not required for Opportunity and Outreach classes.

HORSE MICROCHIP

Note: An ISO 11784/11785 compliant chip is required for entry into ALL USHJA rated hunter/jumper competitions starting with the 2019 season.

STATEMENT OF HORSE HEALTH / VACCINATIONS

Per GR845 Equine Vaccination Rule: At Federation licensed competitions, horses entering the grounds must be accompanied by documentation of Equine Influenza Virus and Equine Herpes Virus (Rhinopneumonitis) vaccinations within six months prior to entering the stables. Horses not in compliance with this rule may be required to leave the competition grounds upon request by Competition Management. Competitors may be asked to provide proof of vaccination upon check-in or prior to entering the property.

SAFE SPORT

Reminder: All USEF Life and Senior Active members, as well as participants who have regular contact with minor athletes, are required to comply with the U.S. Center for SafeSport training requirement to be eligible to participate in the competition. All participants must adhere to the U.S. Center for SafeSport Code, USEF Safe Sport Policy, and the Minor Athlete Abuse Prevention Policies. More information about these can be found at www.usef.org.

COMPETITION OFFICE HOURS

Day preceding show: 10:00am-5:00pm. Days of show: 7am-5pm or 30 minutes after the last regular class completes whichever is later. Special classes are excluded. Regardless of closing time all next day class adds are due by 4:00pm.

PROFESSIONAL PHOTOGRAPHY AND VIDEO

Photography and video may be captured for personal use. Professional photography or video captured for purposes of sale or free distribution to Cascade Horse Shows exhibitors (now or in the future) is strictly prohibited except by officially licensed photographers. Professional photographers who are not officially licensed may apply for a weekly show pass (available for a fee by contacting office@cascadehorsheshows.com) and agree to abide by the rules set forth therein. Failure to abide by the rules may result in a request to leave the property.

ARRIVALS AND DEPARTURES

Arrivals: You may arrive as early as two days prior to the start of competition. For example, a Wednesday competition start with a Tuesday warm-up day means you may move in on Monday beginning at noon. You may arrive later if you like. For approval to arrive earlier than noon two days before competition start, contact the Show Office at office@cascadehorsheshows.com. Early arrivals incur a per-night fee per-stall and per-RV, as applies.

Departures: Plan to depart Stabling and RV locations by 7pm Sunday or pre-pay with the Show Office to stay over Sunday night. The fee is \$50 per horse stall, and you must vacate by 8am on Monday morning. On Sunday night there will be a 10pm stabling 'lights out'. Sunday night RV stays incur a 'per night' RV fee.

STABLING

Stalls with doors are provided; dimensions are 10'x10'. 160 have mats; the remaining have dirt/gravel floors. Requests for specific stalls or stall locations will be considered on an individual basis. Preference given to horses showing multiple weeks and to sponsors. Portable stalls, with doors, are provided. Bales of shavings will be available by pre-order on entry form and/or during the show by request at the Competition Office. Straw is not permitted.

In cases of high demand, management reserves the right to cap how many non-horse stalls are sold, and a ratio of horse stalls to non-horse stalls may be put into effect.

Stalls must be cleaned daily. Dirty bedding must be placed in areas provided. Exhibitors are responsible for cleaning their own stalls and must provide their own feed and buckets. A \$60 manure disposal and garbage fee will be assessed for all stalls. No staples, nails, cutting stalls or removal of top doors permitted. Stabling damage fees will be assessed by the WSHP as follows: Panels – \$100 portable stall, \$200 permanent stall; Stall metal framework - \$200; light cords \$150; Roof Tarps – actual repair/replacement costs. Trash cans and bags will be provided on move out days.

SHARPS CONTAINERS

Sharps containers will be available at the end of each barn aisle way. Please be aware Competition Management may fine any individual up to \$100 for improper disposal of needles or other sharp disposable instruments. GR1210.4 If needles are dropped in manure, it cannot be composted.

JUMPER / HUNTER / EQ NOMINATING FEE

Horses or ponies entered in any jumper, hunter or equitation classes pay a Nomination Fee (varies per show). This fee allows entries to add classes before 4:00 pm prior to the day of the class (see next section).

CLASS ADD / SCRATCH POLICY

Adds — Classes may be added up to a day ahead of time at no charge if the Show Office is notified by 4:00pm. Unless otherwise posted, it should be assumed that there are no day-of adds. If wanting to add a class on the same day, approval will be based on schedule availability and management discretion. We cannot guarantee acceptance, and you may be put on the ring wait list. If accepted, day-of adds will be assessed a \$10 per class fee.

Scratches — With the exception of Spotlight classes, if your horse has a written scratch form at the Show Office prior to the start of the class, full class entry fees are refunded minus a \$10 scratch fee. You must scratch your classes BEFORE they start. If you don't scratch them at all or try to scratch them after the class has started, you will be charged the full class entry fee.

SPOTLIGHT CLASS SCRATCH POLICY

Spotlight classes will be assessed a \$25 scratch fee if scratched on the day of the class.

RIDER DID NOT ENTER (RDNE) FEE

It is the responsibility of the competitor and trainer to ensure they have properly entered all classes they intend to compete in. A "ride-did-not-enter" (RDNE) fee of \$25 will be added to the cost of the class for any rounds competed that cannot be supported by office-approved paperwork.

CLASS WAIT LIST POLICY

Be sure to get all entries planned for the next day in by 4pm. If full ring capacity is reached, any entries received for that ring after 4pm, may be put on a wait list. You are encouraged to enter all classes/divisions for the entire show before 5pm on schooling day to ensure entry in those classes/divisions.

US EQUESTRIAN and USHJA FEES

All horses participating in any competition recognized by the US Equestrian Federation incur the following fees: USEF \$23 fee (\$15 of this fee is a Drugs and Medication fee to provide research, inspection, and enforcement of rules regarding use of medications and drugs: see GR407.1, .2, and .3); USHJA Fee \$7 (National shows) or \$2 (Regional I shows). An active USEF competing membership is required for all riders, trainers, and coaches (including parents signing entry forms as trainers). If you are not a current USHJA member, a Show Pass fee of \$30 is assessed by the USHJA. These fees will be added to your show account.

Cascade Grands Prix

Saturday, June 20, 2026 **\$9,999 Barn Pros Grand Prix**

to be run at 1.30m

*Presented by **Barn Pros Nationwide***

Saturday, June 27, 2026 **\$9,999 Horseware Grand Prix**

to be run at 1.25m

*Presented by **The Absolute Horse***

*Owner/rider Courtney Palmer-McGlothern
pilots Vedauwoot into the ribbons in the
\$10,000 Horseware Grand Prix at the 2025
Cascade Open.*



MANAGEMENT CLASS CHANGES

Management reserves the right to cancel or combine any classes as appropriate. Notice will be given to exhibitors affected. Management reserves the right to start the first class of any section 30 minutes earlier than the scheduled time. Management reserves the right to change arenas, judges, or class orders to facilitate time, schedule, and conditions.

PRIZE MONEY PAYMENTS

Exhibitors receive prize money within 3 weeks after the horse show. A valid Social Security or Federal tax ID number must be provided. Prize money won by foreign exhibitors is subject to the US Internal Revenue Service regulation requiring sporting events to withhold 30% of prize money unless they have a US Social Security #.

TROPHIES, RIBBONS, PRIZE MONEY SPLITS

Trophy and ribbons will be awarded to eight places in all Hunter and Equitation classes. Unless stated otherwise, Hunter and Hunter Classic prize money will be divided 30%, 25%, 20%, 15%, 10%. The USHJA National Hunter Derby prize money will be divided 30%, 22%, 13%, 8%, 6%, 5%, 4%, 3%, 3%, 2%, 2%, 2%. Trophy and ribbons will be awarded to six places in all Jumper classes. Unless stated otherwise, Jumper prize money will be divided 25%, 23%, 20%, 17%, 15%. The Cascade Welcome and the Luxury DerbyCross™ prize money will be divided 30%, 23%, 15%, 12%, 10%, 10%. The Need for Speed™ Open Jumper will be divided 30%, 20%, 14%, 10%, 8%, 7%, 6%, 5%. The Grand Prix and Mini Prix will be divided 30%, 20%, 15%, 10%, 8%, 6%, 4%, 3%, 2%, 2%.

HUNTER PRIZE MONEY**Cascade Classic (330219):**

2026 Hunter prize money offered \$20,650 / guaranteed* \$5,000.
2025 Hunter prize money offered \$19,700 / paid \$7,221.25.

Cascade Open (332619):

2026 Hunter prize money offered \$8,775 / guaranteed* \$2,500
2025 Hunter prize money offered \$5,916 / paid \$5941.25.

*Guaranteed amounts assume all classes fill.

HUNTER TIES

As stated in [USEF HU154](#), in case of a tie the Championship and/or Reserve is awarded to the horse with the most points over fences. If horses have equal points over fences and no points under saddle, the tied horses will be asked to compete in a hack off (Exception: Green and Young Hunters.) Any competitor may concede and not hack off, or if both competitors agree, break the tie with a coin toss. If horses have an equal number of points over fences, under saddle, and model (i.e., Green Conformation Hunter 3'6" or High-Performance Conformation Hunter) the tie will stand as is and double ribbons will be awarded.

JUMPER TIES

As stated in [USEF IP143](#), Competitors who are tied for first place after the initial round(s) will jump off. Any competitors that compete in the jump off and are still tied for first place shall remain tied. Competitors who are tied for other than first place in all Jumper sections will be placed according to the time taken to complete the first course. Prize money and Championship points shall be combined and divided equally among the tied competitors. Double ribbons will be awarded for division championships. For special classes, the competitors will toss a coin for the ribbon and toss a coin for the special award if any.

JUMPER CLASS SCHEDULE TABLES

Jumper classes not otherwise designated in the class schedules will run as Table II.1, Table II.2.b or Table II.2.c, or Table II.d. Please refer to the daily schedules available in the Competition Office.

STAKE/HANDY HUNTER CLASSES

If a per class entry is offered in a division, horse and rider must have shown in at least one other class in the division to be eligible for the Stake or Handy Hunter Class.

POLING / OFFSETS

Manual poling, or the use of offsets, is prohibited on competition grounds (GR838).

HORSE ILLNESS

In the event of an acute and serious injury or illness of a horse on competition grounds when the owner or trainer of the horse is not present, after reasonable effort to contact that individual has been made, Competition Management, in consultation with a licensed veterinarian, may authorize the provision of emergency veterinary treatment of the horse. If Competition Management authorizes treatment under the provisions of this rule, Competition Management and veterinarian are not responsible for any resulting costs, damages, losses, claims, or actions arising directly from the treatment of the horse.

SCHOOLING AND EXERCISE

Schooling areas are available for use before and during the show. A mandatory schooling fee of \$40 is charged for all horses. Helmets meeting the US Equestrian requirements as well as riding boots must be worn during schooling.

No lungeing is permitted in any of the arenas, including the warm-up rings. Please lunge horses on the designated lungeing pads located on the Horse Park near the west and northeast stalls.

WARM-UP RINGS

During competition days, please cede use of the warm-up rings to riders preparing for upcoming classes. When jumping, standards are cleared with the flags on the right, no reversing of directions. Horses approaching a jump must always be given priority. For your safety and the safety of others, always pass "left shoulder to left shoulder" when traveling in opposite directions in the arena. More warm-up ring rules and best practices can be found at <https://practicalhorsemanmag.com/training/warm-up-ring-etiquette>

ARENAS & FOOTING

Hunters: 250' X 255'; Hunters: 150' X 220'; Jumpers (covered): 150' X 300'. All have sand footing.

DOGS

We welcome your dogs at the shows! Keep your dogs and horses safe by always keeping your dogs on leash while on the Horse Park property. We kindly request you pick up after your dog. For their safety, do not let dogs run loose on trails. All dogs are eligible for our Cascade Canine Derby! (Class availability varies by show.)

Cascade Equitation Challenge

Presented by **Equidae Farm**

Saturday, June 20, 2026

A flat equitation class judged in elimination style. Riders will be tested at the judge's discretion. The champion will be the final rider on the rail.

The top four placing riders from each equitation section at the Cascade Classic plus the top four riders from the Pro Equitation on the Flat, #740 (Classic only) are eligible to compete.

Formal attire and salute to sponsor appreciated. Winner takes home a Helite safety vest.



RVs, MOTORHOMES, TRAILERS, AND CAMPERS

Submit the [RV Site Request form](#) to request your site. RV sites are available by the week only (the night before schooling day through Sunday day only). Additional nights on either end of the reservation may be available for an additional fee with pre-approval. As hookup sites are limited, preference is given for length of stay, sponsors, reservation date, and size of RV. In the event all the hookup sites are reserved, additional requests will be accepted for non-hookup dry-camping sites.

Full payment is required for confirmed sites. Designated trainers having an account with Cascade Horse Shows may choose to add their personal RV site to their show bill to have us do trainer splits. [All other sites](#) must be pre-paid in advance at the time of confirmation. Charges apply to RV site whether hooked to utilities or not.

Upon arrival, an RV Pass must be obtained from Show Office and displayed. Hookup locations are assigned by us—if assigned a site with a hookup, park only in your designated site.

Tent campers must make a [Tent Camping Reservation](#) to camp on the Horse Park grounds. Payment is due with reservation. Upon arrival, camping passes must be obtained from the Parking attendant and prominently displayed. Campers must camp in designated areas only. See the Horse Show Fees, page 13, for fees.

MOTORIZED VEHICLES

Minors who do not have a valid driver's license which allows them to operate a motorized vehicle in the state in which they reside will not be permitted to operate a motorized vehicle of any kind, including, but not limited to, golf carts, motorcycles, scooters, or farm utility vehicles, on the competition grounds of licensed competitions. Minors who have a valid temporary license may operate the above described motorized vehicles as long as they are accompanied by an adult with a valid driver's license. The parent/legal guardian or individual who signs the entry blank as a parent or guardian of a minor operating a motorized vehicle in violation of this rule are solely responsible for any damages, claims, losses or actions resulting from that operation. Violations of this rule will be cause for penalties against those responsible for the child committing the offense. Wheelchairs and other mobility assistance devices for individuals with disabilities are exempt from this rule.

The unsafe use of personal electronic transport devices, as determined by the competition officials and management in their sole discretion, that do not require a driver's license to operate, including but not limited to segways, hover boards, and single wheeled scooters is prohibited on competition grounds. Operating such devices in areas where people gather may be deemed "unsafe use" if there is a risk of harm to others. If the operator of the device is a minor, the parent/legal guardian or individual who signs the entry blank as a parent or guardian of a minor operating the device in violation of this rule is accountable and may be subject to penalties. Wheelchairs and other mobility assistance devices for individuals with disabilities are exempt from this rule.

HELMETS

It is compulsory for all persons at US Equestrian licensed hunter, jumper or hunter/jumper competitions when mounted anywhere on the competition grounds, to wear properly fastened protective headgear which meets or exceeds ASTM (American Society for Testing and Materials)/SEI (Safety Equipment Institute) standards for equestrian use and carries the SEI tag. It must be properly fitted with harness secure

SAFETY AND WELFARE

The nearest hospital is [Kittitas Valley Healthcare](#) which is 24 miles from the Washington State Horse Park. The nearest level 1 trauma center is [Harborview Medical Center](#) in Seattle, WA which is 83 miles from the Washington State Horse Park.

DISCRETIONARY POLICY

All questions not covered in these rules and regulations shall be decided by Show Management whose decision shall be final.

SPOTLIGHT CLASSES

Hunter Derbies

Presented by: **Altura Hunters & Jumpers**

\$3,500 USHJA National Hunter Derby

To be run at 3' with 3'5" options

Friday, June 19, 2026

\$2,500 USHJA National Hunt & Go

To be run at 3' with 3'5" options

Friday, June 26, 2026

USHJA 2'6" Junior/Amateur Hunter Derby

To be run in the Hunt & Go format

Friday, June 19, 2026

Friday, June 26, 2026

USHJA Outreach Hunter Derbies

USHJA Outreach Hunt & Go 2'-2'3"

Derbies to be run at 2'6" with 2'9" options, and at 2' with 2'3" options

Sunday, June 28, 2026

Karen O'Neal and Clooney 14 show precise form enroute to a second-place finish in the USHJA National Hunter Derby during the 2025 Cascade Open. Owner: Annika Asling.



Are you looking for
QUALITY PRE-OWNED
children's riding apparel &
pony tack?

SHOP & CONSIGN NOW
www.forestparksaddlery.com

Instagram icon @forestparksaddlery
info@forestparksaddlery.com

DCIS

Dianna Connelly
Insurance Services, LLC

EQUESTRIAN INSURANCE SPECIALIST



- Equine Mortality
- Equine Major Medical
- Instructors & Trainers Liability
- Commercial Equine Liability
- Private Horse Owner Liability
- Stable Liability
- Care, Custody & Control
- Farm Dwellings
- Horse Farm Package
- Auto

(206) 419-0634 - cell
(425) 806-0401 - office
PO Box 2277
Bothell, WA 98041-2277

Dianna@Sea-Mountain.com
www.sea-mountain.com



★ INTRODUCING THE ★
Golden Backstage Pass

Earn an exclusive invite to the
USHJA National Championships!



TORI BILAS/USHJA



TRICIA BOOKER/USHJA

Awarded to the highest pointed Gold Level Outreach competitor from each Zone, the Golden Backstage Pass earns the winner premier access to events at the USHJA's annual national competition in Las Vegas, including:

- ★ The opportunity to compete in the USHJA Affiliate Championships held during the USHJA National Championships
- ★ The chance to participate in the National Championship Grand Prix and Hunter Derby course walks, as well as attend educational sessions such as Judge with the Judge and Sports Psychology for Equestrians
- ★ The honor of presenting awards with USHJA President Mary Knowlton and Executive Director Kevin Price



*Learn more about Outreach and earning
the Golden Backstage Pass at ushja.org/outreach.*



2026 CASCADE CLASSIC

June 17-21, 2026

USEF #330219

Tami Masters and Superior D'or celebrate their winning round in the Cascade Welcome during the 2025 Cascade Classic. Owner: Laurel Jones.

SPOTLIGHT CLASSES

Class #	Class	Height	Entry Fee	Prize Money
1	Barn Pros Grand Prix <i>Presented by Barn Pros Nationwide</i>	1.30m	\$395/class	\$9,999
3	USHJA National Hunter Derby <i>Presented by Altura Hunters & Jumpers</i>	3' with 3'5" options	\$225/class	\$3,500
28	USHJA 2'6" Junior/Amateur Hunter Derby	2'6"	\$100/class	\$1,000
38	Cascade Welcome 1.25m	1.25m	\$100/class	\$1,000
7	Luxury DerbyCross™ 3'3" 1.00m	Hunter course: 3'3", Jumper course: 1.00m	\$120/class	\$1,000
30	Cascade Hunter Team Trials 2'6" <i>Presented by Tiffany & Equestrians</i>	2'6"	\$90/class	\$750
20	Need for Speed™ Open Jumper 1.00 or 1.10m	1.00 or 1.10m	\$75/class	\$750
29	USHJA Zone 9 Handy Hunter Challenge 3'	3'	\$75/class	\$500
22	Cascade Equitation Challenge <i>Presented by Equidae Farm</i>	N/A	\$60/class	
13	Hobby Horse Classic <i>Presented by Cascade Partners</i>	N/A	\$10/class	
16	Rising Stars™ Leadline	N/A	Free	

Formal Attire Required — Salute to Sponsors Requested

USHJA Zone 9 Handy Hunter Challenge is open to Junior and Amateur riders only.

USHJA National Hunter Derby: Special recognition for the top 3 Amateurs/Juniors

See full class specifications here: Specifications on page 79.

SPOTLIGHT CLASSES

Luxury DerbyCross

Presented by Pacesetter Properties

Sunday, June 21, 2026

Sunday, June 28, 2026

The Cascade-exclusive Luxury DerbyCross™ is a unique combined class challenging the skills of both rider and horse with back-to-back Handy Hunter and Jumper Speed rounds

See class specifications for scoring

\$1,000 distributed 1st through 6th

Formal Hunter attire and tack required, braiding optional. Salute to sponsor requested

Hadley Wagter and BellaTrix lay down an impressive hunter round on their way to a second-place finish in the Luxury DerbyCross at the 2025 Cascade Open. Owner: Paige Wagter.



HUNTER CLASSICS

Class #	Class	Height	Entry Fee	Prize Money
40	Pony Hunter Classic 2'3", 2'6", 2'9"-3'	2'3", 2'6", 2'9"-3'	\$60/class	\$500
41	Pre-Children's/Adult Hunter Classic 2'9"	2'9"	\$60/class	\$250
42	Low Children's/Adult Hunter Classic 2'6"	2'6"	\$60/class	\$250
44	Children's Hunter Pony Classic 2', 2'6"	2', 2'6"	\$60/class	\$250
45	Short/Long Stirrup Hunter Classic 2'3"	2'3"	\$60/class	\$250
46	Short Stirrup Hunter Pony Classic 18"	18"	\$60/class	\$250
47	Cascade Hunter Classic 2'	2'	\$60/class	\$250
48	Cascade Hunter Classic 2'3"	2'3"	\$60/class	\$250
52	Children's/Adult Hunter Classic 3'	3'	\$60/class	\$250

Formal Attire Required — Salute to Sponsors Requested

Prize Money — 30%, 25%, 20%, 15%, 10%

All Classics are 2 rounds. The last class of the corresponding division to be the first round of the class. Round 2 to be shown over a course of at least 10 obstacles. Hunter Classic riders must have ridden in at least 2 hunter classes in their division to compete.

USEF NATIONAL-RATED HUNTER SECTIONS

Class #	Class (Section Code)	Height	Entry Fee	Prize Money
305, 306, 307, 308 ¹ , 309 ³	High Performance Hunter 3'9" (B)	3'9"	\$275/section or \$60/class	\$250/\$100 U/S
310, 311, 312, 313 ¹ , 314 ³	Performance Hunter 3'6" (C)	3'6"	\$275/section or \$60/class	\$150/\$100 U/S
315, 316, 317 ³ , 318, 319 ¹	Performance Hunter 3'3" (D)	3'3"	\$275/section or \$60/class	\$150/\$100 U/S
320, 321, 322, 323 ¹ , 324 ³	Green Hunter 3'9" (E)	3'9"	\$275/section or \$60/class	\$150/\$100 U/S
325, 326, 327, 328, 329 ³	Green Hunter 3'6" (F)	3'6"	\$275/section or \$60/class	\$150/\$100 U/S
330, 331, 332 ³ , 333, 334	Green Hunter 3'3" (G)	3'3"	\$275/section or \$60/class	\$150/\$100 U/S
335, 336, 337 ³ , 338, 339	Green Hunter 3' (H)	3'	\$275/section or \$60/class	\$150/\$100 U/S
345, 346, 347 ³ , 348, 349	Young Hunter 3'3" - Horses 7 & Under (J)	3'3"	\$250/section or \$55/class	\$100/\$75 U/S
350, 351, 352, 353, 354 ³	Young Hunter 3' - Horses 6 & Under (K)	3'	\$250/section or \$55/class	\$100/\$75 U/S
355, 356, 357 ³ , 358, 359	Young Hunter 2'9" - Horses 5 & Under (L)	2'9"	\$250/section or \$55/class	\$100/\$75 U/S
360, 361, 362, 363 ¹ , 364 ³	Amateur Owner Hunter 18-35 3'6" (P)	3'6"	\$250/section	\$100/\$75 U/S
365, 366, 367, 368 ¹ , 369 ³	Amateur Owner Hunter 36 & Over 3'6" (M)	3'6"	\$250/section	\$100/\$75 U/S
370, 371, 372, 373 ¹ , 374 ³	Amateur Owner Hunter 18-35 3'3" (O)	3'3"	\$250/section	\$100/\$75 U/S
375, 376, 377, 378 ¹ , 379 ³	Amateur Owner Hunter 36 & Over 3'3" (N)	3'3"	\$250/section	\$100/\$75 U/S
380, 381, 382, 383 ¹ , 384 ³	Junior Hunter 15-17 3'6" (Q)	3'6"	\$250/section	\$100/\$75 U/S
385, 386, 387, 388 ¹ , 389 ³	Junior Hunter 14 & Under 3'6" (R)	3'6"	\$250/section	\$100/\$75 U/S
400, 401, 402, 403 ¹ , 404 ³	Junior Hunter 15-17 3'3" (U)	3'3"	\$250/section	\$100/\$75 U/S
405, 406, 407, 408 ¹ , 409 ³	Junior Hunter 14 & Under 3'3" (V)	3'3"	\$250/section	\$100/\$75 U/S
410, 411 ¹ , 412 ³ , 413	Pony Hunter (SML) 2'3", 2'6", 2'9"-3' (W)	2'3", 2'6", 2'9"-3'	\$250/section	\$100/\$75 U/S

Class # footnotes: 1 = Handy; 2 = Stake; 3 = Under Saddle; italics = Conformation

Green Hunter: Reference [US Equestrian Rule Book HU](#) for Green Hunter Eligibility and Status. Jog for soundness. Horse may compete in only one green hunter fence height section at any one competition

Young Hunter: Reference [US Equestrian Rule Book HU](#) for Young Hunter Eligibility and Status. Not to Jog.

AO Hunters: Horses competing in 3'6" AO Hunters may not cross-enter 3'3" AO Hunters

Junior Hunter: A large Junior Hunter is over 16.0 hands, and a small Junior Hunter is 16.0 Hands and under. Junior Hunter 3'3" is open to junior riders. Riders may not cross-enter any class at 3'6" or higher in the Hunter division, higher than 3'9" in the Equitation division or higher than 1.20m in the Jumper division at the same competition. Horses entered in the Junior Hunter 3'3" section may not cross-enter the Junior Hunter 3'6" section at the same competition.

SML and Green Pony Hunter: Classes 410 and 415 to be judged 25% Conformation.

Sections may be combined if fewer than 4 entries in section.

ALL HUNTER CLASSES WILL BE JUDGED ON PERFORMANCE AND SOUNDNESS UNLESS OTHERWISE NOTED

USEF REGIONAL II AND NON-RATED HUNTER SECTIONS

Class #	Class (Section Code)	Height	Entry Fee	Prize Money
425, 426, 427 ³ , 428	Adult Amateur Hunter 18-39 3' (Z)	3'	\$200/section or \$55/class	
425, 426, 427 ³ , 428	Adult Amateur Hunter 18-39 3' (Z)	3'	\$200/section or \$55/class	
430, 431, 432 ³ , 433	Adult Amateur Hunter 40 & Over 3' (AA)	3'	\$200/section or \$55/class	
435, 436, 437 ³ , 438	Children's Hunter 13 & Under 3' (AB)	3'	\$200/section or \$55/class	
440, 441, 442 ³ , 443	Children's Hunter 14-17 3' (AC)	3'	\$200/section or \$55/class	
445, 446, 447 ³ , 448	Children's Hunter Pony 2', 2'6" (AD)	2', 2'6"	\$200/section or \$55/class	
450, 451, 452, 453 ³	Small Hunter 3' (AN)	3'	\$200/section or \$55/class	Stake \$250
455, 456, 457, 458 ³	Thoroughbred Hunter 3' (AE)	3'	\$200/section or \$55/class	Stake \$250
460, 461 ³ , 462, 463	USHJA 2' Hunter (AF)	2'	\$200/section or \$55/class	
465, 466 ³ , 467, 468	USHJA 2'3" Hunter (AG)	2'3"	\$200/section or \$55/class	
470, 471, 472, 473 ³	USHJA 2'6" Hunter (AH)	2'6"	\$200/section or \$55/class	
475, 476 ³ , 477, 478	USHJA 2'9" Hunter (AI)	2'9"	\$200/section or \$55/class	
480, 481, 482, 483 ³	USHJA 3' Hunter (AJ)	3'	\$200/section or \$55/class	
500, 501, 502 ³ , 503	Short Stirrup Hunter Horse 17 & Under 2'3" (AK)	2'3"	\$200/section or \$55/class	
505, 506, 507 ³ , 508	Short Stirrup Hunter Pony 17 & Under 18" (AL)	18"	\$200/section or \$55/class	
510, 511, 512 ³ , 513	Long Stirrup Hunter 18 & Over 2'3" (AM)	2'3"	\$200/section or \$55/class	
515, 516, 517, 518 ³	Large Hunter 3' (AO)	3'	\$200/section or \$55/class	
520, 521, 522 ³ , 523	Pre-Children's Hunter 2'9" (AP)	2'9"	\$200/section or \$55/class	
525, 526, 527 ³ , 528	Low Children's Hunter 2'6" (AQ)	2'6"	\$200/section or \$55/class	
530, 531, 532 ³ , 533	Low Adult Hunter 2'6" (AS)	2'6"	\$200/section or \$55/class	
535, 536, 537, 538 ³	Baby Green Hunter 2'6" (AR)	2'6"	\$200/section or \$55/class	
545, 546, 547 ³ , 548	Pre-Adult Hunter 2'9" (BF)	2'9"	\$200/section or \$55/class	

Class # footnotes: 1 = Handy; 2 = Stake; 3 = Under Saddle * Indicates a non-rated class.

AA Hunter: To be ridden by amateurs no longer eligible to compete as a Junior. See current [USHJA Zone 9 specifications](#) in this prize list or at [Zone-9 Specifications on USHJA.org](#).

Ponies may not cross into any other rated section at the same show. Riders may compete on a maximum of 1 Children's Hunter horse section at the same show and in any class not to exceed 3' (Exception: Pony Jumpers). Green & Regular Hunter Pony riders may compete on a maximum of 1 additional pony in the Children's Hunter Pony section at the same show.

Small Hunters: Open to horses over 14.2 hands and not to exceed 16 hands

Thoroughbred Hunters: Thoroughbred registration verification required, see [USEF HU 106.8](#)

USHJA Hunter: Open to all horses and ponies.

Short Stirrup: Rider no cross entry into any other classes except Low Under 3' Short Stirrup Equitation and Short Stirrup Pony or Short Stirrup Horse (as applicable to the class)

Long Stirrup: Riders no cross entry into rated classes 3' & up.

Large Hunter: Open to Horses Over 16 hands

Pre-Children's / Pre-Adult Hunter: Rider no cross entry into rated sections or classes with fences 3'6" or higher. May be split by age group if entries warrant.

Low Children's / Low Adult Hunter: Please see full [Zone 9 Specifications](#) for cross-entry restrictions.

Baby Green: Open to horses and ponies in 1st year of showing.

Sections may be combined if fewer than 4 entries in section.

ALL HUNTER CLASSES WILL BE JUDGED ON PERFORMANCE AND SOUNDNESS UNLESS OTHERWISE NOTED.

HUNTER WARM-UP CLASSES (NON-RATED)

Class #	Class	Height	Entry Fee	Prize Money
600	Warm-Up Hunter 18"	18"	\$55/class	
610	Warm-Up Hunter 2'	2'	\$55/class	
620, 621, 622	Warm-Up Hunter 2'3"	2'3"	\$55/class	
625	Warm-Up Hunter 2'3", 2'6", 2'9"	2'3", 2'6", 2'9"	\$55/class	
630, 631, 632	Warm-Up Hunter 2'6"	2'6"	\$55/class	
640, 641	Warm-Up Hunter 2'9"	2'9"	\$55/class	
650, 651, 652, 653	Warm-Up Hunter 3'	3'	\$55/class	
660, 661	Warm-Up Hunter 3'3"	3'3"	\$55/class	
670, 671	Warm-Up Hunter 3'6"	3'6"	\$55/class	
675	Warm-Up Hunter 3'9"	3'9"	\$55/class	
680, 681	Warm-Up Pony Hunter	Respective heights	\$55/class	

Braiding is optional. Not to jog.

EQUITATION SECTIONS

Class #	Class (Section Code)	Height	Entry Fee
700, 701, 702 ³	Pony Equitation 2'3", 2'6", 2'9"-3' (AT)	2'3", 2'6", 2'9"-3'	\$150/section or \$55/class
703, 704, 705 ³	Long Stirrup Equitation 2'3" (AU)	2'3"	\$150/section or \$55/class
706, 707, 708 ³	Short Stirrup Equitation Horse 2'3" (AV)	2'3"	\$150/section or \$55/class
709, 710, 711 ³	Short Stirrup Equitation Pony 18" (AW)	18"	\$150/section or \$55/class
712, 713, 714 ³	Children's Pony Equitation 2', 2'6" (AX)	2', 2'6"	\$150/section or \$55/class
715, 716, 717 ³	Low Children's Equitation 2'6" (AY)	2'6"	\$150/section or \$55/class
718, 719, 720 ³	Low Adult Equitation 2'6" (AZ)	2'6"	\$150/section or \$55/class
721, 722, 723 ³	Pre-Children's Equitation 2'9" (BA)	2'9"	\$150/section or \$55/class
724, 725, 726 ³	Adult Equitation 18-39 3' (BB)	3'	\$150/section or \$55/class
727, 728, 729 ³	Adult Equitation 40 & Over 3' (BC)	3'	\$150/section or \$55/class
730, 731, 732 ³	Equitation 14 & Under 3' (BD)	3'	\$150/section or \$55/class
733, 734, 735 ³	Equitation 15-17 3' (BE)	3'	\$150/section or \$55/class
736, 737, 738 ³	Pre-Adult Equitation 2'9" (BG)	2'9"	\$150/section or \$55/class

Class # footnotes: 3 = Not to jump

* Ponies ride respective heights

** Qualifier for class #22 Cascade Equitation Challenge

OPPORTUNITY CLASSES

USEF / USHJA memberships and horse recording are not required.

Class #	Class	Height	Entry Fee
900	Opportunity Schooling	N/A	\$25/class
920 ³	Opportunity Walk/Trot/Canter Equitation		\$35/class
925, 926, 927 ³ , 928, 929, 930, 931	Opportunity Cross Pole Equitation		\$35/class
970, 971, 972 ³ , 973, 974, 975, 976	Opportunity Walk/Trot Poles Equitation		\$35/class

Class # footnotes: 3 = Not to jump

Braiding is optional. Not to jog.

MEDAL CLASSES

Class #	Class	Height	Entry Fee
800	WSHJA Good Hands & Seat 2'6"	2'6"	\$55/class
801	WSHJA Good Hands & Seat 3'	3'	\$55/class
802	WSHJA Good Hands & Seat 3'6"	3'6"	\$55/class
803	ASPCA Maclay Horsemanship Medal 3'6"	3'6"	\$55/class
804	Dover Saddlery/USEF Hunter Seat Medal 3'6"	3'6"	\$55/class
805	Hamel Foundation NHS Medal 3'3"	3'3"	\$55/class
806	EMO Insurance/USHJA Jumping Seat Medal 3'3"	3'3"	\$55/class
807	USEF/NCEA Junior Hunter Seat Medal 3'3"	3'3"	\$55/class
808	Taylor Harris Insurance National Children's Medal 3'	3'	\$55/class
809	Ariat National Adult Medal 3'	3'	\$55/class
810	Marshall & Sterling U.S. Pony Medal 2'3", 2'6", 2'9"-3'	Respective heights	\$55/class
811	OHJA Mini Medal 2'6"	2'6"	\$55/class
812	OHJA Children's Medal 3'	3'	\$55/class
813	OHJA Adult Medal 3'	3'	\$55/class
814	USHJA Jumping Seat Medal 3'3"	3'3"	\$55/class
815	USHJA 3'3" Hunter Seat Medal	3'3"	\$55/class
816	USEF Adult Equitation 3'3"	3'3"	\$55/class
817	Northwest Foundation Medal 3' 14 & Under	3'	\$55/class

WSHJA Medals: Open to juniors and amateurs. Riders must be WSHJA members prior to the start of the class.

ASPCA Maclay: Open to junior members of USEF or Equine Canada who have not reached their 18th birthday in accordance with GR127. Riders and their trainers or coaches must be current members of the National Horse Show Association ("NHSAA").

Dover Saddlery/USEF Hunter Seat: Open to Individual Junior USEF Members in good standing who have not reached their 18th birthday in accordance with GR127.

EMO Insurance/USHJA Jumping Seat: Open to Junior active members of US Equestrian and USHJA who have not reached their 18th birthday as of December 1 of the current competition year (per USEF rules).

USEF/NCEA: NCEA membership is not required to ride the class but only NCEA members receive points and will be included in rankings for the finals

Taylor Harris National Children's Medal: Riders not to compete in any hunter or equitation class 3'9" or higher, or jumper class set above 1.20m at same show

Ariat National Adult Medal: Riders not to compete over jumps that exceed 3'6" or 1.20m or higher at same show.

Marshall & Sterling U.S. Pony Medal: Tests young riders, judging their ability to compete over a technical and demanding course of fences.

OHJA Mini Medal: No cross entry with 3' medals. Riders must be OHJA members prior to the start of the class.

OHJA Children's Medal: Riders may not cross-enter junior hunters, junior jumpers, or any 3'6" medal class at the same show. Riders must be OHJA members prior to the start of the class.

OHJA Adult Medal: Riders must be OHJA members prior to the start of the class.

USHJA Adult Jumping Seat Medal: Open to amateur active USEF/USHJA members 18 years of age or older (per USEF rules).

USHJA 3'3" Hunter Seat Medal: Open to open to Junior Active Members of the USEF and USHJA who have not previously won a USHJA 3'3" Hunter Seat Medal Finals.

USEF Adult Equitation: Open to Amateur Senior Members of the Federation and USHJA.

Northwest Foundation Medal. Open to junior riders 14 years of age and under.

SPOTLIGHT CLASSES

Need for Speed™ Open Jumper Classic

Presented by **Voltaire Design**

Sunday, June 21, 2026

Sunday, June 21, 2026

To be run at 1.00m or 1.10m with time penalty

\$750.00 prize money to be distributed 1st through 8th

The winner receives \$500 in Voltaire Design accessories

Formal attire required; salute to sponsor requested



Denise Youell and Verdi de Laume cruising to a second-place finish in the Need for Speed Open Jumper during the 2025 Cascade Classic. Owner: Farpoint Farm, Inc.

JUMPER CLASSICS

Class #	Class	Height	Entry Fee	Prize Money
71	Open Jumper Classic .70m	.70m	\$60/class	\$250
72	Open Jumper Classic .80m	.80m	\$60/class	\$250
73	Open Jumper Classic .90m	.90m	\$60/class	\$250

Formal Attire Required — Salute to Sponsors Requested

Prize Money — 25%, 23%, 20%, 17%, 15%

Jumper Classic riders must have ridden in at least 1 other class to compete.



**Excited to be a Sponsor & Vendor at
Cascade's Cle Elum Shows!**



2221 NE 3rd St · Bend, Oregon · 541-388-3855 · www.TheAbsoluteHorse.com · AbsoluteHorse@gmail.com

JUMPER SECTIONS

Class #	Class	Height	Entry Fee	Prize Money
100, 101, 102, 103	Jumper .60m	.60m	\$55/class	
105, 106, 107, 108	Jumper .70m	.70m	\$55/class	
120, 121, 122, 123	Jumper .80m	.80m	\$55/class	
140, 141, 142, 143	Jumper .90m	.90m	\$55/class	
160, 161, 162, 163	Jumper 1.00m	1.00m	\$55/class	
170, 171, 172, 173	Jumper 1.10m	1.10m	\$60/class	\$100
175, 176, 177, 178	Jumper 1.15m	1.15m	\$60/class	\$100
180, 181, 182, 183	Jumper 1.20m	1.20m	\$60/class	\$250
185, 186, 187	Jumper 1.30m	1.30m	\$60/class	\$250
190, 191, 192	Jumper 1.40m	1.40m	\$60/class	\$250
200, 201, 202	Young Jumper .90m	.90m	\$60/class	\$100
205, 206, 207	Young Jumper 1.00m	1.00m	\$60/class	\$100
210, 211, 212	Young Jumper 1.10m	1.10m	\$60/class	\$100
220, 221, 222	Young Jumper 1.20m	1.20m	\$60/class	\$200
225, 226, 227	Young Jumper 1.30m	1.30m	\$60/class	\$200
230, 231, 232, 233	Thoroughbred Jumper 1.00m	1.00m	\$60/class	\$100
245, 246, 247	Junior/Amateur Jumper 1.20m	1.20m	\$60/class	\$100
250, 251, 252, 253	Amateur Jumper .90m	.90m	\$55/class	
255, 256, 257, 258	Junior Jumper .90m	.90m	\$55/class	
260, 261, 262, 263	Amateur Jumper 1.00m	1.00m	\$55/class	
265, 266, 267, 268	Junior Jumper 1.00m	1.00m	\$55/class	
270, 271, 272, 273	Amateur Jumper 1.10m	1.10m	\$55/class	
275, 276, 277, 278	Junior Jumper 1.10m	1.10m	\$55/class	
280, 281, 282	Pony Jumper .60m, .70m, .80m	.60m, .70m, .80m	\$55/class	
285, 286, 287	Non-Pro Jumper .60m	.60m	\$55/class	
290, 291, 292, 293	Non-Pro Jumper .70m	.70m	\$55/class	
295, 296, 297, 298	Non-Pro Jumper .80m	.80m	\$55/class	

Class # footnotes: 2 = Stake

Sections may be split by age group if there are more than 5 horses in each section

Stake Classes: Must have ridden in at least one other class in the same section at the same show to ride in any Stake Class

PNW Young Jumpers: Open to jumpers with papers indicating a foaling date the number of years as indicated prior to the current calendar year. WSHJA membership required to qualify for PNW championship. ^ = Clear rounds

YJC Young Jumpers: Open to all horses. January 1 is the universal birthdate. To qualify for championships must be enrolled with USHJA YJC. Full details at [USHJA.org](https://www.ushja.org). ^ = Clear rounds

Thoroughbred Jumper: Thoroughbred registration verification required according to USEF JP 120. Affiliated with the TAKE2 Thoroughbred League. Points count for USEF and TAKE2

Children's & Adult Amateur jumper riders may not cross-enter classes with fences over 1.15m

Low Children's & Low Adult Amateur horse and rider combinations may not cross-enter the High Children's & High Adult Amateur Jumpers

High Children's & High Adult Amateur horse and rider combinations may not cross-enter the Low Children's & Low Adult Amateur Jumpers

JUMPER WARM-UP CLASSES (NON-RATED)

Class #	Class	Height	Entry Fee	Prize Money
685	Warm-Up Jumper .60m	.60m	\$50/class	
687	Warm-Up Jumper .70m	.70m	\$50/class	
690	Warm-Up Jumper .80m	.80m	\$50/class	
695	Warm-Up Jumper .90m	.90m	\$50/class	



Sponsor Sage Block, left, joins Cascade competition manager Jennifer Hansen and partner Jessica Vania in presenting prizes to the winners of the Rising Stars Leadline during the 2025 Cascade Classic.



#1

SHINE SPRAY ON THE MARKET

“ THE QUALITY OF EQUIFUSE SHINE IS SIMPLY

perfection in a bottle.

IT'S THE ONLY COAT SHINE SPRAY I TRUST ON MY SENSITIVE MARE. ”



LINDSEY DENOBREGA, EQUIFUSE USER

CHAMPIONSHIPS OFFERED

Hunter Section Championships

Adult Amateur Hunter 18-39 3' (Z)	High Performance Hunter 3'9" (B)	Short Stirrup Hunter Horse 17 & Under 2'3" (AK)
Adult Amateur Hunter 40 & Over 3' (AA)	Junior Hunter 14 & Under 3'3" (V)	Short Stirrup Hunter Pony 17 & Under 18" (AL)
Amateur Owner Hunter 18-35 3'3" (O)	Junior Hunter 14 & Under 3'6" (R)	Small Hunter 3' (AN)
Amateur Owner Hunter 18-35 3'6" (P)	Junior Hunter 15-17 3'3" (U)	Thoroughbred Hunter 3' (AE)
Amateur Owner Hunter 36 & Over 3'3" (N)	Junior Hunter 15-17 3'6" (Q)	USHJA 2' Hunter (AF)
Amateur Owner Hunter 36 & Over 3'6" (M)	Large Hunter 3' (AO)	USHJA 2'3" Hunter (AG)
Baby Green Hunter 2'6" (AR)	Long Stirrup Hunter 18 & Over 2'3" (AM)	USHJA 2'6" Hunter (AH)
Children's Hunter 13 & Under 3' (AB)	Low Adult Hunter 2'6" (AS)	USHJA 2'9" Hunter (AI)
Children's Hunter 14-17 3' (AC)	Low Children's Hunter 2'6" (AQ)	USHJA 3' Hunter (AJ)
Children's Hunter Pony 2', 2'6" (AD)	Performance Hunter 3'3" (D)	Young Hunter 2'9" - Horses 5 & Under (L)
Green Hunter 3' (H)	Performance Hunter 3'6" (C)	Young Hunter 3' - Horses 6 & Under (K)
Green Hunter 3'3" (G)	Pony Hunter (SML) 2'3", 2'6", 2'9"-3' (W)	Young Hunter 3'3" - Horses 7 & Under (J)
Green Hunter 3'6" (F)	Pre-Adult Hunter 2'9" (BF)	
Green Hunter 3'9" (E)	Pre-Children's Hunter 2'9" (AP)	

Hunter Championships: Hunter champion and reserve will be awarded to two of the four horses scoring the most points over fences. In addition, only these top four horses will receive full points for ribbons won under saddle and half points for ribbons won in model. Points will be awarded 10, 6, 4, 2, 1, ½.

Equitation Section Championships

Adult Equitation 18-39 3' (BB)	Long Stirrup Equitation 2'3" (AU)	Pre-Adult Equitation 2'9" (BG)
Adult Equitation 40 & Over 3' (BC)	Low Adult Equitation 2'6" (AZ)	Pre-Children's Equitation 2'9" (BA)
Children's Pony Equitation 2', 2'6" (AX)	Low Children's Equitation 2'6" (AY)	Short Stirrup Equitation Horse 2'3" (AV)
Equitation 14 & Under 3' (BD)	Pony Equitation 2'3", 2'6", 2'9"-3' (AT)"	Short Stirrup Equitation Pony 18" (AW)
Equitation 15-17 3' (BE)		

Jumper Championships: in jumper championships, points for all classes shall be calculated 10, 6, 4, 2, 1, 1/2. In case of a tie for champion or reserve the tied entries shall remain tied and each receive a ribbon and trophy / prize

Jumper Section Championships

Amateur Jumper .90m	Jumper 1.10m	Junior Jumper 1.10m
Amateur Jumper 1.00m	Jumper 1.15m	Junior/Amateur Jumper 1.20m
Amateur Jumper 1.10m	Jumper 1.20m	Non-Pro Jumper .60m
Jumper .70m	Jumper 1.30m	Non-Pro Jumper .70m
Jumper .80m	Jumper 1.40m	Non-Pro Jumper .80m
Jumper .90m	Junior Jumper .90m	Thoroughbred Jumper 1.00m
Jumper 1.00m	Junior Jumper 1.00m	

Equitation Championships: points for all classes shall be calculated 10, 6, 4, 2, 1, ½. In the case of a tie for champion or reserve, the winner shall be the entry with the most points over fences. If still tied, the entry with the most points in the equitation flat class will win the tie.

All: At least three competitors must compete in the first class of a section for it to run.

Sections codes (in parentheses) allow convenient entry into all classes in section.

SPOTLIGHT CLASSES

Cascade Welcome 1.25m

Presented by Deep Creek Farm

Thursday, June 18, 2026

Thursday, June 25, 2026

The \$1,000 Cascade Welcome is a thrilling 1.25m Table II, Sec 2(a) jumper class—Time first with a jump off; ties to jump off for first place

\$1,000 prize money distributed 1st through 6th 30%, 23%, 15%, 12%, 10%, 10%

Traditional attire encouraged; salute to sponsor requested

Owner/rider Sarah Rose Berg pilots Diamanto R to a second-place finish in the Cascade Welcome during the 2025 Cascade Classic.



SCHEDULES: CASCADe CLASSIC

June 17-21, 2026

2026 Cascade Classic

Wednesday, June 17, 2026

Grand Hunter Arena

Presented by Friends of Cascade

8:00 AM

670	Warm-Up Hunter 3'6"
325, 326	Green Hunter 3'6"
310, 311	Performance Hunter 3'6"
675	Warm-Up Hunter 3'9"
305, 306	High Performance Hunter 3'9"
320, 321	Green Hunter 3'9"
660	Warm-Up Hunter 3'3"
315, 316	Performance Hunter 3'3"
330, 331	Green Hunter 3'3"
345, 346	Young Hunter 3'3" - Horses 7 & Under
650	Warm-Up Hunter 3'
335, 336	Green Hunter 3'
350, 351	Young Hunter 3' - Horses 6 & Under
450, 451	Small Hunter 3'
515, 516	Large Hunter 3'
480	USHJA 3' Hunter
455, 456	Thoroughbred Hunter 3'
640	Warm-Up Hunter 2'9"
355, 356	Young Hunter 2'9" - Horses 5 & Under
357 ³	Young Hunter 2'9" - Horses 5 & Under U/S
475	USHJA 2'9" Hunter
476 ³	USHJA 2'9" Hunter U/S
630	Warm-Up Hunter 2'6"
535	Baby Green Hunter 2'6"
470	USHJA 2'6" Hunter
620	Warm-Up Hunter 2'3"
465	USHJA 2'3" Hunter
466 ³	USHJA 2'3" Hunter U/S

Cascade Hunter Arena

Presented by WA State Hunter Jumper Association

9:00 AM

610	Warm-Up Hunter 2'
460	USHJA 2' Hunter
461 ³	USHJA 2' Hunter U/S
900	Opportunity Schooling

Grand Jumper Arena

Presented by Farpoint Farm

8:00 AM

685	Warm-Up Jumper .60m
100	Jumper .60m
687	Warm-Up Jumper .70m IV.1
105	Jumper .70m II.2b
690	Warm-Up Jumper .80m IV.1
120	Jumper .80m II.2b
695	Warm-Up Jumper .90m IV.1
200	Young Jumper .90m II
140	Jumper .90m II.2b
205	Young Jumper 1.00m II.2b
160	Jumper 1.00m II.2b
230	Thoroughbred Jumper 1.00m II.2b
210	Young Jumper 1.10m II.2b
170	Jumper 1.10m II.2b
175	Jumper 1.15m II.2b
220	Young Jumper 1.20m II.2b
180	Jumper 1.20m II.2b
245	Junior/Amateur Jumper 1.20m II.2b
225	Young Jumper 1.30m II.2b
185	Jumper 1.30m II.2b
190	Jumper 1.40m II.2b

Class # footnotes: 1 = Handy; 2 = Stake; 3 = Under Saddle; *italics* = Conformation

2026 Cascade Classic

Thursday, June 18, 2026

Grand Hunter Arena

Presented by Friends of Cascade

8:00 AM

- 327, 328 Green Hunter 3'6"
- 312, 313¹ Performance Hunter 3'6"
- 314³ Performance Hunter 3'6" U/S
- 329³ Green Hunter 3'6" U/S
- 307, 308¹ High Performance Hunter 3'9"
- 322, 323¹ Green Hunter 3'9"
- 309³ High Performance Hunter 3'9" U/S
- 324³ Green Hunter 3'9" U/S
- 317³ Performance Hunter 3'3" U/S
- 332³ Green Hunter 3'3" U/S
- 347³ Young Hunter 3'3" - Horses 7 & Under U/S
- 318, 319¹ Performance Hunter 3'3"
- 348, 349 Young Hunter 3'3" - Horses 7 & Under
- 333, 334 Green Hunter 3'3"
- 651 Warm-Up Hunter 3'
- 337³ Green Hunter 3' U/S
- 338, 339 Green Hunter 3'
- 352, 353 Young Hunter 3' - Horses 6 & Under
- 481, 482 USHJA 3' Hunter
- 457 Thoroughbred Hunter 3'
- 452 Small Hunter 3'
- 517 Large Hunter 3'
- 354³ Young Hunter 3' - Horses 6 & Under U/S
- 453³ Small Hunter 3' U/S
- 518³ Large Hunter 3' U/S
- 483³ USHJA 3' Hunter U/S
- 458³ Thoroughbred Hunter 3' U/S
- 358, 359 Young Hunter 2'9" - Horses 5 & Under
- 477, 478 USHJA 2'9" Hunter
- 536, 537 Baby Green Hunter 2'6"
- 538³ Baby Green Hunter 2'6" U/S
- 471, 472 USHJA 2'6" Hunter
- 473³ USHJA 2'6" Hunter U/S
- 467, 468 USHJA 2'3" Hunter
- 48 Cascade Hunter Classic 2'3"

Cascade Hunter Arena

Presented by WA State Hunter Jumper Association

8:00 AM

- 462, 463 USHJA 2' Hunter
- 47 Cascade Hunter Classic 2'**
- 970, 971 Opportunity Walk/Trot Poles Equitation O/F
- 925, 926 Opportunity Cross Pole Equitation O/F
- 972³ Opportunity Walk/Trot Poles Equitation Not to jump
- 927³ Opportunity Cross Pole Equitation Not to jump
- 920³ Opportunity Walk/Trot/Canter Equitation Not to jump

Grand Jumper Arena

Presented by Farpoint Farm

8:00 AM

- 101 Jumper .60m
- 285 Non-Pro Jumper .60m
- 106 Jumper .70m IV.2b
- 290 Non-Pro Jumper .70m
- 121 Jumper .80m II.2b
- 295 Non-Pro Jumper .80m
- 280 Pony Jumper .60m, .70m, .80m II.2b
- 201 Young Jumper .90m II.2b
- 141 Jumper .90m II.1
- 250 Amateur Jumper .90m II.2b
- 255 Junior Jumper .90m II.2b
- 206 Young Jumper 1.00m II.2b
- 161 Jumper 1.00m II.1
- 231 Thoroughbred Jumper 1.00m II.2b
- 260 Amateur Jumper 1.00m II.2b
- 265 Junior Jumper 1.00m II.2b
- 171 Jumper 1.10m II.1
- 211 Young Jumper 1.10m II.2b
- 270 Amateur Jumper 1.10m II.2b
- 275 Junior Jumper 1.10m II.2b
- 176 Jumper 1.15m II.1
- 221 Young Jumper 1.20m II.2b
- 181 Jumper 1.20m II.1
- 246 Junior/Amateur Jumper 1.20m II.1
- 226 Young Jumper 1.30m II.2b
- 186 Jumper 1.30m II.2b
- 191 Jumper 1.40m II.2b
- 38 Cascade Welcome 1.25m II.2a**

Class # footnotes: 1 = Handy; 2 = Stake; 3 = Under Saddle; *italics* = Conformation

2026 Cascade Classic

Friday, June 19, 2026

Grand Hunter Arena

Presented by Friends of Cascade

8:00 AM

- 652 Warm-Up Hunter 3'
- 730, 731 Equitation 14 & Under 3' O/F
- 733, 734 Equitation 15-17 3' O/F
- 732³ Equitation 14 & Under 3' Not to jump
- 735³ Equitation 15-17 3' Not to jump
- 724, 725 Adult Equitation 18-39 3' O/F
- 727, 728 Adult Equitation 40 & Over 3' O/F
- 817 Northwest Foundation Medal 3' 14 & Under
- 801 WSHJA Good Hands & Seat 3'
- 726³ Adult Equitation 18-39 3' Not to jump
- 729³ Adult Equitation 40 & Over 3' Not to jump
- 661 Warm-Up Hunter 3'3"
- 370, 371 Amateur Owner Hunter 18-35 3'3"
- 375, 376 Amateur Owner Hunter 36 & Over 3'3"
- 405, 406 Junior Hunter 14 & Under 3'3"
- 400, 401 Junior Hunter 15-17 3'3"
- 816 USEF Adult Equitation 3'3"
- 807 USEF/NCEA Junior Hunter Seat Medal 3'3"
- 671 Warm-Up Hunter 3'6"
- 360, 361 Amateur Owner Hunter 18-35 3'6"
- 365, 366 Amateur Owner Hunter 36 & Over 3'6"
- 385, 386 Junior Hunter 14 & Under 3'6"
- 380, 381 Junior Hunter 15-17 3'6"
- 802 WSHJA Good Hands & Seat 3'6"
- 641 Warm-Up Hunter 2'9"
- 736, 737 Pre-Adult Equitation 2'9" O/F
- 721, 722 Pre-Children's Equitation 2'9" O/F
- 738³ Pre-Adult Equitation 2'9" Not to jump
- 723³ Pre-Children's Equitation 2'9" Not to jump
- 631 Warm-Up Hunter 2'6"
- 715, 716 Low Children's Equitation 2'6" O/F
- 718, 719 Low Adult Equitation 2'6" O/F
- 800 WSHJA Good Hands & Seat 2'6"
- 717³ Low Children's Equitation 2'6" Not to jump
- 720³ Low Adult Equitation 2'6" Not to jump
- 680 Warm-Up Pony Hunter (respective heights)
- 700, 701 Pony Equitation 2'3", 2'6", 2'9"-3' O/F (respective heights)
- 702³ Pony Equitation 2'3", 2'6", 2'9"-3' Not to jump

30 Cascade Hunter Team Trials 2'6"

Presented by Tiffany & Equestrians

3 USHJA National Hunter Derby

Presented by Altura Hunters & Jumpers

28 USHJA 2'6" Junior/Amateur Hunter Derby

Cascade Hunter Arena

Presented by WA State Hunter Jumper Association

8:00 AM

- 621 Warm-Up Hunter 2'3"
- 706, 707 Short Stirrup Equitation Horse 2'3" O/F
- 703, 704 Long Stirrup Equitation 2'3" O/F
- 708³ Short Stirrup Equitation Horse 2'3" Not to jump
- 705³ Long Stirrup Equitation 2'3" Not to jump
- 625 Warm-Up Hunter 2'3", 2'6", 2'9" (respective heights)
- 712, 713 Children's Pony Equitation 2', 2'6" O/F (respective heights)
- 714³ Children's Pony Equitation 2', 2'6" Not to jump
- 600 Warm-Up Hunter 18"
- 709, 710 Short Stirrup Equitation Pony 18" O/F
- 711³ Short Stirrup Equitation Pony 18" Not to jump
- 928, 929 Opportunity Cross Pole Equitation O/F
- 973, 974 Opportunity Walk/Trot Poles Equitation O/F

Grand Jumper Arena

Presented by Farpoint Farm

8:00 AM

- 142 Jumper .90m II.2c
- 251 Amateur Jumper .90m II.2c
- 256 Junior Jumper .90m II.2c
- 162 Jumper 1.00m II.2c
- 232 Thoroughbred Jumper 1.00m II.2d
- 261 Amateur Jumper 1.00m
- 266 Junior Jumper 1.00m
- 172 Jumper 1.10m II.2c
- 271 Amateur Jumper 1.10m II.2d
- 276 Junior Jumper 1.10m II.2d
- 177 Jumper 1.15m II.2c
- 182 Jumper 1.20m II.2c
- 247 Junior/Amateur Jumper 1.20m II.2d
- 227 Young Jumper 1.30m II.2d
- 187 Jumper 1.30m II.2c
- 192 Jumper 1.40m II.2c
- 102 Jumper .60m
- 286 Non-Pro Jumper .60m II.2d
- 107 Jumper .70m II.2c
- 291 Non-Pro Jumper .70m II.2d
- 122 Jumper .80m II.2c
- 296 Non-Pro Jumper .80m II.2d
- 281 Pony Jumper .60m, .70m, .80m II.2d

Class # footnotes: 1 = Handy; 2 = Stake; 3 = Under Saddle; *italics* = Conformation

2026 Cascade Classic

Saturday, June 20, 2026

Grand Hunter Arena

Presented by Friends of Cascade

After USHJA Jumper Medal Class

- 372, 373¹ Amateur Owner Hunter 18-35 3'3"
- 377, 378¹ Amateur Owner Hunter 36 & Over 3'3"
- 374³ Amateur Owner Hunter 18-35 3'3" U/S
- 379³ Amateur Owner Hunter 36 & Over 3'3" U/S
- 407, 408¹ Junior Hunter 14 & Under 3'3"
- 402, 403¹ Junior Hunter 15-17 3'3"
- 805 Hamel Foundation NHS Medal 3'3"
- 815 USHJA 3'3" Hunter Seat Medal
- 409³ Junior Hunter 14 & Under 3'3" U/S
- 404³ Junior Hunter 15-17 3'3" U/S
- 362, 363¹ Amateur Owner Hunter 18-35 3'6"
- 367, 368¹ Amateur Owner Hunter 36 & Over 3'6"
- 364³ Amateur Owner Hunter 18-35 3'6" U/S
- 369³ Amateur Owner Hunter 36 & Over 3'6" U/S
- 387, 388¹ Junior Hunter 14 & Under 3'6"
- 382, 383¹ Junior Hunter 15-17 3'6"
- 803 ASPCA Maclay Horsemanship Medal 3'6"
- 804 Dover Saddlery/USEF Hunter Seat Medal 3'6"
- 389³ Junior Hunter 14 & Under 3'6" U/S
- 384³ Junior Hunter 15-17 3'6" U/S
- 653 Warm-Up Hunter 3'
- 425, 426 Adult Amateur Hunter 18-39 3'
- 430, 431 Adult Amateur Hunter 40 & Over 3'
- 809 Ariat National Adult Medal 3'
- 813 OHJA Adult Medal 3'
- 435, 436 Children's Hunter 13 & Under 3'
- 440, 441 Children's Hunter 14-17 3'
- 808 Taylor Harris Ins. National Children's Medal 3'
- 812 OHJA Children's Medal 3'
- 427³ Adult Amateur Hunter 18-39 3' U/S
- 432³ Adult Amateur Hunter 40 & Over 3' U/S
- 437³ Children's Hunter 13 & Under 3' U/S
- 442³ Children's Hunter 14-17 3' U/S
- 545, 546 Pre-Adult Hunter 2'9"
- 547³ Pre-Adult Hunter 2'9" U/S
- 520, 521 Pre-Children's Hunter 2'9"
- 522³ Pre-Children's Hunter 2'9" U/S
- 632 Warm-Up Hunter 2'6"
- 525, 526 Low Children's Hunter 2'6"
- 530, 531 Low Adult Hunter 2'6"
- 811 OHJA Mini Medal 2'6"
- 527³ Low Children's Hunter 2'6" U/S
- 532³ Low Adult Hunter 2'6" U/S
- 681 Warm-Up Pony Hunter (respective heights)
- 810 Marshall & Sterling U.S. Pony Medal 2'3", 2'6", 2'9"-3' (respective heights)
- 410, 411¹ Pony Hunter (SML) 2'3", 2'6", 2'9"-3' (respective heights)
- 412³ Pony Hunter (SML) 2'3", 2'6", 2'9"-3' U/S (respective heights)

Cascade Hunter Arena

Presented by WA State Hunter Jumper Association

8:00 AM

- 622 Warm-Up Hunter 2'3"
- 500, 501 Short Stirrup Hunter Horse 17 & Under 2'3"
- 510, 511 Long Stirrup Hunter 18 & Over 2'3"
- 502³ Short Stirrup Hunter Horse 17 & Under 2'3" U/S
- 512³ Long Stirrup Hunter 18 & Over 2'3" U/S
- 445, 446 Children's Hunter Pony 2', 2'6" (respective heights)
- 447³ Children's Hunter Pony 2', 2'6" U/S (respective heights)
- 505, 506 Short Stirrup Hunter Pony 17 & Under 18"
- 507³ Short Stirrup Hunter Pony 17 & Under 18" U/S
- 975, 976 Opportunity Walk/Trot Poles Equitation O/F
- 930, 931 Opportunity Cross Pole Equitation O/F

13 Hobby Horse Classic

Presented by Cascade Partners

Grand Jumper Arena

Presented by Farpoint Farm

8:00 AM

- 806 EMO Insurance/USHJA Jumping Seat Medal 3'3"
- 814 USHJA Jumping Seat Medal 3'3"
- 103 Jumper .60m II.2b
- 287 Non-Pro Jumper .60m II.1
- 108 Jumper .70m II.2b
- 292 Non-Pro Jumper .70m II.1
- 123 Jumper .80m II.2b
- 297 Non-Pro Jumper .80m II.1
- 282 Pony Jumper .60m, .70m, .80m II.1
- 202 Young Jumper .90m II
- 143 Jumper .90m II.2b
- 252 Amateur Jumper .90m II.1
- 257 Junior Jumper .90m II.1
- 207 Young Jumper 1.00m
- 163 Jumper 1.00m II.2b
- 233 Thoroughbred Jumper 1.00m II.1
- 262 Amateur Jumper 1.00m II.2c
- 267 Junior Jumper 1.00m II.2c
- 212 Young Jumper 1.10m II.2d
- 173 Jumper 1.10m II.2b
- 272 Amateur Jumper 1.10m II.2b
- 277 Junior Jumper 1.10m II.2b
- 178 Jumper 1.15m II.2b
- 222 Young Jumper 1.20m II.2d
- 183 Jumper 1.20m II.1
- 22 **Cascade Equitation Challenge**
- Presented by Equidae Farm*
- 16 **Rising Stars™ Leadline**
- 1 **Barn Pros Grand Prix II.2a**
- Presented by Barn Pros Nationwide*

Class # footnotes: 1 = Handy; 2 = Stake; 3 = Under Saddle; *italics* = Conformation

2026 Cascade Classic

Sunday, June 21, 2026

Grand Hunter Arena

Presented by Friends of Cascade

9:00 AM

- 428 Adult Amateur Hunter 18-39 3'
- 433 Adult Amateur Hunter 40 & Over 3'
- 438 Children's Hunter 13 & Under 3'
- 443 Children's Hunter 14-17 3'
- 52 **Children's/Adult Hunter Classic 3'**
- 29 **USHJA Zone 9 Handy Hunter Challenge 3'**
- 548 Pre-Adult Hunter 2'9"
- 523 Pre-Children's Hunter 2'9"
- 41 **Pre-Children's/Adult Hunter Classic 2'9"**
- 528 Low Children's Hunter 2'6"
- 533 Low Adult Hunter 2'6"
- 42 **Low Children's/Adult Hunter Classic 2'6"**
- 413 Pony Hunter (SML) 2'3", 2'6", 2'9"-3' (respective heights)
- 40 **Pony Hunter Classic 2'3", 2'6", 2'9"-3' (respective heights)**

Cascade Hunter Arena

Presented by WA State Hunter Jumper Association

8:00 AM

- 448 Children's Hunter Pony 2', 2'6" (respective heights)
- 44 **Children's Hunter Pony Classic 2', 2'6" (respective heights)**
- 503 Short Stirrup Hunter Horse 17 & Under 2'3"
- 513 Long Stirrup Hunter 18 & Over 2'3"
- 45 **Short/Long Stirrup Hunter Classic 2'3"**
- 508 Short Stirrup Hunter Pony 17 & Under 18"
- 46 Short Stirrup Hunter Pony Classic 18"

Grand Jumper Arena

Presented by Farpoint Farm

8:00 AM

- 7 **Luxury DerbyCross™ 3'3" | 1.00m**
- 273 Amateur Jumper 1.10m II.2b
- 278 Junior Jumper 1.10m II.2b
- 20 **Need for Speed™ Open Jumper 1.00m III**
- 20 **Need for Speed™ Open Jumper 1.10m III**
- 263 Amateur Jumper 1.00m II.2b
- 268 Junior Jumper 1.00m II.2b
- 253 Amateur Jumper .90m II.2b
- 258 Junior Jumper .90m II.2b
- 73 **Open Jumper Classic .90m II.2b**
- 298 Non-Pro Jumper .80m II.2b
- 72 **Open Jumper Classic .80m II.2b**
- 293 Non-Pro Jumper .70m II.2b
- 71 **Open Jumper Classic .70m II.2b**

Class # footnotes: 1 = Handy; 2 = Stake; 3 = Under Saddle; *italics* = Conformation

SPOTLIGHT CLASSES

Hobby Horse Classic

Presented by **Cascade Partners**

Saturday, June 20, 2026

A combined event challenging the under-21 set to a hobby horse competition. (Who said the adults should have all the fun?)

New for 2026! Hobby (stick) horses will be used instead of bouncy horses. Bring your own hobby horse or make one at the show!

\$10 entry fee (cash or Venmo only)

Three age groups: 8 & under, 9 – 13, and 14 – 20

Ribbons through third. The winner in each bracket takes home a hobby horse!

Sign up in the Prize Store!



The competition was fierce—and fun—in the 2025 No Joke, Hold My Coke Classic! This year's competition will feature hobby (stick) horses.



2026 CASCADE OPEN

June 24 – June 28, 2026
USEF #332619

Owner/rider Patrick Billes and Espartano LS take a well-deserved victory lap after winning the \$10,000 Horseware Grand Prix at the 2025 Cascade Open.

SPOTLIGHT CLASSES

Class #	Class	Height	Entry Fee	Prize Money
4	Horseware Grand Prix <i>Presented by The Absolute Horse</i>	1.25m	\$395/class	\$9,999
31	USHJA National Hunt & Go <i>Presented by Altura Hunters & Jumpers</i>	3' with 3'5" options	\$200/class	\$2,500
28	USHJA 2'6" Junior/Amateur Hunter Derby	2'6"	\$100/class	\$1,000
38	Cascade Welcome 1.25m	1.25m	\$100/class	\$1,000
25	Luxury DerbyCross™ 3' .90m	Hunter course: 3', Jumper course: .90m	\$100/class	\$1,000
9	Jumpernite Rider Relay 1.00m <i>Presented by Jumpernite</i>	1.00m	\$80/class	\$750
20	Need for Speed™ Open Jumper 1.00 or 1.10m	1.00 or 1.10m	\$75/class	\$750
11	Rosé All Day Amateur Classic <i>Presented by Brass Ring Farm</i>	N/A	\$55/class	\$500
16	Rising Stars™ Leadline	N/A	Free	
17	Cascade Canine Derby <i>Presented by Inkspiration Crafts</i>	Varied	\$10/class	

Formal Attire Required — Salute to Sponsors Requested

USHJA National Hunter Derby: Special recognition for the top 3 Amateurs/Juniors

See full class specifications here: [Specifications](#) on page 79.

HUNTER CLASSICS

Class #	Class	Height	Entry Fee	Prize Money
41	Pre-Children's/Adult Hunter Classic 2'9"	2'9"	\$60/class	\$250
42	Low Children's/Adult Hunter Classic 2'6"	2'6"	\$60/class	\$250
44	Children's Hunter Pony Classic 2', 2'6"	2', 2'6"	\$60/class	\$250
45	Short/Long Stirrup Hunter Classic 2'3"	2'3"	\$60/class	\$250
46	Short Stirrup Hunter Pony Classic 18"	18"	\$60/class	\$250
52	Children's/Adult Hunter Classic 3'	3'	\$60/class	\$250

Formal Attire Required — Salute to Sponsors Requested

Prize Money — 30%, 25%, 20%, 15%, 10%

All Classics are 2 rounds. The last class of the corresponding division to be the first round of the class. Round 2 to be shown over a course of at least 10 obstacles. Hunter Classic riders must have ridden in at least 2 hunter classes in their division to compete.

SPOTLIGHT CLASSES

Rosé All Day Amateur Classic

Presented by **Brass Ring Farm**

Friday, June 26, 2026

Run in the spirit of a traditional Hunter Hack for all 21 and older amateur riders...
How much will be left in *your* glass?

\$500 prize money distributed 1st through 5th

The winner takes home a case of rosé wine, bottles to 8th place

Traditional attire encouraged; salute to sponsor requested



Shadin Al-Arab and Cairo throw caution to the wind during the Rosé All Day Amateur Classic at the 2025 Cascade Open.

USEF REGIONAL I-RATED HUNTER SECTIONS

Class #	Class (Section Code)	Height	Entry Fee	Prize Money
315, 316 ¹ , 317 ³	Performance Hunter 3'3" (D)	3'3"	\$165/section or \$60/class	\$150/\$100 U/S
330, 331, 332 ³	Green Hunter 3'3" (G)	3'3"	\$165/section or \$60/class	\$150/\$100 U/S
335, 336, 337	Green Hunter 3' (H)	3'	\$165/section or \$60/class	\$150/\$100 U/S
345, 346, 347 ³	Young Hunter 3'3" - Horses 7 & Under (J)	3'3"	\$150/section or \$55/class	\$100/\$75 U/S
350, 351, 352 ³	Young Hunter 3' - Horses 6 & Under (K)	3'	\$150/section or \$55/class	\$100/\$75 U/S
355, 356, 357 ³	Young Hunter 2'9" - Horses 5 & Under (L)	2'9"	\$150/section or \$55/class	\$100/\$75 U/S

Class # footnotes: 1 = Handy; 2 = Stake; 3 = Under Saddle; italics = Conformation

Green Hunter: Reference [US Equestrian Rule Book HU](#) for Green Hunter Eligibility and Status. Jog for soundness (Option A per HU118.3). Horse may compete in only one green hunter fence height section at any one competition.

Young Hunter: Reference [US Equestrian Rule Book HU](#) for Young Hunter Eligibility and Status. Not to Jog.

Sections may be combined if fewer than 4 entries in section.

ALL HUNTER CLASSES WILL BE JUDGED ON PERFORMANCE AND SOUNDNESS UNLESS OTHERWISE NOTED

Truwe Esser thanks her partner OE Ramble On following their round in the USHJA National Hunter Derby during the 2025 Cascade Open. Trainer: Courtney Palmer-McGlothorn.



USEF REGIONAL II AND NON-RATED HUNTER SECTIONS

Class #	Class (Section Code)	Height	Entry Fee	Prize Money
425, 426, 427 ³ , 428	Adult Amateur Hunter 18-39 3' (Z)	3'	\$200/section or \$55/class	
430, 431, 432 ³ , 433	Adult Amateur Hunter 40 & Over 3' (AA)	3'	\$200/section or \$55/class	
435, 436, 437 ³ , 438	Children's Hunter 13 & Under 3' (AB)	3'	\$200/section or \$55/class	
440, 441, 442 ³ , 443	Children's Hunter 14-17 3' (AC)	3'	\$200/section or \$55/class	
445, 446, 447 ³ , 448	Children's Hunter Pony 2', 2'6" (AD)	2', 2'6"	\$200/section or \$55/class	
455, 456, 457 ³	Thoroughbred Hunter 3' (AE)	3'	\$150/section or \$55/class	Stake \$250
460 ³ , 461, 462	USHJA 2' Hunter (AF)	2'	\$150/section or \$55/class	
465 ³ , 466, 467	USHJA 2'3" Hunter (AG)	2'3"	\$150/section or \$55/class	
470 ³ , 471, 472	USHJA 2'6" Hunter (AH)	2'6"	\$150/section or \$55/class	
475, 476, 477 ³	USHJA 2'9" Hunter (AI)	2'9"	\$150/section or \$55/class	
480, 481, 482 ³	USHJA 3' Hunter (AJ)	3'	\$150/section or \$55/class	
500, 501, 502 ³ , 503	Short Stirrup Hunter Horse 17 & Under 2'3" (AK)	2'3"	\$200/section or \$55/class	
505, 506, 507 ³ , 508	Short Stirrup Hunter Pony 17 & Under 18" (AL)	18"	\$200/section or \$55/class	
510, 511, 512 ³ , 513	Long Stirrup Hunter 18 & Over 2'3" (AM)	2'3"	\$200/section or \$55/class	
520, 521, 522 ³ , 523	Pre-Children's Hunter 2'9" (AP)	2'9"	\$200/section or \$55/class	
525, 526 ³ , 527	Low Children's Hunter 2'6" (AQ)	2'6"	\$150/section or \$55/class	
530, 531, 532 ³ , 533	Low Adult Hunter 2'6" (AS)	2'6"	\$200/section or \$55/class	
535, 536, 537 ³	Baby Green Hunter 2'6" (AR)	2'6"	\$150/section or \$55/class	
545, 546, 547 ³ , 548	Pre-Adult Hunter 2'9" (BF)	2'9"	\$200/section or \$55/class	

Class # footnotes: 1 = Handy; 2 = Stake; 3 = Under Saddle * Indicates a non-rated class.

AA Hunter: To be ridden by amateurs no longer eligible to compete as a Junior. See current [USHJA Zone 9 specifications](#) in this prize list or at [Zone-9 Specifications on USHJA.org](#).

Ponies may not cross into any other rated section at the same show. Riders may compete on a maximum of 1 Children's Hunter horse section at the same show and in any class not to exceed 3' (Exception: Pony Jumpers). Green & Regular Hunter Pony riders may compete on a maximum of 1 additional pony in the Children's Hunter Pony section at the same show.

Thoroughbred Hunters: Thoroughbred registration verification required, see [USEF HU 106.8](#)

USHJA Hunter: Open to all horses and ponies.

Short Stirrup: Rider no cross entry into any other classes except Low Under 3' Short Stirrup Equitation and Short Stirrup Pony or Short Stirrup Horse (as applicable to the class)

Long Stirrup: Riders no cross entry into rated classes 3' & up.

Pre-Children's / Pre-Adult Hunter: Rider no cross entry into rated sections or classes with fences 3'6" or higher. May be split by age group if entries warrant.

Low Children's Hunter: Open to exhibitors who have not yet reached their 18th birthday as of December 1 of the current competition year. Riders may not cross enter at the same competition into any class/ section where fences exceed 2'9".

Low Adult Hunter: Open to exhibitors who have reached their 18th birthday as of December 1 of the current competition year. Riders may not cross enter into any class or section at the same competition where fences exceed 2'9".

Sections may be combined if fewer than 4 entries in section.

ALL HUNTER CLASSES WILL BE JUDGED ON PERFORMANCE AND SOUNDNESS UNLESS OTHERWISE NOTED.

HUNTER WARM-UP CLASSES (NON-RATED)

Class #	Class	Height	Entry Fee	Prize Money
610	Warm-Up Hunter 2'	2'	\$55/class	
620 ³	Warm-Up Hunter 2'3"	2'3"	\$55/class	
630 ³ , 631	Warm-Up Hunter 2'6"	2'6"	\$55/class	
640 ³ , 641	Warm-Up Hunter 2'9"	2'9"	\$55/class	
650, 651, 652	Warm-Up Hunter 3'	3'	\$55/class	
660, 661	Warm-Up Hunter 3'3"	3'3"	\$55/class	
670	Warm-Up Hunter 3'6"	3'6"	\$55/class	
683	Warm-Up Children's Pony 2', 2'6"	2', 2'6"	\$55/class	

Braiding is optional. Not to jog.

Cascade Canine Derby

Presented by **Inkspiration Crafts**

Saturday, June 27

A fan-favorite tradition of our Cascade Open and Cascade Finals shows, the Cascade Canine Derby is a “team” event challenging dogs and their humans over a course of 8 obstacles, with high options!

\$10 entry fee (cash or Venmo only); sign-up in the Prize Store.

Open to all dogs of all sizes and breeds.

Dogs to be judged in two sections: Big Dogs and Little Dogs.

Prizes to 6th, smiles for everyone!



New and Improved!

USHJA Outreach Rewards and Awards

Earn points towards year-end rewards and awards with a free USHJA Outreach Membership!

USHJA Outreach Competitions and Classes provide opportunity to earn national recognition in classes from walk/trot to 3'0" in hunter, equitation, and .60m-1.20m in jumper sections at rated and unrated local shows.

Rewards

Riders and owners of USHJA Outreach registered horses can earn level status and points to redeem at the end of the year for items such as USHJA logo wear, Outreach ribbons or Outreach medallions.

Bronze Level: Riders or horses must earn at least 50-74 points during the competition year

Silver Level: Riders or horses must earn at least 75-99 points during the competition year

Gold Level: Riders or horses must earn at least 100 points during the competition year

Awards

New! Exciting year-end awards will be given to trainers, riders and horses.

Trainers—Earn the USHJA Outreach High Point Trainer Award by being the leading trainer in your zone whose riders have earned 100 or more points cumulatively in USHJA Outreach Classes.

Riders— In addition to awards and rewards, one high point rider from each Zone will earn a Golden Backstage Pass to participate in the USHJA National Championship Affiliate sections and get exclusive access to free educational sessions and National Championship Grand Prix and Hunter Derby course walks!

Horses—While horse recording and microchipping is not required to participate in Outreach classes, owners wishing for their horses to earn points must have them recorded with USHJA (\$20/annual or \$75/lifetime). Horses will have their Outreach points tracked and ranked within their USHJA Zone and displayed on ushja.org.

For more information and to find a USHJA Outreach Competition near you, visit ushja.org/Outreach.

Questions? Contact Melanie Mader at mmader@ushja.org.



USHJA Outreach Champion



USHJA Outreach Champion



USHJA Outreach Champion



USHJA Outreach Champion



USHJA OUTREACH HUNTER CLASSES (NON-RATED)

USEF / USHJA memberships and horse recording are not required.

Class #	Class	Height	Entry Fee	Prize Money
1200	USHJA Outreach Hunter Derby 2'6"-2'9"	2'6" with 2'9" options	\$45/class	
1201	USHJA Outreach Hunter Derby 2'-2'3"	2' with 2'3" options	\$45/class	
1203	USHJA Outreach Hunt & Go 2'-2'3"	2' with 2'3" options	\$45/class	
1205 ³ , 1206, 1207	USHJA Outreach Hunters Walk/Trot Poles		\$120/section or \$45/class	
1210 ³ , 1211, 1212, 1213, 1214	USHJA Outreach Hunters Crossrail		\$200/section or \$45/class	
1215, 1216, 1217 ³ , 1218, 1219	USHJA Outreach Hunters 18"	18"	\$200/section or \$45/class	
1220, 1221, 1222 ³ , 1223, 1224	USHJA Outreach Hunters 2'	2'	\$200/section or \$45/class	
1225, 1226, 1227 ³ , 1228, 1229	USHJA Outreach Hunters 2'3"	2'3"	\$200/section or \$45/class	
1230, 1231, 1232 ³ , 1233, 1234	USHJA Outreach Hunters 2'6"	2'6"	\$200/section or \$45/class	
1235, 1236, 1237 ³ , 1238, 1239	USHJA Outreach Hunters 2'9"	2'9"	\$200/section or \$45/class	

Class # footnotes: 3 = Under Saddle

SCHOOLING

USEF / USHJA memberships and horse recording are not required.

Class #	Class	Height	Entry Fee
1500	Outreach Crossrails Ticketed Schooling	N/A	\$25/class

EQUITATION SECTIONS

Class #	Class (Section Code)	Height	Entry Fee
703 ³ , 704, 705	Long Stirrup Equitation 2'3" (AU)	2'3"	\$150/section or \$55/class
706 ³ , 707, 708	Short Stirrup Equitation Horse 2'3" (AV)	2'3"	\$150/section or \$55/class
709, 710, 711 ³	Short Stirrup Equitation Pony 18" (AW)	18"	\$150/section or \$55/class
712, 713, 714 ³	Children's Pony Equitation 2', 2'6" (AX)	2', 2'6"	\$150/section or \$55/class
715, 716, 717 ³	Low Children's Equitation 2'6" (AY)	2'6"	\$150/section or \$55/class
718, 719, 720 ³	Low Adult Equitation 2'6" (AZ)	2'6"	\$150/section or \$55/class
721, 722, 723 ³	Pre-Children's Equitation 2'9" (BA)	2'9"	\$150/section or \$55/class
724, 725, 726 ³	Adult Equitation 18-39 3' (BB)	3'	\$150/section or \$55/class
727, 728, 729 ³	Adult Equitation 40 & Over 3' (BC)	3'	\$150/section or \$55/class
730, 731, 732 ³	Equitation 14 & Under 3' (BD)	3'	\$150/section or \$55/class
733, 734, 735 ³	Equitation 15-17 3' (BE)	3'	\$150/section or \$55/class
736, 737, 738 ³	Pre-Adult Equitation 2'9" (BG)	2'9"	\$150/section or \$55/class

Class # footnotes: 3 = Not to jump

* Ponies ride respective heights

USHJA OUTREACH EQUITATION (NON-RATED)

USEF / USHJA memberships and horse recording are not required.

Class #	Class	Height	Entry Fee
1300 ³ , 1301 ³	USHJA Outreach Walk/Trot Poles Equitation	N/A	\$80/section or \$45/class
1310, 1311 ³ , 1312, 1313	USHJA Outreach Equitation Crossrail	N/A	\$160/section or \$45/class
1315, 1316, 1317 ³ , 1318, 1319	USHJA Outreach Equitation 18"	18"	\$200/section or \$45/class
1320, 1321, 1322 ³ , 1323, 1324	USHJA Outreach Equitation 2'	2'	\$200/section or \$45/class
1325, 1326, 1327 ³ , 1328, 1329	USHJA Outreach Equitation 2'3"	2'3"	\$200/section or \$45/class
1330, 1331, 1332 ³ , 1333, 1334	USHJA Outreach Equitation 2'6"	2'6"	\$200/section or \$45/class
1335, 1336, 1337 ³ , 1338, 1339	USHJA Outreach Equitation 2'9"	2'6"	\$200/section or \$45/class

Class # footnotes: 3 = Not to jump

Braiding is optional. Not to jog.

MEDAL CLASSES

Class #	Class	Height	Entry Fee
800	WSHJA Good Hands & Seat 2'6"	2'6"	\$55/class
801	WSHJA Good Hands & Seat 3'	3'	\$55/class
802	WSHJA Good Hands & Seat 3'6"	3'6"	\$55/class
803	ASPCA Maclay Horsemanship Medal 3'6"	3'6"	\$55/class
804	Dover Saddlery/USEF Hunter Seat Medal 3'6"	3'6"	\$55/class
805	Hamel Foundation NHS Medal 3'3"	3'3"	\$55/class
807	USEF/NCEA Junior Hunter Seat Medal 3'3"	3'3"	\$55/class
808	Taylor Harris Insurance National Children's Medal 3'	3'	\$55/class
809	Ariat National Adult Medal 3'	3'	\$55/class
811	OHJA Mini Medal 2'6"	2'6"	\$55/class
812	OHJA Children's Medal 3'	3'	\$55/class
813	OHJA Adult Medal 3'	3'	\$55/class
814	USHJA Jumping Seat Medal 3'3"	3'3"	\$55/class
817	Northwest Foundation Medal 3' 14 & Under	3'	\$55/class

WSHJA Medals: Open to juniors and amateurs. Riders must be WSHJA members prior to the start of the class.

ASPCA Maclay: Open to junior members of USEF or Equine Canada who have not reached their 18th birthday in accordance with GR127. Riders and their trainers or coaches must be current members of the National Horse Show Association ("NHS").

Dover Saddlery/USEF Hunter Seat: Open to Individual Junior USEF Members in good standing who have not reached their 18th birthday in accordance with GR127.

USEF/NCEA: NCEA membership is not required to ride the class but only NCEA members receive points and will be included in rankings for the finals

Taylor Harris National Children's Medal: Riders not to compete in any hunter or equitation class 3'9" or higher, or jumper class set above 1.20m at same show

Ariat National Adult Medal: Riders not to compete over jumps that exceed 3'6" or 1.20m or higher at same show.

Marshall & Sterling U.S. Pony Medal: Tests young riders, judging their ability to compete over a technical and demanding course of fences.

OHJA Mini Medal: No cross entry with 3' medals. Riders must be OHJA members prior to the start of the class.

OHJA Children's Medal: Riders may not cross-enter junior hunters, junior jumpers, or any 3'6" medal class at the same show. Riders must be OHJA members prior to the start of the class.

OHJA Adult Medal: Riders must be OHJA members prior to the start of the class.

Northwest Foundation Medal. Open to junior riders 14 years of age and under.

JUMPER CLASSICS

Class #	Class	Height	Entry Fee	Prize Money
75	Pony Jumper Classic .60m, .70m, .80m	.60m, .70m, .80m	\$50/class	
78	Junior/Amateur Jumper Classic 1.10m	1.10m	\$60/class	\$250

Formal Attire Required — Salute to Sponsors Requested

Prize Money — 25%, 23%, 20%, 17%, 15%

Jumper Classic riders must have ridden in at least 1 other class to compete.



Olive Trump and Capistrano Cat on their way to a 1st place finish in the \$1,000 Luxury DerbyCross during the 2025 Cascade Open.

JUMPER SECTIONS

Class #	Class	Height	Entry Fee	Prize Money
160, 161, 162	Jumper 1.00m	1.00m	\$55/class	
170, 171, 172	Jumper 1.10m	1.10m	\$60/class	\$100
175, 176, 177, 178	Jumper 1.15m	1.15m	\$60/class	\$100
180, 181, 182, 183	Jumper 1.20m	1.20m	\$60/class	\$250
185, 186, 187	Jumper 1.30m	1.30m	\$60/class	\$250
190, 191, 192	Jumper 1.40m	1.40m	\$60/class	\$250
200, 201, 202	Young Jumper .90m	.90m	\$60/class	\$100
205, 206, 207	Young Jumper 1.00m	1.00m	\$60/class	\$100
210, 211, 212	Young Jumper 1.10m	1.10m	\$60/class	\$100
230, 231, 232	Thoroughbred Jumper 1.00m	1.00m	\$60/class	\$100
245, 246, 247	Junior/Amateur Jumper 1.20m	1.20m	\$60/class	\$100
250, 251, 252, 253	Amateur Jumper .90m	.90m	\$55/class	
255, 256, 257, 258	Junior Jumper .90m	.90m	\$55/class	
260, 261, 262, 263	Amateur Jumper 1.00m	1.00m	\$55/class	
265, 266, 267, 268	Junior Jumper 1.00m	1.00m	\$55/class	
270, 271, 272, 273	Amateur Jumper 1.10m	1.10m	\$55/class	
275, 276, 277, 278	Junior Jumper 1.10m	1.10m	\$55/class	
280, 281, 282	Pony Jumper .60m, .70m, .80m	.60m, .70m, .80m	\$55/class	

PNW Young Jumpers: Open to jumpers with papers indicating a foaling date the number of years as indicated prior to the current calendar year. WSHJA membership required to qualify for PNW championship. ^ = Clear rounds

Thoroughbred Jumper: Thoroughbred registration verification required according to USEF JP 120. Affiliated with the TAKE2 Thoroughbred League. Points count for USEF and TAKE2

Sections may be split by age group if there are more than 5 horses in each section

USHJA OUTREACH JUMPER CLASSES (NON-RATED)

USEF / USHJA memberships and horse recording are not required.

Class #	Class	Height	Entry Fee	Prize Money
1400, 1401, 1402, 1403, 1404, 1405, 1406	USHJA Outreach Jumper .60m	.60m	\$245/section or \$40/class	
1410, 1411, 1412, 1413, 1414, 1415, 1416	USHJA Outreach Jumper .70m	.70m	\$245/section or \$40/class	
1420, 1421, 1422, 1423, 1424, 1425, 1426	USHJA Outreach Jumper .80m	.80m	\$245/section or \$40/class	
1430, 1431, 1432, 1433, 1434, 1435, 1436	USHJA Outreach Jumper .90m	.90m	\$245/section or \$40/class	
1456	USHJA Outreach Jumper Classic .60m	.60m	\$55/class	\$200
1457	USHJA Outreach Jumper Classic .70m	.70	\$55/class	\$200
1458	USHJA Outreach Jumper Classic .80m	.80	\$55/class	\$200
1459	USHJA Outreach Jumper Classic .90m	.90m	\$55/class	\$200

Join WSHJA!

Why become a member?

- Opportunity to participate in the WSHJA Annual Awards Program, earning points towards year-end championships.
- Access to WSHJA Scholarships to financially aid in attending Equitation, Hunter, and Jumper Finals.
- Exclusive invitations to and discounts on educational events, including judge's clinics, trainer symposiums, and much more!
- Access to a community of horse-loving individuals who share your interest and passion for the horse.



WASHINGTON STATE
HUNTER JUMPER ASSOCIATION

2026 WSHJA Shows

Spring Inaugural + Outreach
April 1 - 5, 2026

Spring National WCHR
April 8 - 12, 2026

May Outreach Show
May 1 - 3, 2026

WSHJA Pacific Northwest WCHR
May 13 - 17, 2026

Evergreen Classic + Outreach
July 30 - Aug 2, 2026

NW Autumn Classic WCHR + Outreach
Sept. 9 - 12, 2026

October Classic + Outreach
Oct. 14 - 18, 2026

Proud Supporter of



CHAMPIONSHIPS OFFERED

Hunter Section Championships

Adult Amateur Hunter 18-39 3' (Z)	Low Adult Hunter 2'6" (AS)	USHJA 2' Hunter (AF)
Adult Amateur Hunter 40 & Over 3' (AA)	Low Children's Hunter 2'6" (AQ)	USHJA 2'3" Hunter (AG)
Baby Green Hunter 2'6" (AR)	Performance Hunter 3'3" (D)	USHJA 2'6" Hunter (AH)
Children's Hunter 13 & Under 3' (AB)	Pre-Adult Hunter 2'9" (BF)	USHJA 2'9" Hunter (AI)
Children's Hunter 14-17 3' (AC)	Pre-Children's Hunter 2'9" (AP)	USHJA 3' Hunter (AJ)
Children's Hunter Pony 2', 2'6" (AD)	Short Stirrup Hunter Horse 17 & Under 2'3" (AK)	Young Hunter 2'9" - Horses 5 & Under (L)
Green Hunter 3' (H)	Short Stirrup Hunter Pony 17 & Under 18" (AL)	Young Hunter 3' - Horses 6 & Under (K)
Green Hunter 3'3" (G)	Thoroughbred Hunter 3' (AE)	Young Hunter 3'3" - Horses 7 & Under (J)
Long Stirrup Hunter 18 & Over 2'3" (AM)		

Hunter Championships: Hunter champion and reserve will be awarded to two of the four horses scoring the most points over fences. In addition, only these top four horses will receive full points for ribbons won under saddle and half points for ribbons won in model. Points will be awarded 10, 6, 4, 2, 1, ½.

Equitation Section Championships

Adult Equitation 18-39 3' (BB)	Equitation 15-17 3' (BE)	Pre-Adult Equitation 2'9" (BG)
Adult Equitation 40 & Over 3' (BC)	Long Stirrup Equitation 2'3" (AU)	Pre-Children's Equitation 2'9" (BA)
Children's Pony Equitation 2', 2'6" (AX)	Low Adult Equitation 2'6" (AZ)	Short Stirrup Equitation Horse 2'3" (AV)
Equitation 14 & Under 3' (BD)	Low Children's Equitation 2'6" (AY)	Short Stirrup Equitation Pony 18" (AW)

Equitation Championships: points for all classes shall be calculated 10, 6, 4, 2, 1, ½. In the case of a tie for champion or reserve, the winner shall be the entry with the most points over fences. If still tied, the entry with the most points in the equitation flat class will win the tie.

Jumper Section Championships

Amateur Jumper .90m	Jumper 1.15m	Junior Jumper .90m
Amateur Jumper 1.00m	Jumper 1.20m	Junior Jumper 1.00m
Amateur Jumper 1.10m	Jumper 1.30m	Junior Jumper 1.10m
Jumper 1.00m	Jumper 1.40m	Junior/Amateur Jumper 1.20m
Jumper 1.10m		Thoroughbred Jumper 1.00m

Jumper Championships: in jumper championships, points for all classes shall be calculated 10, 6, 4, 2, 1, 1/2. In case of a tie for champion or reserve the tied entries shall remain tied and each receive a ribbon and trophy / prize.

USHJA Outreach Section Championships

USHJA Outreach Hunters 18"	USHJA Outreach Equitation 18"	USHJA Outreach Jumper .60m
USHJA Outreach Hunters 2'	USHJA Outreach Equitation 2'	USHJA Outreach Jumper .70m
USHJA Outreach Hunters 2'3"	USHJA Outreach Equitation 2'3"	USHJA Outreach Jumper .80m
USHJA Outreach Hunters 2'6"	USHJA Outreach Equitation 2'6"	USHJA Outreach Jumper .90m
USHJA Outreach Hunters 2'9"	USHJA Outreach Equitation 2'9"	
USHJA Outreach Hunters Crossrail	USHJA Outreach Equitation Crossrail	
USHJA Outreach Hunters Walk/Trot Poles	USHJA Outreach Walk/Trot Poles Equitation	

Outreach Hunter, Equitation and Jumper Championships: Championships are offered for every Outreach hunter, equitation, and jumper section. Please refer to the class and section tables for a full list of Outreach sections.

All: At least three competitors must compete in the first class of a section for it to run.

SCHEDULES: CASCADE OPEN

June 24 – June 28, 2026

2026 Cascade Open

Wednesday, June 24, 2026

Grand Hunter Arena

Presented by Friends of Cascade

8:00 AM

660	Warm-Up Hunter 3'3"
315, 316 ¹	Performance Hunter 3'3"
330, 331	Green Hunter 3'3"
345, 346	Young Hunter 3'3" - Horses 7 & Under
317 ³	Performance Hunter 3'3" U/S
332 ³	Green Hunter 3'3" U/S
347 ³	Young Hunter 3'3" - Horses 7 & Under U/S
650	Warm-Up Hunter 3'
335, 336, 337	Green Hunter 3'
350, 351	Young Hunter 3' - Horses 6 & Under
480, 481	USHJA 3' Hunter
455, 456	Thoroughbred Hunter 3'
352 ³	Young Hunter 3' - Horses 6 & Under U/S
457 ³	Thoroughbred Hunter 3' U/S
482 ³	USHJA 3' Hunter U/S
640 ³	Warm-Up Hunter 2'9" U/S
355, 356	Young Hunter 2'9" - Horses 5 & Under
475, 476	USHJA 2'9" Hunter
477 ³	USHJA 2'9" Hunter U/S
357 ³	Young Hunter 2'9" - Horses 5 & Under U/S
630 ³	Warm-Up Hunter 2'6" U/S
470 ³	USHJA 2'6" Hunter U/S
471, 472	USHJA 2'6" Hunter
535, 536	Baby Green Hunter 2'6"
537 ³	Baby Green Hunter 2'6" U/S
620 ³	Warm-Up Hunter 2'3" U/S
465 ³	USHJA 2'3" Hunter U/S
466, 467	USHJA 2'3" Hunter
610	Warm-Up Hunter 2'
460 ³	USHJA 2' Hunter U/S
461, 462	USHJA 2' Hunter

Cascade Hunter Arena

Presented by WA State Hunter Jumper Association

8:00 AM

1215, 1216	USHJA Outreach Hunters 18"
1217 ³	USHJA Outreach Hunters 18" U/S
1220, 1221	USHJA Outreach Hunters 2'
1222 ³	USHJA Outreach Hunters 2' U/S
1225, 1226	USHJA Outreach Hunters 2'3"
1227 ³	USHJA Outreach Hunters 2'3" U/S
1230, 1231	USHJA Outreach Hunters 2'6"
1232 ³	USHJA Outreach Hunters 2'6" U/S
1235, 1236	USHJA Outreach Hunters 2'9"
1237 ³	USHJA Outreach Hunters 2'9" U/S
1500	Outreach Crossrails Ticketed Schooling

Grand Jumper Arena

Presented by Farpoint Farm

8:00 AM

1400, 1401	USHJA Outreach Jumper .60m
1410	USHJA Outreach Jumper .70m II.2b
1411	USHJA Outreach Jumper .70m IV.1
1420	USHJA Outreach Jumper .80m II.2b
1421	USHJA Outreach Jumper .80m IV.1
1430	USHJA Outreach Jumper .90m II.2b
1431	USHJA Outreach Jumper .90m IV.1
250	Amateur Jumper .90m II.2c
255	Junior Jumper .90m II.2d
160	Jumper 1.00m II.2d
260	Amateur Jumper 1.00m II.2d
265	Junior Jumper 1.00m II.2b
230	Thoroughbred Jumper 1.00m II.2b
200	Young Jumper .90m II.2b
170	Jumper 1.10m II.2d
205	Young Jumper 1.00m II.2d
270	Amateur Jumper 1.10m II.2c
275	Junior Jumper 1.10m II.2d
175	Jumper 1.15m II.2d
210	Young Jumper 1.10m II.2d
180	Jumper 1.20m II.2d
245	Junior/Amateur Jumper 1.20m II.2d
185	Jumper 1.30m II.2c
190	Jumper 1.40m II.2d

Class # footnotes: 1 = Handy; 2 = Stake; 3 = Under Saddle; *italics* = Conformation

2026 Cascade Open

Thursday, June 25, 2026

Grand Hunter Arena

Presented by Friends of Cascade

8:00 AM

651	Warm-Up Hunter 3'
730, 731	Equitation 14 & Under 3' O/F
733, 734	Equitation 15-17 3' O/F
724, 725	Adult Equitation 18-39 3' O/F
727, 728	Adult Equitation 40 & Over 3' O/F
732 ³	Equitation 14 & Under 3' Not to jump
735 ³	Equitation 15-17 3' Not to jump
726 ³	Adult Equitation 18-39 3' Not to jump
729 ³	Adult Equitation 40 & Over 3' Not to jump
661	Warm-Up Hunter 3'3"
807	USEF/NCEA Junior Hunter Seat Medal 3'3"
641	Warm-Up Hunter 2'9"
736, 737	Pre-Adult Equitation 2'9" O/F
721, 722	Pre-Children's Equitation 2'9" O/F
738 ³	Pre-Adult Equitation 2'9" Not to jump
723 ³	Pre-Children's Equitation 2'9" Not to jump
631	Warm-Up Hunter 2'6"
715, 716	Low Children's Equitation 2'6" O/F
718, 719	Low Adult Equitation 2'6" O/F
800	WSHJA Good Hands & Seat 2'6"
717 ³	Low Children's Equitation 2'6" Not to jump
720 ³	Low Adult Equitation 2'6" Not to jump
683	Warm-Up Children's Pony 2', 2'6"
712, 713	Children's Pony Equitation 2', 2'6" O/F (respective heights)
714 ³	Children's Pony Equitation 2', 2'6" Not to jump

Cascade Hunter Arena

Presented by WA State Hunter Jumper Association

8:00 AM

1218, 1219	USHJA Outreach Hunters 18"
1223, 1224	USHJA Outreach Hunters 2'
1228, 1229	USHJA Outreach Hunters 2'3"
1233, 1234	USHJA Outreach Hunters 2'6"
1238, 1239	USHJA Outreach Hunters 2'9"
1205 ³	USHJA Outreach Hunters Walk/Trot Poles U/S
1210 ³	USHJA Outreach Hunters Crossrail U/S
1206, 1207	USHJA Outreach Hunters Walk/Trot Poles
1211, 1212	USHJA Outreach Hunters Crossrail

Grand Jumper Arena

Presented by Farpoint Farm

8:00 AM

1432, 1433	USHJA Outreach Jumper .90m
251	Amateur Jumper .90m II.1
256	Junior Jumper .90m II.1
161	Jumper 1.00m II.1
231	Thoroughbred Jumper 1.00m II.1
201	Young Jumper .90m II.2b
261	Amateur Jumper 1.00m II.1
266	Junior Jumper 1.00m II.1
171	Jumper 1.10m II.2b
206	Young Jumper 1.00m II.2b
271	Amateur Jumper 1.10m II.2b
276	Junior Jumper 1.10m II.1
176	Jumper 1.15m II.1
211	Young Jumper 1.10m II.2b
181	Jumper 1.20m
246	Junior/Amateur Jumper 1.20m
38	Cascade Welcome 1.25m II.2a
186	Jumper 1.30m
191	Jumper 1.40m
280	Pony Jumper .60m, .70m, .80m
1402	USHJA Outreach Jumper .60m II.2b
1403	USHJA Outreach Jumper .60m II.1
1412	USHJA Outreach Jumper .70m II.2b
1413	USHJA Outreach Jumper .70m II.1
1422	USHJA Outreach Jumper .80m II.2b
1423	USHJA Outreach Jumper .80m II.1

Class # footnotes: 1 = Handy; 2 = Stake; 3 = Under Saddle; *italics* = Conformation

2026 Cascade Open

Friday, June 26, 2026

Grand Hunter Arena

Presented by Friends of Cascade

8:00 AM

- 652 Warm-Up Hunter 3'
- 813 OHJA Adult Medal 3'
- 817 Northwest Foundation Medal 3' 14 & Under
- 801 WSHJA Good Hands & Seat 3'
- 812 OHJA Children's Medal 3'
- 445, 446 Children's Hunter Pony 2', 2'6" (respective heights)
- 447³ Children's Hunter Pony 2', 2'6" U/S (respective heights)
- 706³ Short Stirrup Equitation Horse 2'3" Not to jump
- 703³ Long Stirrup Equitation 2'3" Not to jump
- 707, 708 Short Stirrup Equitation Horse 2'3" O/F
- 704, 705 Long Stirrup Equitation 2'3" O/F
- 709, 710 Short Stirrup Equitation Pony 18" O/F
- 711³ Short Stirrup Equitation Pony 18" Not to jump

11 Rosé All Day Amateur Classic

Presented by Brass Ring Farm

31 USHJA National Hunt & Go

Presented by Altura Hunters & Jumpers

28 USHJA 2'6" Junior/Amateur Hunter Derby

Cascade Hunter Arena

Presented by WA State Hunter Jumper Association

8:00 AM

- 1213, 1214 USHJA Outreach Hunters Crossrail
- 1310 USHJA Outreach Equitation Crossrail O/F
- 1311³ USHJA Outreach Equitation Crossrail Not to jump
- 1300³, 1301³ USHJA Outreach Walk/Trot Poles Equitation Not to jump
- 1315, 1316 USHJA Outreach Equitation 18" O/F
- 1317³ USHJA Outreach Equitation 18" Not to jump
- 1320, 1321 USHJA Outreach Equitation 2' O/F
- 1322³ USHJA Outreach Equitation 2' Not to jump
- 1325, 1326 USHJA Outreach Equitation 2'3" O/F
- 1327³ USHJA Outreach Equitation 2'3" Not to jump
- 1330, 1331 USHJA Outreach Equitation 2'6" O/F
- 1332³ USHJA Outreach Equitation 2'6" Not to jump
- 1335, 1336 USHJA Outreach Equitation 2'9" O/F
- 1337³ USHJA Outreach Equitation 2'9" Not to jump

Grand Jumper Arena

Presented by Farpoint Farm

8:00 AM

- 814 USHJA Jumping Seat Medal 3'3"
- 1434 USHJA Outreach Jumper .90m II.2b
- 1435 USHJA Outreach Jumper .90m II.1
- 252 Amateur Jumper .90m II.1
- 257 Junior Jumper .90m II.1
- 162 Jumper 1.00m II.2b
- 232 Thoroughbred Jumper 1.00m
- 262 Amateur Jumper 1.00m II.1
- 267 Junior Jumper 1.00m II.1
- 172 Jumper 1.10m II.2b
- 272 Amateur Jumper 1.10m II.2b
- 277 Junior Jumper 1.10m II.2b
- 177 Jumper 1.15m II.2b
- 182 Jumper 1.20m II.2b
- 247 Junior/Amateur Jumper 1.20m II.1
- 187 Jumper 1.30m
- 192 Jumper 1.40m
- 281 Pony Jumper .60m, .70m, .80m
- 1404 USHJA Outreach Jumper .60m II.2b
- 1405 USHJA Outreach Jumper .60m II.1
- 1414 USHJA Outreach Jumper .70m II.2b
- 1415 USHJA Outreach Jumper .70m II.1
- 1424 USHJA Outreach Jumper .80m II.2b
- 1425 USHJA Outreach Jumper .80m II.1

Class # footnotes: 1 = Handy; 2 = Stake; 3 = Under Saddle; *italics* = Conformation

2026 Cascade Open

Saturday, June 27, 2026

Grand Hunter Arena

Presented by Friends of Cascade

8:00 AM

- 805 Hamel Foundation NHS Medal 3'3"
- 803 ASPCA Maclay Horsemanship Medal 3'6"
- 804 Dover Saddlery/USEF Hunter Seat Medal 3'6"
- 425, 426 Adult Amateur Hunter 18-39 3'
- 427³ Adult Amateur Hunter 18-39 3' U/S
- 430, 431 Adult Amateur Hunter 40 & Over 3'
- 432³ Adult Amateur Hunter 40 & Over 3' U/S
- 809 Ariat National Adult Medal 3'
- 435, 436 Children's Hunter 13 & Under 3'
- 440, 441 Children's Hunter 14-17 3'
- 437³ Children's Hunter 13 & Under 3' U/S
- 442³ Children's Hunter 14-17 3' U/S
- 808 Taylor Harris Ins. National Children's Medal 3'
- 545, 546 Pre-Adult Hunter 2'9"
- 547³ Pre-Adult Hunter 2'9" U/S
- 520, 521 Pre-Children's Hunter 2'9"
- 522³ Pre-Children's Hunter 2'9" U/S
- 525 Low Children's Hunter 2'6"
- 530, 531 Low Adult Hunter 2'6"
- 811 OHJA Mini Medal 2'6"
- 526³ Low Children's Hunter 2'6" U/S
- 532³ Low Adult Hunter 2'6" U/S
- 448 Children's Hunter Pony 2', 2'6" (respective heights)
- 44 Children's Hunter Pony Classic 2', 2'6" (respective heights)
- 500, 501 Short Stirrup Hunter Horse 17 & Under 2'3"
- 510, 511 Long Stirrup Hunter 18 & Over 2'3"
- 502³ Short Stirrup Hunter Horse 17 & Under 2'3" U/S
- 512³ Long Stirrup Hunter 18 & Over 2'3" U/S
- 505, 506 Short Stirrup Hunter Pony 17 & Under 18"
- 507³ Short Stirrup Hunter Pony 17 & Under 18" U/S

Cascade Hunter Arena

Presented by WA State Hunter Jumper Association

8:00 AM

- 1312, 1313 USHJA Outreach Equitation Crossrail O/F
- 1318, 1319 USHJA Outreach Equitation 18" O/F
- 1323, 1324 USHJA Outreach Equitation 2' O/F
- 1328, 1329 USHJA Outreach Equitation 2'3" O/F
- 1333, 1334 USHJA Outreach Equitation 2'6" O/F
- 1338, 1339 USHJA Outreach Equitation 2'9" O/F

17 Cascade Canine Derby

Presented by Cascade Partners

Grand Jumper Arena

Presented by Farpoint Farm

8:00 AM

- 282 Pony Jumper .60m, .70m, .80m
- 1406 USHJA Outreach Jumper .60m II.2b
- 1416 USHJA Outreach Jumper .70m II.2b
- 1426 USHJA Outreach Jumper .80m II.2b
- 1436 USHJA Outreach Jumper .90m II.2b
- 253 Amateur Jumper .90m II.2b
- 258 Junior Jumper .90m II.2b
- 202 Young Jumper .90m
- 263 Amateur Jumper 1.00m II.2b
- 268 Junior Jumper 1.00m II.2b
- 207 Young Jumper 1.00m
- 273 Amateur Jumper 1.10m II.2b
- 278 Junior Jumper 1.10m II.2b
- 178 Jumper 1.15m
- 183 Jumper 1.20m
- 212 Young Jumper 1.10m
- 16 **Rising Stars™ Leadline**
- 9 **Jumpernite Rider Relay 1.00m**
Presented by Jumpernite
- 4 **Horseware Grand Prix II.2a**
Presented by The Absolute Horse

Class # footnotes: 1 = Handy; 2 = Stake; 3 = Under Saddle; *italics* = Conformation

2026 Cascade Open

Sunday, June 28, 2026

Grand Hunter Arena

Presented by Friends of Cascade

8:00 AM

- 25 **Luxury DerbyCross™ 3'**
- 670 Warm-Up Hunter 3'6"
- 802 WSHJA Good Hands & Seat 3'6"
- 428 Adult Amateur Hunter 18-39 3'
- 433 Adult Amateur Hunter 40 & Over 3'
- 438 Children's Hunter 13 & Under 3'
- 443 Children's Hunter 14-17 3'
- 52 Children's/Adult Hunter Classic 3'**
- 548 Pre-Adult Hunter 2'9"
- 523 Pre-Children's Hunter 2'9"
- 41 Pre-Children's/Adult Hunter Classic 2'9"**
- 527 Low Children's Hunter 2'6"
- 533 Low Adult Hunter 2'6"
- 42 Low Children's/Adult Hunter Classic 2'6"**
- 503 Short Stirrup Hunter Horse 17 & Under 2'3"
- 513 Long Stirrup Hunter 18 & Over 2'3"
- 45 Short/Long Stirrup Hunter Classic 2'3"**
- 508 Short Stirrup Hunter Pony 17 & Under 18"
- 46 Short Stirrup Hunter Pony Classic 18"**

Cascade Hunter Arena

Presented by WA State Hunter Jumper Association

8:00 AM

- 1201 USHJA Outreach Hunter Derby 2'-2'3"
- 1200 USHJA Outreach Hunter Derby 2'6"-2'9"
- 1203 USHJA Outreach Hunt & Go 2'-2'3"

Grand Jumper Arena

Presented by Farpoint Farm

8:00 AM

- 25 **Luxury DerbyCross™ .90m**
- 78 Junior/Amateur Jumper Classic 1.10m II.2b**
- 20 Need for Speed™ Open Jumper 1.00m III**
- 20 Need for Speed™ Open Jumper 1.10m III**
- 75 Pony Jumper Classic .60m, .70m, .80m II.2b**
- 1456 USHJA Outreach Jumper Classic .60m II.2b
- 1457 USHJA Outreach Jumper Classic .70m II.2b
- 1458 USHJA Outreach Jumper Classic .80m II.2b
- 1459 USHJA Outreach Jumper Classic .90m

Class # footnotes: 1 = Handy; 2 = Stake; 3 = Under Saddle; *italics* = Conformation

Entry Agreement for the 2026 Cascade Classic June 17-21

Closing Date of Entries: May 18, 2026

Owner		Rider One		Trainer	
Horse Owner Name	Rider Name	Trainer Name			
Address	Address	Farm/Business Name			
City	City	Address			
State/Province	State/Province	City	State/Province	Zip/PC	
Zip/PC	Zip/PC	State/Province	Zip/PC		
Date of Birth	USEF Age	ASPCA #			
Phone	USEF #	USHA #	Phone	USEF #	USHA #
Email	Email		Email		
Recipient of Prize Money Awards		Rider Two		Stabling, Fees and Payment Information	
Individual or Corporation Name	Rider Name				
Social Security # or Federal Tax ID #	Address				
Address	City	State/Province	Zip/PC		
City	State/Province	USEF Age	ASPCA #		
State/Province	Zip/PC	USEF #	USHA #		
Phone	Phone	USEF #	USHA #		
Email	Email				
EVERYONE MUST SIGN: Mandatory Liability Releases					
Horse / Tack Stall \$360		QTY:			
Stabling: Mon 10 am - Sun 7 pm Included					
Sun night: \$50 additional					
Horse					
Horse Name	USEF #	Breed	Age	Color	Sex
	USHA #				
Horse Arrival Date	Non-Showing?	Size	S	M	L
I Prefer to be Stabled With (if other than Trainer)		Horse to Primarily Compete in (check all that apply): <input type="checkbox"/> Hunter competition <input type="checkbox"/> Jumper competition			
US Equestrian Federation Entry Agreement					
<p>By entering a Federation-licensed Competition and signing this entry blank as the Owner, Lessee, Trainer, Manager, Agent, Coach, Driver, Rider, Handler, Vaultler or Longeur and on behalf of myself and my principals, representatives, employees and agents, I agree that I am subject to the Bylaws and Rules of the United States Equestrian Federation, Inc. (the "Federation") and the local rules of Cascade Horse Shows (Competition). I agree to be bound by the Bylaws and Rules of the Federation and of the competition. I will accept as final the decision of the Hearing Committee on any question arising under the Rules, and agree to release and hold harmless the competition, the Federation, their officials, directors and employees for any action taken under the Rules. I represent that I am eligible to enter and/or participate under the Rules, and every horse I am entering is eligible as entered. I also agree that as a condition of and in consideration of acceptance of entry, the Federation and/or the competition may use or assign photographs, videos, audios, cable casts, broadcast, internet, film, new media or other likenesses of me and my horse taken during the course of the promotion, coverage or benefit of the competition, sport, or the Federation. Those likenesses shall not be used to advertise a product and they may not be used in such a way as to jeopardize amateur status. I hereby expressly and irrevocably waive and release any rights in connection with such use, including any claim to compensation, invasion of privacy, right of publicity, or to misappropriation. The construction and application of Federation rules are governed by the laws of the State of New York, and any action instituted against the Federation must be filed in New York State. See 6R807.4.</p> <p>If not currently a USEF Active Competing member or Subscriber and competing only in classes that are exempt from membership requirements, I acknowledge and agree that I will be enrolled at no cost as a benefits of a USEF Fan and my USEF Fan Account will continue to annually automatically renew unless and until USEF determines in its sole discretion to terminate my Fan account. Additionally, I acknowledge that the benefits of a USEF Fan are subject to change without notice. I acknowledge that I may opt out at any time by going to My USEF Dashboard or calling (859) 810-8733.</p> <p>BY SIGNING BELOW, I AGREE that I have read, understand, and agree to be bound by all applicable Federation Bylaws, rules, and policies including the USEF Safe Sport Policy and Minor Athlete Abuse Prevention Policies (MAAAP) as published at www.usef.org, as amended from time to time, as well as all terms and provisions of this Prize List. If I am signing and submitting this Agreement electronically, I acknowledge that my electronic signature shall have the same validity, force and effect as if I affixed my signature by my own hand.</p>					
<p>US Equestrian Federation Entry Agreement</p> <p>USHA fee \$10 USHA Show Pass Fee: \$30</p> <p>Credit Card # - 3.5% convenience fee per transaction will be added for CC use.</p> <p>CC Exp Date</p> <p>CCV #</p> <p>Zip/PC</p> <p>Name on Card (please print)</p> <p>Billing Address</p> <p>Signature Authorizing Payment</p> <p>\$410 Competition Deposit Required per Show</p> <p>NON REFUNDABLE after close of entries</p>					
Owner/Agent		Rider		Trainer	
Signature (Parent/Guardian required if minor)	Rider One Signature (Parent/Guardian required if minor)	US Citizen?	Signature		
Print Name	Rider Two Signature (Parent/Guardian required if minor)	US Citizen?	Emergency Contact Phone #		
<p>Checks payable to: Cascade Horse Shows</p> <p>Cascade Horse Shows, 1612 207th Ave NE, Sammamish, WA 98074 www.cascadehorsheshows.com</p> <p>Pre-order on website: Shawnings/Hay/Feed_request@RVSite.Golf.Car</p> <p>Show Secretary: Lauren Wasserman 360.573.4360 office@cascadehorsheshows.com</p>					

Entry Agreement (Rated) for the 2026 Cascade Open June 24 – June 28

Closing Date of Entries: May 18, 2026

Owner				Rider One				Trainer					
Horse Owner Name				Rider Name				Trainer Name					
Address				Address				Farm/Business Name					
City		State/Province		Zip/PC		State/Province		Zip/PC		State/Province		Zip/PC	
Date of Birth		USEF Age		ASPCA #		City		USEF #		Phone		USEF #	
Phone		USEF #		USHJA #		Phone		USEF #		USHJA #		USHJA #	
Email		Email		Email		Email		Email		Email		Email	
Recipient of Prize Money Awards				Rider Two				Stabling, Fees and Payment Information					
Individual or Corporation Name				Rider Name				EVERYONE MUST SIGN: Mandatory Liability Releases					
Social Security # or Federal Tax ID #				Address				Horse / Tack Stall \$360					
City		State/Province		Zip/PC		State/Province		Zip/PC		QTY:			
Date of Birth		USEF Age		ASPCA #		Date of Birth		USEF Age		Stabling: Tues 10 am - Sun 7 pm included		Sun night: \$50 additional	
Phone		USEF #		USHJA #		Phone		USEF #		Non-Showing Horse: Stall fees + \$175 per show		Haul-in Fee: \$50/horse/day \$150 horse/show	
Email		Email		Email		Email		Email		Warm-up / Schooling Fee: \$40		Per-stall Manure Disposal / Garbage Fee: \$60	
Horse Name		USEF #		USHJA #		Breed		Is Pony?		Office Fee: \$60		Hunter / Jumper Nominating Fee: \$75	
Age		USHJA #		Age		Age		Height		US Equestrian fee \$25 (drugs/meds \$15, USEF \$10)		USHJA fee \$10 USHJA Show Pass Fee: \$30	
Size		S		M		L		Green Status		Credit Card # - 3.3% convenience fee per transaction will be added for CC use.			
Jockey Club Registry #		Measurement Card #		Measurement Card #		Measurement Card #		CCV #		CCV #		Zip/PC	
Horse to be Stabled With (If other than Trainer)		Horse to be Stabled With (If other than Trainer)		Horse to be Stabled With (If other than Trainer)		Horse to be Stabled With (If other than Trainer)		Name on Card (please print)		Billing Address		Signature Authorizing Payment	
I Prefer to be Stabled With (If other than Trainer)		I Prefer to be Stabled With (If other than Trainer)		I Prefer to be Stabled With (If other than Trainer)		I Prefer to be Stabled With (If other than Trainer)		Signature Authorizing Payment		Signature Authorizing Payment			
Horse to Primarily Compete in (check all that apply):		Horse to Primarily Compete in (check all that apply):		Horse to Primarily Compete in (check all that apply):		Horse to Primarily Compete in (check all that apply):		Billing Address		Signature Authorizing Payment			
<input type="checkbox"/> Hunter competition		<input type="checkbox"/> Hunter competition		<input type="checkbox"/> Hunter competition		<input type="checkbox"/> Hunter competition		Name on Card (please print)		Signature Authorizing Payment			
<input type="checkbox"/> Jumper competition		<input type="checkbox"/> Jumper competition		<input type="checkbox"/> Jumper competition		<input type="checkbox"/> Jumper competition		Billing Address		Signature Authorizing Payment			
<input type="checkbox"/> Jumper competition		<input type="checkbox"/> Jumper competition		<input type="checkbox"/> Jumper competition		<input type="checkbox"/> Jumper competition		Billing Address		Signature Authorizing Payment			
Entry Agreement (sign all other releases at CascadeHorseShows.com)												\$410 Competition Deposit Required per Show NON REFUNDABLE after close date	
US Equestrian Federation Entry Agreement													
By entering a Federation-licensed Competition and signing this entry blank as the Owner, Lessee, Trainer, Manager, Agent, Coach, Driver, Rider, Handler, Vaulter or Longeur and on behalf of myself and my principals, representatives, employees and agents, I agree that I am subject to the Bylaws and Rules of the United States Equestrian Federation, Inc. (the "Federation") and the local rules of Cascade Horse Shows (Competition). I agree to be bound by the Bylaws and Rules of the Federation and of the competition. I will accept as final the decision of the Hearing Committee on any question arising under the Rules, and agree to release and hold harmless the competition, the Federation, their officials, directors and employees for any action taken under the Rules. I represent that I am eligible to enter and/or participate under the Rules, and every horse I am entering is eligible as entered. I also agree that as a condition of and in consideration of acceptance of entry, the Federation and/or the Competition may use or assign photographs, videos, audios, cable casts, broadcasts, internet, film, new media or other likenesses of me and my horse taken during the course of the competition, coverage or benefit of the competition, sport, or the Federation. Those likenesses shall not be used to advertise a product and they may not be used in such a way as to jeopardize amateur status. I hereby expressly and irrevocably waive and release any rights in connection with such use, including any claim to compensation, invasion of privacy, right of publicity, or to misappropriation. The construction and application of Federation rules are governed by the laws of the State of New York, and any action instituted against the Federation must be filed in New York State. See GR907.4.													
If not currently a USEF Active Competing member or Subscriber and competing only in classes that are exempt from membership requirements, I acknowledge and agree that I will be enrolled at no cost as a USEF Fan and my USEF Fan Account will continue to annually automatically renew unless and until USEF determines in its sole discretion to terminate my Fan account. Additionally, I acknowledge that the benefits of a USEF Fan are subject to change without notice. I acknowledge that I may opt out at any time by going to My USEF Dashboard or calling (859) 810-8733.													
BY SIGNING BELOW, I AGREE that I have read, understand, and agree to be bound by all applicable Federation Bylaws, rules, and policies including the USEF Safe Sport Policy and Minor Athlete Abuse Prevention Policies (MAAPP) as published at www.usef.org, as amended from time to time, as well as all terms and provisions of this Prize List. If I am signing and submitting this Agreement electronically, I acknowledge that my electronic signature shall have the same validity, force and effect as if I affixed my signature by my own hand.													
Owner/Agent				Rider				Trainer				Coach	
Signature (Parent/Guardian required if minor)				Signature (Parent/Guardian required if minor)				Signature				Signature	
Print Name				Print Name				Print Name				Print Name	
Emergency Contact Phone #				Emergency Contact Phone #				Emergency Contact Phone #				Emergency Contact Phone #	
Checks payable to: Cascade Horse Shows Cascade Horse Shows, 1612 207th Ave NE, Sammamish, WA 98074 www.cascadehorseshow.com													
Pre-order on website: Shavings/Hay/Feed/ , request RV Site, Golf Car Show Secretary: Lauren Wasserman 360.573.4360 office@cascadehorseshow.com													

Entry Agreement (Outreach) for the 2026 Cascade Open June 24 – June 28

Closing Date of Entries: May 18, 2026

Owner		Rider One		Trainer	
Horse Owner Name		Rider Name		Trainer Name	
Address		Address		Farm/Business Name	
City	State/Province	Zip/PC	City	State/Province	Zip/PC
Phone	USEF #	USHA #	Date of Birth	USEF Age	ASPCA #
Email			Phone	USEF #	USHA #
			Email		Email
Recipient of Prize Money Awards			Rider Two		
Individual or Corporation Name			Rider Name		
Social Security # or Federal Tax ID #			Address		
Address			City		
City			State/Province		
State/Province			Zip/PC		
Zip/PC			Date of Birth		
Phone			USEF Age		
USEF #			USEF #		
USHA #			USHA #		
Email			Email		
Stabling, Fees and Payment Information					
EVERYONE MUST SIGN: Mandatory Liability Releases					
Horse / Tack Stall \$360					
Stabling: Tues 10 am - Sun 7 pm included					
Sun night: \$50 additional					
Non-Showing Horse: Stall fees + \$175 per show					
Haul-in Fee: \$50/horse/day \$150 horse/show					
Warm-up / Schooling Fee: \$40					
Per-stall Manure Disposal / Garbage Fee: \$60					
Office Fee: \$60					
Hunter / Jumper Nominating Fee: \$75					
USHA fee \$5					
Credit Card #: 3.5% convenience fee per transaction will be added for CC use.					
CC Exp Date		CCV #		Zip/PC	
Name on Card (please print)					
Billing Address					
Signature Authorizing Payment					
\$420 Competition Deposit Required per Show					
NON REFUNDABLE After Close Date					
Owner/Agent		Rider		Trainer	
Signature (Parent/Guardian required if minor)		Rider One Signature (Parent/Guardian required if minor)		Signature	
Print Name		Rider Two Signature (Parent/Guardian required if minor)		Emergency/Contact Phone #	
US Citizen?		US Citizen?		Print Name	

Checks payable to: Cascade Horse Shows
Cascade Horse Shows, 1612 207th Ave NE, Sammamish, WA 98074 | www.cascadehorsheshows.com

Pre-order on website: Shawings/Haw/Feed/, request RV Site, Golf Car
Show Secretary: Lauren Wasserman | 360.573.4360 | office@cascadehorsheshows.com



RELEASE OF LIABILITY FOR PROPERTY DAMAGE, PERSONAL INJURY OR DEATH

I choose to participate voluntarily in Equine Activities, as that term is defined in the [Revised Code of Washington \(RCW\) 4.24.530\(2\)](#), at the **Washington State Horse Park** (“WSHP”). The WSHP is an equine activity sponsor, as that term is defined in [RCW 4.24.530\(3\)](#). I am fully aware of and acknowledge that Equine Activities involve inherent dangerous risks of accident, loss, and serious bodily injury including broken bones, head injuries, trauma, pain, suffering or death (“Harm”).

I agree to release WSHP Authority and the individual WSHP Board members and the WSHP Foundation and the individual WSHP Foundation Board Members, their agents, assigns, employees and contractors and members, the City of Cle Elum and Sun Communities (hereinafter collectively referred to as the “Released Parties”) from all claims for money damages or loss for any Harm to me, my injury or death, the injury or death of my child(ren) named below (“Child”) or my horse or for any Harm caused by me or my horse to others, even if the Harm, directly or indirectly, resulted from the negligence of the Released Parties.

I agree to expressly assume all risks of Harm to me or my child or my horse.

I agree to indemnify the Released Parties and to hold them harmless from all claims, causes of action and money damages resulting from Harm to me, my Child, or my horse while I am participating in Equine Activities at the WSHP facility.

Under Washington State law, except as provided in RCW 4.24.540(2), an equine activity sponsor or an equine professional shall not be liable for an injury or the death of a participant engaged in an equine activity, and, except as provided in subsection(s) of this section, no participant nor participant’s representative may maintain an action against or recover from an equine activity sponsor or an equine professional for an injury to or the death of a participant engaged in an equine activity.

I have read and understand the Rules and Regulations of WSHP that are posted on the WSHP property. I understand these rules and regulations of WSHP will be changed from time to time and I agree to abide by the changed rules. I represent that I and/or my child have the requisite training, coaching and ability to participate safely in the activities we chose to pursue at WSHP.

RELEASE OF PHOTOGRAPHIC AND VIDEO IMAGES

I hereby give permission to WSHP and those acting with its authority the unrestricted right and permission to use, publish and republish any photographic or video images of me and/or my horse for promotional and marketing purposes of the Horse Park. I also permit the use of any printed material in connection therewith and relinquish any right to review or restrict its use or publication.

I read and understand these Releases, and my handwritten or digital signature below signifies my acceptance of their terms and conditions. I agree these Releases shall remain in full force and effect until they are specifically revoked by me in writing or superseded by new releases issued by the Horse Park and signed by me. Electronic delivery of this document shall be legally binding, the same as delivery of an original.

Name of Event: _____ Event Date(s): _____

Participant’s Name: _____ DOB if under 18: _____

Participant’s Signature: _____ Date: _____

If Event Participant is under 18 years of age, his/her parent must sign on his/her behalf below:

Parent’s Name: _____

Parent’s Signature: _____ Date: _____

Signer’s Home Address: _____

City: _____ State: _____ Zip Code: _____



**WAIVER AND RELEASE OF LIABILITY,
ASSUMPTION OF RISK AND INDEMNITY AGREEMENT**

For and in consideration of United States Equestrian Federation, Inc. dba US Equestrian (“USEF”) allowing me, the undersigned, to participate in any capacity (including as a rider, driver, handler, vaulter, longeur, lessee, owner, agent, coach, official, trainer or volunteer) in a USEF sanctioned, licensed or approved event or activity, including but not limited to equestrian clinics, practices, shows, competitions and related or incidental activities and _____ (“USEF Event” or “USEF Events”); I, for myself, and on behalf of my spouse, children, heirs and next of kin, and any legal and personal representatives, executors, administrators, successors, and assigns, hereby agree to and make the following contractual representations pursuant to this Agreement (the “Agreement”):

A. RULES AND REGULATIONS: I hereby agree that I have read, understand, and agree to be bound by all applicable Federation Bylaws, rules, and policies including the USEF Safe Sport Policy and Minor Athlete Abuse Prevention Policies (MAAPP) as published at www.usef.org, as amended from time to time.

B. ACKNOWLEDGMENT OF INHERENT RISKS: I knowingly, willingly, and voluntarily acknowledge the inherent risks associated with equine activities, including but not limited to horseback riding and equestrian sport, are inherently dangerous, and that participation in any USEF Event involves risks and dangers including, without limitation, the potential for serious bodily injury (including broken bones, head or neck injuries), sickness and disease (including communicable diseases), trauma, pain & suffering, permanent disability, paralysis and death; loss of or damage to personal property (including my mount & equipment) arising out of the unpredictable behavior of horses; exposure to extreme conditions and circumstances; accidents involving other participants, event staff, volunteers or spectators; contact or collision with other participants and horses, natural or manmade objects; adverse weather conditions; facilities issues and premises conditions; failure of protective equipment (including helmets); inadequate safety measures; participants of varying skill levels; situations beyond the immediate control of the USEF Event organizers and competition management; and other undefined, not readily foreseeable and presently unknown risks and dangers (“Risks”).

EQUINE ACTIVITY LIABILITY ACT WARNING:

CAUTION: HORSEBACK RIDING AND EQUINE ACTIVITIES CAN BE DANGEROUS. RIDE AT YOUR OWN RISK.

Under Washington law, an equine activity sponsor or equine professional is not liable for any injury to, or the death of, a participant in equine activities resulting from the inherent risks of equine activities. RCW 4.24.540

C. ASSUMPTION OF RISK: I understand that the aforementioned Risks may be caused in whole or in part or result directly or indirectly from the negligence of my own actions or inactions, the actions or inactions of others participating in the USEF Events, or the negligent acts or omissions of the Released Parties defined below, and I hereby voluntarily and knowingly assume all such Risks and responsibility for any damages, liabilities, losses, or expenses that I incur as a result of my participation in any USEF Events. I also agree to be responsible for any injury or damage caused by me, my horse, my employees or contractors under my direction and control at any USEF Event.

D. WAIVER AND RELEASE OF LIABILITY, HOLD HARMLESS AND INDEMNITY: In conjunction with my participation in any USEF Event, I hereby release, waive and covenant not to sue, and further agree to indemnify, defend and hold harmless the following parties: USEF, USEF Recognized Affiliate Associations, the United States Olympic & Paralympic Committee (USOPC), USEF clubs, members, Event participants (including athletes/riders, coaches, trainers, judges/officials, and other personnel), the Event owner, licensee, and competition managers; the promoters, sponsors, or advertisers of any USEF Event; any charity or other beneficiary which may benefit from the USEF Event; the owners, managers, or lessors of any facilities or premises where a USEF Event may be held; and all directors, officers, employees, agents, contractors, and volunteers of any of the aforementioned parties (**Individually and Collectively, the “Released Parties” or “Event Organizers”**), with respect to any liability, claim(s), demand(s), cause(s) of action, damage(s), loss, or expense (including court costs and reasonable attorney fees) of any kind or nature (“Liability”) which may arise out of, result from, or relate in any way to my participation in the USEF Events, including claims for Liability caused in whole or in part by the negligent acts or omissions of the Released Parties.

E. COMPLETE AGREEMENT AND SEVERABILITY CLAUSE: This Agreement represents the complete understanding between the parties regarding these issues and no oral representations, statements or inducements have been made apart from this Agreement. If any provision of this Agreement is held to be unlawful, void, or for any reason unenforceable, then that provision shall be deemed severable from this Agreement and shall not affect the validity and enforceability of any remaining provisions.

I HAVE CAREFULLY READ THIS DOCUMENT IN ITS ENTIRETY, UNDERSTAND ALL OF ITS TERMS AND CONDITIONS, AND KNOW IT CONTAINS AN ASSUMPTION OF RISK, RELEASE AND WAIVER FROM LIABILITY, AS WELL AS A HOLD HARMLESS AND INDEMNIFICATION OBLIGATIONS.

By signing below, I agree that I have read, understand, and agree to be bound by all applicable Federation Bylaws, rules, and policies including the USEF Safe Sport Policy and Minor Athlete Abuse Prevention Policies (MAAPP) as published at www.usef.org, as amended from time to time. Further, by signing below, I (as the participant or as the Parent/Legal Guardian of the minor identified below) hereby accept and agree to the terms and conditions of this Agreement in connection with my (or the minor’s) participation in USEF Events. If, despite this Agreement, I, or anyone on my behalf or the minor’s behalf, makes a claim for Liability against any of the Released Parties, I will indemnify, defend and hold harmless each of the Released Parties from any such Liabilities as the result of such claim.

The parties agree that this agreement may be electronically signed. The parties agree that the electronic signatures appearing on this agreement are the same as handwritten signatures for the purposes of validity, enforceability, and admissibility.

RIDER/DRIVER/HANDLER/VAULTER/LONGEUR OWNER TRAINER OFFICIAL STAFF VOLUNTEER COACH (IF APPLICABLE) OTHER

Signature: _____ Date: _____ Print Name: _____

Parent/Guardian Signature: (Required if Rider/Driver/Handler/Vaulter/Longeur is a minor) _____ Date: _____

Print Parent//Guardian Name: _____ Emergency Contact Phone No. _____

02.18.26

UNITED STATES EQUESTRIAN FEDERATION : 4001 WING COMMANDER WAY : LEXINGTON, KY 40511 : 859.810.8733 : FAX 859.721.1151 : USEF.ORG

© United States Equestrian Federation® All rights reserved. Reproduction without permission is strictly prohibited.



Credit Card Authorization Form for 2026 Shows

Please complete all fields. This authorization will remain in effect for the duration of the show season or until cancelled by the signer. The signer may cancel this authorization at any time by contacting: office@cascadehorsheshows.com.

Responsible Party:
(named on entry)

Name(s) of horse(s):
(to credit funds to)

Credit Card Information	
Card Type	<input type="checkbox"/> MasterCard <input type="checkbox"/> VISA <input type="checkbox"/> Discover <input type="checkbox"/> AMEX
Cardholder Name (as shown on card)	
Card Number	
Expiration Date (MM/YY)	CVV Code
Cardholder Billing ZIP Code	

I, _____, authorize Cascade Horse Shows LLC to charge my credit card above for agreed upon charges. I understand that I will be charged a 4% credit card service charge and that my information will be saved on file for future transactions on my Cascade Horse Shows LLC account.

Customer Signature

Date

SPECIFICATIONS

Cascade Grands Prix, #1, #4

The Grand Prix held at each Cascade show will be run as a Table II, Sec 2(a) — Time first with a jump off; ties to jump off for first place. Order of go will be drawn by Show Management and posted by 2pm on the day of the class. Prize money will be distributed as 1st 30%, 2nd 20%, 3rd 14%, 4th 10%, 5th 8%, 6th 7%, 7th 6%, 8th 5% unless otherwise stated. Horses and riders must have competed in at least one other class in the competition. Formal attire required; salute to sponsors requested. June shows qualify for the Washington State Elite Jumper Year End Award sponsored by WSHJA.

USHJA National Hunter Derby, #3

The USHJA National Hunter Derby features a two-round format with a minimum of two judges utilizing a numerical system to score competitors in the Classic Hunter Round (first round) on performance, hunter pace, jumping style, quality and substance, and movement. A second round will feature a Handy Hunter course designed to reflect brilliance of pace and handiness. In each round, following the judges' base score, one point will be added for each high-option fence jumped; up to a maximum of four high options may be included. Fences are set at 3' with four high-option fences set at 3'5" (June) or 3'3" (July/September). Prize money will be distributed as: 1st 30%, 2nd 22%, 3rd 13%, 4th 8%, 5th 6%, 6th 5%, 7th 4%, 8th-9th 3%, 10th-12th 2% unless otherwise stated. The top 3 Amateurs/Juniors will also be recognized. Formal attire required; salute to sponsor requested. Full specs can be found in this document and with the United States Hunter Jumper Association.

USHJA National Hunt & Go, #31

To be run in accordance with [USHJA National Hunter Derby specifications](#) in the Hunt & Go format (III.F). The USHJA National Hunt & Go will consist of two (2) phases: one (1) Classic Hunter, and one (1) Handy Hunter. The phases will be jumped consecutively. All participants will complete both the Classic and the Handy portions even if penalties (rails, refusals, etc.) are incurred. Major penalties (falls, 3 refusals, off course, etc.) will be combined from the Classic and Handy rounds and will result in elimination (i.e. a horse who has two refusals in the Classic Round will be eliminated after one refusal in the proceeding Handy Round). Prize money will be distributed as: 1st 30%, 2nd 22%, 3rd 13%, 4th 8%, 5th 6%, 6th 5%, 7th 4%, 8th-9th 3%, 10th-12th 2% unless otherwise stated. Special recognition for the top 3 placing Amateurs/Juniors.

Cascade Welcome, #38

The Cascade Welcome will run as a Table II.2a class at a height of 1.25m. Order of go will be drawn by Show Management and posted by 2pm the day of the class. Prize money will be distributed: 1st 30%, 2nd 23%, 3rd 20%, 4th 15%, 5th 10%, 6th 10% unless otherwise stated.

Luxury DerbyCross™, #7, #25

The DerbyCross™ is a unique combined discipline class that challenges the skills of the rider and horse to perform both the Handy Hunter and Jumper Speed styles in a two-phase round. Fences 1-7 will be the Handy Hunter round, may include some natural fences and a trot fence, and will be judged on performance, hunter pace, style, quality, and handiness. Fences 8-13 will be scored as a Table II.1 jumper round and will include one combination.

Two judges will officiate, judge #1 will award a numeric Handy Hunter score for jumps 1-7, judge #2 will score and time each rider's speed phase. Speed phase points will be awarded 1st 30pts, 2nd 25pts, 3rd 20pts, 4th 18pts, 5th 15pts, 6th 14pts, 7th 13pts, 8th 12pts. The Speed phase points will be added to each competitor's Handy Hunter score and the total will determine the final class placings.

Prize money will be distributed as 1st 30%, 2nd 23%, 3rd 20%, 4th 15%, 5th 10%, 6th 10% unless otherwise stated.

Formal hunter attire and tack required, braiding is optional.

This class may be offered at 3'3" - 1.m or 3' - .90. Please check the schedule for each show for the height offering. This class maybe run in one ring or two, depending on time allowance. The number of obstacles may vary slightly depending on the number of rings used.

If the class is run in two rings, the competitors are not allowed to talk to ANYONE as they walk between rings. And they must cross the start line within 40 seconds of entering the second arena.

Jumpernite Rider Relay, #9

Rotating Pair Relay is a Table III speed round for teams of two. A horse may only compete once in this class, but a rider may compete on more than one horse. The entire course must be jumped twice in the correct order rotating between competitors. The competitor who crossed the start line must jump the first obstacle and the competitor who jumped the last obstacle must cross the finish line. One change mandatory. Competitors change over as often as they wish. A change is obligatory whenever a fault is incurred. Prize money will be distributed as: 1st 30%, 2nd 25%, 3rd 20%, 4th 15%, 5th 10% unless otherwise stated. See USEF rule JP150 #5 for complete rules.

Rosé All Day Amateur Classic, #11

Run in the spirit of a traditional Hunter Hack for all 21 & older amateur riders. A Hunter Hack is a type of English pleasure class where exhibitors in Hunt seat tack and attire perform on the flat at a walk, trot, canter, and hand gallop, and then jump two low fences. For this unique variation, riders may be asked to walk, trot, canter, change direction, sit the trot, halt & back up, and jump a cavalletti line, all while holding a glass of “rosé” wine! Class will be pinned on Judges Score adjusted for the “rosé” left in your glass. Prize money will be distributed as: 1st 50%, 2nd 30%, 3rd 20%. The winner also takes home a case of (real) rosé wine with bottles of rosé to 8th place. Traditional attire encouraged; salute to sponsor requested.

Need For Speed™ Open Jumper, #20

The Need for Speed Open Jumper will be run as a Table III speed round, with faults converted into seconds. A time limit of 120 seconds will apply, and faults incurred will be penalized by adding four seconds for each occurrence. This class is offered at 1.10m and 1.20m. Entrants must designate which height they intend to compete in at the time they enter. At the 1.10m height a 2 second handicap will be added to each competitor's time. Prize money will be distributed as: 1st 30%, 2nd 20%, 3rd 14%, 4th 10%, 5th 8%, 6th 7%, 7th 6%, 8th 5% unless otherwise stated. Formal attire required; salute to sponsor requested.

Cascade Equitation Challenge, #22

The top four placing riders from each equitation section at the Cascade Classic and the top four riders from the Pro Equitation on the Flat, #740 (held at the Classic only) are eligible to compete in the Cascade Equitation Challenge. This is a flat equitation class judged in elimination style. Riders will be tested at the judge's discretion. Tests may include riding without stirrups, counter canter, shoulder in, halt, rein back, turn on the forehand, turn on the haunches. The champion will be the final rider on the rail. Formal attire and salute to sponsor appreciated.

USHJA 2'6" Junior/Amateur Hunter Derby, #28

This class will run as a Hunt & Go format with the first half of the course being ridden as a Classic Round and the second half being ridden as a Handy Round. Both phases will be jumped consecutively with no break in pace. Riders may complete both phases even if minor penalties are incurred in the first phase. Major penalties (falls, 2 refusals etc.) will result in elimination. 2'6" section will have 2'9" high options, and 2'9" section will have 3'0" high options. Courses will not have a combination. Scores plus bonus points will be given for each phase and added together to determine total scores. Open to Junior and Amateur riders who will not compete over 2'9" at this show. Riders must jump the highest height they have been competing at.

USHJA Zone 9 Handy Hunter Challenge, #29

To be held as a standalone one round Handy Hunter class. A minimum of ten (10) fences shall be set at 3' in height with spreads not to exceed the fence height. A minimum of 6 entries is required for the class to run and of those, a minimum of 3 rounds must be scored for double points towards USHJA Zone Horse of the Year standings. Open to junior and amateur riders (certification required) whose home Zone of record is Zone 9, and who are Active members of USEF and USHJA before the start of the Handy Hunter Challenge. Horses must be registered with USHJA to participate. Riders may compete more than one horse per Handy Hunter Challenge as long as more than one (1) rider is entered in the Challenge class. Professionals are not eligible to compete in the Handy Hunter Challenge. Formal attire requested but not required.

Cascade Hunter Team Trials, #30

Teams of three riders to jump 7 jumps in a single file line, maintaining equal spacing by riding at an equal pace. The eighth, final fence may be jumped three abreast. Jumps will be set at 2'6" with no combinations. To be judged on team performance, hunter pace, style, and team sportsmanship. Formal attire requested.

Cascade Hunter Classics, #40-52

All Classics are two rounds. The final round over fences of the corresponding section is to count as the first round of the respective Classic. Round 2 to be shown over a course of at least 9 obstacles. Hunter Classic horses or ponies must have competed in at least two hunter classes in the corresponding section to compete. Prize money will be distributed as: 1st 30%, 2nd 25%, 3rd 20%, 4th 15%, 5th 10% unless otherwise stated. Formal attire required; salute to sponsor requested.

Cascade Open Jumper Classics, #71-78

Jumper Classic entries must have entered at least one other class in the corresponding section to compete. Open Jumper Classics are offered at .70m, .80m, .90m and 1.00m. Ribbons to 8th, prize money to 5th: (30%, 25%, 20%, 15%, 10%).

Hobby Horse Classic, #13

Bring your own Hobby Horse or make one at the show! This class is for the under 21 set. Three age groups: 8 & under, 9 – 13, and 14 – 20. Hobby horses will be shown over a hunter style course of ground poles. Horses should have good manners, smooth style and a graceful overall appearance. A smooth canter with lead changes will earn the highest score. The top six may be called back for a Handy Hunter tie-breaker round. Bonus points for the best turned out Hobby Horses. \$10 entry fee (cash or Venmo only).

Rising Stars Leadline, #16

No Fee. Cascade Classic - Week 2 preceding the Barn Pros Grand Prix. Wow the crowd with style and smiles. Prizes to all. Helmet and boots required.

Cascade Canine Derby, #17

A fan-favorite tradition of our Cascade Open and Cascade Finals shows. Open to all dogs of all sizes and breeds. A team event challenging dogs and their humans over a course of 8 obstacles, with high options. \$10 entry fee (cash or Venmo only); sign-up in the Prize Store. Prizes to 6th, smiles for everyone!



USHJA NATIONAL HUNTER DERBY QUICK SPECS

For full specifications see: <https://ushja.org/competition/hunter/national-hunter-derby>

Membership Requirements

1. Riders, owners, and trainers must be a current Active member of USEF and USHJA to participate in this class. (see GR202).
2. Horses and ponies must be registered with USHJA to participate in this class.
3. Exception: Foreign residents and horses and ponies in good standing with their National Federation are eligible to compete in this class but will not receive points unless they follow 1 and 2.
4. USHJA National and Zone HOTY bonus points will only be awarded if the owner is a current Active member of USEF and USHJA and the horse is recorded with USEF and registered with USHJA.
5. Money won will only count for any USHJA National Hunter Derby standings or awards if the rider, owner and trainer are current Active members of USEF and USHJA, and the horse is registered with USHJA.

Course Requirements: Jumps in ALL Rounds

1. Obstacles must simulate those reminiscent of the hunt field and course must offer a variety of Classic jumps with different appearances such as: natural post and rail, stone wall, white board fence or gate, coop, aiken, hedge, oxer, brush, logs, natural foliage.
2. Natural obstacles such as banks and ditches are allowed.
3. A minimum of 2" difference is required for the back element of all oxers.
4. Ground lines are not to exceed 18" in depth from the vertical plane of the jump. For appropriate jumps, no ground line is necessary.
5. The jumpable portion of any fence must be a minimum of 8 feet on its front face
6. The top element of all jumps must be in cups except for walls with movable bricks.
7. Flat cups may only be used for log fences and in accordance with Federation rules.
8. Distances will not be adjusted for ponies.
9. Fence height 3'0"
10. There must be four (4) high option fences set at 3'5". (Hunt and Go format refer to Section III F.1.) If there is a difference in difficulty between any two tracks containing height options, the higher options should include the more inviting, less difficult track.

First Round: Classic Hunter Style Course

1. A minimum of ten obstacles must be offered in the Classic Hunter Round.
2. At least three of the following types of fences must be utilized: natural post and rail, stone wall, white board fence, riviera gate, coop, aiken, hedge, brush or logs.
3. At least one in and out
4. At least one bending line
5. At least one line with an unrelated distance
6. At least one long approach

Second Round: Handy Hunter Course

1. A minimum of eight obstacles must be offered in the Handy Hunter Round.
2. At least three of the following types of fences must be utilized: natural post and rail, stone wall, white board fence, riviera gate, coop, aiken, hedge, brush or logs.
3. The course should simulate riding over hunt country and must have a minimum of two handy options, such as: tight turns, different tracks, clever options for jump approaches, pen type obstacles, hand gallop a jump, trot a lowered obstacle not to exceed 2'6" in height, halt and/or back. Gimmicky options are not appropriate.
4. Unless the prize list states that more than twelve (12) entries are to return for the second round, then only the top twelve (12) horses from the first round, after all ties are broken, are eligible to return for the second round.

Awards and HOTY Points Specifications

1. All riders in the top twelve overall (or their designated representative if not available) must ride for ribbons to receive prize money. Although not required, a show may choose to award separate ribbons for the first round if so stated in the prize list.
2. For National Hunter Derby Zone HOTY points to be awarded, riders must complete a USHJA Exhibitor Declaration Form prior to the conclusion of the competition.
3. Points accrued by horses shown by Professionals may be awarded to the declared Green Hunter 3'0", Green Hunter 3'3", Performance Hunter 3'3", Small Hunter, Young Hunter 5 and under- 2'9", Young Hunter 6 and under- 3', or Young Hunter 7 and under- 3'3".
4. Points accrued by horses shown by Juniors or Amateurs may be awarded to the declared Green Hunter 3'0", Green Hunter 3'3" Performance Hunter 3'3", or the applicable Children's, Pony, Adult Amateur, Amateur Owner 3'3", Small Hunter or Junior Hunter 3'3, Young Hunter 5 and under- 2'9", Young Hunter 6 and under- 3', or Young Hunter 7 and under- 3'3".

Judging System

1. The first round shall be judged on performance, hunter pace, jumping style, quality and substance, and movement. After the judge(s) base score is given, one (1) point will be added for each high option fence jumped. The Option Bonus Score of one additional point must be awarded even if there is a refusal, rail down or loss of good jumping style at that higher height option fence, providing that the horse-and-rider combination does jump the higher height option fence. (Maximum of four points.)
2. The second round shall be judged on performance, hunter pace, jumping style, quality and substance, movement, handiness and brilliance of pace. Handiness is defined as ground saving movement without adversely affecting performance or style. Brilliance of pace is defined as a faster pace than ordinary, without sacrificing performance or style. Handiness is taken into account in the judges' base score. After the judge(s)' base score is given, one (1) point will be added for each high option fence jumped. The Option Bonus Score of one additional point must be awarded even if there is a refusal, rail down or loss of good jumping style at that higher height option fence, providing that the horse-and-rider combination does jump the higher height option fence. (Maximum of four points.)

For Full USHJA National Hunter Derby Specifications see: <https://ushja.org/competition/hunter/national-hunter-derby>



Doctor Kelly Farnsworth of the Washington State University College of Veterinary Medicine speaks on horse welfare and opportunities in the field during the 2025 Cascade Classic. Cascade Horse Shows is proud to offer educational sessions featuring noted experts at many of our shows.

USHJA Zone 9 Specifications

(MT, WY, ID, OR, WA)



In accordance with GR1111.4: CA, NV, UT, CO, ND, SD, NE, and Canada are contiguous states.

JUDGING FOR ALL HUNTER AND EQUITATION SECTIONS:

- To be judged on performance and soundness, suitability to count.
- Horses and Ponies are not required to jog for soundness.
- In Equitation: to be judged on performance, style, form and suitability of horse and rider to count

ELIGIBILITY FOR ADULT AMATEURS: HUNTER, JUMPER AND EQUITATION:

- To be ridden by exhibitors who have reached their 18th birthday as of December 1 of the current competition year and who hold a current USEF Amateur certification. Open to horses and ponies.

ELIGIBILITY FOR CHILDREN'S SECTIONS: HUNTER, JUMPER AND EQUITATION:

- To be ridden by exhibitors who have not reached their 18th birthday as of December 1 of the current competition year.

ADULT AMATEUR HUNTER

Sections offered and requirements: • Adult Amateurs – may be split into three (3) sections. **Cross Entry: Riders:** Amateur Owner Hunter riders may compete on a maximum of one (1) Adult Amateur Hunter horse that they own at the same competition. Riders may not show in any classes in which the fences are 3'9" and over at the same competition. **Horses:** Horses entered in Adult Amateur Hunter sections may not compete in the Amateur Owner Hunter sections at the same competition. **Horse and Rider Combination:** Horse and rider combinations may not cross enter into the Amateur Owner Hunter sections. **Fence height:** 3'0" with spreads not to exceed the fence height. Courses will not be adjusted for ponies. In and outs will be permitted. **Combining/Dividing Sections:** Refer to HU166. **Awards:** Zone Horse of the Year Awards will be presented annually to the following sections: Adult Amateur Hunter 18- 39; Adult Amateur 40- 55; Adult Amateur 56 & over.

LOW ADULT AMATEUR HUNTER

Eligibility: Open to exhibitors who have reached their 18th birthday as of December 1 of the current competition year. **Cross Entry: Riders:** Riders may not cross enter into any class or section at the same competition where fences exceed 2'9". **Fence Height:** 2'6". In and outs will not be permitted. **Combining/Dividing Sections:** The Low Adult Amateur Hunter and Low Children's Hunter sections may be combined if there are fewer than three (3) entries in either section. **Awards:** Zone Horse of the Year Awards will be presented annually to the following section: Low Adult Amateur Hunter.

AMATEUR JUMPER

Sections offered and requirements: 1.00/1.05m Amateur Jumper; 1.10/1.15m Amateur Jumper; **Cross Entry: Rider:** Riders may not show in any classes where the jumps exceed 1.20m. **Horse/Pony:** No cross entry restrictions. **Horse and Rider Combination:** 1.00/1.05m Amateur horse and rider combinations may not cross enter into the 1.10/1.15m Amateur Jumper section at the same competition. 1.10/1.15m Amateur horse and rider combinations may not cross enter into the 1.00/1.05m Amateur Jumper section at the same competition. **Fence Height:** 1.00m to 1.05m; 1.10m to 1.15m. **Combining/Dividing Sections:** Amateur Jumper sections may be divided by or combined with Junior Jumper sections, at competition management's discretion, if so stated in the prize list. **Awards:** Zone Horse of the Year Awards will be presented annually to the following sections: 1.00/1.05m Amateur Jumper; 1.10/1.15m Amateur Jumper

ADULT AGE GROUP EQUITATION SECTIONS

Sections Offered: Adult Equitation 18- 39; Adult Equitation 40- 55; Adult Equitation 56 & Over. **Cross Entry:** No cross entry restrictions into another section for horse and rider unless stated in the prize list. **Fence Height:** 2'9"- 3'6" with spreads not to exceed fence height. Combinations will be permitted. Management must state in the prize list, the height at which sections are being held. **Combining/Dividing Sections:** Refer to HU166. **Awards:** Zone Horse of the Year Awards will be presented annually to the following section: Adult Equitation 18- 39; Adult Equitation 40- 55; Adult Equitation 56 & Over.

CHILDREN'S HUNTER HORSE

Sections offered and requirements: Children's Hunter Horse 13 & Under; Children's Hunter Horse 14- 17. **Cross Entry: Rider:** Riders entered in the Children's Hunter section may not compete in the Junior Hunter section at the same competition. Riders may not show in any classes in which the fences are 3'9" and over at the same competition. **Horses/Ponies:** Horses entered in the Children's Hunter section may not compete in the Junior Hunter section at the same competition. **Horse and rider combination:** No cross entry restrictions. **Fence Height:** 3'0" with spreads not to exceed fence height. In and outs will be permitted. **Combining/Dividing Sections:** Refer to HU166. **Awards:** Zone Horse of the Year Awards will be presented annually to the following sections: Children's Hunter Horse 13 & Under; Children's Hunter Horse 14- 17.

LOW CHILDREN'S HUNTER HORSE

Eligibility: Open to exhibitors who have not yet reached their 18th birthday as of December 1 of the current competition year. **Cross Entry: Riders:** Riders may not cross enter at the same competition into any class/ section where fences exceed 2'9". **Fence Height:** • 2'6". In and outs will not be permitted. **Combining/Dividing Sections:** The Low Children's Hunter and Low Adult Amateur Hunter sections may be combined if there are fewer than three (3) entries in either section. **Awards:** Zone Horse of the Year Awards will be presented annually to the following section: Low Children's Hunter Horse.

CHILDREN'S HUNTER PONY

Sections offered and requirements: Small/Medium Children's Pony; Large Children's Pony. **Cross Entry: Rider:** Children's Hunter Pony riders may compete on a maximum of one (1) Children's Hunter horse section at the same competition and in any class not to exceed 3'0" (Exception: Pony Jumpers). Green and Regular Hunter Pony riders may compete on a maximum of two (2) additional pony in the Children's Hunter Pony section at the same competition. **Horse/Pony:** Ponies may not cross enter into any other rated section at the same competition. **Horse and Rider Combination:** The same pony and rider may not cross enter into any other rated section at the same competition. **Fence Height:** In and outs will not be permitted. Classes may run as one or split Small/Medium and Large to run at 2'0" and 2'6" respectively. **Combining/Dividing Sections:** Refer to HU166. **Awards:** Zone Horse of the Year Awards will be presented annually to the following sections: Children's Hunter Pony-Small/Medium; Children's Hunter Pony-Large.

JUNIOR JUMPER

Sections offered and Requirements: 1.00/1.05m Junior Jumper; 1.10/1.15m Junior Jumper. **Entry: Rider:** Riders may not show in any classes where the jumps exceed 1.20m, except Junior riders competing in FEI Children's classes and USEF Talent Search Class. **Horse/Pony:** No cross entry restrictions. **Horse and Rider Combination:** 1.00/1.05m Junior horse and rider combinations may not cross enter into the 1.10/1.15m Junior Jumpers at the same competition. 1.10/1.15m Junior horse and rider combinations may not cross enter into the 1.00/1.05m Junior Jumpers at the same competition. **Fence Height:** 1.00m to 1.05m; 1.10m to 1.15m. **Combining/Dividing Sections:** Junior Jumper sections may be divided or combined with Amateur Jumper sections, at competition management's discretion, if so stated in the prize list. **Awards:** Zone Horse of the Year Awards will be presented annually to the following sections: 1.00/1.05m Junior Jumper; 1.10/1.15m Junior Jumper.

CHILDREN'S AGE GROUPS: HUNTER EQUITATION SECTIONS

Sections Offered: Hunter Equitation 11 & Under; Hunter Equitation 12-14; Hunter Equitation 15-17. **Cross Entry:** No cross entry restrictions into another section for horse and rider unless stated in the prize list. **Fence Height:** Hunter Equitation 11 & Under: Minimum 2'6", maximum 3' - management must state height at which class will be offered. Management may offer multiple height options if stated in the prize list, but each course must be set at the same height throughout. Combinations not permitted. Hunter Equitation 12- 14: Minimum 2'9", maximum 3'3" - management must state height at which class will be offered. Management may offer multiple height options if stated in the prize list, but each course must be set at the same height throughout. Combinations are optional. Hunter Equitation 15- 17: Minimum 3'0", maximum 3'6" - management must state height at which class will be offered. Management may offer multiple height options if stated in the prize list, but each course must be set at the same height throughout. Combinations are optional. **Combining/Dividing Sections:** Refer to HU166. **Awards:** Zone Horse of the Year Awards will be presented annually to the following sections: Hunter Equitation 11 & Under; Hunter Equitation 12-14; Hunter Equitation 15-17.

USHJA COMPETITIVE PROGRAMS

For more information regarding the following programs please click on the links below:

- Green Hunter Incentive Click [here](#) for full specifications
- Hunter Team Challenge Click [here](#) for full specifications
- International Hunter Derby Click [here](#) for full specifications National Hunter Derby Click [here](#) for full specifications
- Outreach Click [here](#) for full specifications
- Pony Hunter Derby Click [here](#) for full specifications
- World Championship Hunter Rider Click [here](#) for full specifications
- Zone Horse of the Year Championships
- Please check individual [zone pages](#)
- Zone Jumper Team Championships Click [here](#) for full specifications
- 1.0/1.05m Junior/Amateur Zone Jumper Championship Click [here](#) for full specifications
- **SPECIAL CLASSES**
- 3'3" Jumping Seat Medal Click [here](#) for full specifications
- 3'3" Hunter Seat Medal Click [here](#) for full specifications Green Hunter Challenge Click [here](#) for full specifications
- Gladstone Cup Equitation Classic Click [here](#) for full specifications

Full Specs available at: <https://www.ushja.org/zones-affiliates/zone-9/specifications>.

Olivia Kibbie celebrates with her partner Midnight Sun at the 2025 Cascade Classic. The pair were Reserve Champions in the Children's Hunter Pony and the Children's Pony Equitation 2', 2'3", 2'6" sections. Trainer: Nancy Free.



Cascade HORSE  SHOWS

USEF Competition Names:

Cascade Classic, Cascade Open

USEF# 330219

Competition Division(s) and Rating(s):

USEF National Hunter (Channel I), Jumper Level 3
USEF Regional Hunter (Channel II), Jumper Level 3

332619

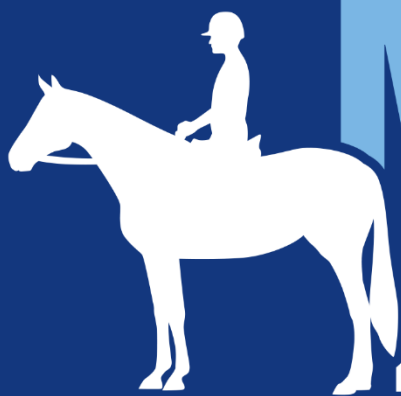

MAAPP

MINOR ATHLETE ABUSE PREVENTION

LEARN ABOUT MAAP POLICIES



Safe Sport Training



Local Travel



One-On-One Interactions



Social Media & Electronic Communications



Read about these & more at usef.org/MAAPP

REPORT MAAP POLICY VIOLATIONS



usef.org/safe-sport/reporting

859-225-6915 or Text Anonymously 855-682-8733



CASCADE SPONSORS

Cascade Horse Shows gratefully thanks its proud sponsors

Equestrian Brands & Commercial Sponsors

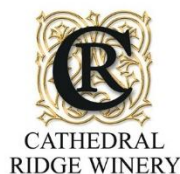

CASCADE SPONSORS

Cascade Horse Shows gratefully thanks its proud sponsors

Premium Show Stables & Individual Patrons

